

ACCLIMATE™

ACRK-16-02-G-S-B1-P-1

ACRK-16-01-G-T-B1-P-1

ACRK-16-06-G-T-B1-M-1

ACRK-16 SERIES

16 mm IP68 FIELD TERMINATION KIT

SPECIFICATIONS

For complete specifications and processing guidelines see www.samtec.com?ACRK-16

Terminal Material:

Brass
Contact Material:
 Brass/BeCu

Operating Temp Range:

-10 °C to +105 °C

Housing:

-P: Thermoplastic

-M: Zinc Alloy

RoHS Compliant:

Yes

Mates with:

ACP-16, ACPK-16

CURRENT RATING		
LEAD STYLE	PINS POWERED	CCC per PIN
-01	14	1.3 A
-02	10	2.6 A
-06	2 (plus 8 signal pins powered @ 1A)	11.6 A

For general reference only. See www.samtec.com?ACRK-16 for complete test data or contact AccliMate@samtec.com for applications requiring higher current carrying capacity.

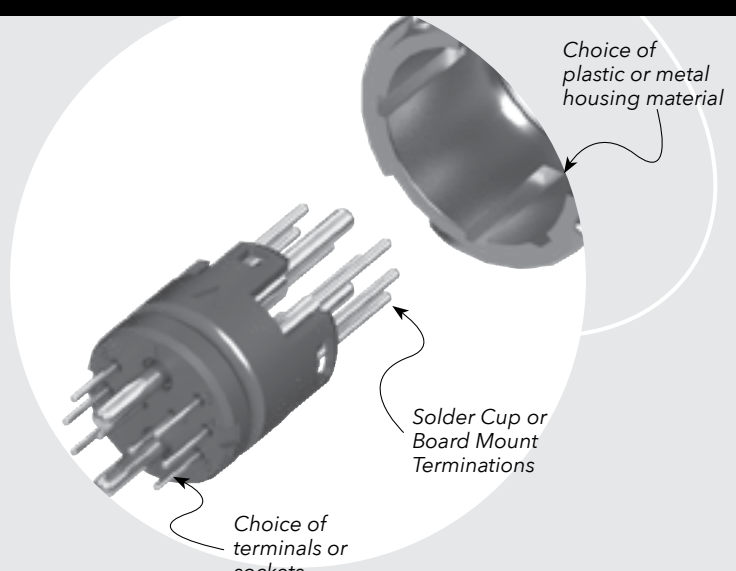

DUST CAPS

- DCA-ACR-16-M-X (Metal)
- DCA-ACR-16-P-X (Plastic)



- Visit sealedio.samtec.com for a complete list of sealed systems

PANEL OPENING

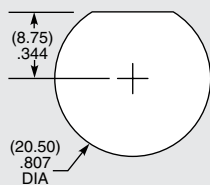

NOTE

For complete specifications and processing guidelines see www.samtec.com?ACRK-16

Note: Some lengths, styles and options are non-standard, non-returnable.

ACRK	16	LEAD STYLE	PLATING	GENDER	TERMINATION	HOUSING MATERIAL	KEY
		-01 = 0.5 mm DIA (14) (26-30 AWG) -02 = 1.0 mm DIA (10) (20-24 AWG) -06 = 1.5 mm DIA (2) (14-18 AWG) + 0.5 mm DIA (8) (26-30 AWG)	-G = 10 μm (0.25 μm) Gold over 50 μm (1.27 μm) Ni on contact	-T = Terminal -S = Socket	-C = Solder Cup -B1 = (1.60 mm) .062" Board Mount	-P = Plastic -M = Metal	-1 = Orange, 45°
			(0.5) .020 DIA (14)			(1.0) .040 DIA (10)	
							(1.5) .060 DIA (2)
						(0.5) .020 DIA (8)	

-B1 END SHOWN **-C END SHOWN**