



CJT-T-P-HH-RA-TH1



CJT-T-P-HH-RA-BH1



**CJT SERIES**

# 100 Ω CIRCULAR RF TWINAX JACK

**SPECIFICATIONS**

For complete specifications and recommended PCB layouts see [www.samtec.com?CJT-TH](http://www.samtec.com?CJT-TH) or [www.samtec.com?CJT-BH](http://www.samtec.com?CJT-BH)

- Shell Material:** Brass
- Insulator Material:** PTFE
- Contact Material:** Phosphor Bronze
- Operating Temperature:** -20 °C to +105 °C
- Frequency Range:** 0 - 4 GHz
- Working Voltage:** 200 VAC
- Impedance:** 100 Ω
- RoHS Compliant:** Yes
- Lead-Free Solderable:** Yes

**Mates with:**  
C28S

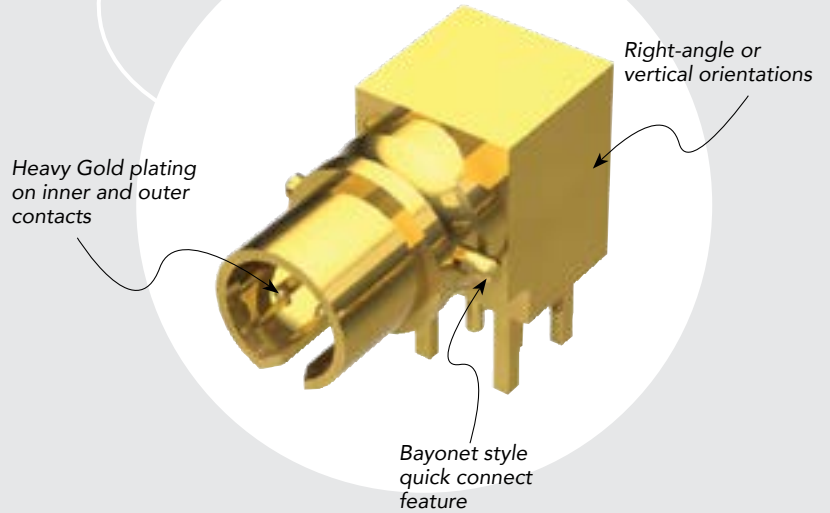

CJT	GENDER	TYPE	PLATING	ORIENTATION	TERMINATION	PACKAGING
-T		-P	-HH	-ST	-TH1	
= Jack		= PCB Mount	= 30 μ" (0.76 μm) Gold on pins and outer contact	= Straight -RA = Right-angle	= Standard Through-hole -BH1* = Standard Bulkhead Through-hole (-RA only)	Leave blank for individually bagged -B Bulk packaged (-BH only)

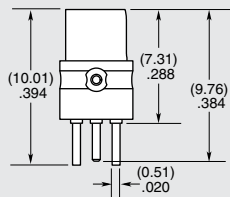
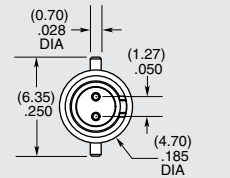

-ST-TH1

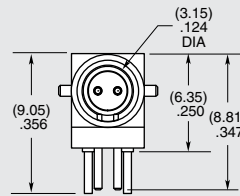

-RA-TH1

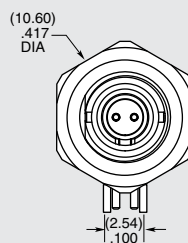
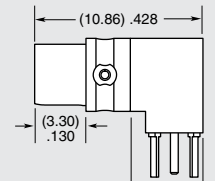

-RA-BH1\*

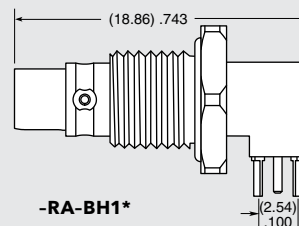

\* Lock washer, nut and gasket supplied unassembled with Bulkhead option.