

THIS DRAWING IS UNPUBLISHED. RELEASED FOR PUBLICATION, 19 .  
 © COPYRIGHT 19 BY AMP INCORPORATED. ALL INTERNATIONAL RIGHTS RESERVED.

LOC	DIST	P	F	REVISIONS				DATE	APPD
AA	25			ZONE	LTR	DESCRIPTION			
					R	REV; EC ON20-0054-97	16SEP97	DS EH	

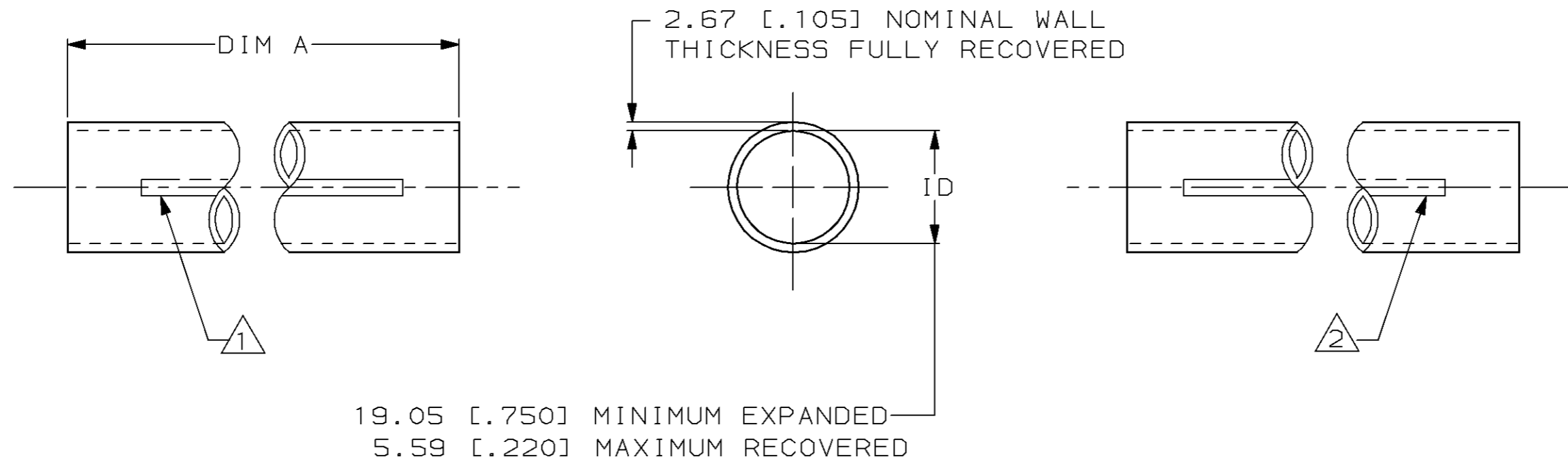

- ① PRODUCT MARKED WITH AMP, AND DATE CODE WITH 6.35 [.25] HIGH CHARACTERS USING WHITE INK LOCATED ALONG THIS SURFACE. REPEAT EVERY 203.2 [8.0] INCHES.
- ② PRODUCT MARKED .750 - .220/19mm - 5.59mm WITH 6.35 [.25] HIGH CHARACTERS USING WHITE INK LOCATED ALONG THIS SURFACE. REPEATED EVERY 203.2 [8.0] INCHES.
- ③ WEIGHT PER LINEAR FOOT: 31.7 GRAMS/ .07 POUNDS.

304.8 ±4.8 [12.00 ±.19]		53701-7
7696.20 - 7620.00 [303 - 300]		53701-2
1244.6 - 1219.2 [49.00 - 48.00]		53701-1
DIM A		PART NO
DO NOT SCALE PRINT. UNLESS SPECIFIED DIMENSIONS IN mm [INCHES] TOLERANCES ON: 2 PLC DEC ± - 3 PLC DEC ± - ANGLES ± -	DR 1-21-94 W CHANDLER	<b>AMP</b> AMP Incorporated Harrisburg, PA 17105-3608
	CHK 2-14-94 D KAAT	
	APPD -	NAME AMPSULATION HWP31, HST WITHOUT SEALANT .750 INCHES DIAMETER
	APPD -	SIZE B CAGE CODE 00779 DRAWING NO C-53701
	PRODUCT SPEC -	SCALE - SHEET 1 OF 1
MATERIAL BLACK POLYOLEFIN	APPLICATION SPEC -	
FINISH -	WEIGHT ③	

THIS DRAWING IS A CONTROLLED DOCUMENT FOR AMP INCORPORATED. IT IS SUBJECT TO CHANGE AND THE CONTROLLING ENGINEERING ORGANIZATION SHOULD BE CONTACTED FOR THE LATEST REVISION.