

Technical specification:

Rated voltage: IEC 61076-2-101	4pos 250 V	5pos 60 V	8pos 30 V
Current rating: IEC 61076-2-101	4/5pos 4 A at 40°C	8pos 2 A at 40°C	
Insulation resistance: IEC 60512	≥100 MΩ		
Pollution degree: IEC 60664-1	3/2		
Degree of protection: IEC 60529	IP 67, in mated condition		
Temperature range: IEC 60664-1	-30°C ... +80°C		
Mating cycles: IEC 60512-9a	≥100		

Materials:

Contact:	CuZn
Contact plating:	Nickel, gold plated
Contact carrier:	TPU GF, UL 94
Sealing:	FKM, NBR
Counternut:	GD-Zn, Nickel plated
Socket housing:	CuZn, Nickel plated
Grouting:	Polyurethane-resin, UL 94

Installation specification:

Recommended torque:	M12x1: 0,6 Nm
	M16x1,5: 1-1,2 Nm

Conec installation tool: Torque wrench: 36-000200
 Insert across flats 13: 36-000220
 Insert across flats 17: 36-000230

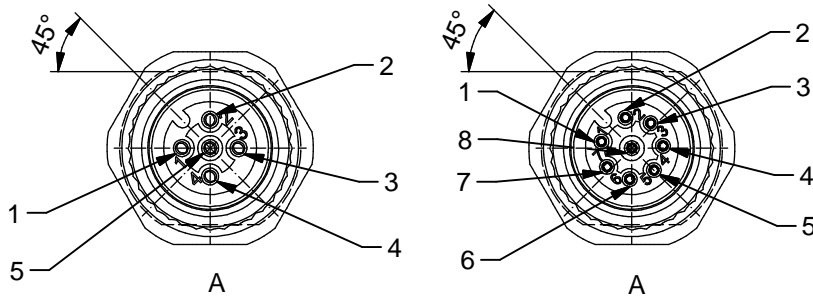

Contact assignment:

- 1) brown
- 2) white
- 3) blue
- 4) black
- 5) green-yellow

Contact assignment:

- 1) white
- 2) brown
- 3) green
- 4) yellow
- 5) grey
- 6) pink
- 7) blue
- 8) red

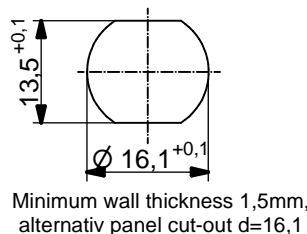
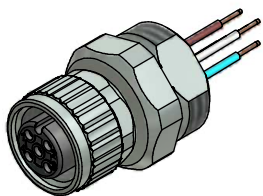

Part no:	Description:	Pol	Length L:	Wire:
43-01378	SAL - 12 - FKD4 - 0,05	4	0,05m	AWG 24 PVC, UL
43-xxxxx	SAL - 12 - FKD4 - ...	4	x	
43-01381	SAL - 12 - FKD5 - 0,05	5	0,05m	
43-xxxxx	SAL - 12 - FKD5 - ...	5	x	
43-01492	SAL - 12 - FKD8 - 0,05	8	0,05m	
43-xxxxx	SAL - 12 - FKD8 - ...	8	x	

DO NOT ALTER CAD DRAWING BY HAND Directive 2002/95/EC RoHS compliant	Index: e 18.08.11 fro Ä3914 Data sheet revised, technical specification changed, Sleeve side B removed, Couplingnut modified	dim. in mm	title: Female socket M12x1 with wires, frontmounting turnable								
	tolerance of wire: L ≤ 0,5m: L + 20mm L > 0,5m: L + 4%	<table border="1" style="width: 100%; border-collapse: collapse;"> <tr> <td style="width: 30px;">date</td> <td style="width: 30px;">name</td> </tr> <tr> <td>drawn 08.12.08</td> <td>Fromm</td> </tr> <tr> <td>appd. 02.12.08</td> <td>Mankopf</td> </tr> </table>	date	name	drawn 08.12.08	Fromm	appd. 02.12.08	Mankopf	dwg no: <div style="text-align: center; font-size: 1.2em; font-weight: bold;">43K1A830</div>		
	date	name									
	drawn 08.12.08	Fromm									
appd. 02.12.08	Mankopf										
general tolerance: 0 ± 0,50mm 0,0 ± 0,25mm 0,00 ± 0,10mm			part no:								
THIS DRAWING MAY NOT BE COPIED OR REPRODUCED IN ANY WAY, AND MAY NOT BE PASSED ON TO A THIRD PARTY WITHOUT WRITTEN PERMISSION. OWNERSHIP AND COPYRIGHT OF CONEC GmbH											