

THIS DRAWING IS UNPUBLISHED. RELEASED FOR PUBLICATION 20
 © COPYRIGHT 20 BY - ALL RIGHTS RESERVED.

| REVISIONS | | | | |
|-----------|-----|---------------------------|-----------|-------|
| P | LTR | DESCRIPTION | DATE | APVD |
| | A | REVISED PER ECR-16-014077 | 06OCT2016 | BW RS |
| | | | | |
| | | | | |

1 THIS HOUSING ACCEPTS BOTH FASTON AND POSI-LOCK MKII TERMINALS.

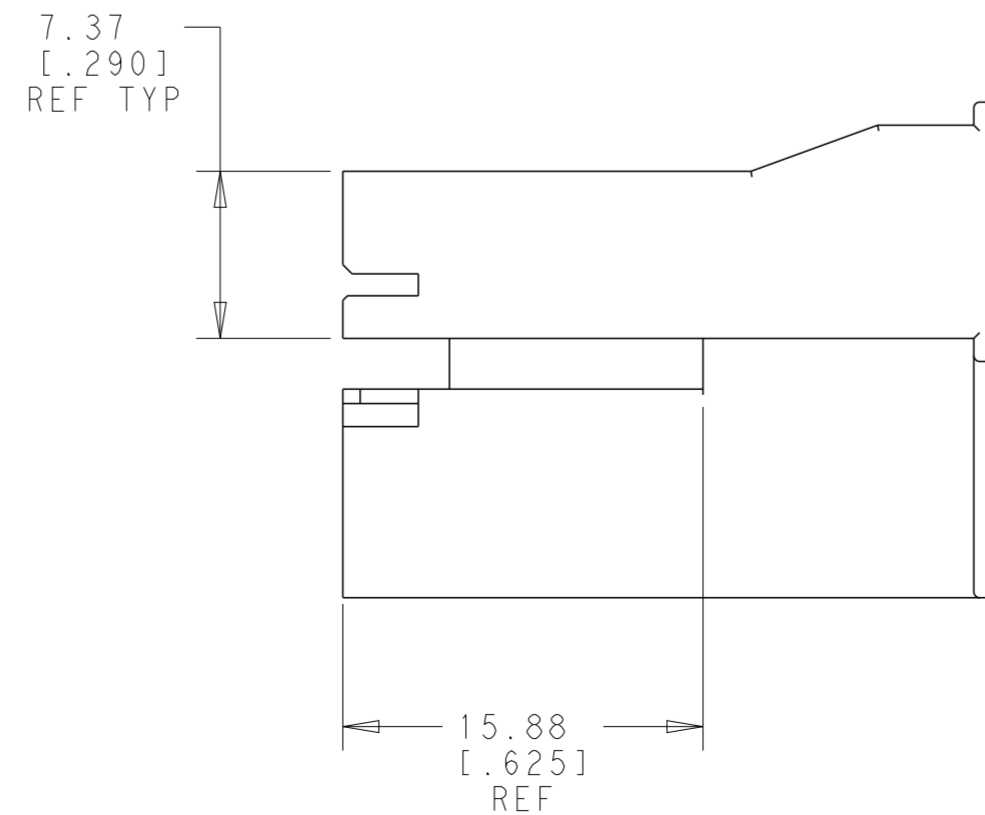
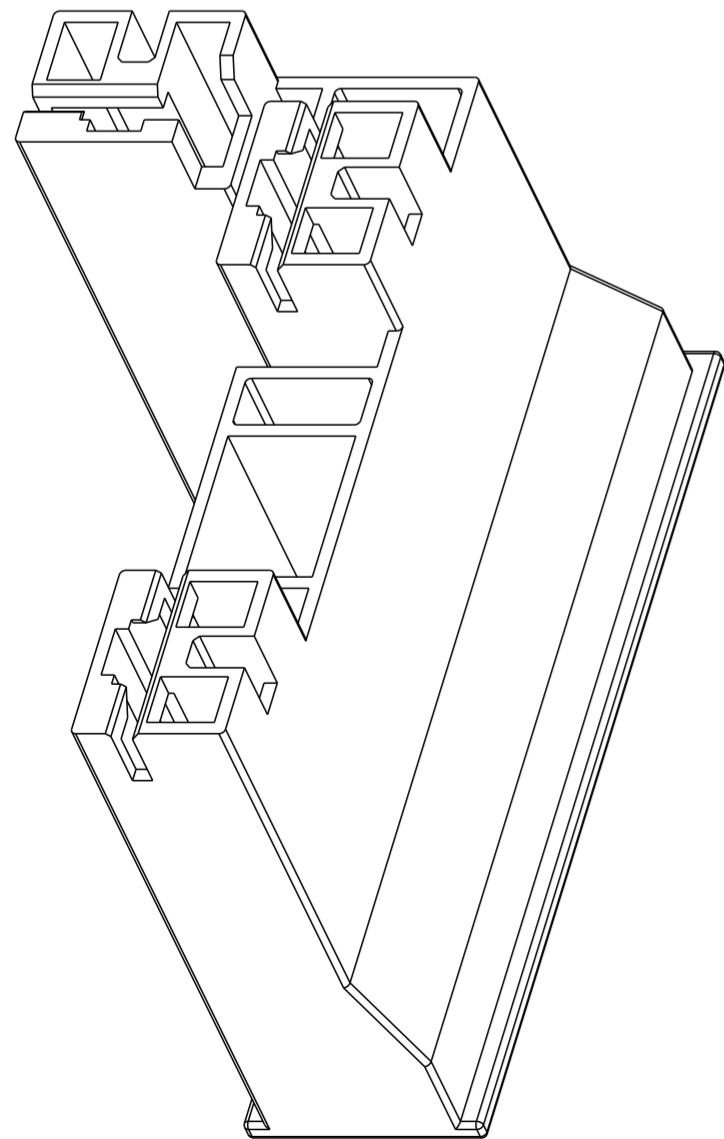
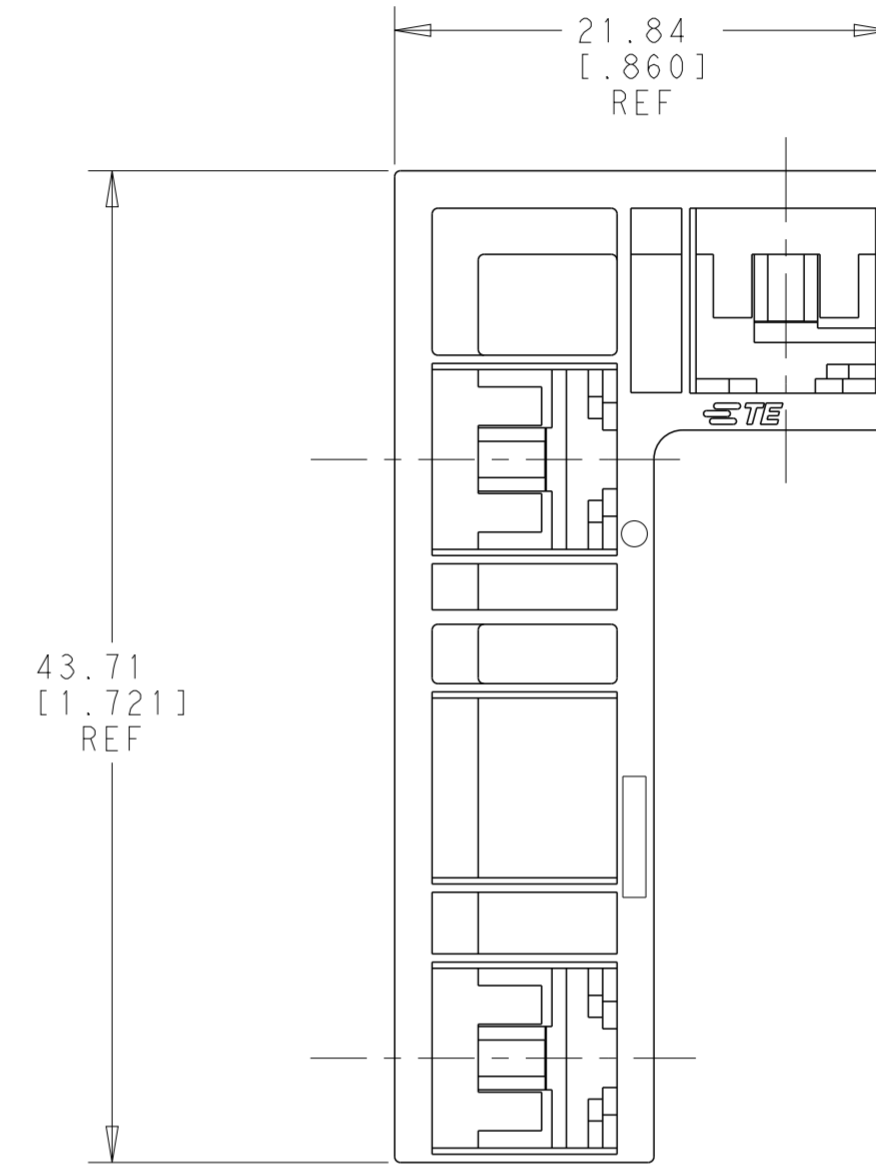
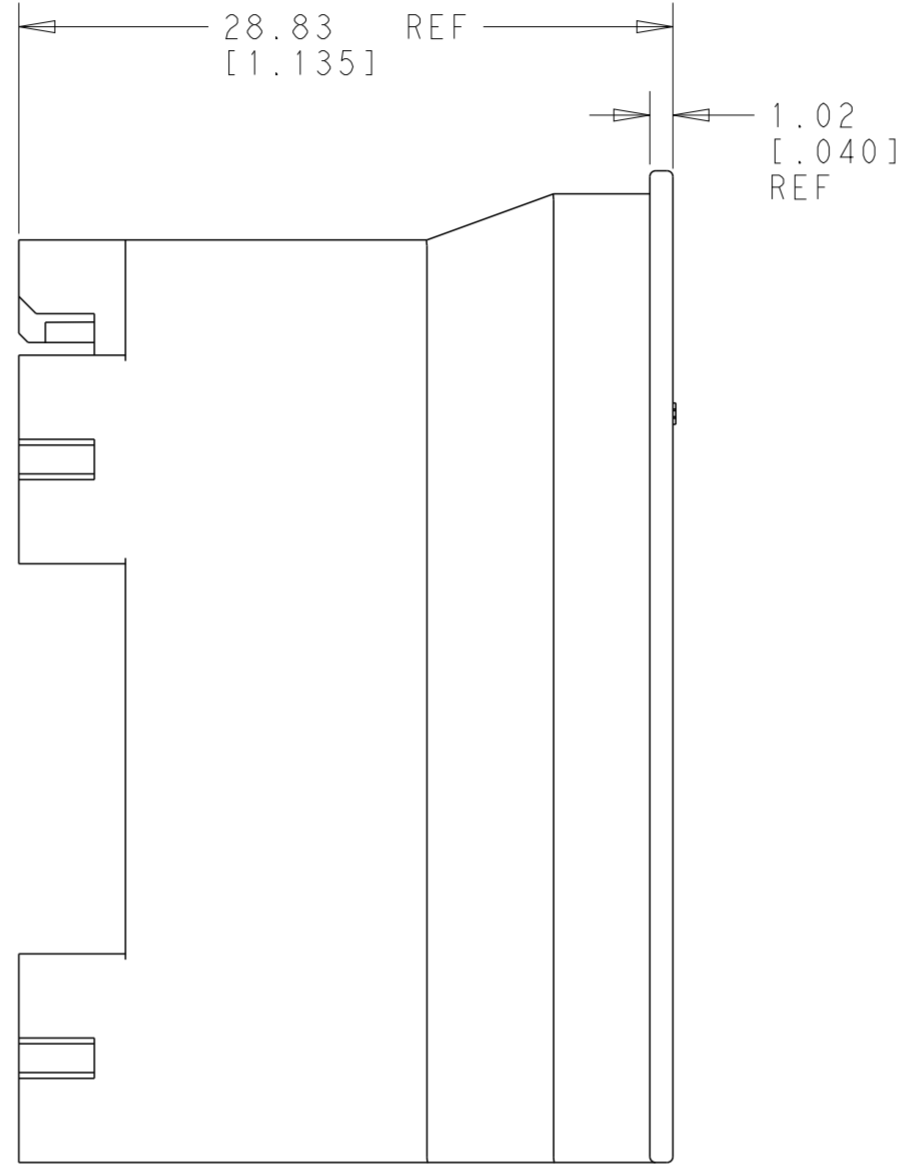
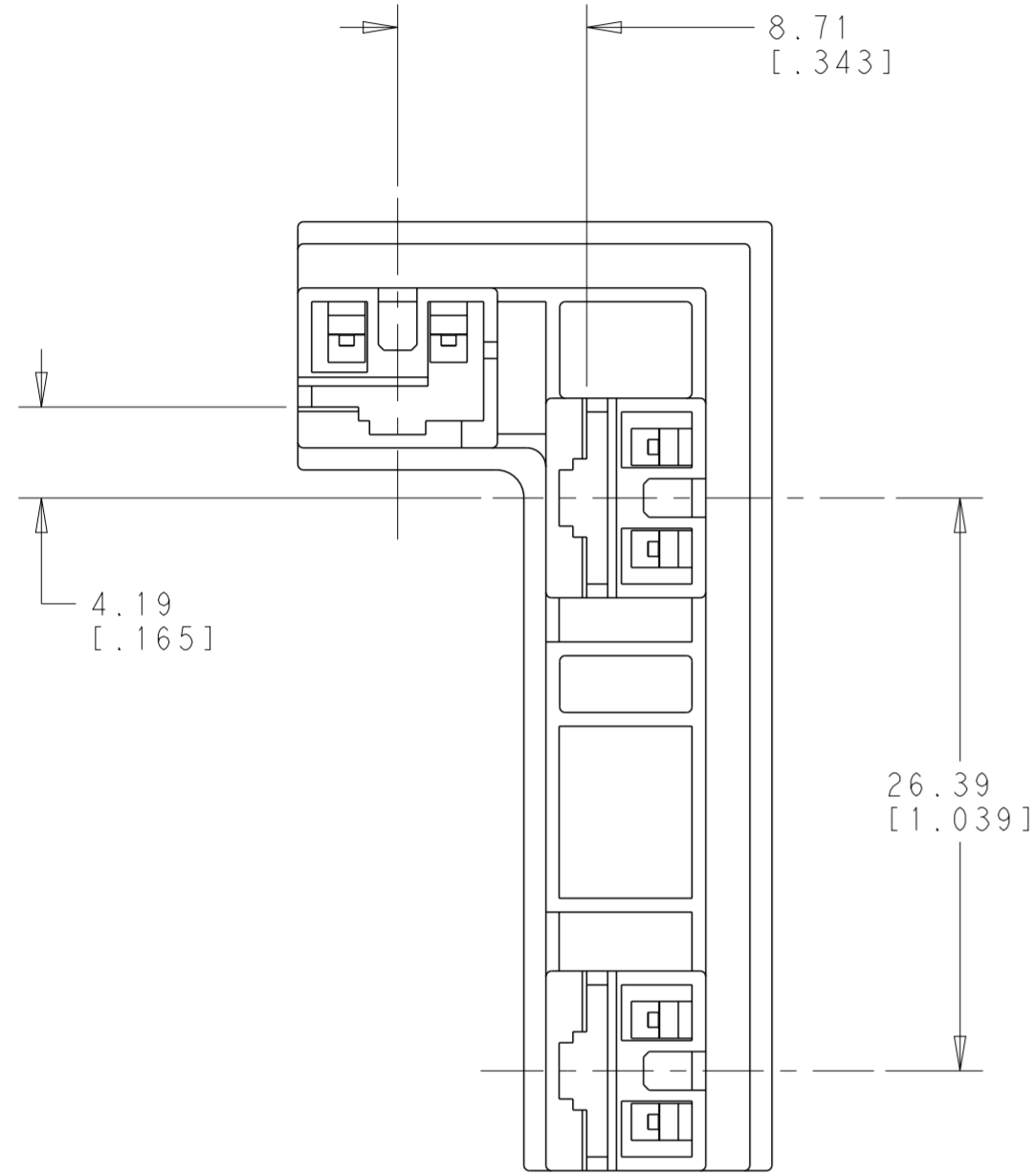

THIS DRAWING IS A CONTROLLED DOCUMENT.

| | |
|----------------------------|--|
| DIMENSIONS: mm [INCHES] | TOLERANCES UNLESS OTHERWISE SPECIFIED: |
| | 0 PLC ± 1 PLC ± 2 PLC ± 3 PLC ±0.25 [.010] 4 PLC ± ANGLES ± FINISH - |
| MATERIAL NYLON V0 | |

| | |
|---------------------------|-------------|
| DWN NAGALAKSHMI, K | 23 JUN 2015 |
| CHK DIDONATO, MICHAEL | 23 JUN 2015 |
| APVD DIDONATO, MICHAEL | 23 JUN 2015 |
| PRODUCT SPEC | |
| APPLICATION SPEC | |
| WEIGHT | |
| CUSTOMER DRAWING | |

| | | |
|-------------------------------|-----------|------------|
| NATURAL | NYLON V0 | 1969760-1 |
| COLOR | MATERIAL | PART NO |
| TE Connectivity | | |
| NAME 3P POSI-LOCK, MARK II | | |
| SIZE | CAGE CODE | DRAWING NO |
| A200779 | C-1969760 | |
| RESTRICTED TO | SCALE | SHEET |
| - | 3:1 | 1 OF 1 |
| REV | | A |