

PARTS LIST				
ITEM	QTY	PART NUMBER	DESCRIPTION	
1	1	F040001	L16PLT10	
2	1	F050209	50-002-12 RECTANGULAR FLAT GREEN LENS	
3	1	F050422	50-004-22 24V LED GREEN	

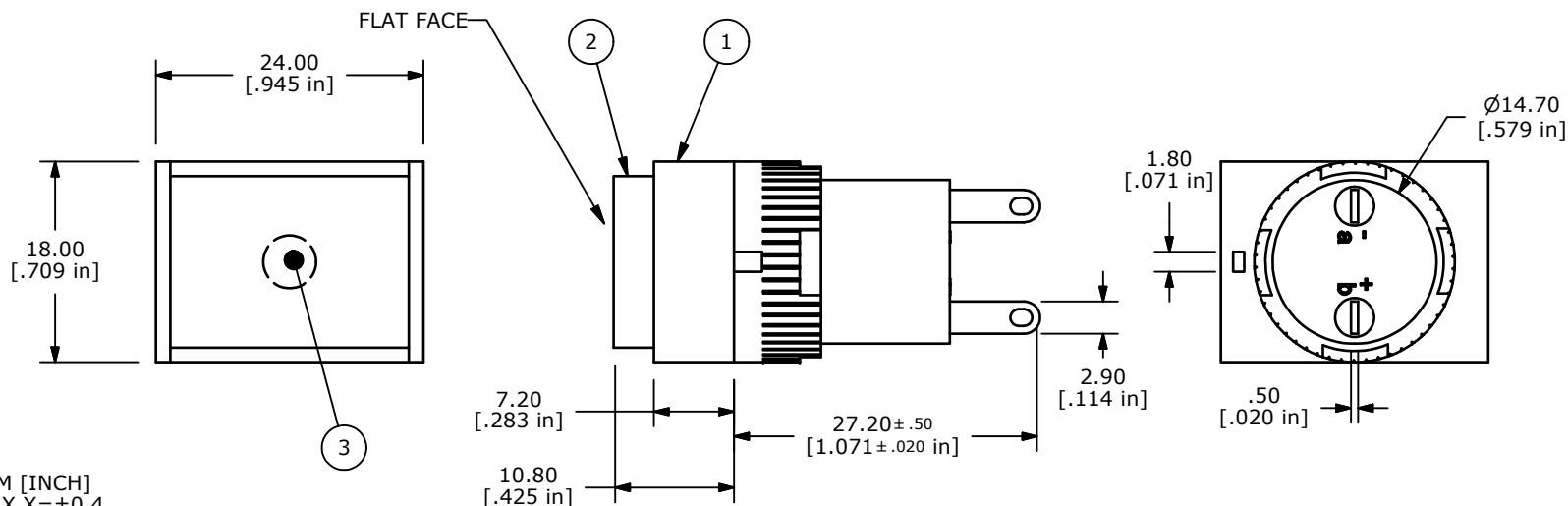

- NOTE:
1. ALL DIMENSIONS IN MM [INCH]
 2. GENERAL TOLERANCE: X.X=±0.4
X.XX=±0.25
 3. TERMINAL NUMBERS FOR REF ONLY
 4. OPERATING TEMP: -25°C to +55°C
 5. STORAGE TEMP: -40°C TO +85°C
 - ▲ 6. LAMP VOLTAGE: 24V LED
 7. ▲ DENOTES CRITICAL PARAMETER.
 8. 2002/95/EC (ROHS) COMPLIANT

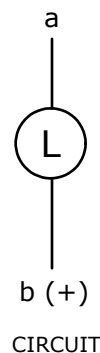
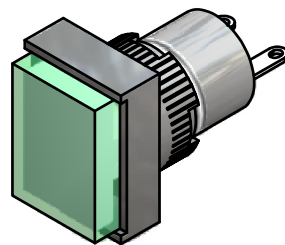
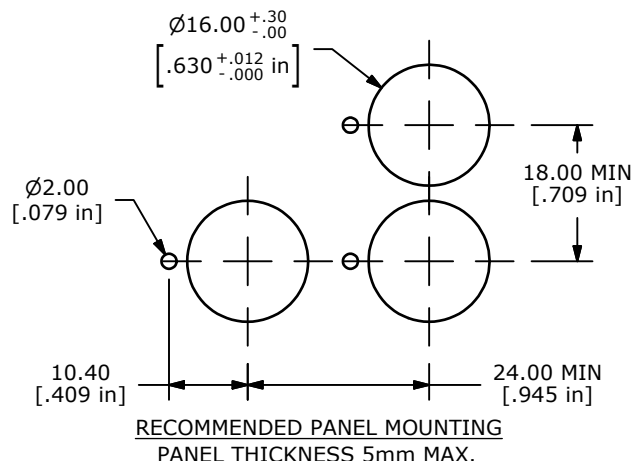

A	20326	RELEASED FOR PRODUCTION	12/8/11	BGL
REV	PCR NO	DESCRIPTION	DATE	BY

TITLE L16PLT10KGRNGRN				
SCALE	DATE	DR	DWG	REV
1.5:1	12/8/2011	BGL	XF0848P	A

THE INFORMATION CONTAINED IN THIS DOCUMENT IS PROPRIETARY TO E-SWITCH AND IS NOT TO BE COPIED OR TRANSFERRED