

LOC	DIST	REV	DATE	BY	CHK	APPV
-	-	A	29JAN2016	JY	SH	
-	-	B	24OCT2016	JY	SH	

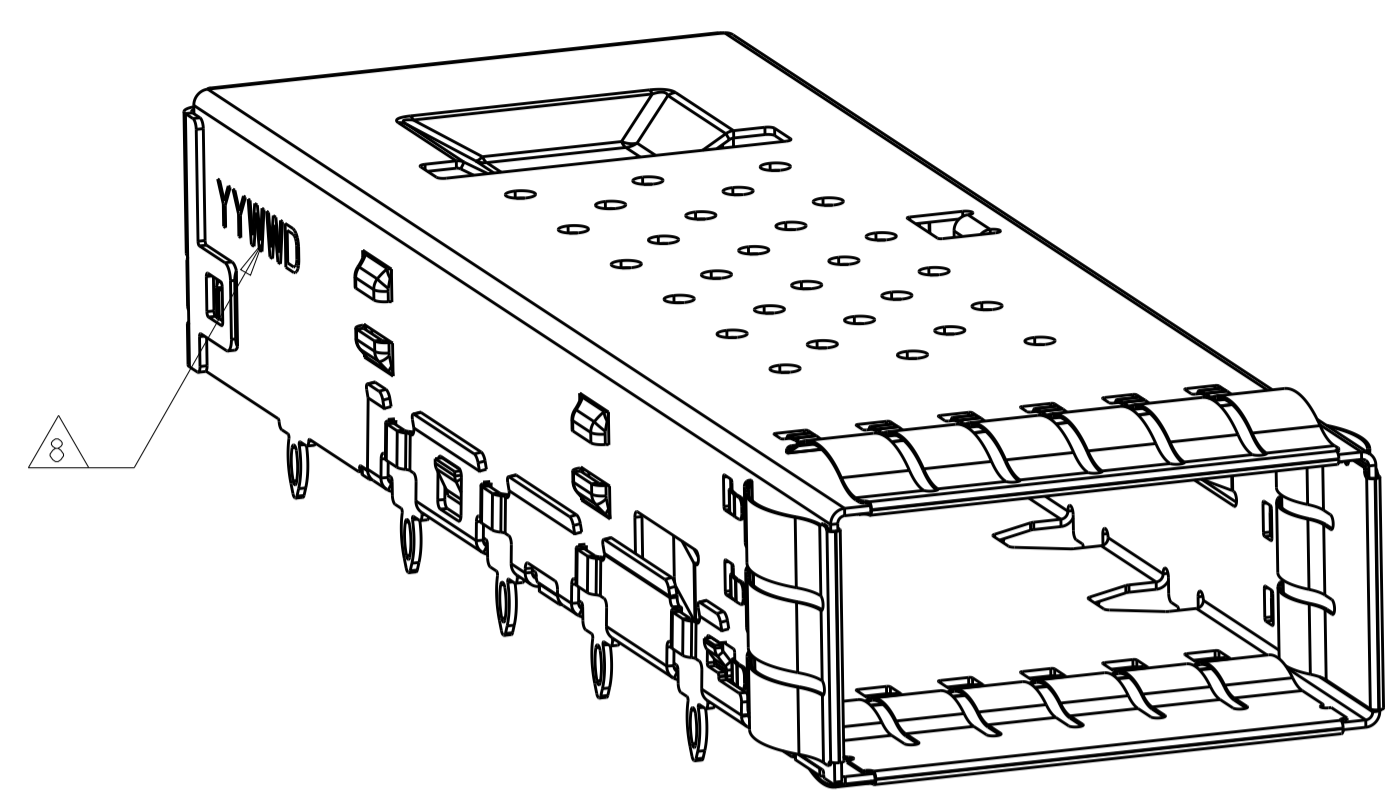

SCALE 4:1

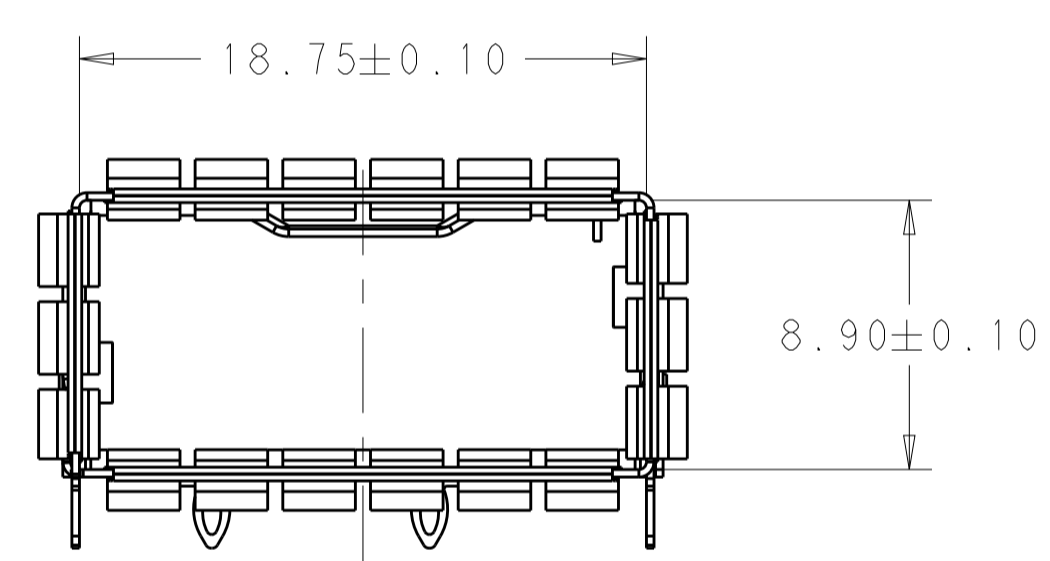
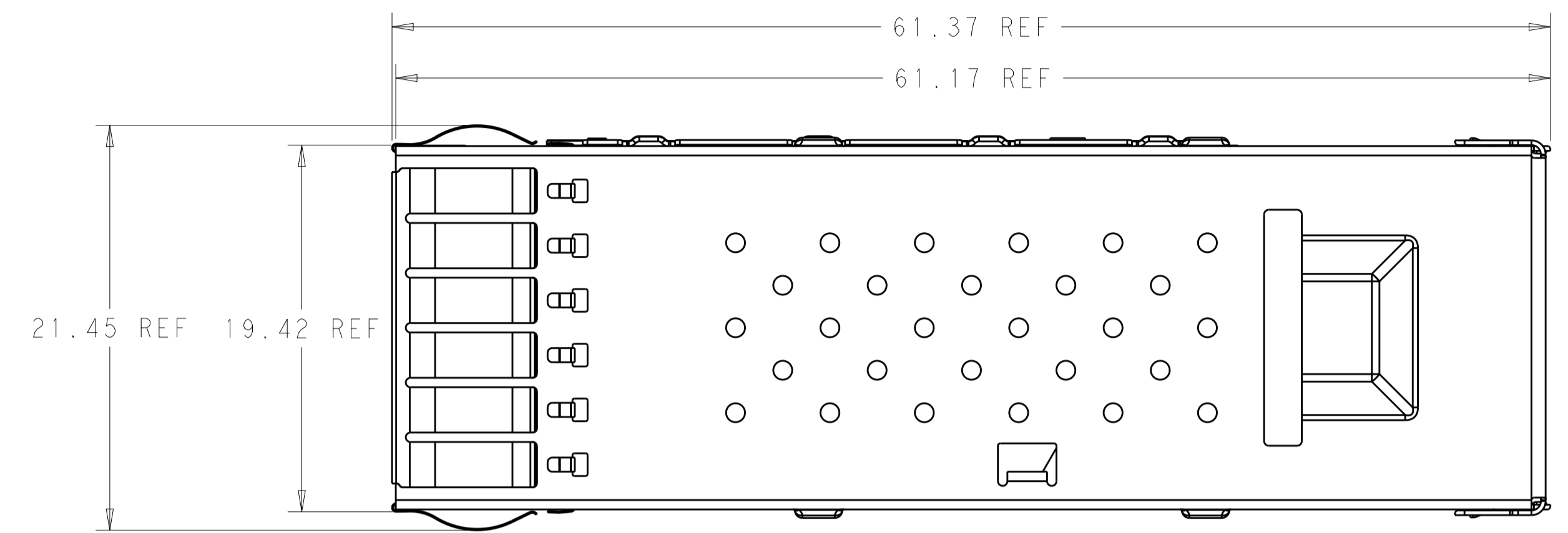

SCALE 4:1

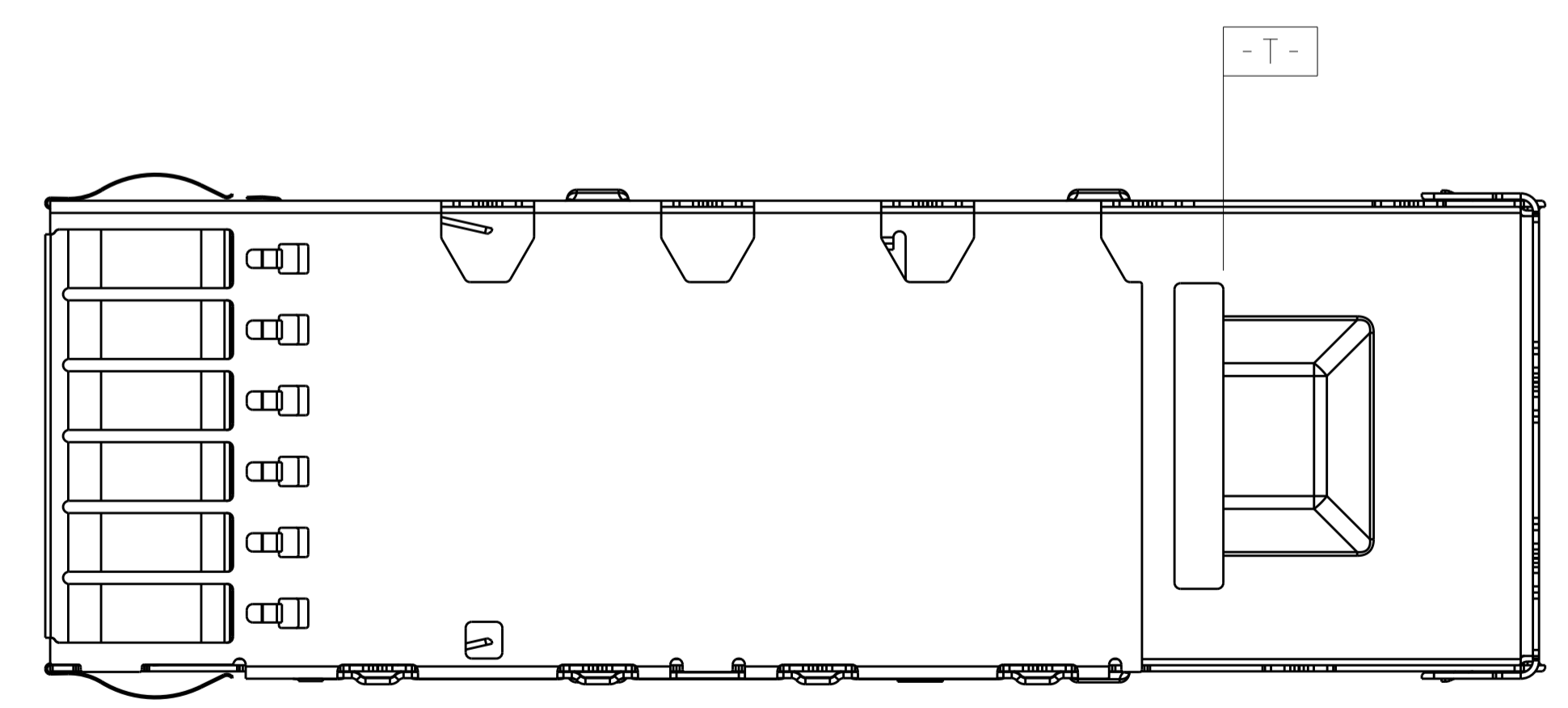
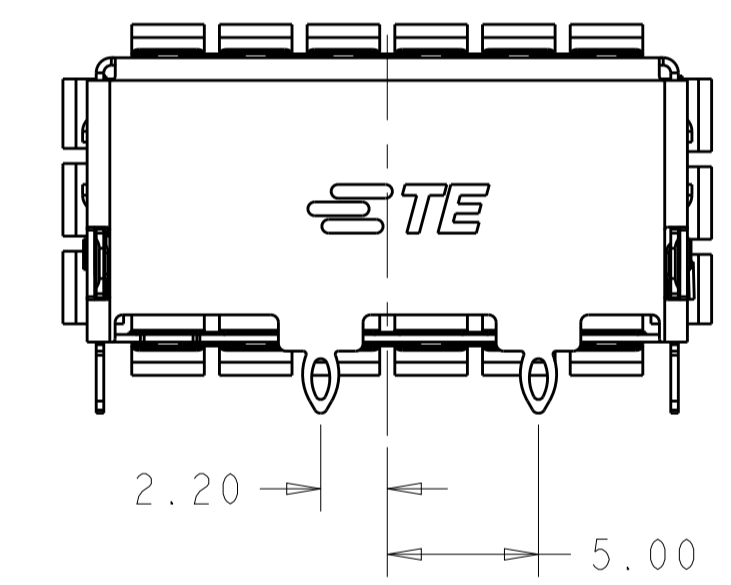
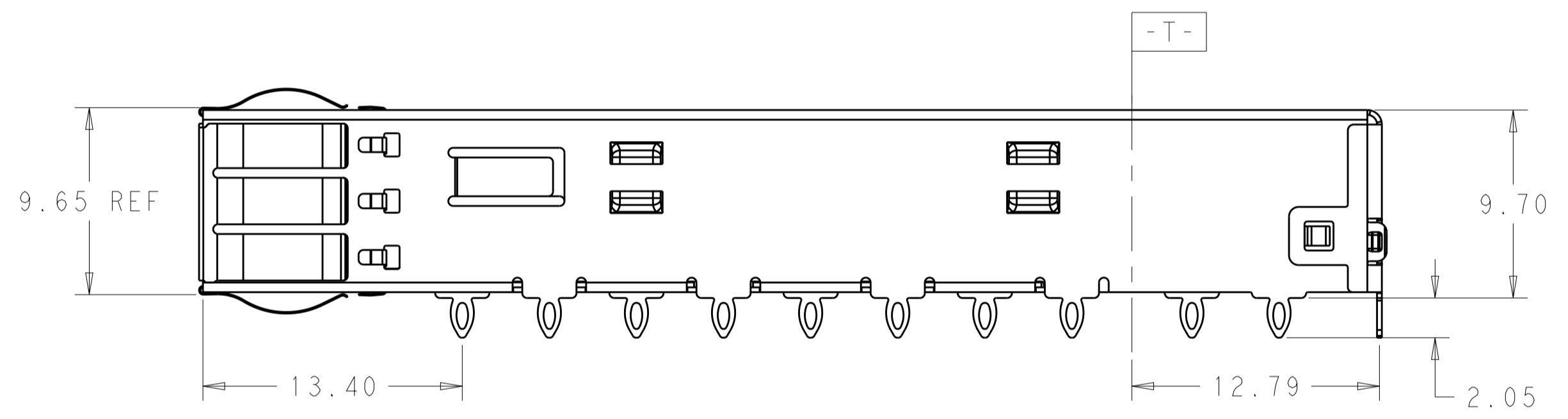

- MATERIAL:
CAGE MATERIAL : 0.25 THICK NICKEL SILVER.
SPRING MATERIAL: COPPER ALLOY
 - FINISH:
SPRING: NICKEL PLATING
 - MATES WITH QSFP28 MSA COMPATIBLE TRANSCEIVER.
 - REFERENCE APPLICATION SPEC 114-32023 FOR RECOMMENDED DRILL HOLE DIAMETER AND PLATING THICKNESS.
 - DATUM AND BASIC DIMENSIONS ESTABLISHED BY CUSTOMERS.
 - MINIMUM PC BOARD THICKNESS: SINGLES SIDED: 1.57 MIN
DOUBLE SIDED: 2.20 MIN
- DATUM [-A-] IS TOP SURFACE OF THE HOST BOARD.
- DATE CODE (YYWWD) MARKED APPROXIMATELY AS SHOWN

WITH	WITH	1	WITHOUT	5-2170703-4
WITHOUT	WITHOUT	0	WITH STANDARD	2-2170703-7
WITH	WITHOUT	1	WITH LARGER	2-2170703-6
WITH	WITHOUT	0	WITH STANDARD	2170703-7
WITH	WITHOUT	1	WITH STANDARD	2170703-6
WITH	WITHOUT	0	WITHOUT	2170703-5
WITH	WITHOUT	1	WITHOUT	2170703-4
WITH	WITHOUT	2	WITH STANDARD	2170703-2
WITH	WITHOUT	2	WITHOUT	2170703-1
SPRING FINGER	INSULATING TAPE OPTION	# REAR PINS	HEAT SINK OPEN	PART NUMBER

2170703-1 AS SHOWN

THIS DRAWING IS A CONTROLLED DOCUMENT. DWG: JASON YANG 23SEP2013, CHK: SEAN HAN 29JAN2016, APVD: -

DIMENSIONS: mm. TOLERANCES UNLESS OTHERWISE SPECIFIED: 0 PLC ±0.25, 1 PLC ±0.25, 2 PLC ±0.20, 3 PLC ±0.100, 4 PLC ±, ANGLES ±.

MATERIAL: -. FINISH: -.

PRODUCT SPEC: 108-19428. APPLICATION SPEC: 114-32023. WEIGHT: -. CUSTOMER DRAWING.

NAME: CAGE ASSEMBLY, QSFP28 1X1, THRU BEZEL WITH EMI SPRING FINGER. SIZE: CAGE CODE DRAWING NO: A100779C=2170703. RESTRICTED TO: -. SCALE: 2:1. SHEET 1 OF 6. REV B.

STC TE Connectivity

LOC		DIST		REVISIONS			
P.	LTN	DESCRIPTION	DATE	DMN	APVD		
-	-	SEE SHEET 1	-	-	-		

HEAT SINK OPEN OPTIONS

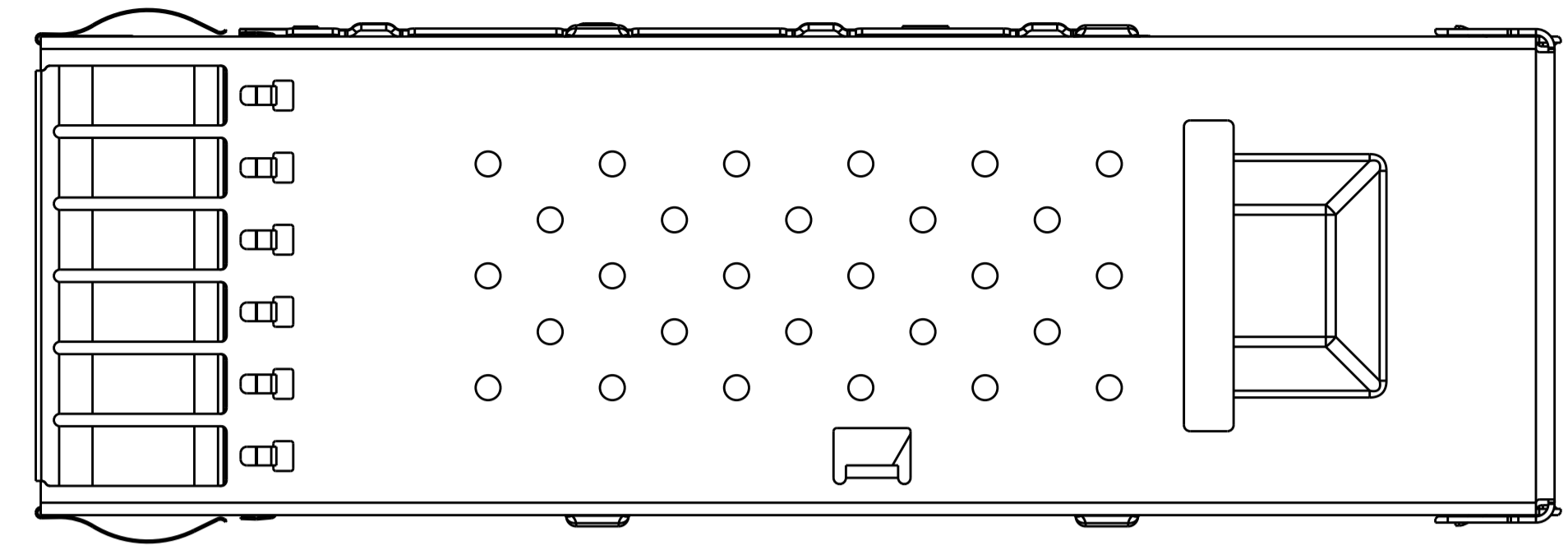

WITHOUT HEAT SINK OPEN
SCALE 4:1

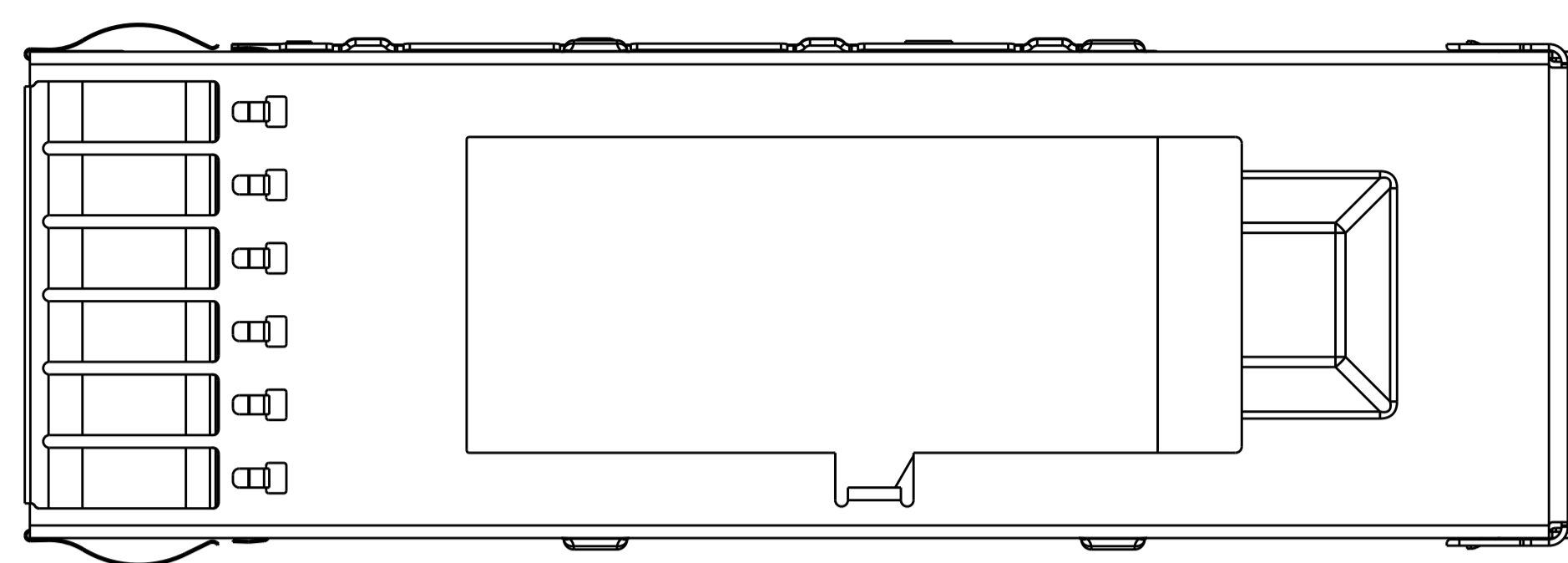

WITH STANDARD HEAT SINK OPEN (30.7X12.5)
SCALE 4:1

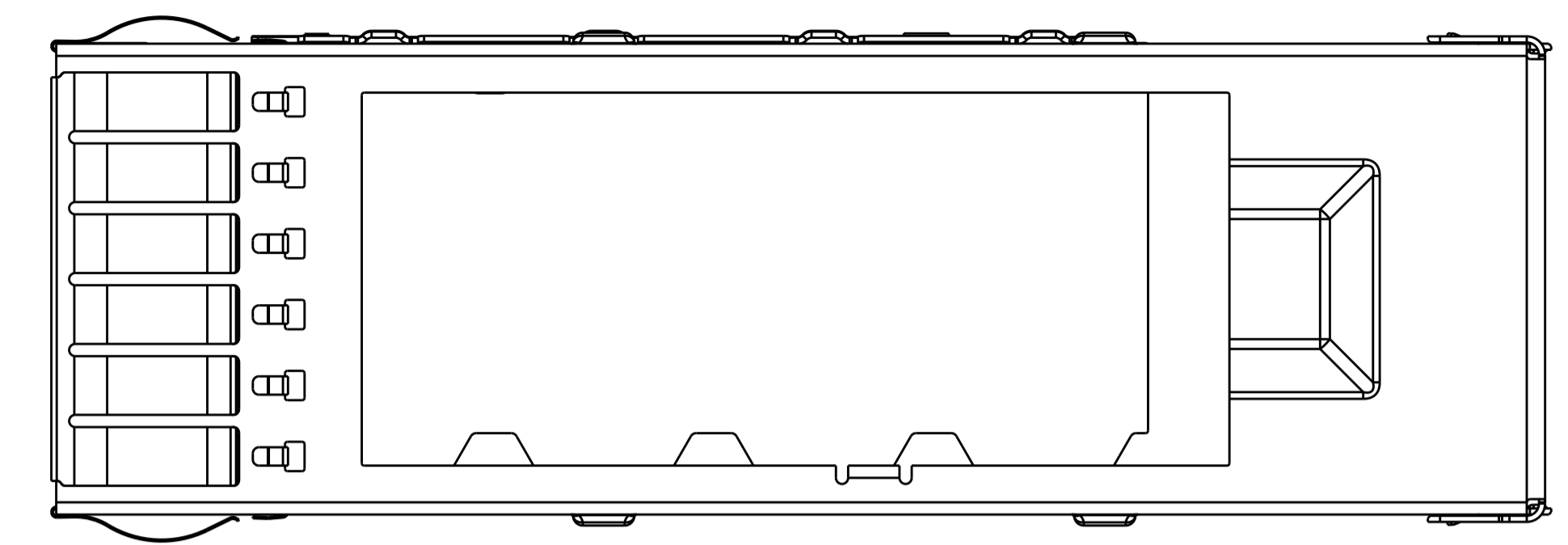

WITH LARGER HEAT SINK OPEN (35.5X15.25)
SCALE 4:1

OF REAR LEGS OPTIONS

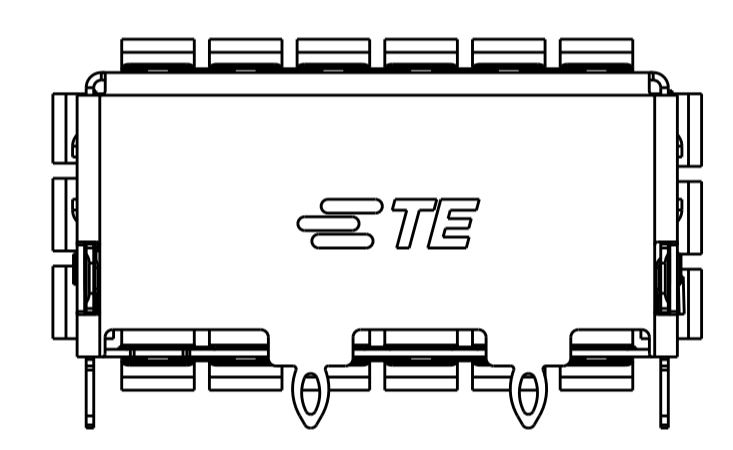

2 REAR LEGS VERSION
SCALE 4:1

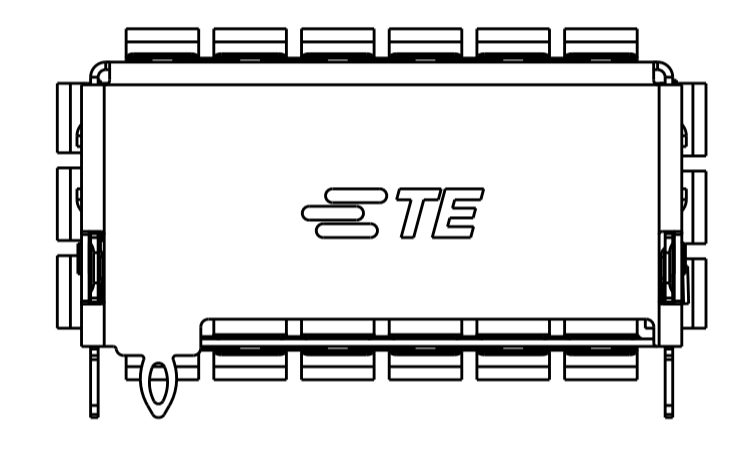

1 REAR LEG VERSION
SCALE 4:1

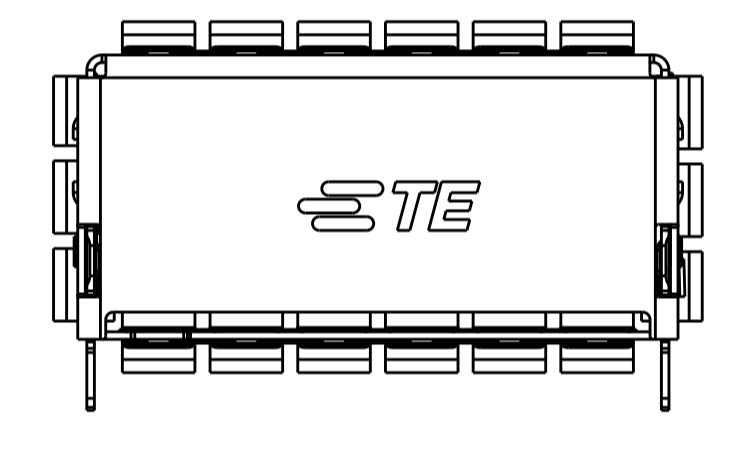

0 REAR LEG VERSION
SCALE 4:1

INSULATING TAPE OPTIONS

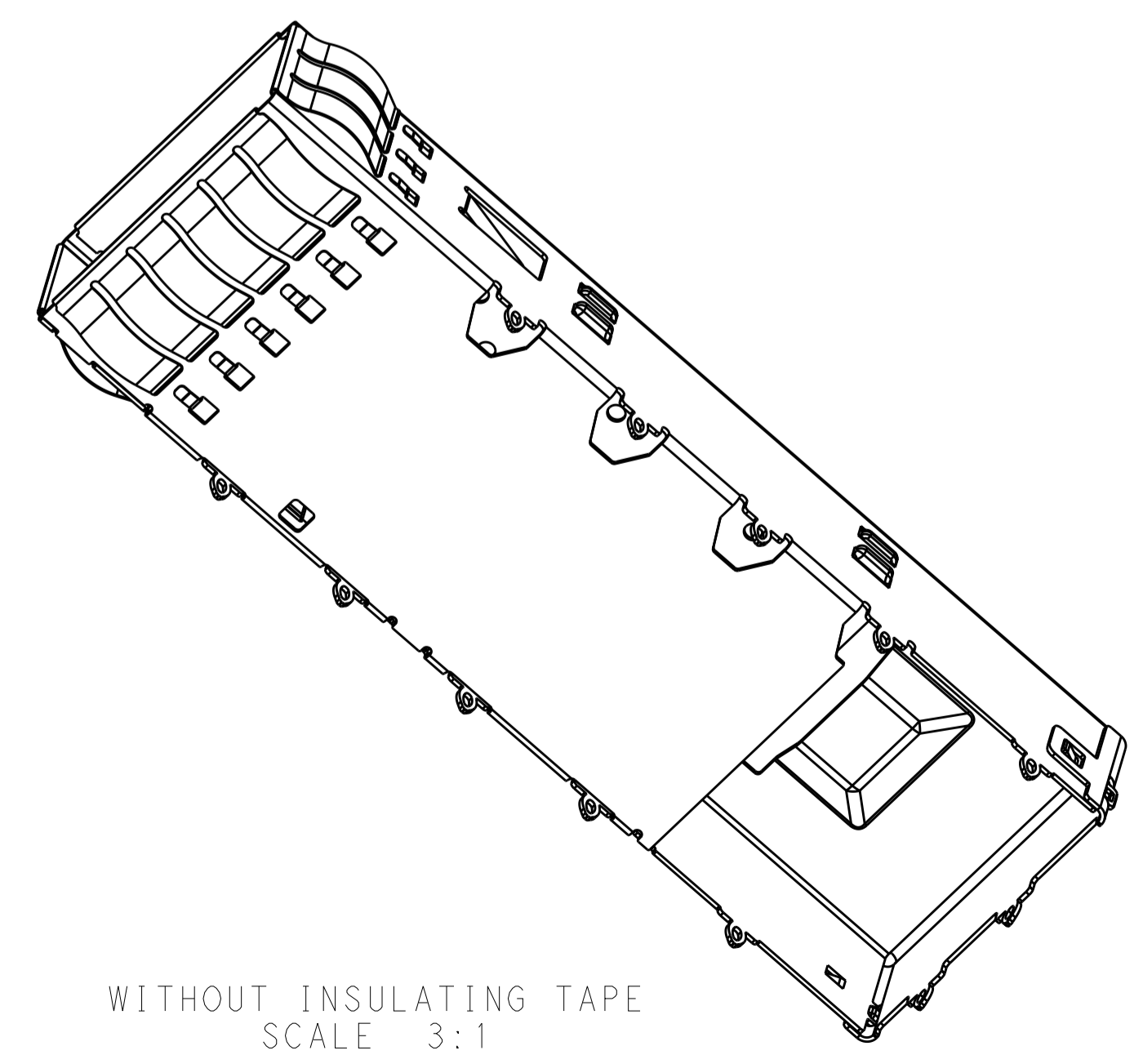

WITHOUT INSULATING TAPE
SCALE 3:1

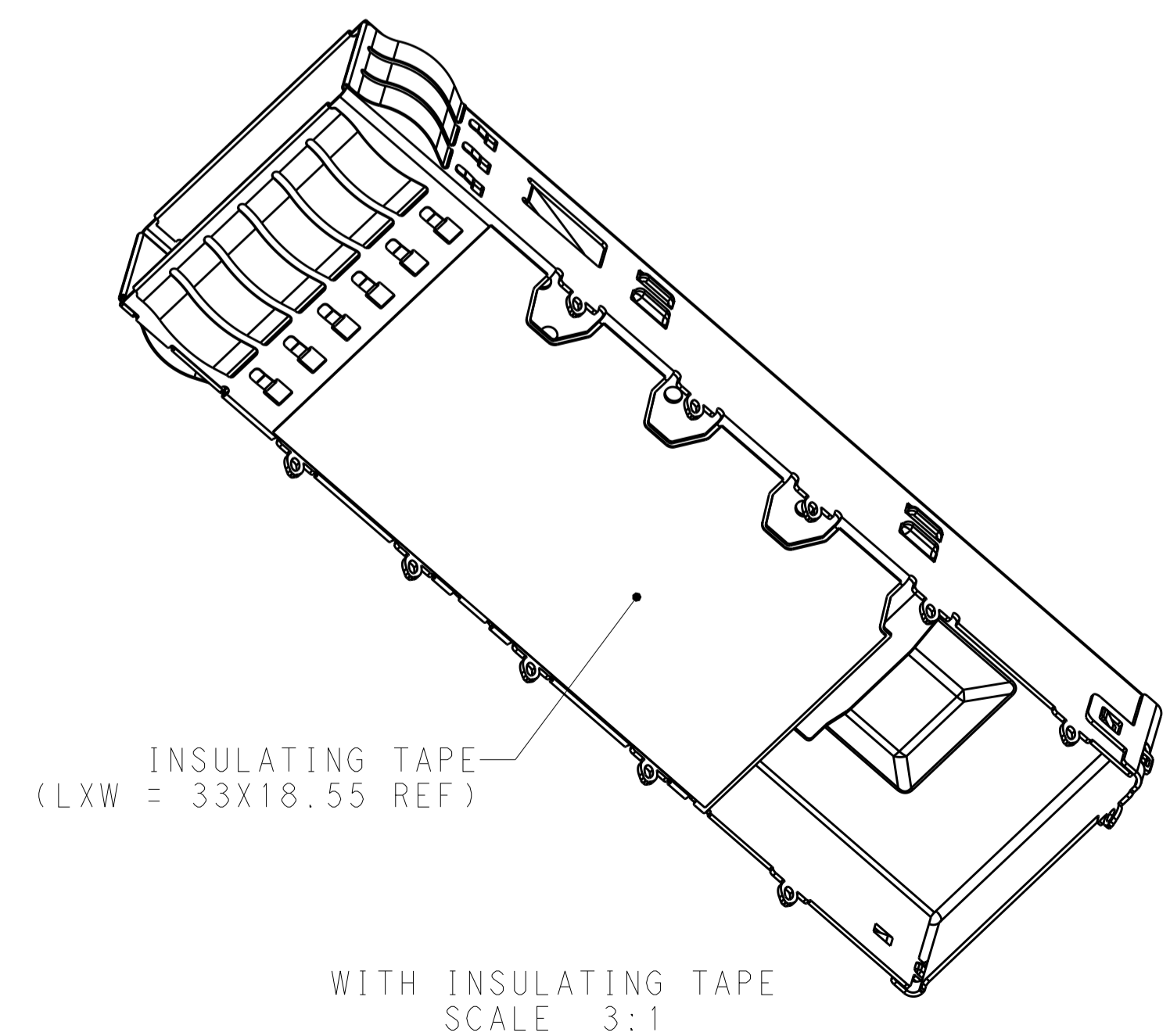

INSULATING TAPE
(LXW = 33X18.55 REF)

WITH INSULATING TAPE
SCALE 3:1

THIS DRAWING IS A CONTROLLED DOCUMENT.		DMN: JASON YANG 23SEP2013	TE Connectivity
		CHK: SEAN HAN 29JAN2016	
DIMENSIONS:		NAME: CAGE ASSEMBLY, QSPF28 1X1, THRU BEZEL WITH EMI SPRING FINGER	
TOLERANCES UNLESS OTHERWISE SPECIFIED:		PRODUCT SPEC: 108-19428	
mm		APPLICATION SPEC: 114-32023	
0 PLC ±0.25		SIZE: A1	
1 PLC ±0.25		CAGE CODE: 00779	
2 PLC ±0.20		DRAWING NO: C=2170703	
3 PLC ±0.100		RESTRICTED TO: -	
4 PLC ±		WEIGHT: -	
ANGLES ±°		CUSTOMER DRAWING	
FINISH: -		SCALE: 2:1	
MATERIAL: -		SHEET: 2 OF 6	
FINISH: -		REV: B	

LOC		DIST		REVISIONS			
P.	LTN	DESCRIPTION	DATE	DWN	APVD		
-	-	SEE SHEET 1	-	-	-		

SPRING FINGER OPTIONS

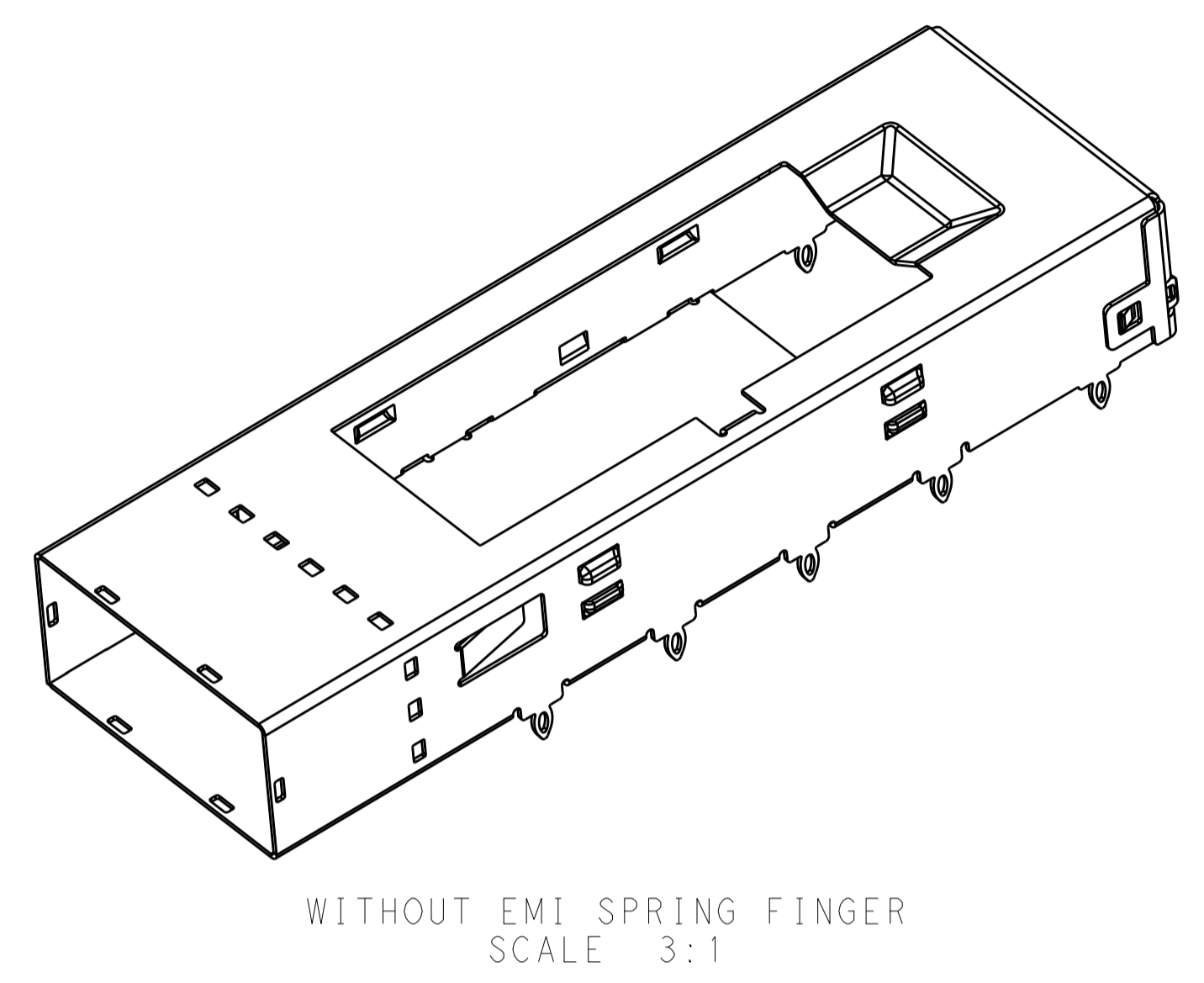
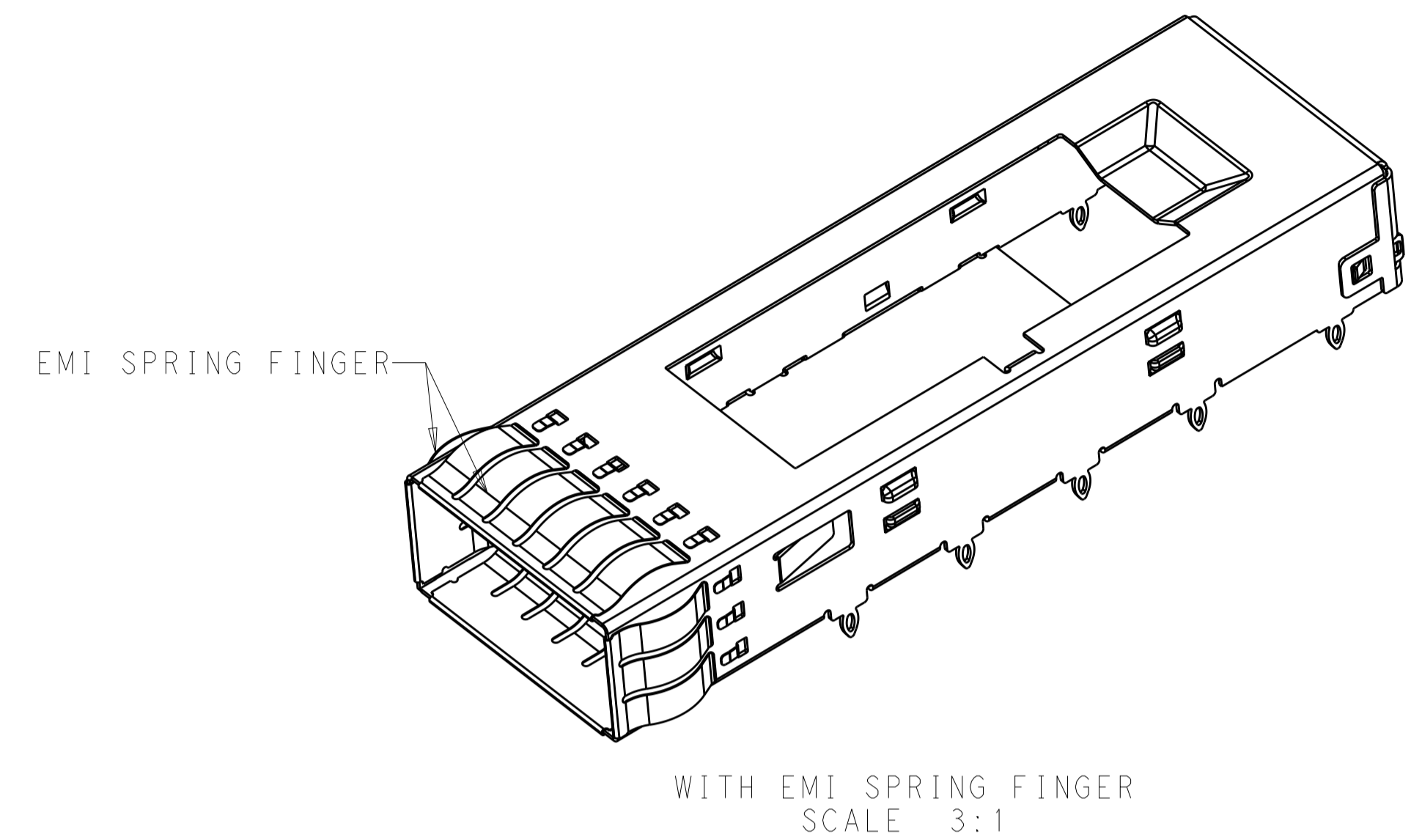

THIS DRAWING IS A CONTROLLED DOCUMENT.		DWN	JASON YANG	23SEP2013		TE Connectivity
		CHK	SEAN HAN	29JAN2016		
DIMENSIONS:		TOLERANCES UNLESS OTHERWISE SPECIFIED:		NAME		
mm	0 PLC ±0.25	1 PLC ±0.25		CAGE ASSEMBLY, QSFP28 1X1, THRU BEZEL		
	2 PLC ±0.25	3 PLC ±0.25		WITH EMI SPRING FINGER		
	4 PLC ±0.100	ANGLES		SIZE CAGE CODE DRAWING NO		
	FINISH	WEIGHT		A100779C=2170703		
MATERIAL		CUSTOMER DRAWING		RESTRICTED TO		
		SCALE 2:1		SHEET 3 OF 6 REV B		

LOC		DIST		REVISIONS			
P	LTN	DESCRIPTION	DATE	DWN	APVD		
-	-	SEE SHEET 1	-	-	-		

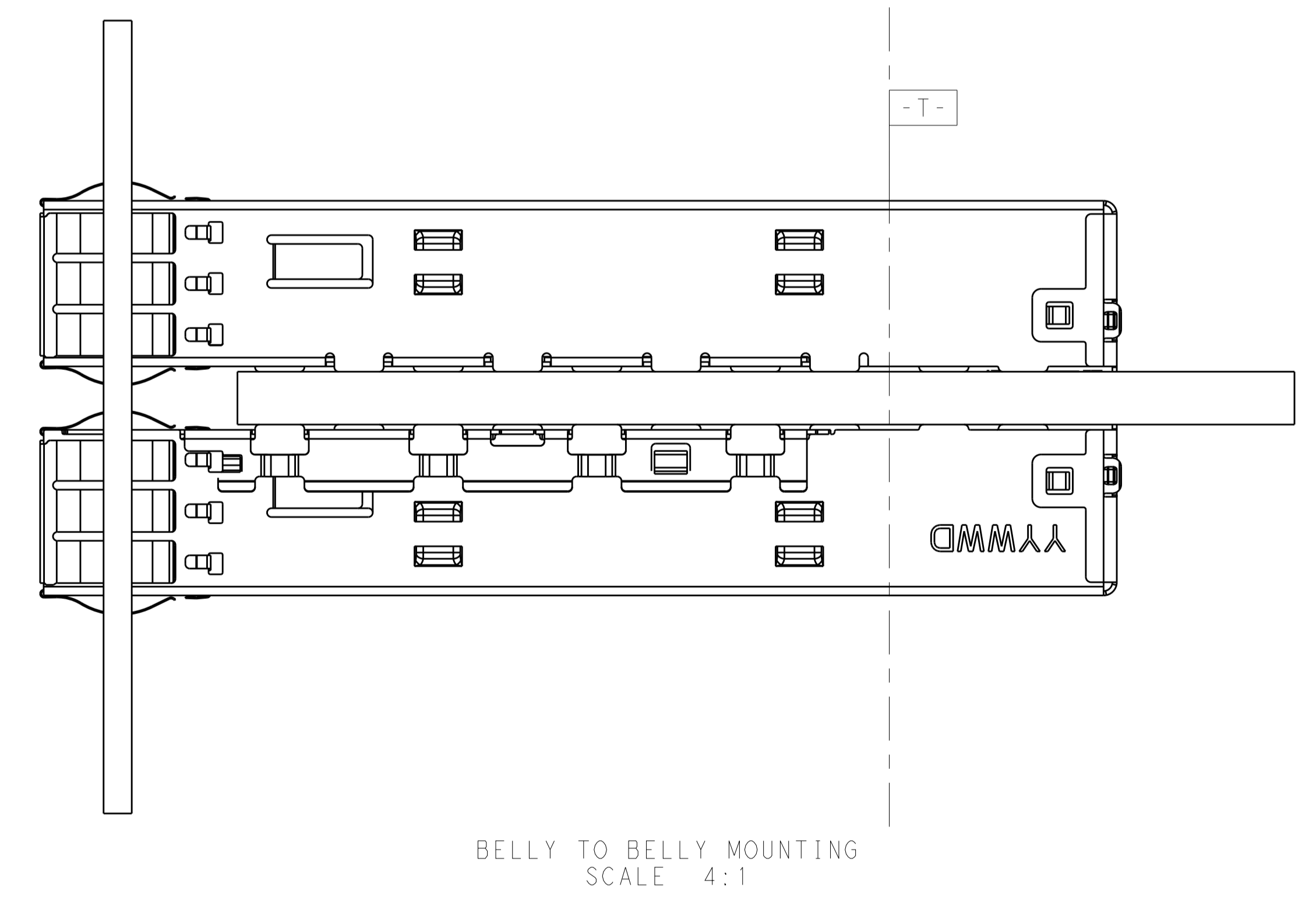
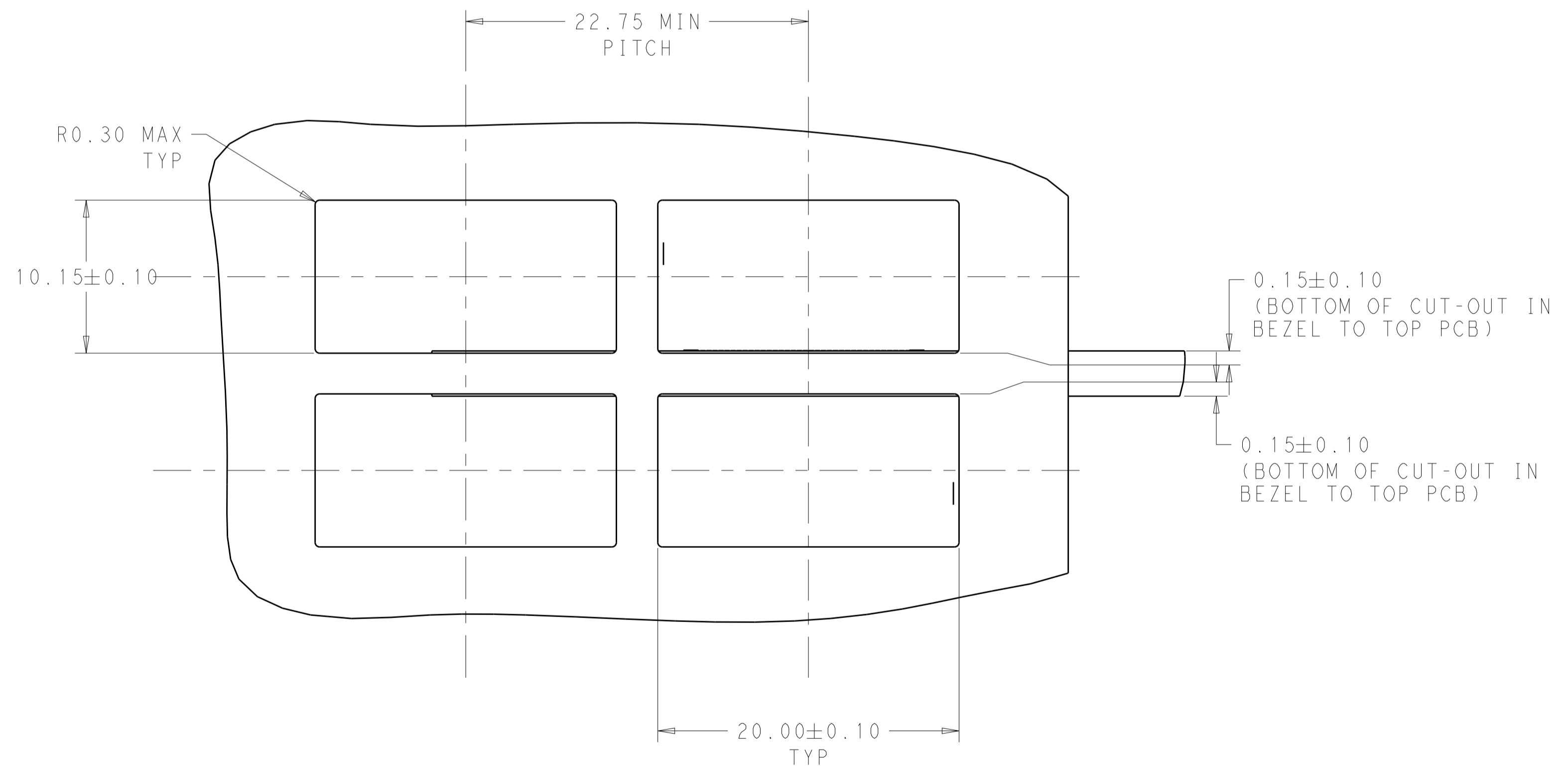
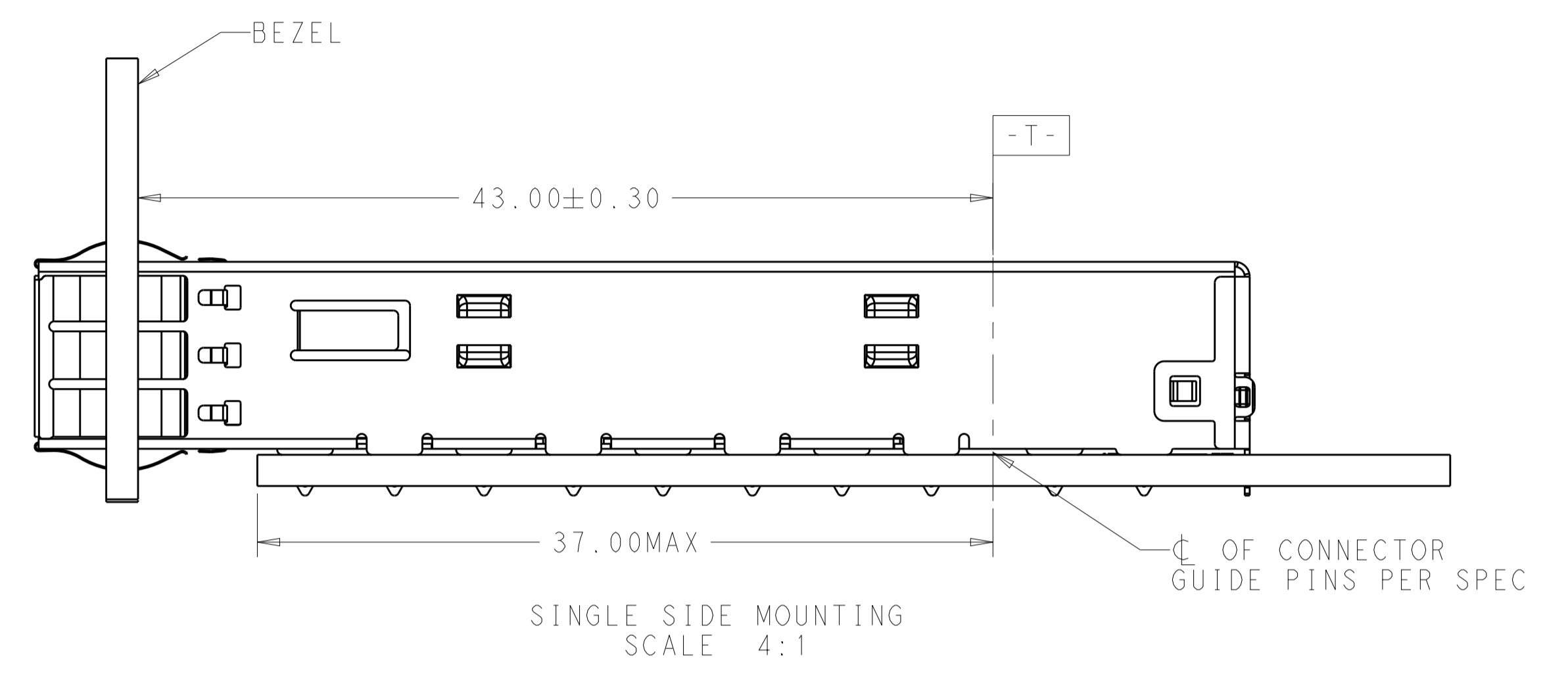
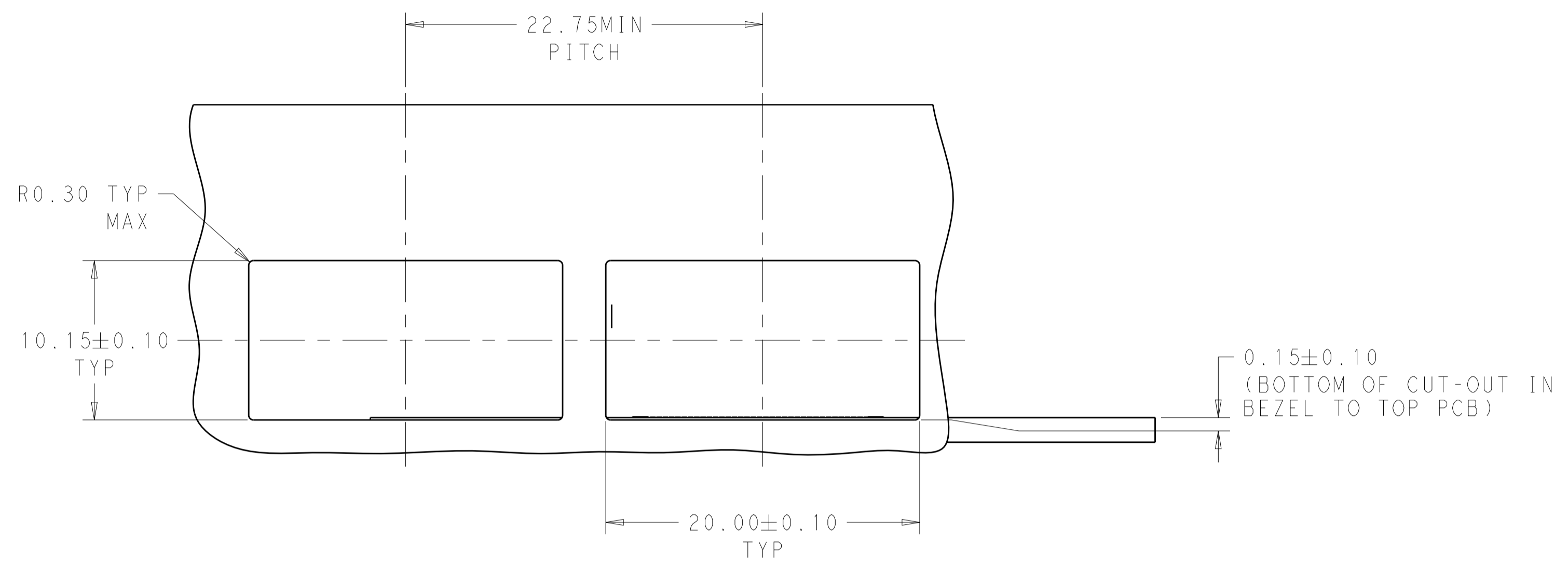

THIS DRAWING IS A CONTROLLED DOCUMENT.		DWN	JASON YANG	23SEP2013		NAME CAGE ASSEMBLY, QSFP28 1X1, THRU BEZEL WITH EMI SPRING FINGER
DIMENSIONS:		CHK	SEAN HAN	29JAN2016		
mm	0 PLC ±0.25	APVD			PRODUCT SPEC	108-19428
	2 PLC ±0.25	APVD			APPLICATION SPEC	114-32023
	3 PLC ±0.20	APVD			SIZE	A100779C=2170703
	4 PLC ±0.100	APVD			WEIGHT	
	ANGLES ±°	APVD			CUSTOMER DRAWING	SCALE 2:1 SHEET 4 OF 6 REV B
MATERIAL	FINISH	APVD				

LOC	DIST	REV	DATE	BY	APPV
		1			

REVISIONS		DATE	BY	APPV
1	SEE SHEET 1			

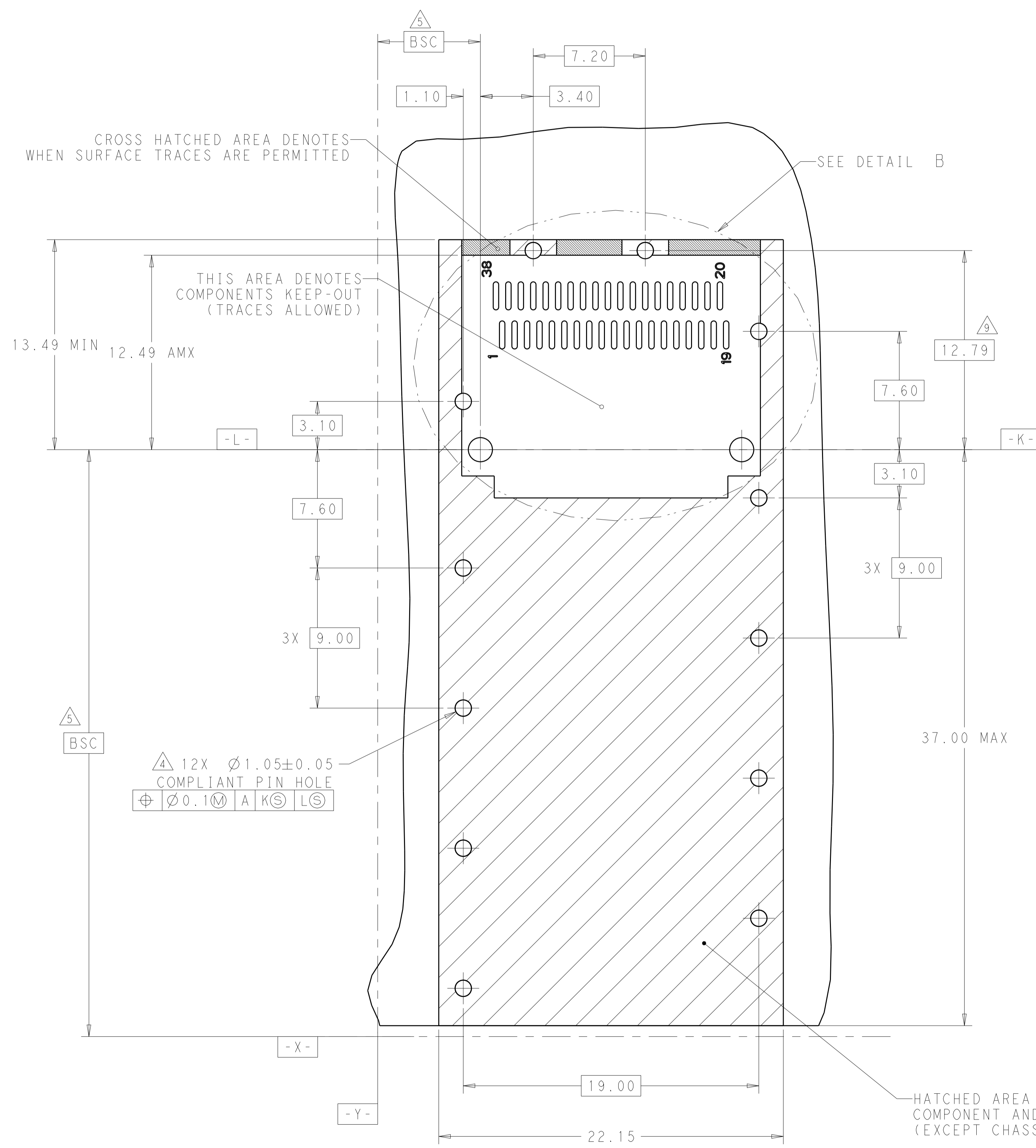

RECOMMENDED PCB LAYOUT
 SINGLE TYPE OF 2 REAR HOLES OF LEGS
 PCB TOLERANCE: ±0.05
 SCALE 6:1

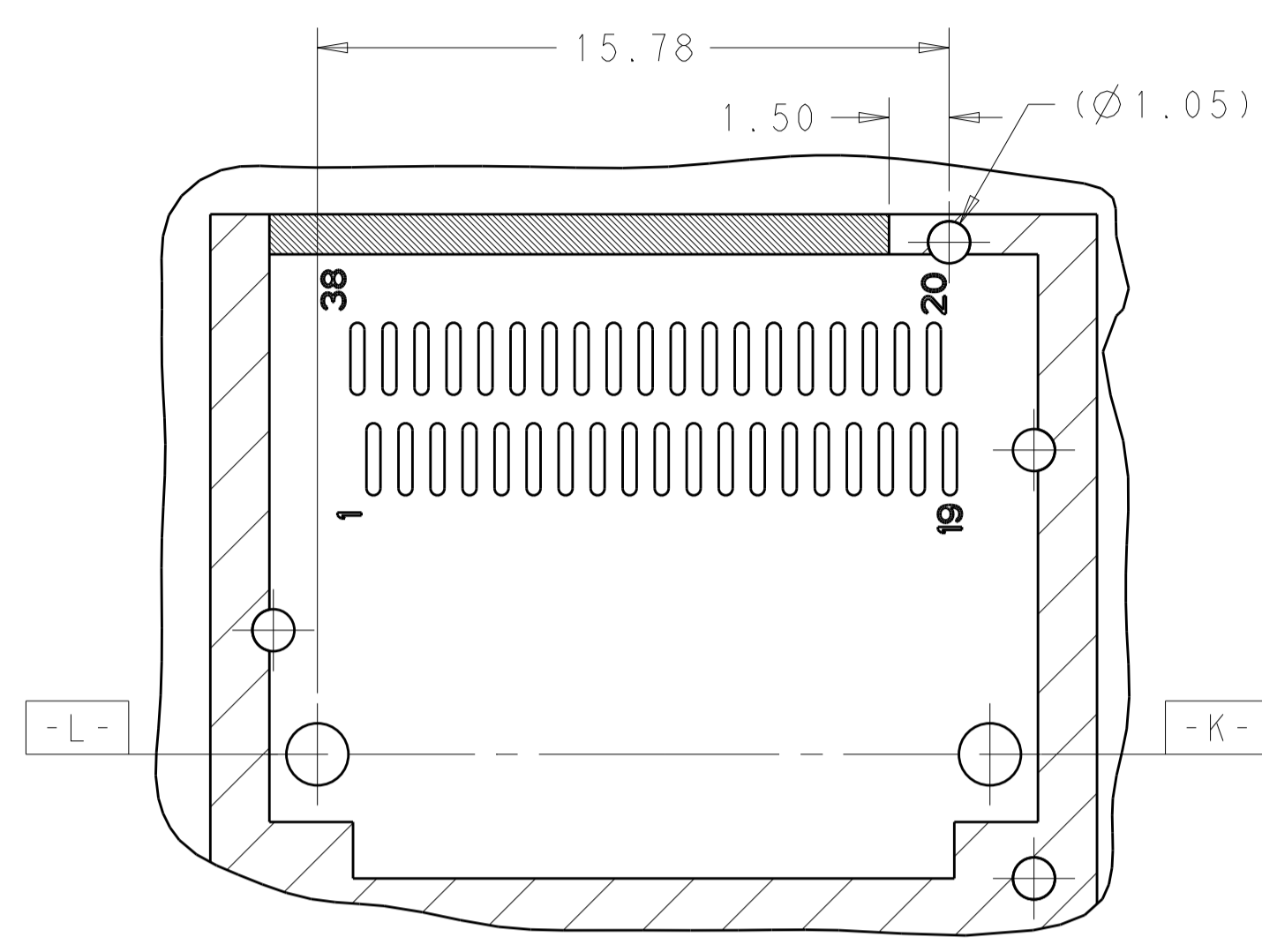

RECOMMENDED PCB LAYOUT
 SINGLE TYPE OF 1 REAR HOLES OF LEGS
 PCB TOLERANCE: ±0.05
 SCALE 6:1

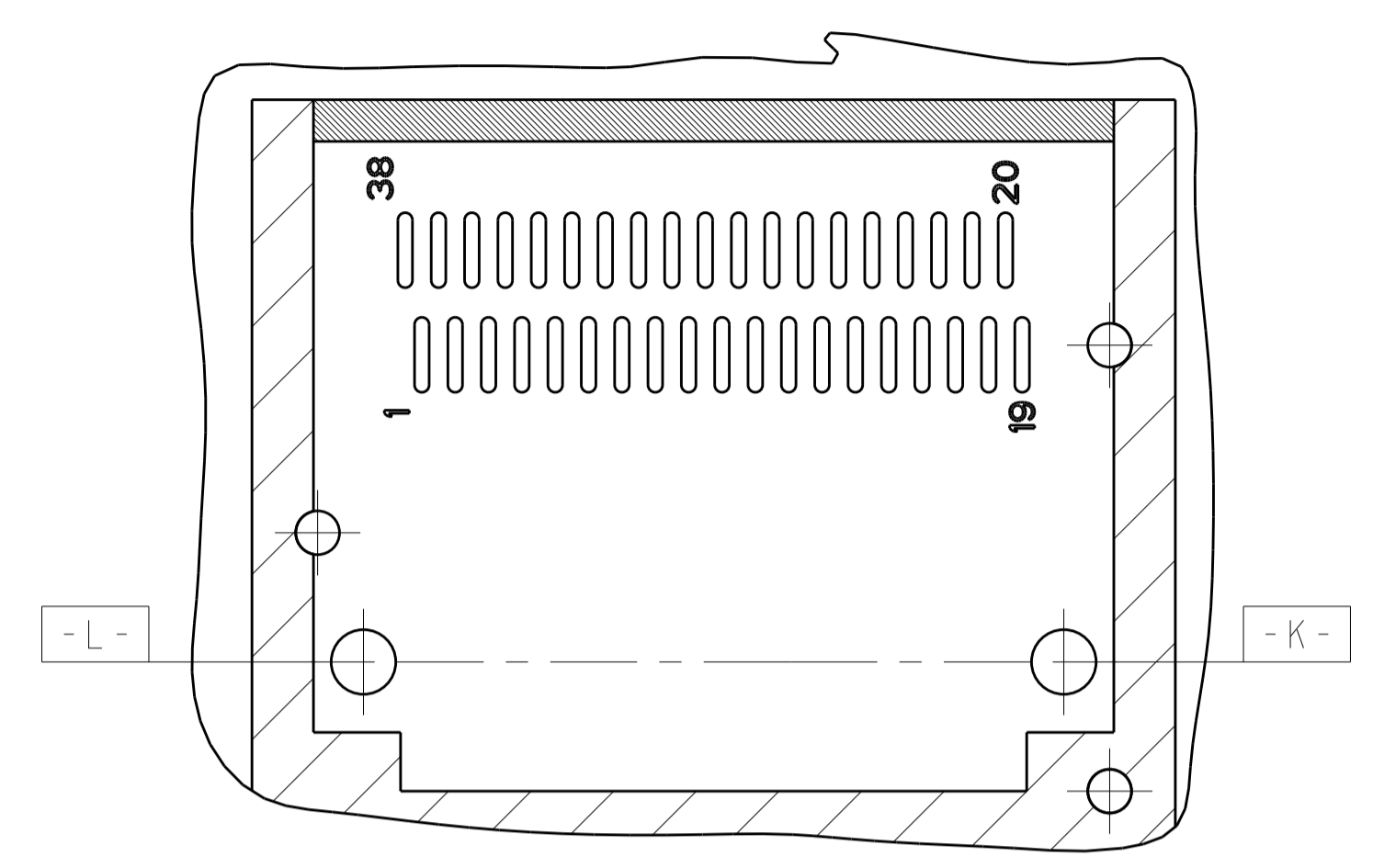

RECOMMENDED PCB LAYOUT
 SINGLE TYPE OF 0 REAR HOLES OF LEGS
 PCB TOLERANCE: ±0.05
 SCALE 6:1

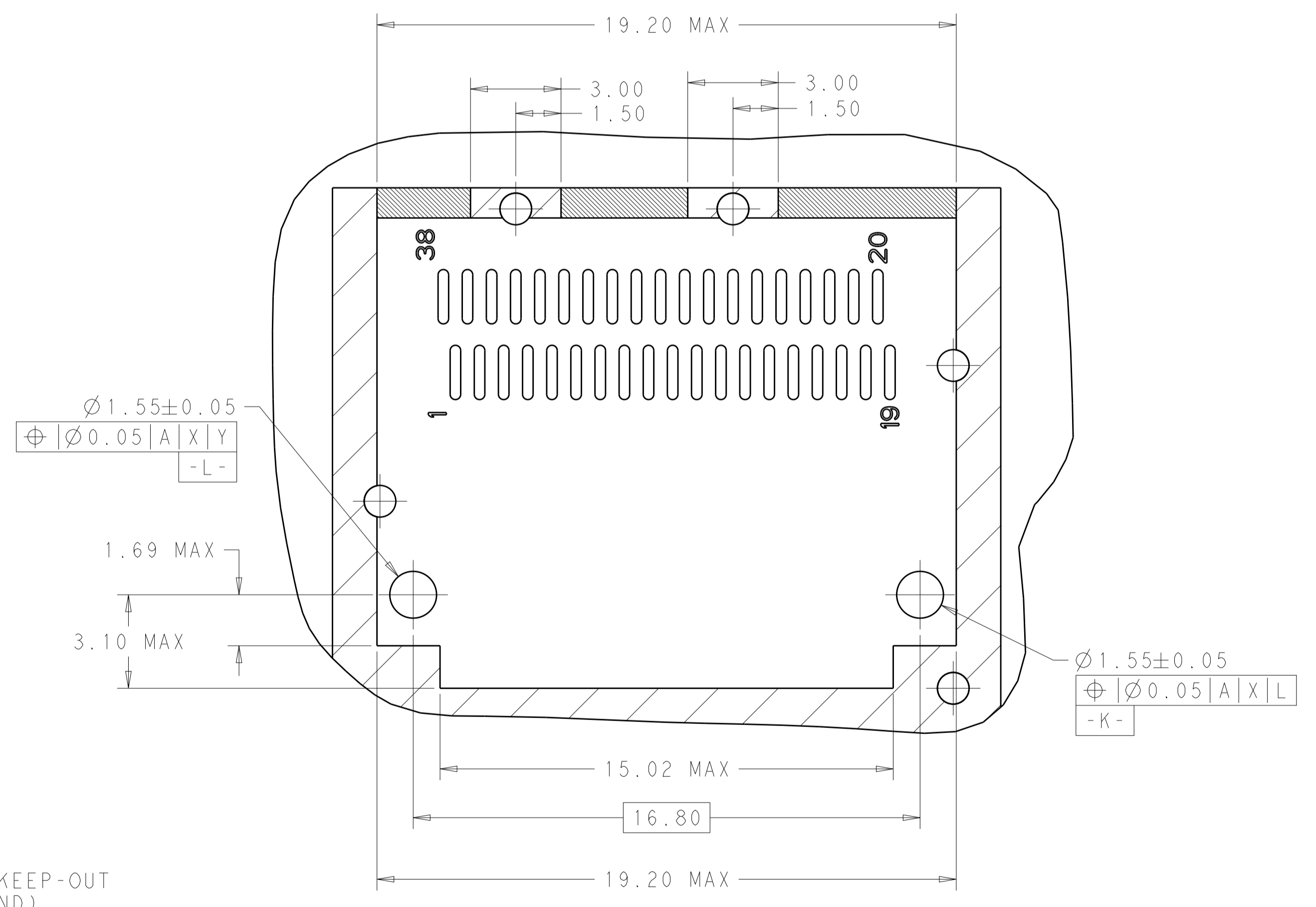

DETAIL B
 SCALE 8:1

HATCHED AREA DENOTES COMPONENT AND TRACE KEEP-OUT (EXCEPT CHASSIS GROUND)

THIS DRAWING IS A CONTROLLED DOCUMENT.		OWN: JASON YANG 23SEP2013	TE Connectivity
		CHK: SEAN HAN 29JAN2016	
DIMENSIONS:	TOLERANCES UNLESS OTHERWISE SPECIFIED:	APVD:	NAME:
mm	0 PLC ±0.25	PRODUCT SPEC	CAGE ASSEMBLY, QSFP28 1X1, THRU BEZEL
	1 PLC ±0.25	108-19428	WITH EMI SPRING FINGER
	2 PLC ±0.20	APPLICATION SPEC	
	3 PLC ±0.100	114-32023	SIZE: CAGE CODE: DRAWING NO:
	4 PLC ±	WEIGHT:	A100779C=2170703
	ANGLES	CUSTOMER DRAWING	RESTRICTED TO:
MATERIAL:	FINISH:	SCALE 2:1	SHEET 5 OF 6 REV B

LOC	DIST	REVISIONS	DATE	DMN	APVD
		SEE SHEET 1			

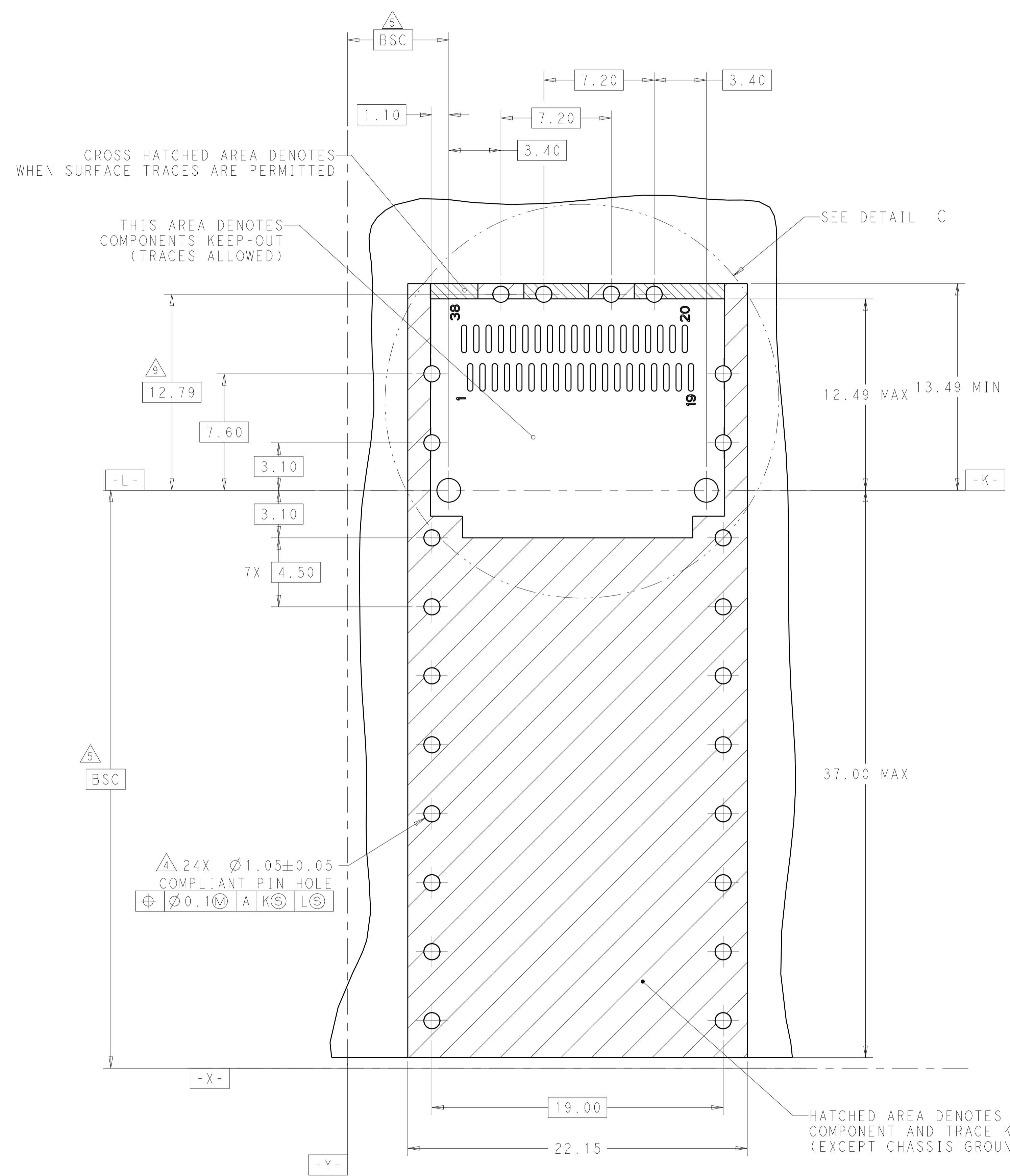

RECOMMENDED PCB LAYOUT
BELLY TO BELLY TYPE OF 2 REAR HOLES OF LEGS
PCB TOLERANCE: ±0.05
SCALE 6:1

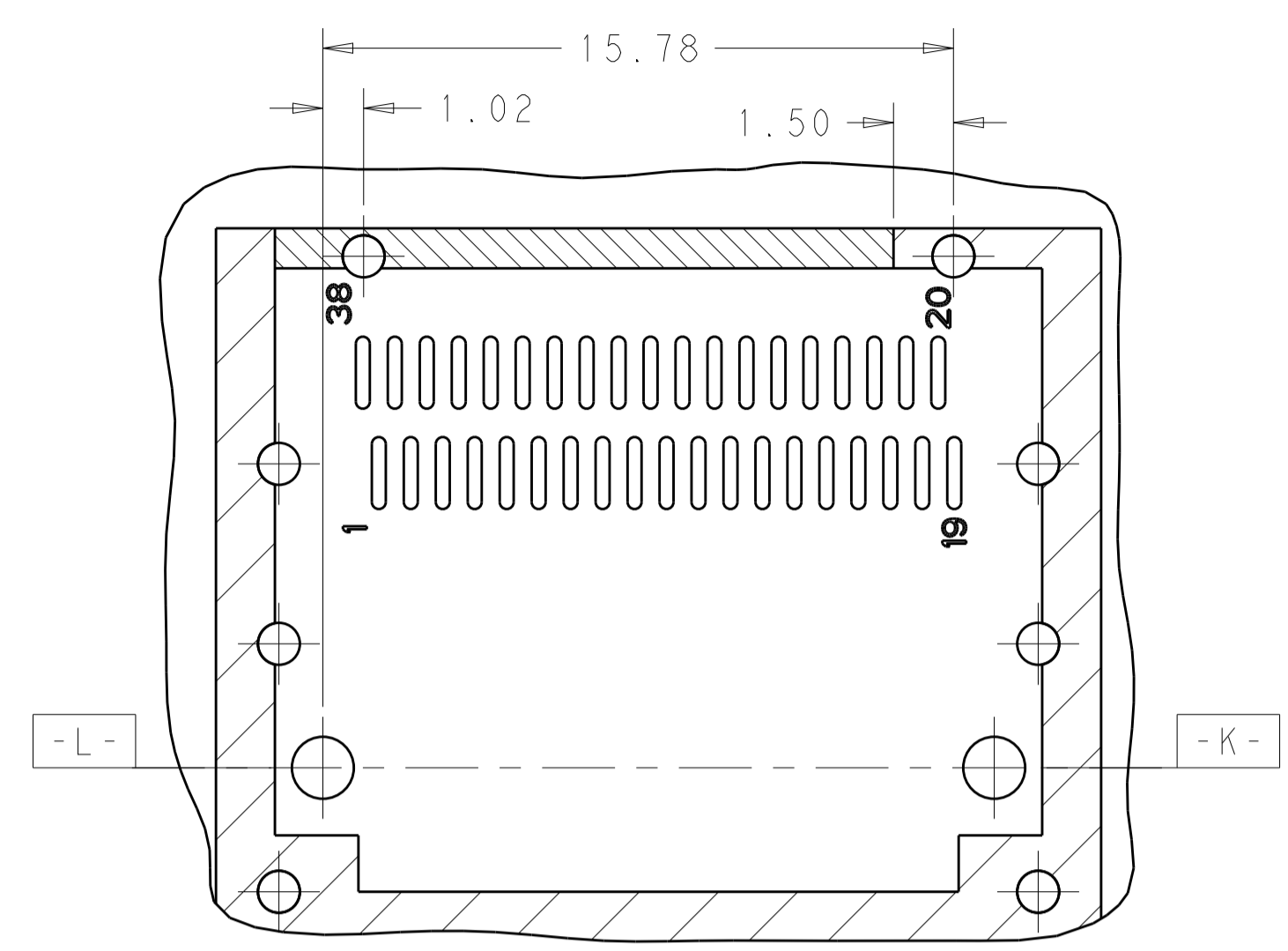

RECOMMENDED PCB LAYOUT
BELLY TO BELLY TYPE OF 1 REAR HOLES OF LEGS
PCB TOLERANCE: ±0.05
SCALE 6:1

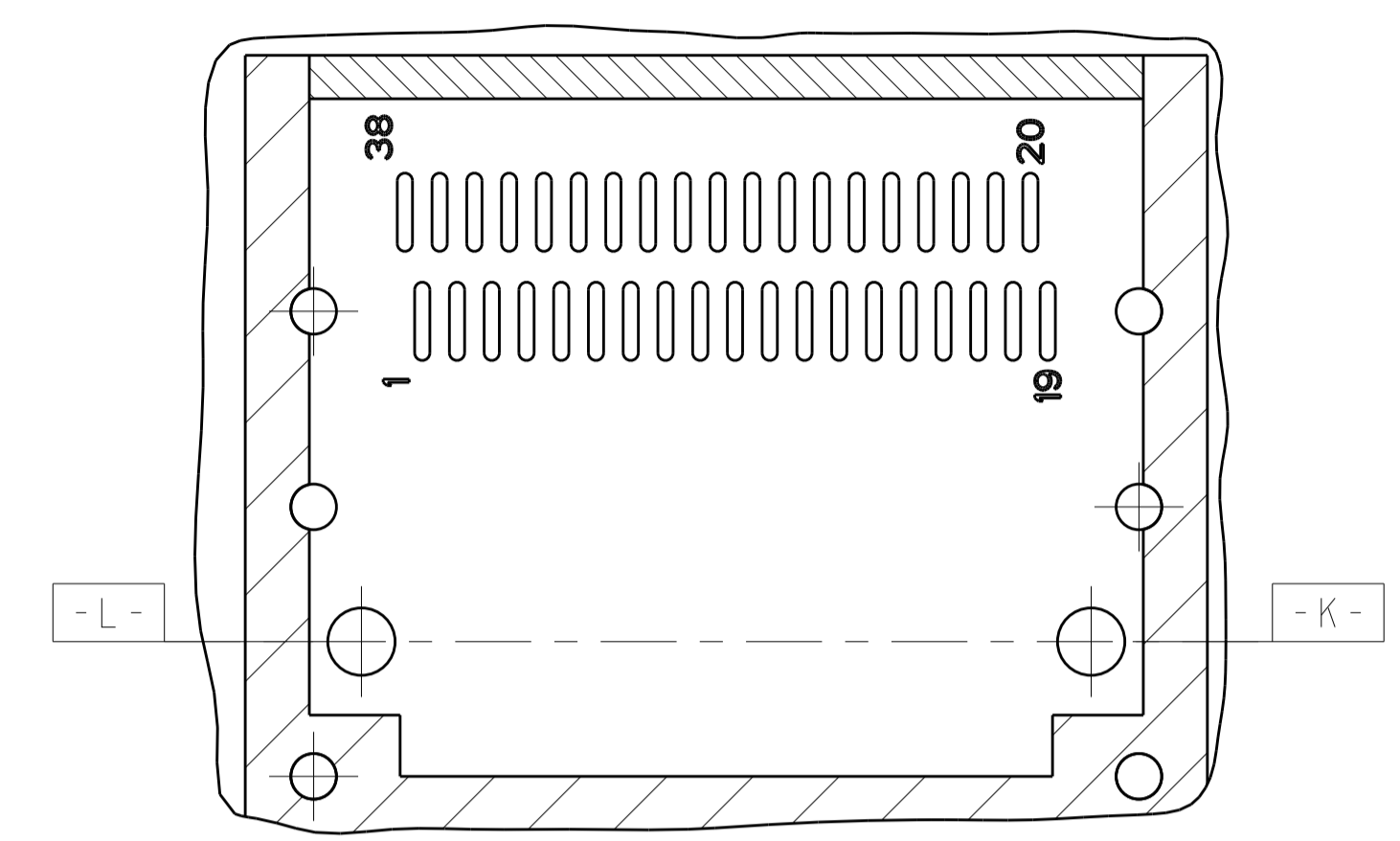

RECOMMENDED PCB LAYOUT
BELLY TO BELLY TYPE OF 0 REAR HOLES OF LEGS
PCB TOLERANCE: ±0.05
SCALE 6:1

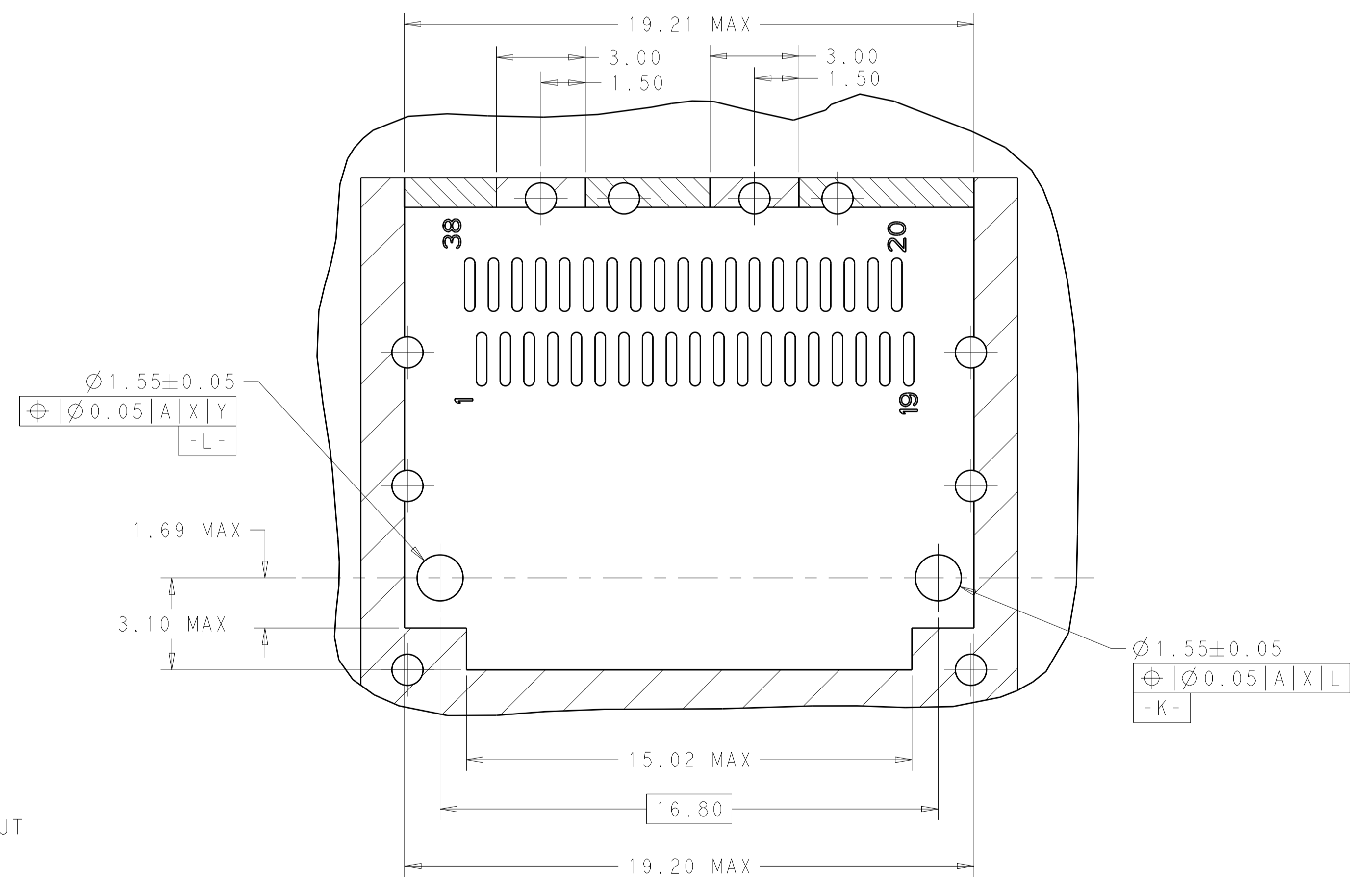

DETAIL C
SCALE 8:1

THIS DRAWING IS A CONTROLLED DOCUMENT.		DMN: JASON YANG 23SEP2013	TE Connectivity
DIMENSIONS: mm		CHK: SEAN HAN 29JAN2016	
TOLERANCES UNLESS OTHERWISE SPECIFIED:		APVD: -	NAME: CAGE ASSEMBLY, QSFP28 1X1, THRU BEZEL WITH EMI SPRING FINGER
0 PLC ±0.25	1 PLC ±0.25	PRODUCT SPEC: 108-19428	SIZE: A1
2 PLC ±0.20	3 PLC ±0.100	APPLICATION SPEC: 114-32023	CAGE CODE: 2170703
4 PLC ±	ANGLES ±	WEIGHT: -	RESTRICTED TO: -
MATERIAL: -	FINISH: -	CUSTOMER DRAWING	SCALE: 2:1 SHEET 6 OF 6 REV B