

PART NUMBER	TAIL PLATING	TAIL TYPE
10078902-001LF	Sn	PRESS-FIT

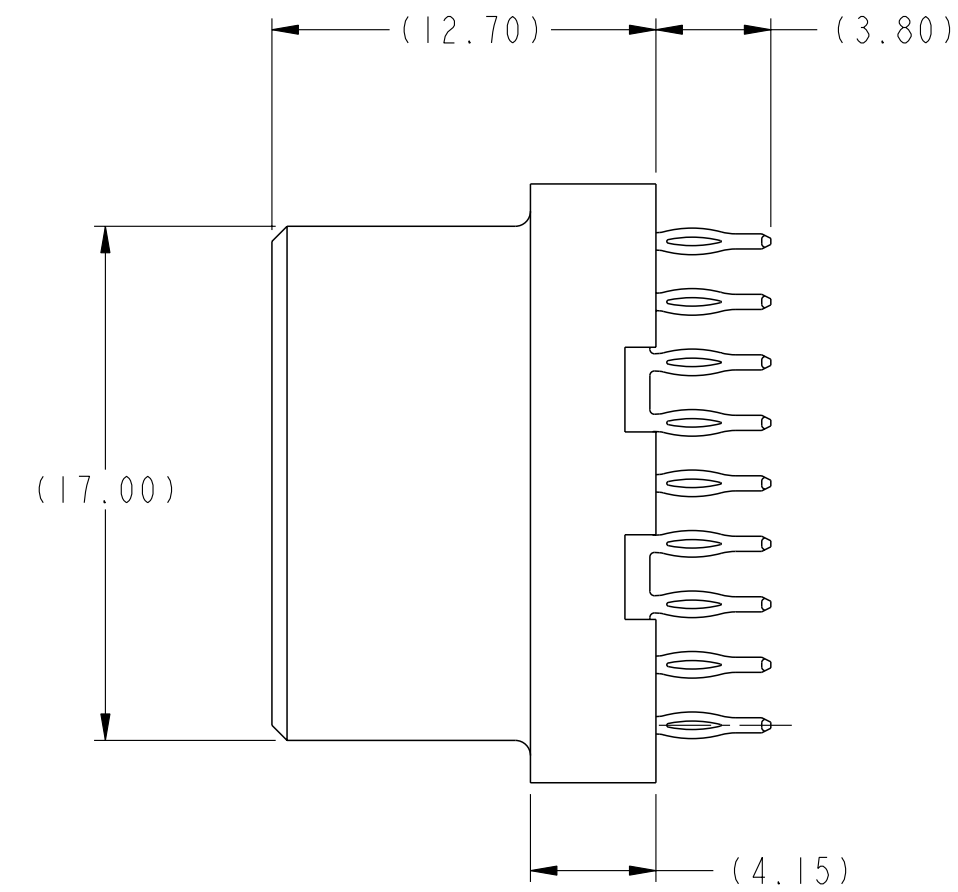
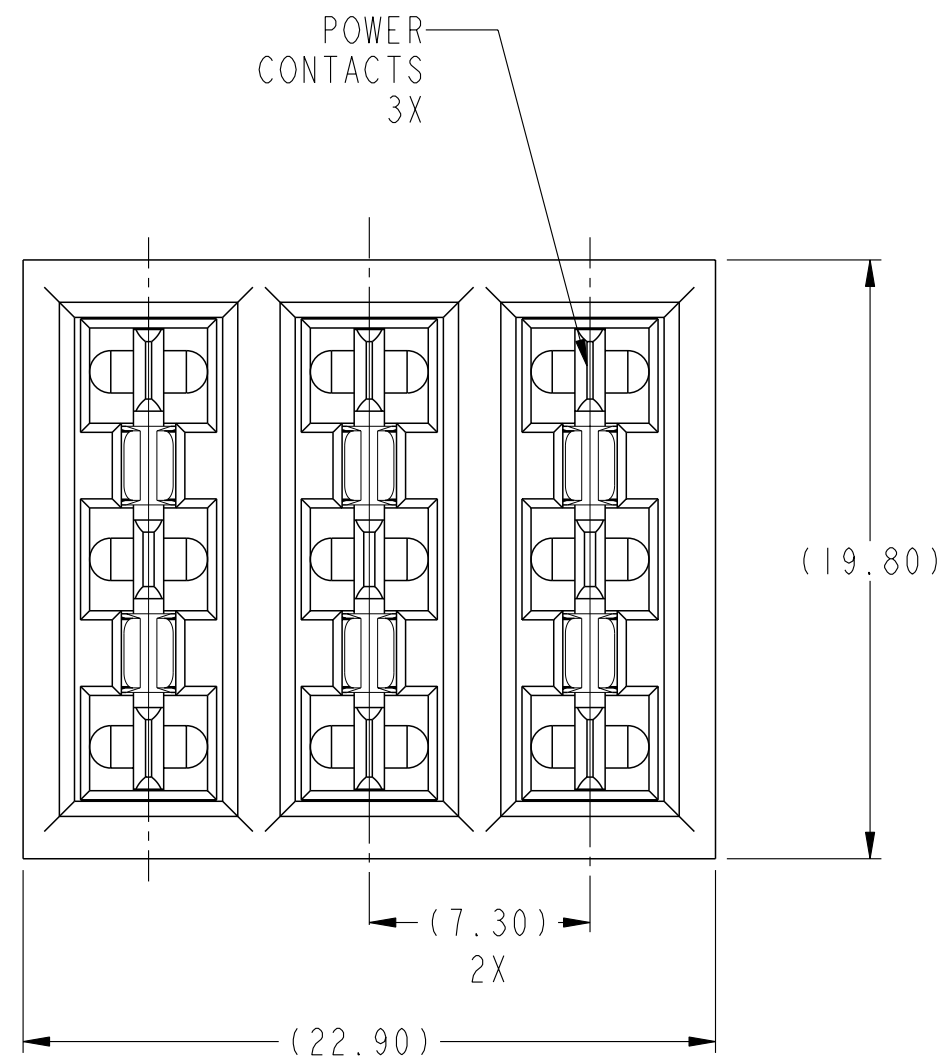
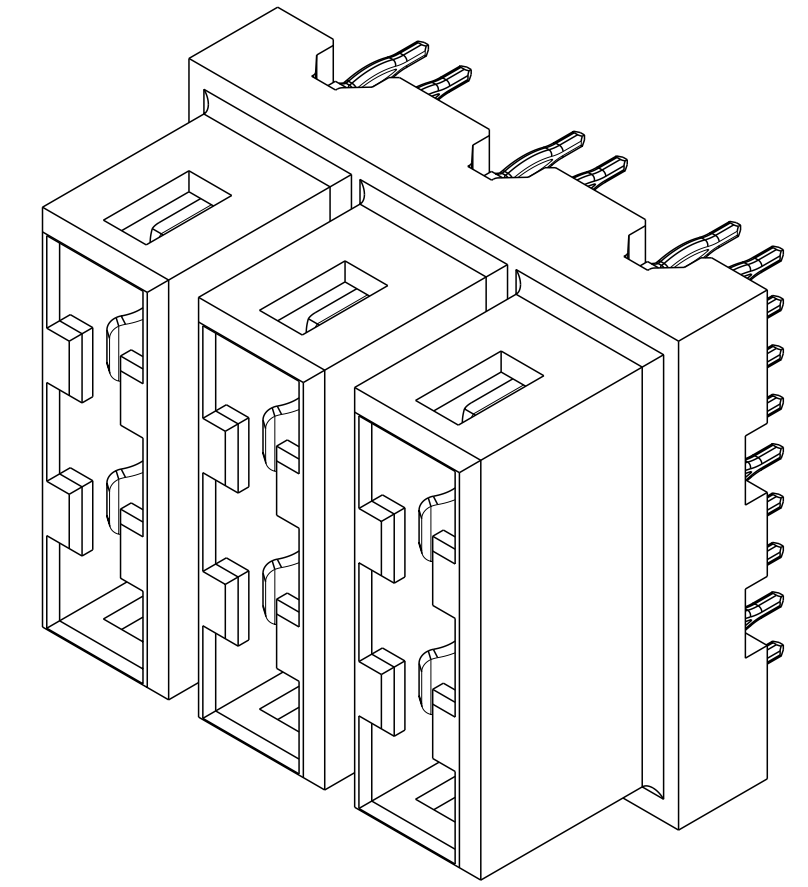
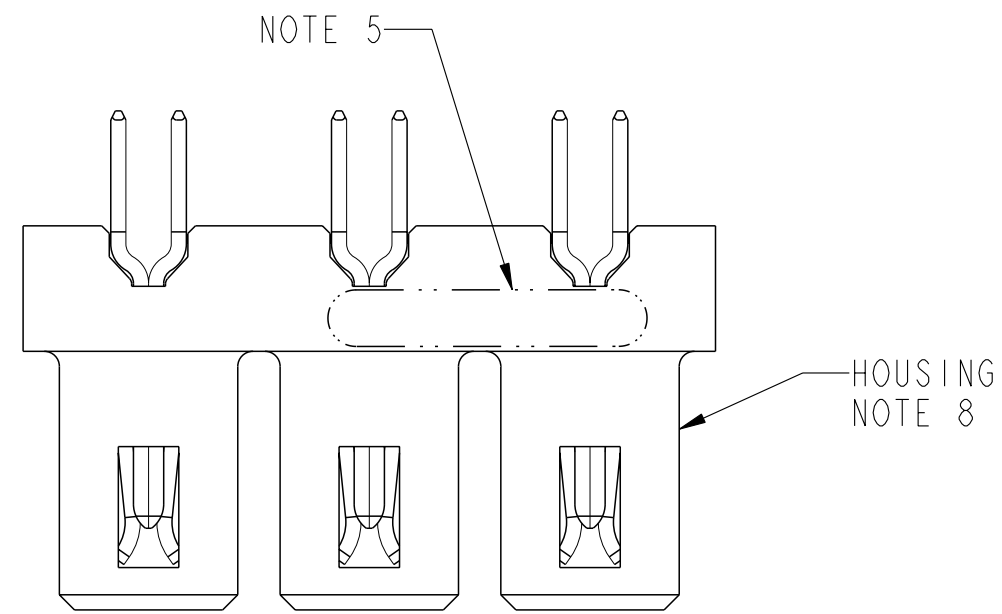

rev	ecn no	dr	date
A	V09-0207	TH	2009-04-29
B	V09-0213	TH	2009-05-04
-	-	-	-
-	-	-	-
-	-	-	-
-	-	-	-

www.fciconnect.com		surface ASME Y14.5	tolerance std ASME Y14.5	projection ASME Y14.5	MM
TOLERANCES UNLESS OTHERWISE SPECIFIED					
Dr	W. J. SWAIN	2007-06-18	ANGULAR	0.X	±.3
Eng	W. J. SWAIN	2007-06-18	LINEAR	0.XX	±.10
Chr	W. J. SWAIN	2007-06-18	0° ±2°	0.XXX	±.050
Appr	H. NGO	2008-05-05	Product family		HCI
FCJ			title		ASSEMBLY, RECEPT, VERT, 3 POSN ISOLATED POWER CONTACT
-			catlog no	CUSTOMER	sheet 1 of 2
-			dwg no	10078902	Rev. B

Copyright FCJ. FCJ

TOP LAYER DESCRIPTION	TABLE 1 (HCI POWER) PLATED THROUGH-HOLE REQUIREMENTS							
	DRILLED HOLE DIAMETER	COPPER THICKNESS	TIN-LEAD THICKNESS	NICKEL THICKNESS	GOLD THICKNESS	TIN THICKNESS	SILVER THICKNESS	FINISHED HOLE DIAMETER
TIN-LEAD	0.81-0.86 (0.85 DRILL)	0.025 - 0.050	0.005 - 0.015	--	--	--	--	0.65 - 0.80
IMMERSION TIN	0.81-0.86 (0.85 DRILL)	0.025 - 0.050	--	--	--	0.9 - 1.5um	--	0.70 - 0.80
IMMERSION SILVER	0.81-0.86 (0.85 DRILL)	0.025 - 0.050	--	--	--	--	0.15 - 0.65um	0.70 - 0.80
COPPER (SEE NOTE 9)	0.81-0.86 (0.85 DRILL)	0.025 - 0.050	--	--	--	--	--	0.70 - 0.80
GOLD	0.81-0.86 (0.85 DRILL)	0.025 - 0.050	--	0.003 - 0.007	FLASH UP TO 0.0002	--	--	0.69 - 0.80

- NOTES:
- CONNECTOR MATERIALS:  
HOUSING: HIGH TEMPERATURE THERMOPLASTIC, BLACK  
UL 94V-0 COMPLIANT  
CONTACTS: HIGH PERFORMANCE COPPER ALLOY
  - CONTACT FINISH (Ref. GS-12-380 SECTION 5.2)
  - PRODUCT SPECIFICATION: GS-12-380.
  - APPLICATION SPECIFICATION: GS-20-070.
  - PRODUCT MARKING (PRODUCT NUMBER & DATE CODE) ON HOUSING IN AREA SHOWN.
  - MINIMUM NOMINAL PCB THICKNESS: 1.6mm
  - PACKAGING MEETS FCI SPECIFICATION GS-14-1194
  - HOUSING COMPONENT WILL WITHSTAND EXPOSURE TO 260°C PEAK TEMPERATURE FOR 60 SECONDS IN A CONVECTION, INFRA-RED, OR VAPOR PHASE REFLOW OVEN.
  - COPPER PLATING THICKNESS IN CENTER OF VIA-HOLE CAN BE NO MORE THAN 0.003 LESS THAN OTHER AREAS.
  - ALL HOLE SIZES ARE FINISHED HOLE SIZES UNLESS OTHERWISE NOTED.

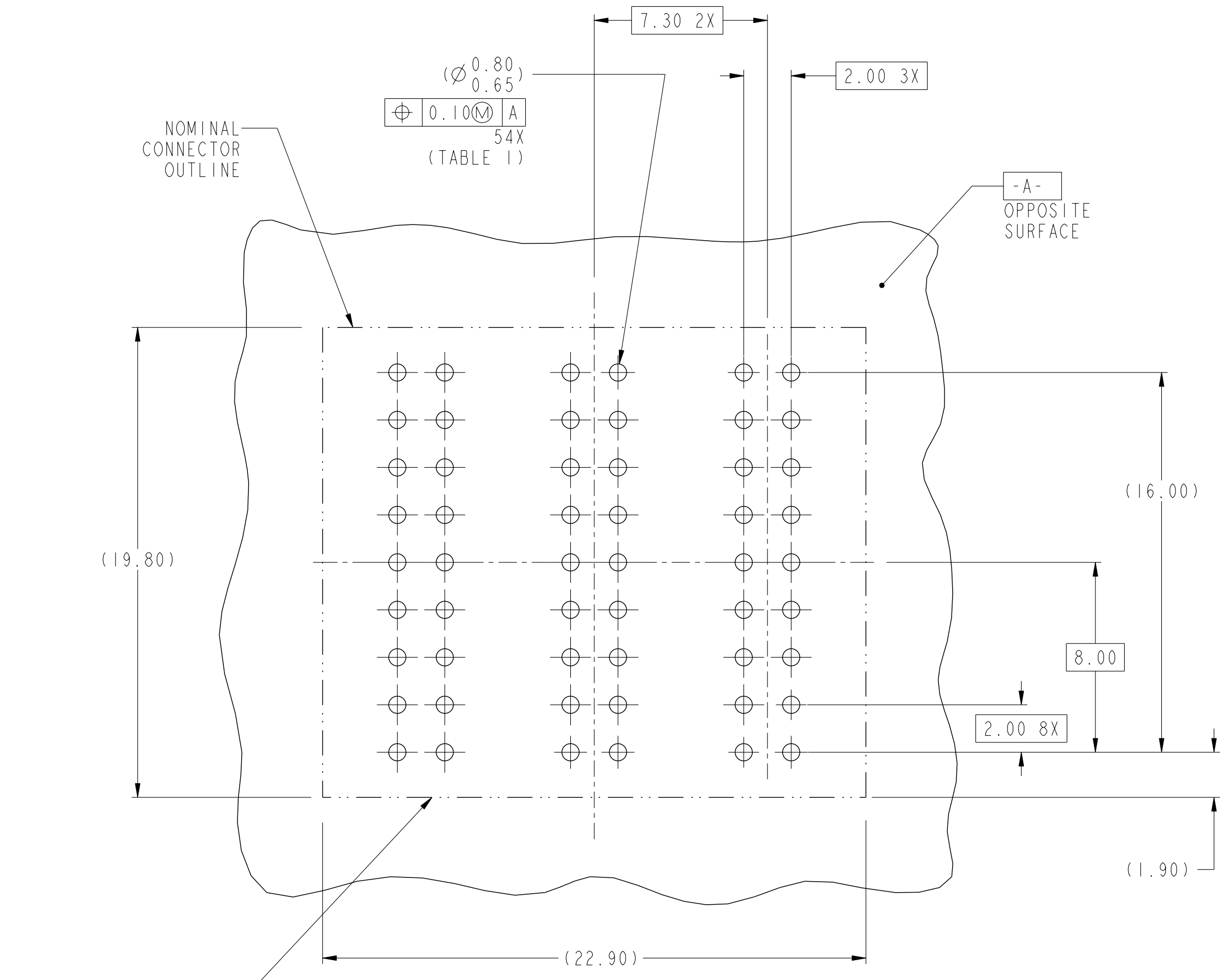

TOP SURFACE OF DAUGHTER CARD

**RECOMMENDED PCB LAYOUT  
COMPONENT SIDE  
NOTE 6**

Copyright FCI.  
**FCI**

<b>FCI</b>	TITLE	ASSEMBLY, RECEPT, VERT,	dwg no	10078902	Rev.	B
		3 POSN ISOLATED POWER CONTACT				
	CATALOG NO			CUSTOMER	sheet 2 of 2	