

PART NUMBER	REV	FIRST USED
567960-1	A	854040-3

TERMINAL NAME: DUAC CONTACT SOCKET					
VISIBLE PAD LTR	CRIMP DATA (AMP TERMINAL)		WIRE SIZE		
	CRIMP HEIGHT	WIRE SIZE			
A	.031 ±.002 [0.79 ±0.05mm]	22			
B	.027 ±.002 [0.69 ±0.05mm]	24			
C	.025 ±.002 [0.64 ±0.05mm]	26			
D	NOT	USED			
CRIMP	SIZE	TYPE	RANGE		
WIRE	.048 [1.22mm]	F	26-22		
INSUL	.080 [2.03mm]	F	ø.047-.069		
WIRE STRIP LENGTH	TERM APPL SPEC	FEED	APPL INSTRUCTION	SET UP GAGE	LAYOUT
.094-.126	114-19048	.472	SEE CUSTOMER MANUAL	NONE	L1768

SIM TO HDM 680307

QTY	REV	TERM	APPL SPEC	DESCRIPTION	ITEM NO
2	-	C	6-354779-8	PIN, WIRE DISC (.3330)D	129
2	-	C	6-354779-0	PIN, WIRE DISC (.3290)C	128
					127
2	-	C	7-354779-2	PIN, WIRE DISC (.3350)A	126
1	-	A	986950-1	WASHER, FLAT PRECISION	125
1	-	A	217238-3	GENERAL INSTRUCTION PACKAGE	124
					123
					122
1	-	A	4-21028-0	PIN, SLT SPR (ø.093x.75)ST GDE PL	121
1	-	B	690701-2	PLATE, SERIAL NO.	120
2	-	A	21899-2	WASHER, FLAT (#10)S G ADJ BLK	119
					118
2	-	A	21024-5	WASHER, LOCK (#10)ADJ BLOCK	117
					116
					115
2	-	A	21024-2	WASHER, LOCK (#4)FRONT STP GUIDE	114
REF	-	A	21024-4	WASHER, LOCK (#8)FEED FINGER	113
2	-	A	21024-4	WASHER, LOCK (#8)DEP-HOLD	112
REF	-	A	21024-4	WASHER, LOCK (#8)STRIPPER	111
					110
					109
1	-	A	21018-5	NUT, HEX (#6)HOLD DOWN	108
					107
					106
					105
					104
1	-	A	21009-2	SCR, 5KT SET (1/4-20x.25 LW)RAM	103
					102
4	-	A	21017-2	SCR, DRIVE (#2x.19)ID PLATE	101
1	-	B	819347-1	PLATE, IDENTIFICATION	100
2	-	A	3-21002-0	SCR, BHC (10-32x.88)DRAG	99
1	-	A	22733-8	SCR, BHC (8-32x.38 LW)ANVIL	98
					97
1	-	A	3-21000-8	SCR, 5HC (10-32x.88)MOUNTING	96
1	-	A	2-21002-7	SCR, BHC (10-32x.50)SG ADJ BLK	95
6	-	A	2-21002-2	SCR, BHC (8-32x.50)SHEAR-TERM SUP	94
					93
					92
1	-	A	1-21002-7	SCR, 5HC (6-32x.50)CAM	91
2	-	A	2-21000-7	SCR, 5HC (8-32x.50)SCR BLK	90
					89
					88
2	-	A	2-21000-7	SCR, 5HC (8-32x.48)DEP-HOLD DOWN	87
REF	-	A	2-22603-0	SCR, HEX HD (8-32x.31)FEED FINGER	86
2	-	A	1-21000-3	SCR, 5HC (4-40x.25)F ST GUIDE	85
REF	-	A	22733-9	SCR, BHC (8-32x.50 SL)STRIPPER	84
					83
					82
1	-	A	3-22603-1	SCR, HEX (10-32x.38)SG ADJ BL	81
					80
					79
					78
2	-	B	463310-7	BLADE, STRIPPING (#24)	77
					76
					75
1	-	A	690603-1	SPRING, ASSIST	74
1	-	A	23030-1	SCR, 5KT CAP (6-32x.25)CP DSC	73
					72
					71

QTY	REV	U/M	DWG SIZE	PART NO	DESCRIPTION	ITEM NO
-1		U/M				

QTY REOD PER ASSY		PARTS LIST	

QTY	REV	U/M	DWG SIZE	PART NO	DESCRIPTION	ITEM NO
-1		U/M				

QTY REOD PER ASSY		PARTS LIST	

CUSTOMER AND ASSEMBLY DRAWING

THIS DRAWING IS A CONTROLLED DOCUMENT.

THIS DRAWING IS UNCLASSIFIED
 RELEASED FOR PUBLICATION
 07 APRIL 1999
 BY AMP INCORPORATED. ALL RIGHTS RESERVED.
 AMP 1756 REV 3-92
 LOC A
 DIST 66

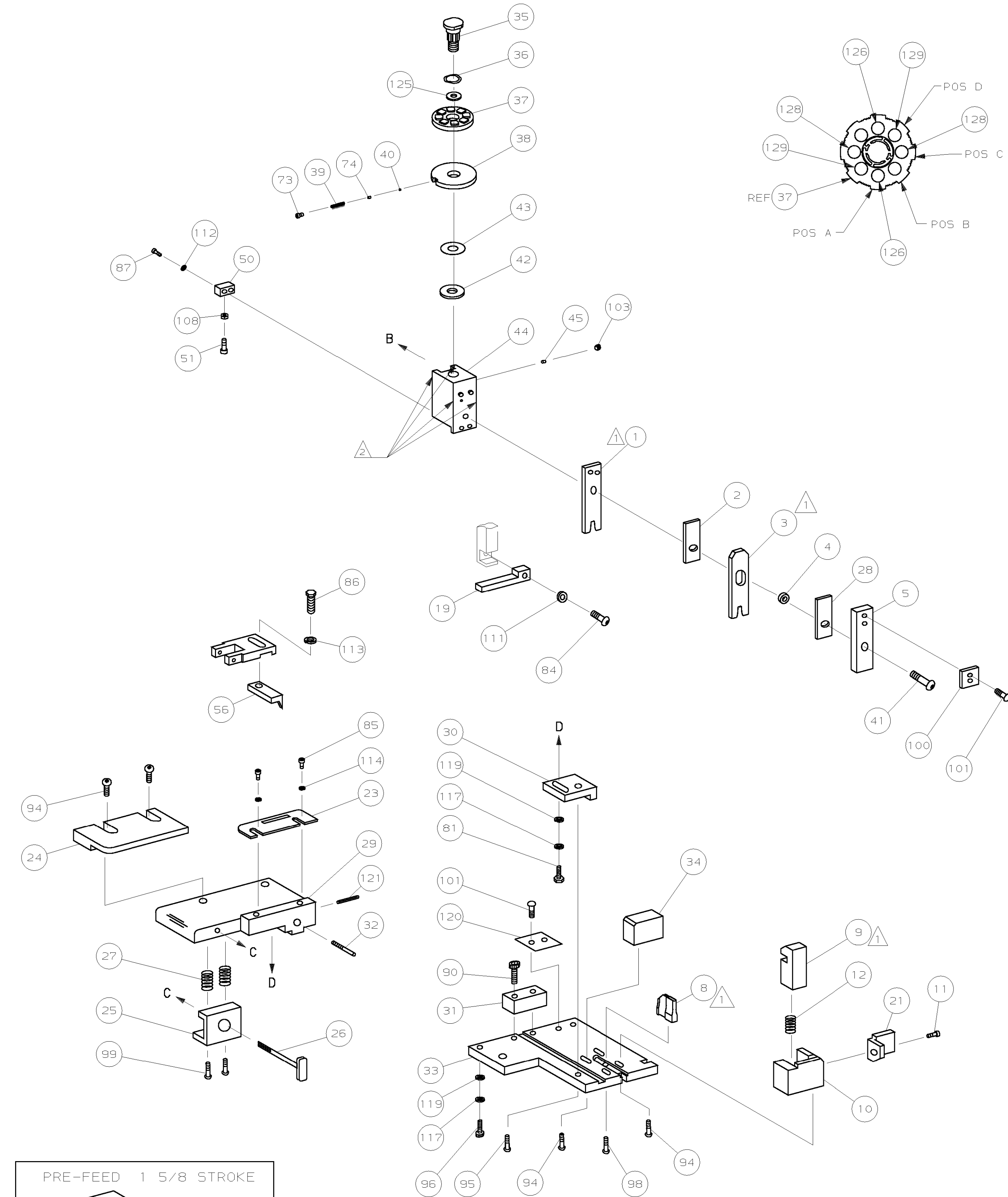

- 1 RECOMMENDED SPARE PARTS.
- 2 GREASE LIGHTLY.
- 3 ITEM NOT SHOWN.
- 4 CUT TO LENGTH AT ASSY.