



Mallory Sonalert Products, Inc.

Part #:

MSE28LDD7

Sales Outline Drawing

Revision:

B

Specifications:

| | |
|-----------------------|-------------------------------------|
| Sound Level Category | Loud |
| Mode of Operation | Ding Dong 4.3 - 3.4 kHz Double Shot |
| Voltage Rating | 20 to 28 VDC |
| Frequency | 4300-3400 Hz Typical |
| Loudness @ 1 FT | 85 to 95 dB(A) Typ. |
| Current Draw | 50mA MAX |
| Housing Material | Valox (UL94V-0), Color: Black |
| Storage Temperature | -40° to +80° C |
| Operating Temperature | -40° to +65° C |
| Weight (Typical) | 4.0g |
| Options | Please contact factory. |

Dimensions: Inches (mm)

ROHS Compliant

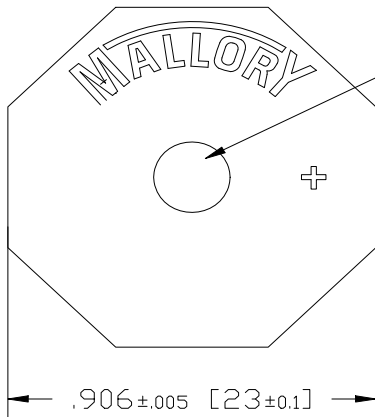

EMISSION HOLE
Ø .188±.005 [4.8±0.1]

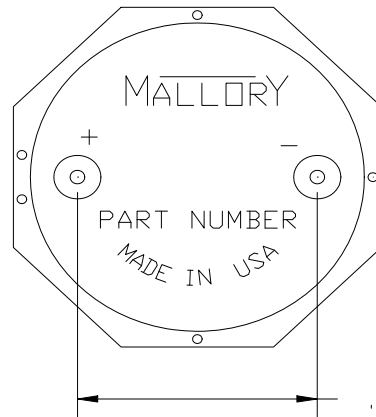

.590±.012 [15±0.3]

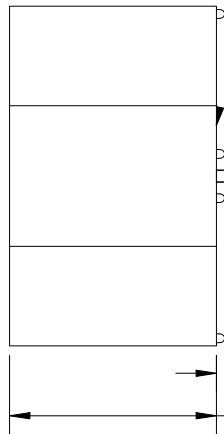

.031±.002 [0.8±.04]
(2 Pins)

.197 [5]
.165 [4]

.020±.005 [. 5±0.1]

.509±.005 [12. 9±0.1]

NOTE A:
TERMINALS - .031" DIA. NICKEL/TIN COATED BRASS.

NOTE B:
MOUNTING- INSERT INTO PRINTED CIRCUIT BOARD AND HAND OR MACHINE SOLDER.
UNITS ARE SUITABLE FOR WAVE SOLDERING. RECOMMENDED MAXIMUM TEMPERATURE
AND TIME DURATION FOR WAVE SOLDERING IS +270°C AND 3 SECONDS RESPECTIVELY.