

NOTES:

- 1.MATERIAL: COPPER ALLOY
- 2.PLATING-
MATING AREA: 0.1µm MIN. Au over 2µm MIN. NiP
TERMINATION AREA: 0.2µm MIN. Au over 2µm MIN. Ni
- 3.PRODUCT SPECIFICATION: INLINE CONNECTOR: 2018400030 PS
- 4.PACKAGING SPECIFICATION: 2018460001 PDD PK
- 5.MATES WITH THE TERMINAL SERIES 201846
- 6.USED WITH HOUSING SERIES 201840
- 7.MAXIMUM ALLOWED OVERALL WIRE DIAMETER IS 6.50MM.
- 8.DIMENSIONS IN BRACKETS ARE REFERENCE ONLY.
- 9.CRIMP TOOL DETAILS:

FCT TOOLS

- HAND TOOL: M309
- PNEUMATIC CRIMP TOOL: WA27-309
- DIE: SP994
- SELECTOR NUMBER:
AWG 8/ SEL. 7
AWG 10/ SEL. 6

RoHS compliant by exemption 6(c)

CRIMP DETAILS

- FOR STRIP LENGTH CONSIDER ESTABLISHED TECHNICAL CRIMP SPECIFICATION, FOR EXAMPLE IPC/WHMA-A-620.
- IN ADDITION KEEP CLEARANCE 'C' BETWEEN INSULATION AND CONTACT BARREL LESS THAN 50% OF OVERALL WIRE O.D., WITH A RECOMMENDATION OF MAX. 1MM CLEARANCE C.
- PUSH STRIPPED WIRES INTO TERMINAL UP TO STOP.
- AFTER CRIMPING CHECK IF STRIPPED WIRES ARE VISIBLE IN INSPECTION HOLE.

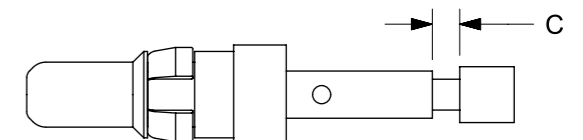
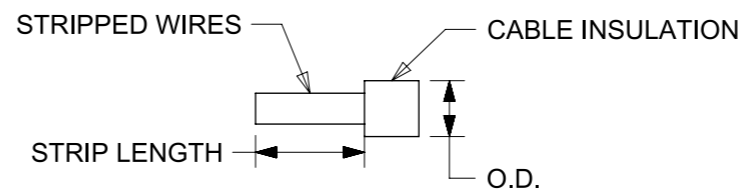

QUALITY SYMBOLS FA = 0 FE = 0 FP = 0 ▼ = 0 C = 0 ⊗ = 0 ■ = 0 ∇ = 0	THIS DRAWING CONTAINS INFORMATION THAT IS PROPRIETARY TO MOLEX ELECTRONIC TECHNOLOGIES, LLC AND SHOULD NOT BE USED WITHOUT WRITTEN PERMISSION											
	DRAWING UPDATE EC NO: 111695 DRWN: MRAMAKRISHNA CHK'D: ISHWARG 2016/12/19 2016/12/20		GENERAL TOLERANCES (UNLESS SPECIFIED) ANGULAR TOL ± ° 4 PLACES ± 3 PLACES ± 2 PLACES ± 0.13 1 PLACE ± 0.25 0 PLACES ±		DIMENSION UNITS: MM SCALE: 5:1							
	DRWN BY: MRAMAKRISHNA DATE: 2016/04/04		CHK'D BY: MRAMAKRISHNA DATE: 2016/04/25		APPR BY: ISHWARG DATE: 2016/12/13							
	DRAWING SIZE: A3 THIRD ANGLE PROJECTION		PRODUCT CUSTOMER DRAWING						SERIES: 201845 MATERIAL NUMBER: 2018450040 CUSTOMER: GENERAL MARKET			
	DRAFT WHERE APPLICABLE MUST REMAIN WITHIN DIMENSIONS		DOCUMENT NUMBER: 2018450040 DOC TYPE: PSD DOC PART: 000 SHEET NUMBER: 1 OF 1									