

**NOTES :**

**1- MATERIAL:**

-HOUSING: POLYESTER FIBER GLASS FILLED UL 94-V0  
COLOR BLACK.

-TERMINAL: PHOSPHOR BRONZE.

**PLATING :**

POST PLATE 0.00127-0.00152/.000050-.000060 GOLD IN  
CONTACT AREA , 0.00190/.000075 MIN PURE TIN  
IN TAIL AREA BOTH OVER 0.00127/.000050 MIN NICKEL  
OVERALL.

- 2- JACK FOR MATING WITH F.C.C. 68 PLUGS (90075 MOLEX SERIES).
- 3- PRODUCT SPECIFICATION PS-95003 AND PS-85505 (SECTION 5.2).
- 4- APPLICATION SPECIFICATION AS-95001.
- 5- PACKAGING SPECIFICATION PK-95003 SHEET 1:  
(TRAY PACKAGING).
- 6- EXCEEDS CATEGORY 5E PERFORMANCE.

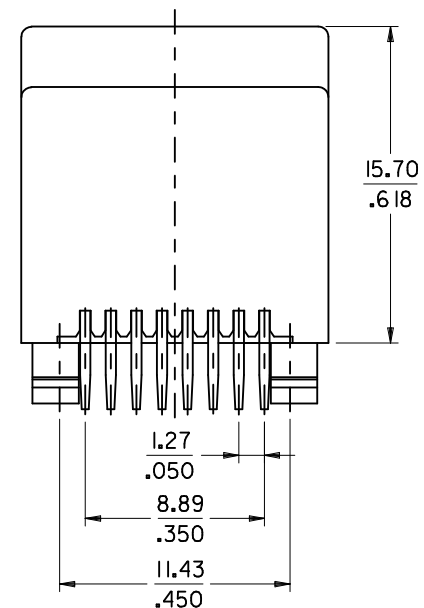
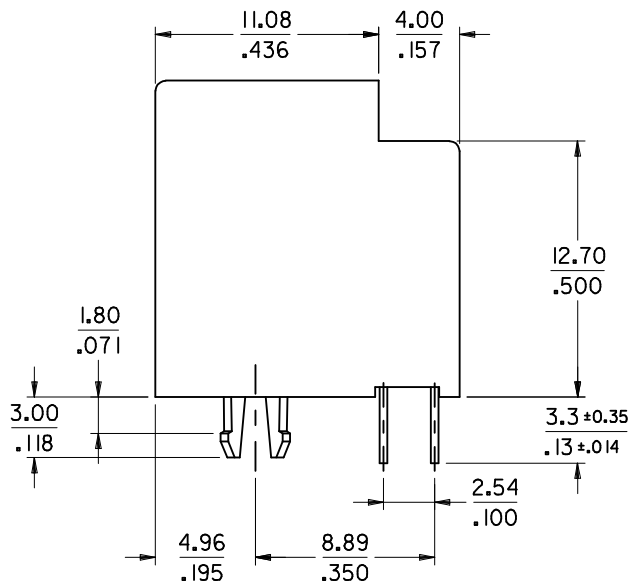
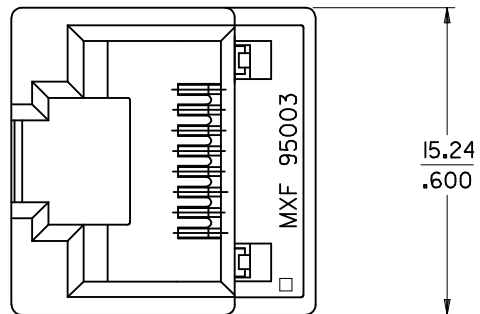

**P.C.B. MOUNTING PATTERN**  
(see from component side)

SCALE 2:1

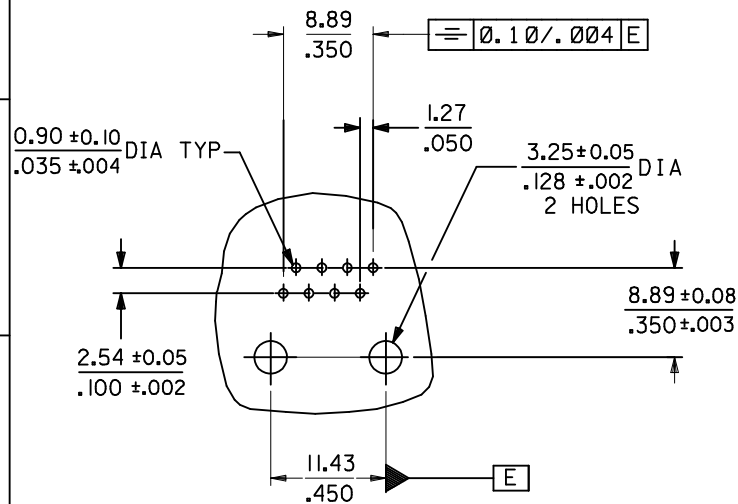

ENTER DESCRIPTION EC NO: MG2005-0151 DRWN: CSEBASTI 2004/10/25 CHKD: FCARBET 2004/10/25 APPR: KNOLLER 2004/11/09	QUALITY SYMBOLS ▽=0 ◻=0	GENERAL TOLERANCES (UNLESS SPECIFIED)		DIMENSION STYLE MM/IN		SCALE 4:1	DESIGN UNITS METRIC	THIRD ANGLE PROJECTION	
		mm	INCH	DRAWN BY HB	DATE 99/08/18	TITLE HIGH SPEED MODULAR JACK TOP ENTRY LOW PROFILE THROUGH HOLE 8 CKTS			
B	REV	4 PLACES	± ---	± ---	CHECKED BY ER	DATE 99/08/18	MOLEX INCORPORATED		
		3 PLACES	± ---	± .006	APPROVED BY FB	DATE 99/08/18			
		2 PLACES	± 0.15	± .010	MATERIAL NO. 85511-0001		DOCUMENT NO. SD-85511-001	SHEET NO. 1 OF 1	
		1 PLACE	± 0.25	± ---	DRAFT WHERE APPLICABLE MUST REMAIN WITHIN DIMENSIONS				
		ANGULAR ± 1/2°		THIS DRAWING CONTAINS INFORMATION THAT IS PROPRIETARY TO MOLEX INCORPORATED AND SHOULD NOT BE USED WITHOUT WRITTEN PERMISSION					