

PART NUMBER	REV	TERMINATOR	FEED TYPE	DESCRIPTION
1528756-1	C	LEADMAKER	MECH POST FEED	CUTS CARRIER
1528756-2	C	BENCH	MECH PRE FEED	CUTS CARRIER
1528756-6	C	LEADMAKER	MECH POST FEED	CONTINUOUS CARRIER
7-1528756-1	C	LEADMAKER	MECH POST FEED	-1 AND SPARE PARTS
7-1528756-2	C	BENCH	MECH PRE FEED	-2 AND SPARE PARTS
7-1528756-6	C	LEADMAKER	MECH POST FEED	-6 AND SPARE PARTS
7-1528756-7	A	-	-	SPARE PARTS KIT

CRIMP DATA		LEAR/GHW TERMINAL	LEAR CRIMP SPECS
TERMINAL NAME: AFK FEMALE TERMINAL SWS 2.8 X 0.8			
CRIMP	SIZE	TYPE	RANGE
WIRE	2.67 [1.05 IN]	F	1.50mm ² -2.50mm ²
INSUL	4.32 [1.70 IN]	0	3.40 [1.34 IN]
WIRE STRIP LENGTH 5.00 [1.97 IN]		APPL INSTRUCTIONS 408-8322 & 408-8490	
TERMINAL APPL SPEC		LEAR CRIMP DIMENSION SHEET FOR PN 26636 [REV6]	FEED [2.45 [1.490 IN]
TERMINALS APPLIED			
TYCO TERM PN	MANUF'S TERM PN	TYCO SEAL PN	MANUF'S SEAL PN
1949251-1	26636.201.185	1949095-1	16694.627.626
1949251-2	26636.201.702	1949095-2	15339992
1949251-3	26676.330.185	-	-
WIRE SIZE	CRIMP HEIGHT	REF SETTING	
2.50mm ²	1.70 ± 0.05 [0.67 ± 0.02 IN]	C5	
1.50mm ²	1.45 ± 0.05 [0.57 ± 0.02 IN]	E4	

- △ RECOMMENDED SPARE PARTS.
- 2. GREASE RAM, CAM, CAM FOLLOWER AND FEED ROD LIGHTLY.
- △ CERTAIN TERMINALS REQUIRE LUBRICATION. REFER TO THE APPLICATOR INSTRUCTION SHEET FOR MORE INFORMATION.
- 4. LUBRICATE DAILY PER THE APPLICATOR INSTRUCTION SHEET SUPPLIED WITH THE APPLICATOR.
- △ THIS APPLICATOR APPLIES TERMINAL WITH A SEAL. INSULATION DIA QUOTED IS OUTSIDE DIAMETER OF SEAL. TERMINAL INSULATION RANGE IS - 1.9 - 2.9 [0.75-.114 IN]
- △ APPLY TORQ-SEAL IN ALLEN SOCKET TO FILL HOLE AFTER FLAT HD HAS BEEN ADJUSTED TO CORRECT HEIGHT AT QUALIFICATION. APPLY #1-23419-5 LOC-TITE TO THREADS.
- △ ALL CRIMP DATA SUPPLIED BY LEAR CORPORATION.
- △ TERMINAL APPLIES FLRY TYPE INSULATION.
- △ STRIP GUIDE MAY REQUIRE ADJUSTMENT WHEN SWITCHING TERMINALS.

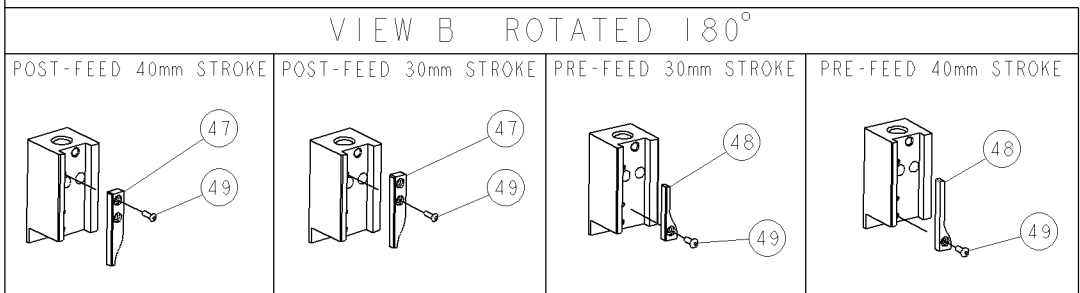

AMP 4805 REV 31MAR2000

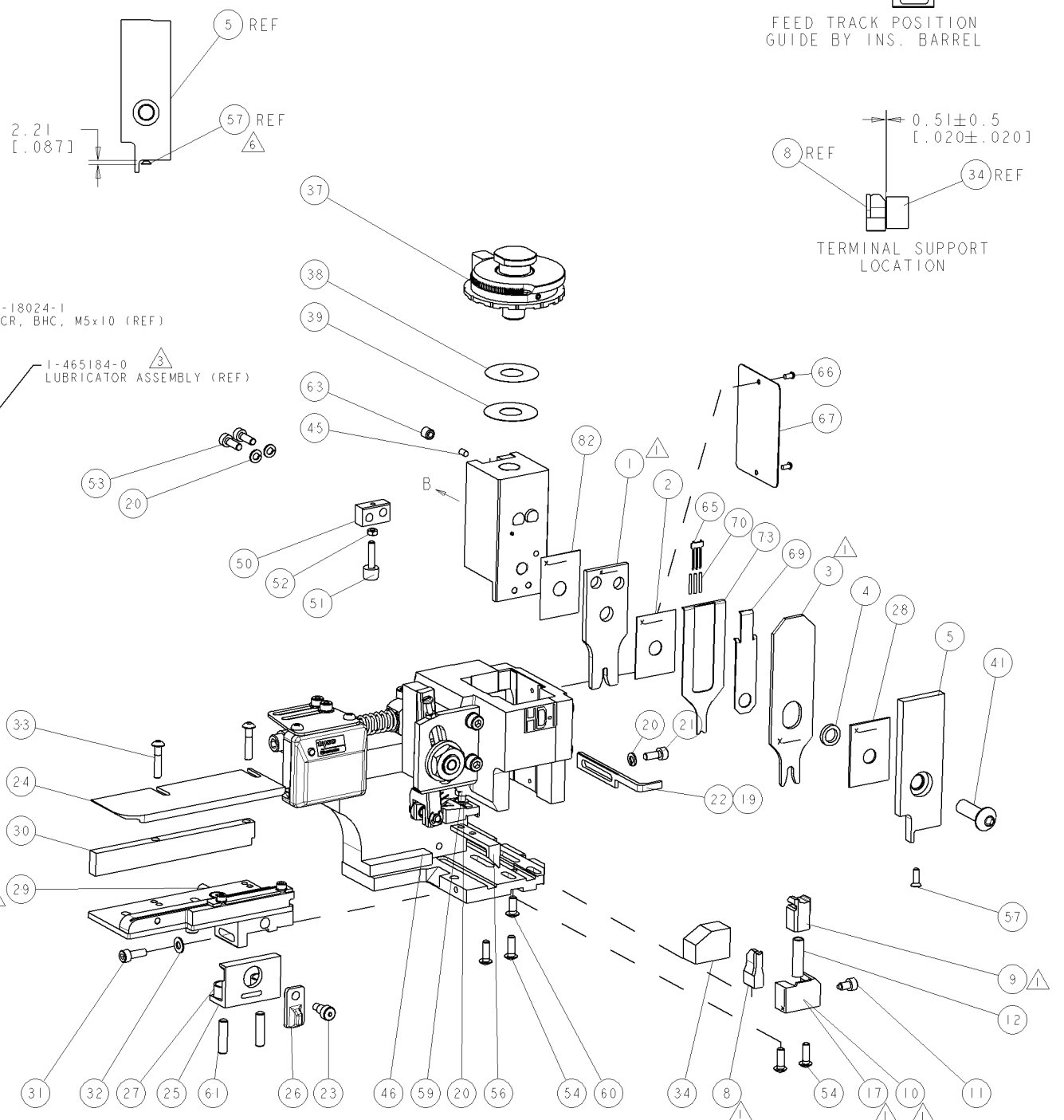

* WARNING
ON INSTALLATION, SET WIRE DISC TO LARGEST WIRE SIZE SETTING. USE OF SETTINGS BELOW MIN. REQUIRED CRIMP HEIGHT SETTING WILL CAUSE DAMAGE TO CRIMP TOOLING.

ITEM NO	DESCRIPTION	ITEM NO
84		
83		
82	455888-2 SPACER, CRIMPER	
81		
80		
79		
78		
77		
76		
75		
74		
73		
72		
71		
70		
69		
68		
67		
66		
65		
64		
63		
62		
61		
60		
59		
58		
57		
56		
55		
54		
53		
52		
51		
50		
49		
48		
47		
46		
45		
44		
43		
42		
41		
40		
39		
38		
37		
36		
35		
34		
33		
32		
31		
30		
29		
28		
27		
26		
25		
24		
23		
22		
21		
20		
19		
18		
17		
16		
15		
14		
13		
12		
11		
10		
9		
8		
7		
6		
5		
4		
3		
2		
1		

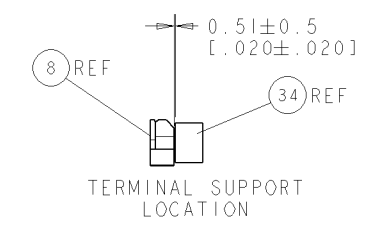
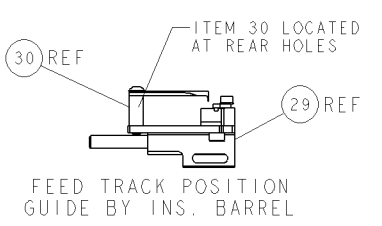

SET UP GAGE
458637-3

REV	DESCRIPTION	DATE	BY	APPV
A	SEE ECO-07-004950	02MAR2007	DP	MC
B	ECR-11-019057	15SEP2011	RS	SX
C	ECR-11-019425	22SEP2011	RS	SX

ITEM NO	DESCRIPTION	ITEM NO
73	1490525-3 DEPRESSOR, WIRE	
72		
71	1338705-3 DOCUMENTATION PACKAGE	
70	2-23147-2 SPRING, COMPRESSION	
69	1490524-1 DEPRESSOR, SPACER	
68		
67	461264-5 PLATE, IDENTIFICATION	
66	21017-2 SCREW, DRIVE	
65	1424350-1 HOLDER, PIN, WIRED	
64		
63	3-18031-0 SCR, SET, CUP POINT M6 X 6.0	
62		
61	2-18032-5 SCR, SET, FLT POINT M5 X 20.0	
60	18024-7 SCR, BTN SKT HD CAP (M4 X 10.0)	
59	5-18022-2 SCR, HEX HD CAP M4 X 8.0	
58		
57	985575-3 SCR, FLT SKT HD CAP M3 X 10.0	
56	1338685-1 PAWL, FEED	
55		
54	18024-8 SCR, BTN SKT HD CAP (M4 X 12.0)	
53	1-18023-2 SCR, SKT HD CAP M4 X 12.0	
52	18030-1 NUT, HEX, REG M3	
51	811242-5 BUMPER, HOLD DOWN	
50	690753-2 SPACER, TONKER	
49	18024-3 SCR, BTN SKT HD CAP (M3 X 10.0)	
48	1338675-1 CAM, UNIVERSAL PRE FEED	
47	1338676-1 CAM, UNIVERSAL POST-FEED	
46	1320999-3 APPLICATOR SUBASSEMBLY, HDI	
45	690191-1 PLUG, NYLON	
44	1633724-1 RAM, (SIDE FEED)	
43		
42		
41	2-18024-6 SCR, BTN SKT HD CAP (M8 X 25.0)	
40		
39	690125-1 SHIM SUB-ASSY	
38	469367-3 SHIM	
37	879103-2 FINE ADJUST HEAD ASSEMBLY	
36		
35		
34	3-1320934-0 SUPPORT, TERMINAL	
33	1-18024-0 SCR, BTN SKT HD CAP (M4 X 20.0)	
32	18027-2 WASHER, FLAT, REG M4	
31	1-18023-2 SCR, SKT HD CAP M4 X 12.0	
30	1320908-6 SPACER, STRIP GUIDE	
29	1633073-2 STRIP GUIDE ASSEMBLY	
28	1-455888-0 SPACER, CRIMPER	
27	1-22284-0 SPRING, COMPRESSION	
26	356835-1 LEVER, DRAG RELEASE	
25	240792-1 DRAG, TERMINAL	
24	1320928-5 PLATE, STRIP GUIDE	
23	980371-4 SCR, SKT HD SHLDR 5.0 DIA X 6.0	
22	690472-2 STRIPPER	
21	1-18023-1 SCR, SKT HD CAP M4 X 10.0	
20	18025-2 WASHER, SPRG LOCK, REG M4	
19	690472-1 STRIPPER	
18		
17	1338684-2 SHEAR HOLDER, FRONT	
16		
15		
14		
13		
12	3-22280-3 SPRING, COMPRESSION	
11	356885-5 STOP, SHEAR	
10	1-1320921-0 SHEAR HOLDER, FRONT, CUT	
9	318707-1 FLOATING SHEAR, FRONT	
8	3-1633138-2 ANVIL, COMBINATION	
7		
6		
5	1338680-5 DEPRESSOR, SHEAR	
4	238011-8 BLOCK, CRIMPER SPACER	
3	3-683454-7 CRIMPER, INSULATION O	
2	455888-4 SPACER, CRIMPER	
1	4-1633305-0 CRIMPER, WIRE PREMIUM	

LOC	DIST	REV	DESCRIPTION	DATE	BY	APPV
A	66					

DIMENSIONS: mm [IN]		TOLERANCES, UNLESS OTHERWISE SPECIFIED:	
0 PLC	±	0.15	±
1 PLC	±	0.25	±
2 PLC	±	0.38	±
3 PLC	±	0.51	±
4 PLC	±	0.76	±
5 PLC	±	1.27	±
6 PLC	±	2.00	±
7 PLC	±	3.00	±
8 PLC	±	4.75	±
9 PLC	±	7.62	±
10 PLC	±	12.7	±
11 PLC	±	20.0	±
12 PLC	±	30.0	±
13 PLC	±	47.5	±
14 PLC	±	72.5	±
15 PLC	±	110.0	±
16 PLC	±	165.0	±
17 PLC	±	250.0	±
18 PLC	±	375.0	±
19 PLC	±	562.5	±
20 PLC	±	843.75	±
21 PLC	±	1265.6	±
22 PLC	±	1898.4	±
23 PLC	±	2847.6	±
24 PLC	±	4271.4	±
25 PLC	±	6407.1	±
26 PLC	±	9610.7	±
27 PLC	±	14416.0	±
28 PLC	±	21624.0	±
29 PLC	±	32436.0	±
30 PLC	±	48654.0	±
31 PLC	±	72981.0	±
32 PLC	±	109471.5	±
33 PLC	±	164207.2	±
34 PLC	±	246310.8	±
35 PLC	±	369466.2	±
36 PLC	±	554199.3	±
37 PLC	±	831298.9	±
38 PLC	±	1246948.4	±
39 PLC	±	1870422.6	±
40 PLC	±	2805633.9	±
41 PLC	±	4208450.9	±
42 PLC	±	6312676.3	±
43 PLC	±	9469014.5	±
44 PLC	±	14203521.7	±
45 PLC	±	21305282.6	±
46 PLC	±	31957923.9	±
47 PLC	±	47936885.8	±
48 PLC	±	71905328.7	±
49 PLC	±	107857993.1	±
50 PLC	±	161786989.6	±
51 PLC	±	242680484.4	±
52 PLC	±	364020726.6	±
53 PLC	±	546031090.0	±
54 PLC	±	819046635.0	±
55 PLC	±	1228569952.5	±
56 PLC	±	1842854928.8	±
57 PLC	±	2764282393.2	±
58 PLC	±	4146423589.8	±
59 PLC	±	6219635384.7	±
60 PLC	±	9279453077.1	±
61 PLC	±	13919179615.7	±
62 PLC	±	20878769423.6	±
63 PLC	±	31318154135.4	±
64 PLC	±	46977231203.1	±
65 PLC	±	70465846804.7	±
66 PLC	±	105698770207.1	±
67 PLC	±	158548155310.7	±
68 PLC	±	237822232966.1	±
69 PLC	±	356733349449.2	±
70 PLC	±	535099924173.8	±
71 PLC	±	802649886260.7	±
72 PLC	±	1203974829391.1	±
73 PLC	±	1805962244086.7	±
74 PLC	±	2708943366129.1	±
75 PLC	±	4063415049193.7	±
76 PLC	±	6095122573790.6	±
77 PLC	±	9142683860686.4	±
78 PLC	±	13714025791029.6	±
79 PLC	±	20571038686544.4	±
80 PLC	±	30856558029816.6	±
81 PLC	±	45764837044715.0	±
82 PLC	±	68647255567073.5	±
83 PLC	±	102970883350610.3	±
84 PLC	±	154456325025915.5	±

STE CONNECTIVITY
Harrisburg, PA 17105-3608

FINE ADJUST SIDE FEED HDI APPLICATOR

SIZE: A1 CAGE CODE: 00779 DRAWING NO: 1528756
SCALE: 3:5 SHEET 1 OF 1 REV C