

H G F E D C B A

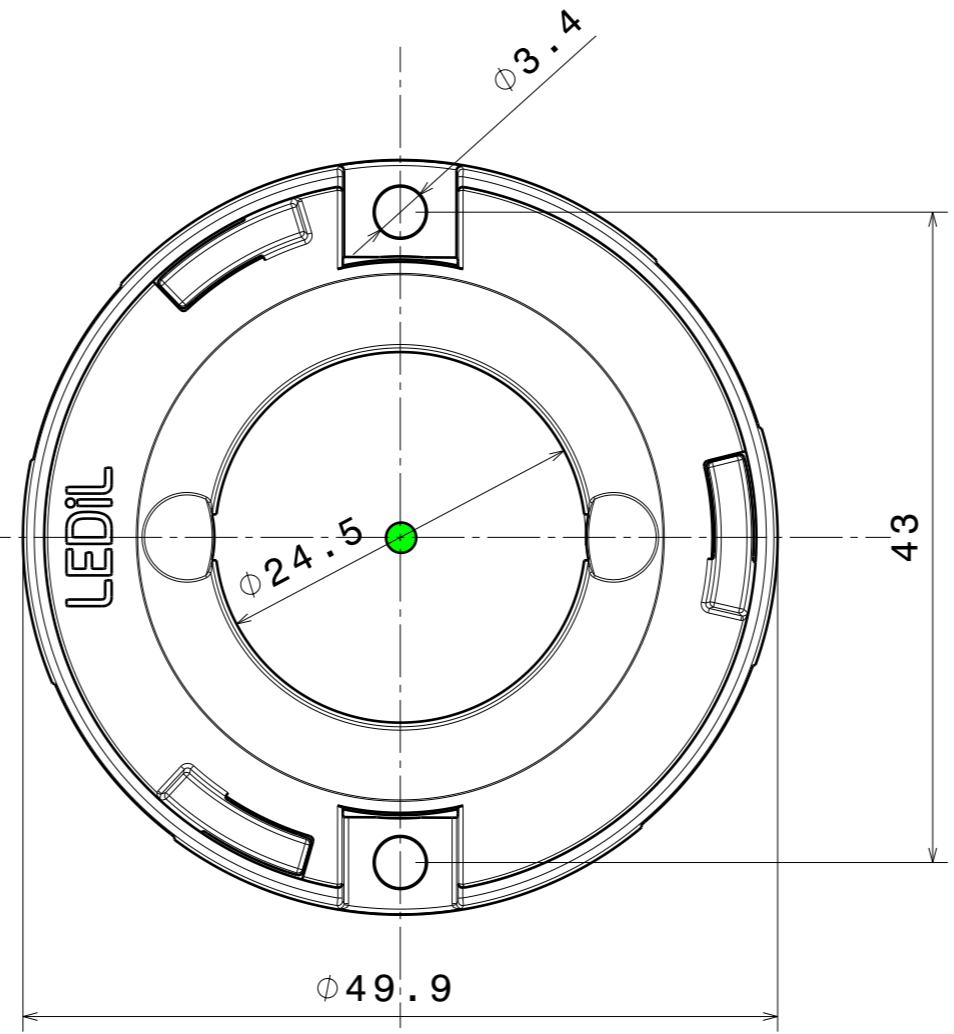
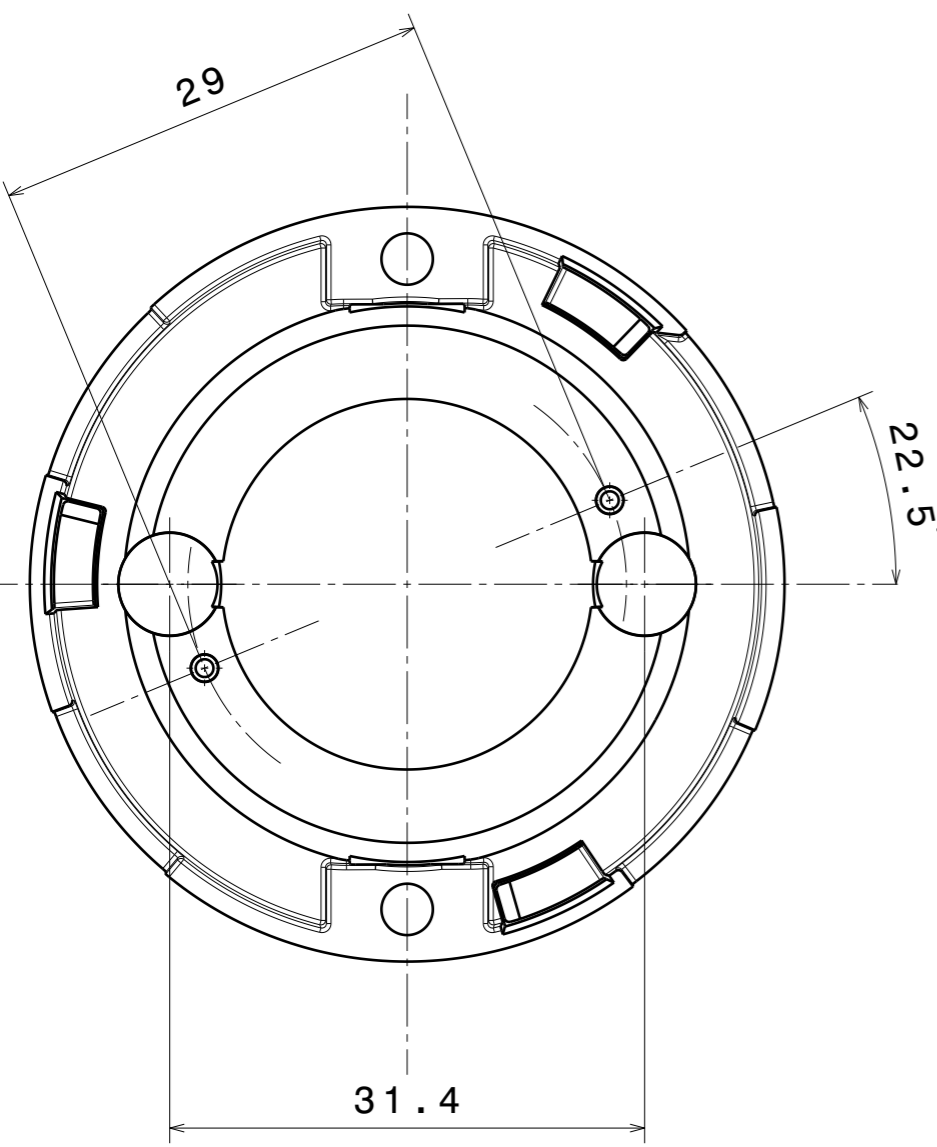
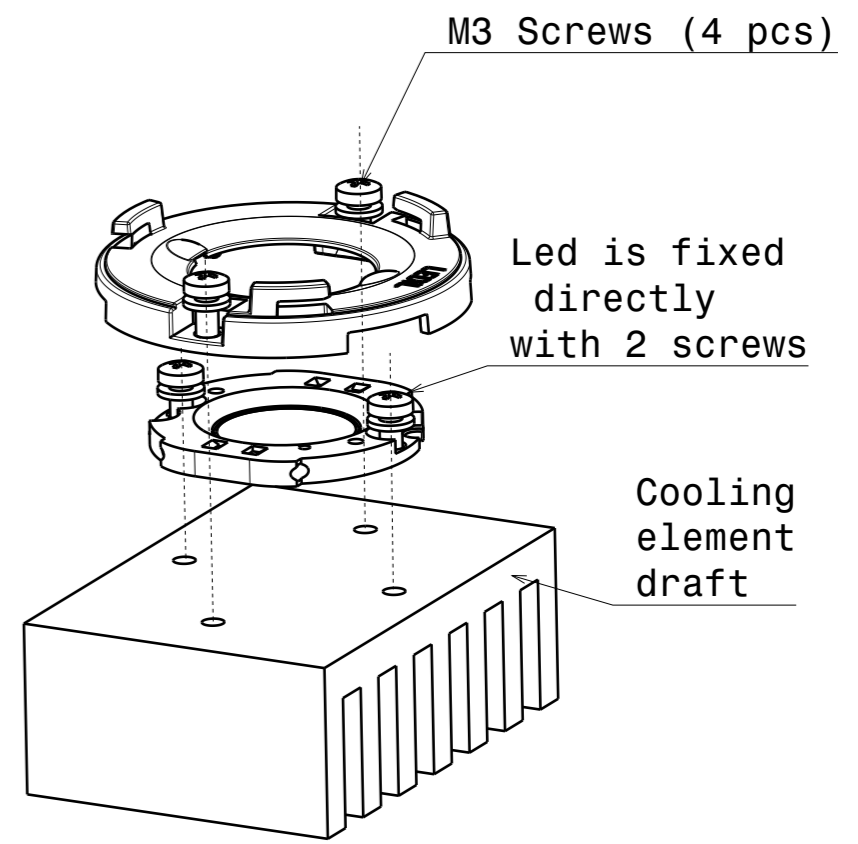
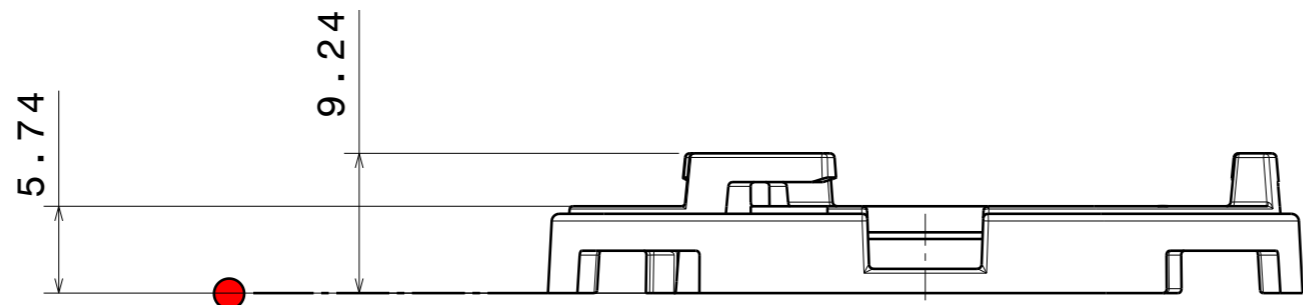

GENERAL MOULDING TOLERANCES

Dimension [mm]	PMMA / PC
>0-6	± 0.2
>6-22	± 0.25
>22-40	± 0.30
>40-90	± 0.44
>90-160	± 0.60
>160-200	± 0.70
>200-315	± 1.1
>315	± 1.3

PART	TYPE	MATERIAL	COLOR / COATING
C16402_CLAMP-VEROSE-13-18 Mechanical Model		PBT	White

MECHANICAL DRAWING		LEDiL [®]
PRODUCT ANGELA		
Plastic molding general tolerances are based on DIN 16901-130 and applies if not otherwise shown in drawing. Silicone molding general tolerances are based on ISO 3302-1 Class M3 and applies if not otherwise shown in the drawing.	FIRST ANGLE PROJECTION: 	This drawing is the property of LEDiL Oy. It may not be reproduced, copied or communicated without a written agreement with LEDiL Oy.
SCALE 1:1	WEIGHT 4,2 g	A3 SHEET 1/1

- Notes**
- PCB or heatsink level.
 - LED location.
- Ensure LED fitting from a product specific 3D model available from www.ledil.com.

H G B A