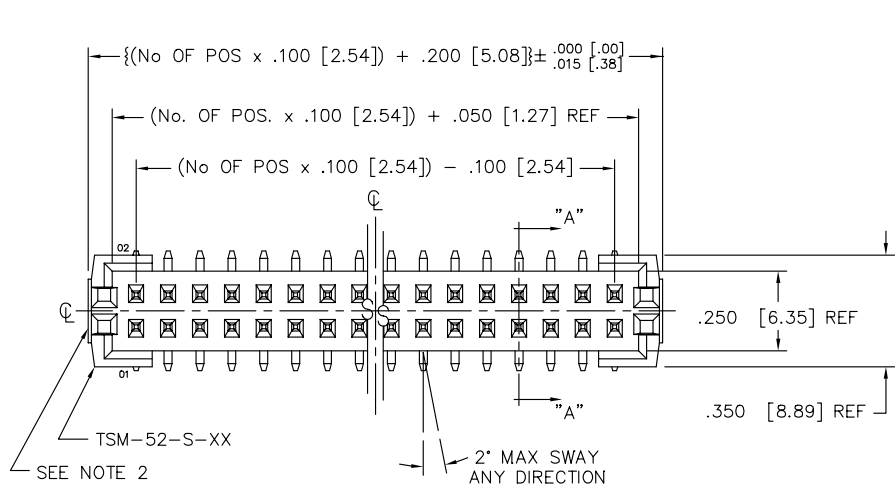

FIG. 1



- NO. OF POSITIONS
 -02 THRU -36 (PER ROW)
 (-02 THRU -04 SEE NOTE 4.)
- LEAD STYLE
 -01
- PLATING
 -S: SELECTIVE GOLD
 -T: TIN
 -G: GOLD
 -F: FLASH GOLD
 -L: LIGHT SELECTIVE
 -SM: SELECTIVE HEAVY GOLD, MATTE TIN TAIL
 -TM: MATTE TIN
 -FM: FLASH SELECTIVE GOLD, MATTE TIN TAIL
 -LM: LIGHT SELECTIVE GOLD, MATTE TIN TAIL
- ROW SPECIFICATION
 -DV: DOUBLE VERTICAL
 *-TH: THROUGH HOLE
 MOLDED END SHROUDS
- OPTION 2
 -LC: LOCKING CLIP (SEE FIG. 1) (DV ONLY)
 -A: ALIGNMENT PIN (SEE FIG. 2, SHEET 2) (DV ONLY)
 -P: PICK & PLACE PAD USE PPP-06 (SEE FIG. 4) (POS. -05 THRU -36 DV ONLY)
 -M: METAL PICK & PLACE PAD USE MPP-01 (SEE FIG. 5) (DV ONLY)
 -TR: TAPE & REEL (-05 THRU -28 POS) (DV ONLY)
- OPTION 1
 POLARIZED POSITIONS
 SPECIFY OMITTED PINS

COPLANARITY	
POSITION	
05-10	.004
11-24	.006
25-36	.008

* NOT ENGINEERING APPROVED

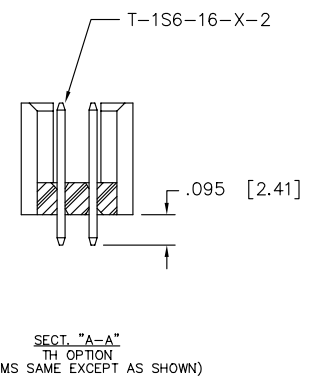
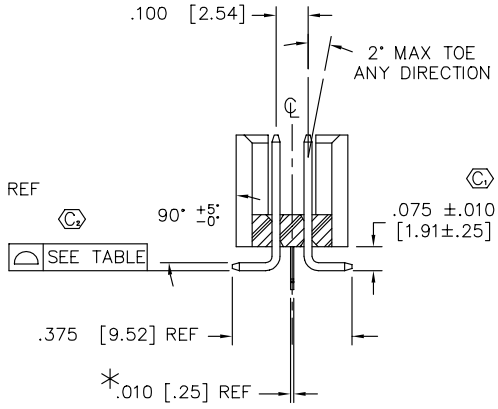
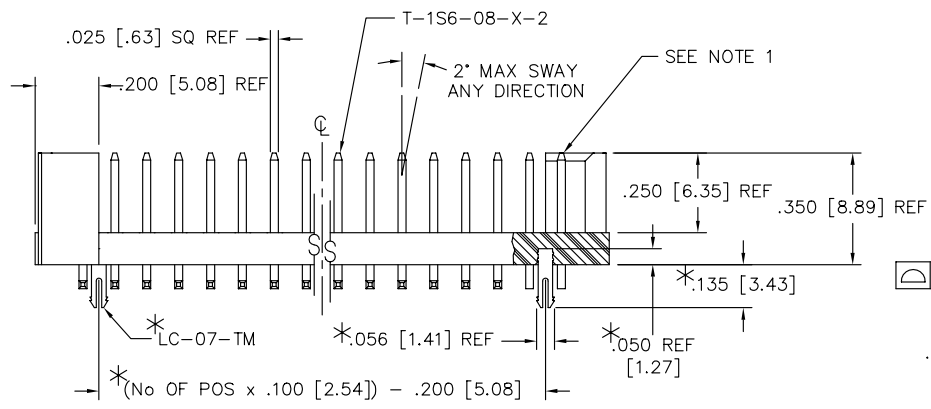

(* DIMENSIONS APPLY ONLY WHEN USING THE -LC OPTION.)

DO NOT SCALE FROM THIS PRINT

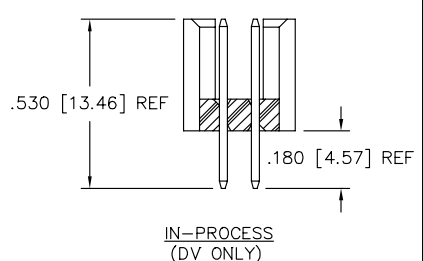
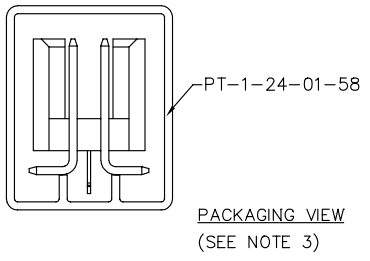

- NOTE:
 1. TERMINALS TO BE FLUSH TO .010 BELOW TOP OF SHROUD.
 2. MAXIMUM CUT FLASH ALLOWED IS .010" IN THIS AREA ONLY.
 3. PACKAGE IN PT-1-24-01-58 TUBE WITH TWO TP-13 PLUGS PER TUBE.
 4. POS. -02 AND -03 MUST USE MPP-01 OR GRIPPERS WILL BE USED INSTEAD OF VACUUM.
 5. (C) REPRESENTS A CRITICAL DIMENSION.

PLOT SCALE: 1 = .3

EXISPROD/ASSEMBLY100 TSM-ES1

samtec

520 PARK EAST BLVD. NEW ALBANY, INDIANA 47150
 PHONE (812) 944-6733 P.O. BOX 1147
 CODE 55322

MADE BY: BRATCHER 10-30-97
 TSM-1XX-XX-XX-DV-S-XXX-XX
 SHEET 1 OF 2

PROPRIETARY NOTE
 THIS DOCUMENT CONTAINS INFORMATION CONFIDENTIAL AND PROPRIETARY TO SAMTEC INC. AND SHALL NOT BE REPRODUCED OR TRANSFERRED TO OTHER DOCUMENTS OR DISCLOSED TO OTHERS OR USED FOR ANY PURPOSE OTHER THAN THAT FOR WHICH IT WAS OBTAINED WITHOUT THE EXPRESSED WRITTEN CONSENT OF SAMTEC INC.