

DETAILS

Product Number	F15244_FLORENCE-ZT25-S
Family	Florence
Type	Lens array
Color	clear
Diameter	286 + 61 mm
Height	11,38 mm
Style	rectang
Optic Material	PMMA
Holder Material	
Fastening	screw
Status	production ready
ROHS Comliant	Yes
Date Updated	12/08/2016

OPTICAL PROPERTIES

LED	Viewing Angle	Light Beam	Efficiency	cd/lm	Connector
LG 5630	Asymmetric deg	Asymmetric	94 %	0.650	-
Duris E5	Asymmetric deg	Asymmetric	94 %	0.730	-
LM561B Plus	Asymmetric deg	Asymmetric	94 %	0.650	-

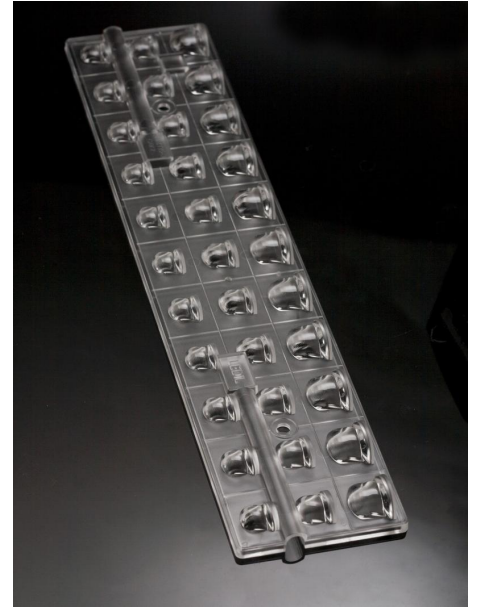

NOTE: INCOMPATIBLE WITH C14437_FLORENCE-PF-3R

Front view

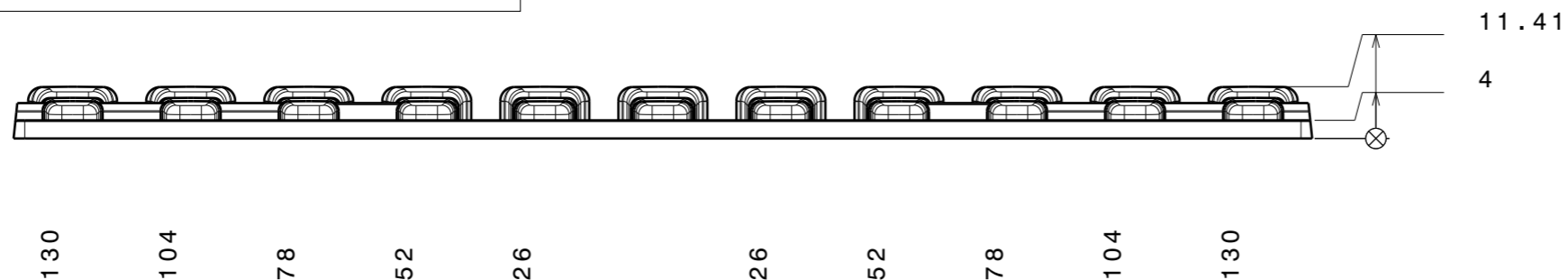

Bottom view

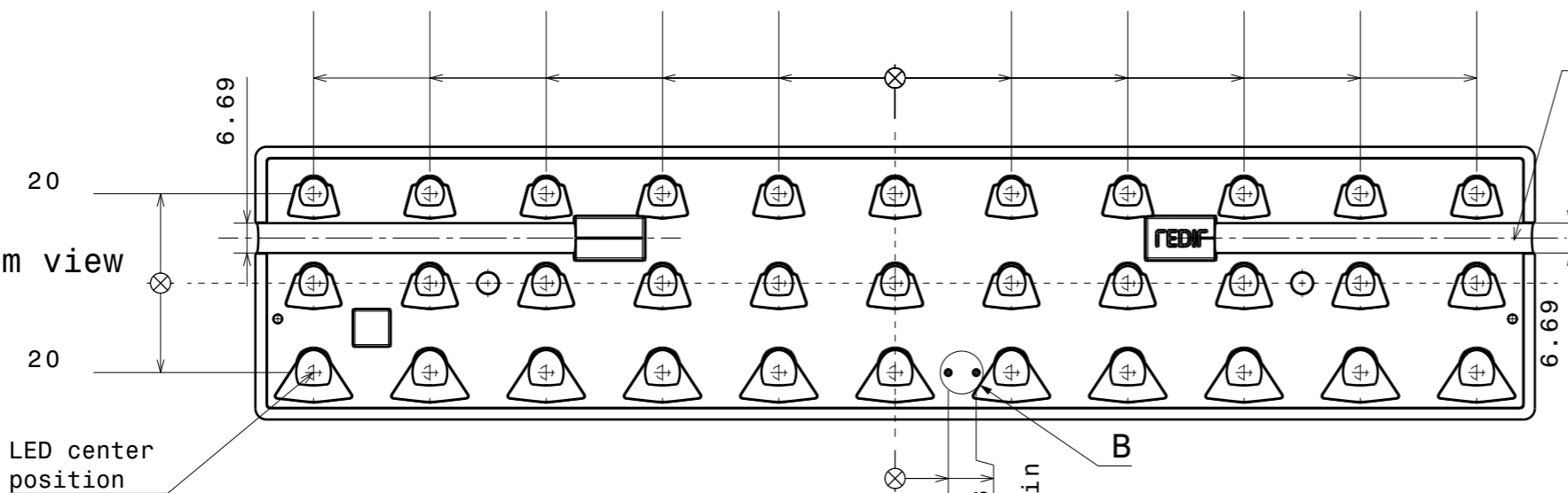

Top view

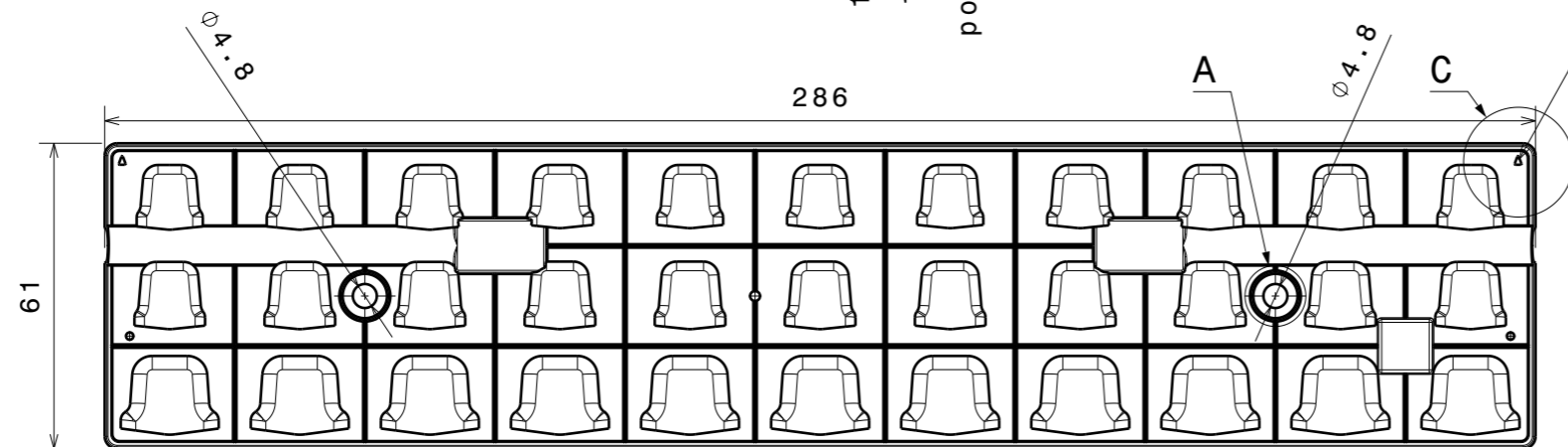

PCB EXAMPLE

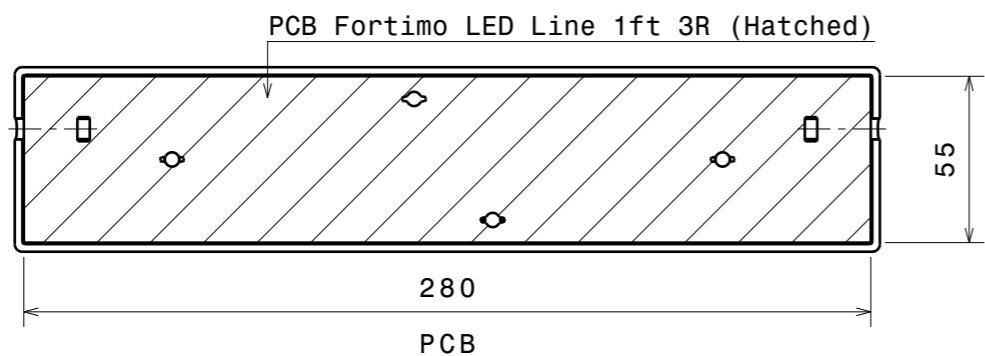

11.41
4



Detail A
4:3

Wire outlet both sides

Detail C
4:3

Asymmetric light
direction indicator

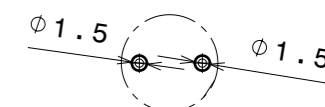

Detail B
4:3

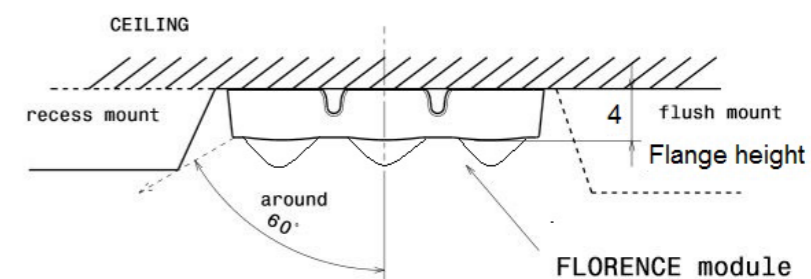

Typical setup

INDEX	PART NO	DESCRIPTION	MATERIAL	COLOUR
1	F15244	FLORENCE-ZT25-S	PMMA	

Tolerances if not otherwise shown
According to DIN ISO 2768-1
Linear measures:
Up to 30mm class M, otherwise class C.
According to DIN ISO 2768-2
Form and position: class L



Ledil Oy
Salorankatu 10
FIN 24240 SALO
Finland

THIRD ANGLE PROJECTION:

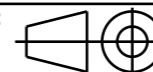

DRAWING TITLE

F15244_FLORENCE-ZT25-S_MechanicalDrawing

This drawing is the property
of LEDiL Oy. It may not be
reproduced, copied or
communicated without a written
agreement with LEDiL Oy.

SIZE

A3

PART NUMBER

F15244

SCALE

2:3

WEIGHT

-

SHEET

1/1

Luminaire: Ledil F15244_FLORENCE-ZT25-S_(LG5630)
Lamps: 1 x LG5630_780.082lm@100mA_P=4.53418W_I=0.100A

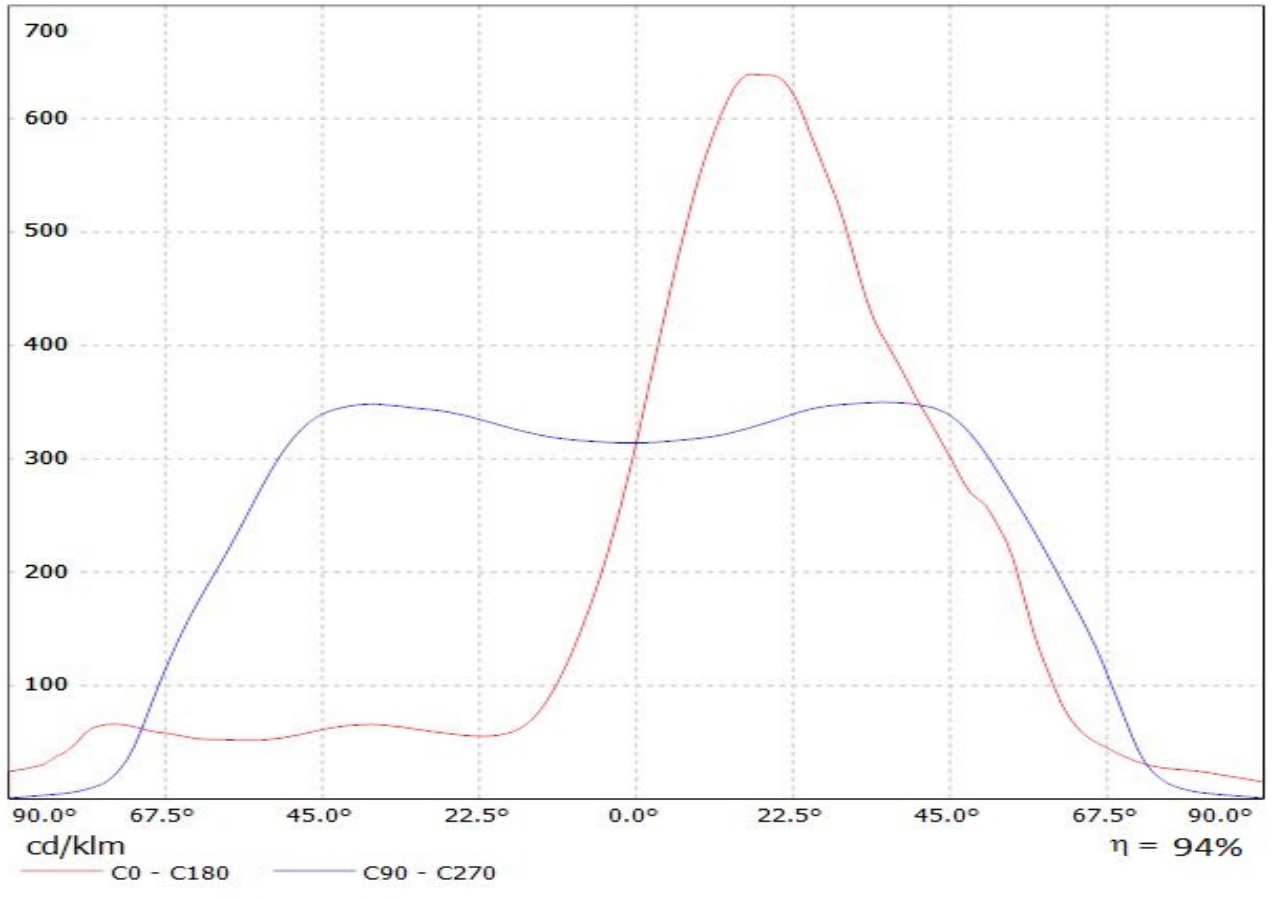

Luminaire: Ledil F15244_FLORENCE-ZT25-S_(Duris_E5)
Lamps: 1 x Osram_Duris_E5_584.783lm@120mA_P=3.68532W_I=0.120A

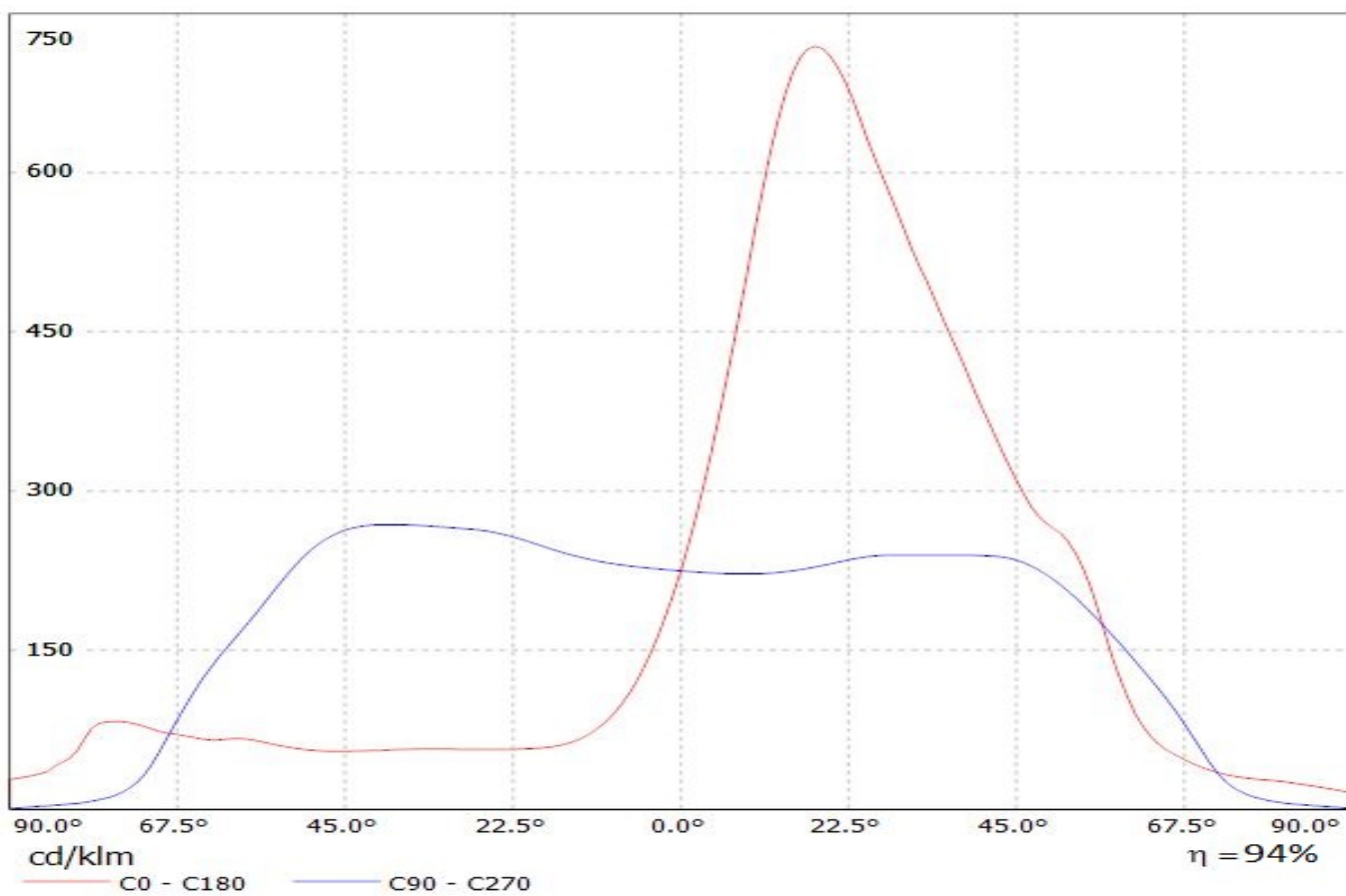

Luminaire: Ledil F15244_FLORENCE-ZT25-S_(LM561B+)_cav1
Lamps: 1 x LM561B+1343.71lm@120mA_P=8.13375W_I=0.250A

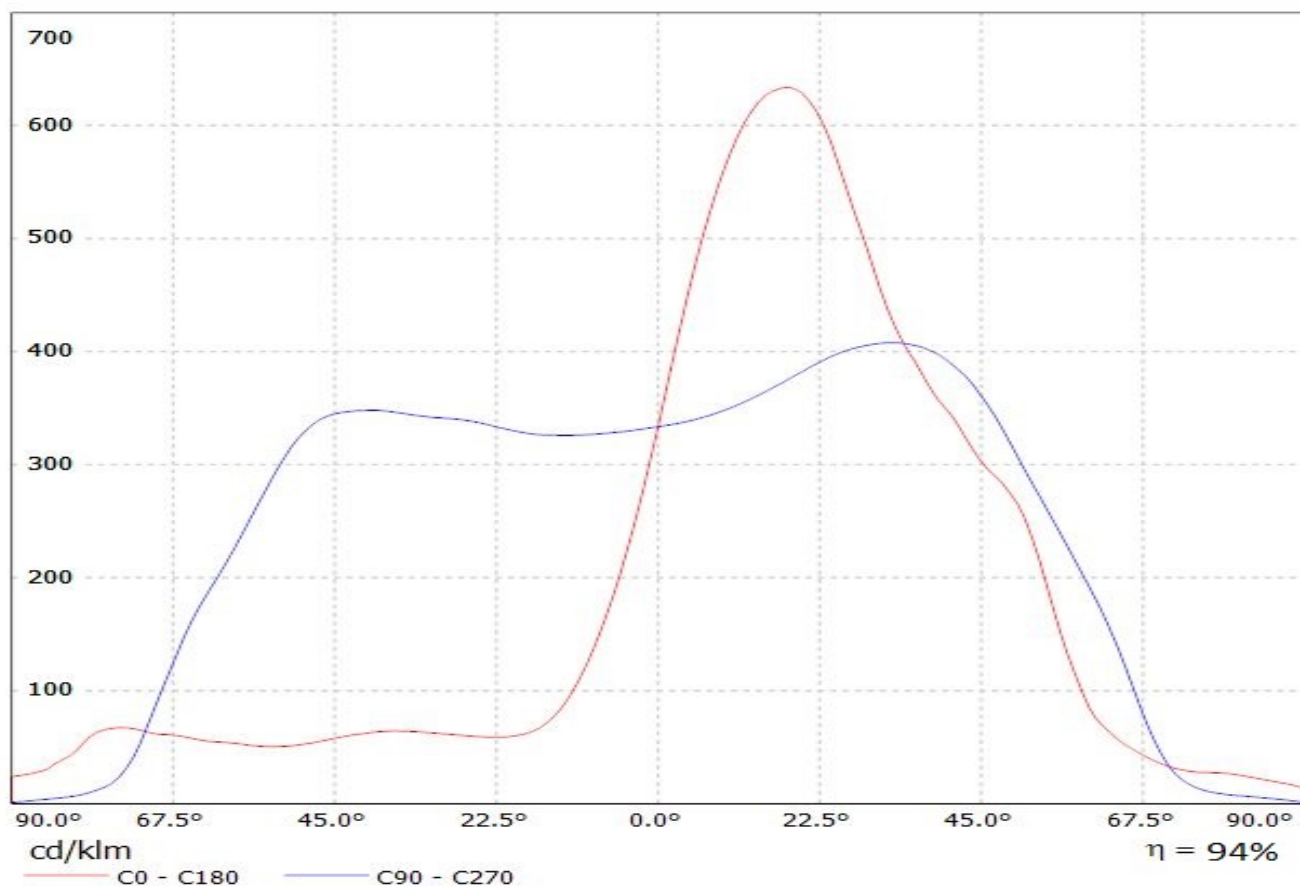

Luminaire: Ledil F15244_FLORENCE-ZT25-S_(LG5630)
Lamps: 1 x LG5630_780.082lm@100mA_P=4.53418W_I=0.100A

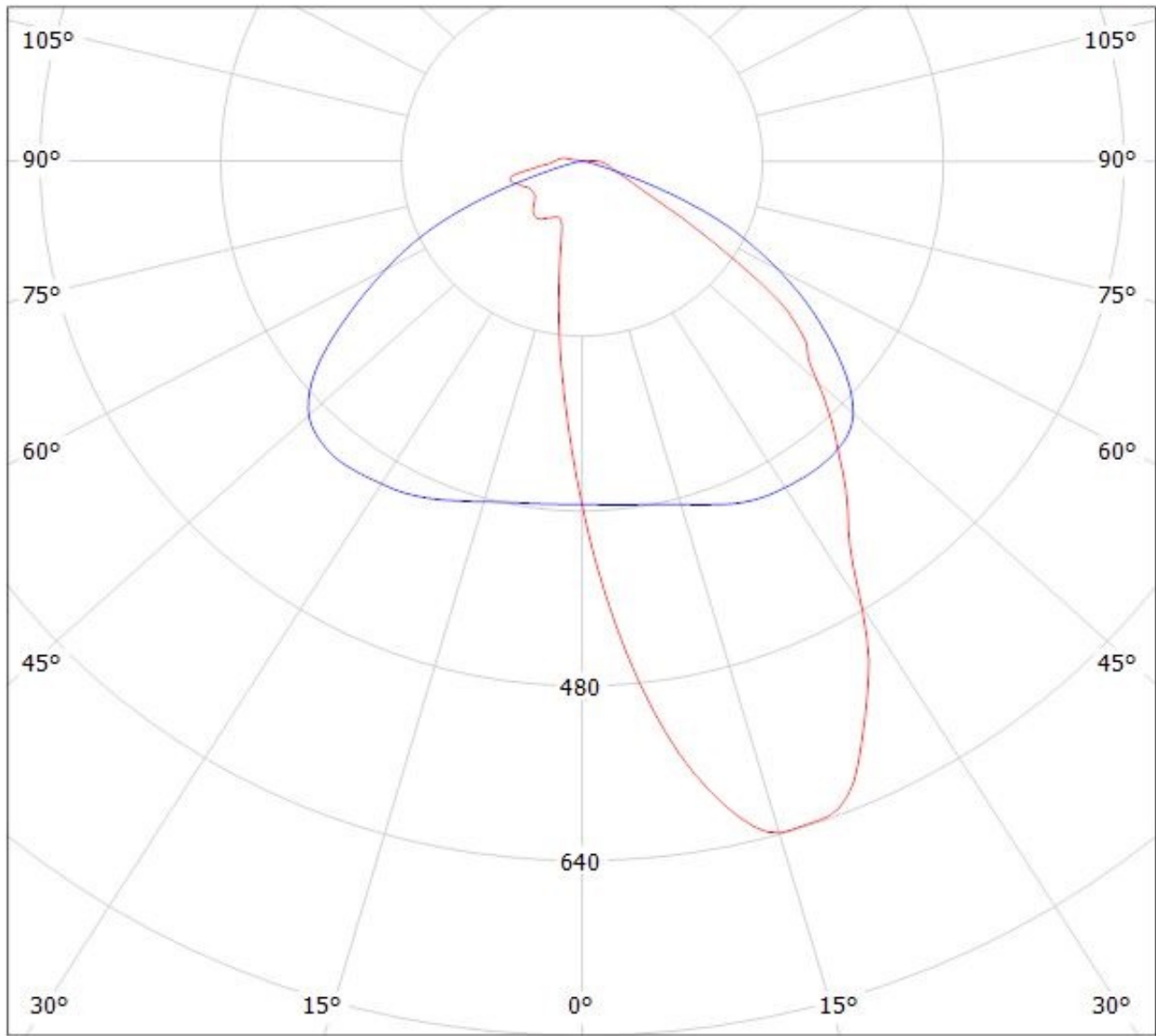

cd/klm

— C0 - C180 — C90 - C270

$\eta = 94\%$

Luminaire: Ledil F15244_FLORENCE-ZT25-S_(Duris_E5)

Lamps: 1 x Osram_Duris_E5_584.783lm@120mA_P=3.68532W_I=0.120A

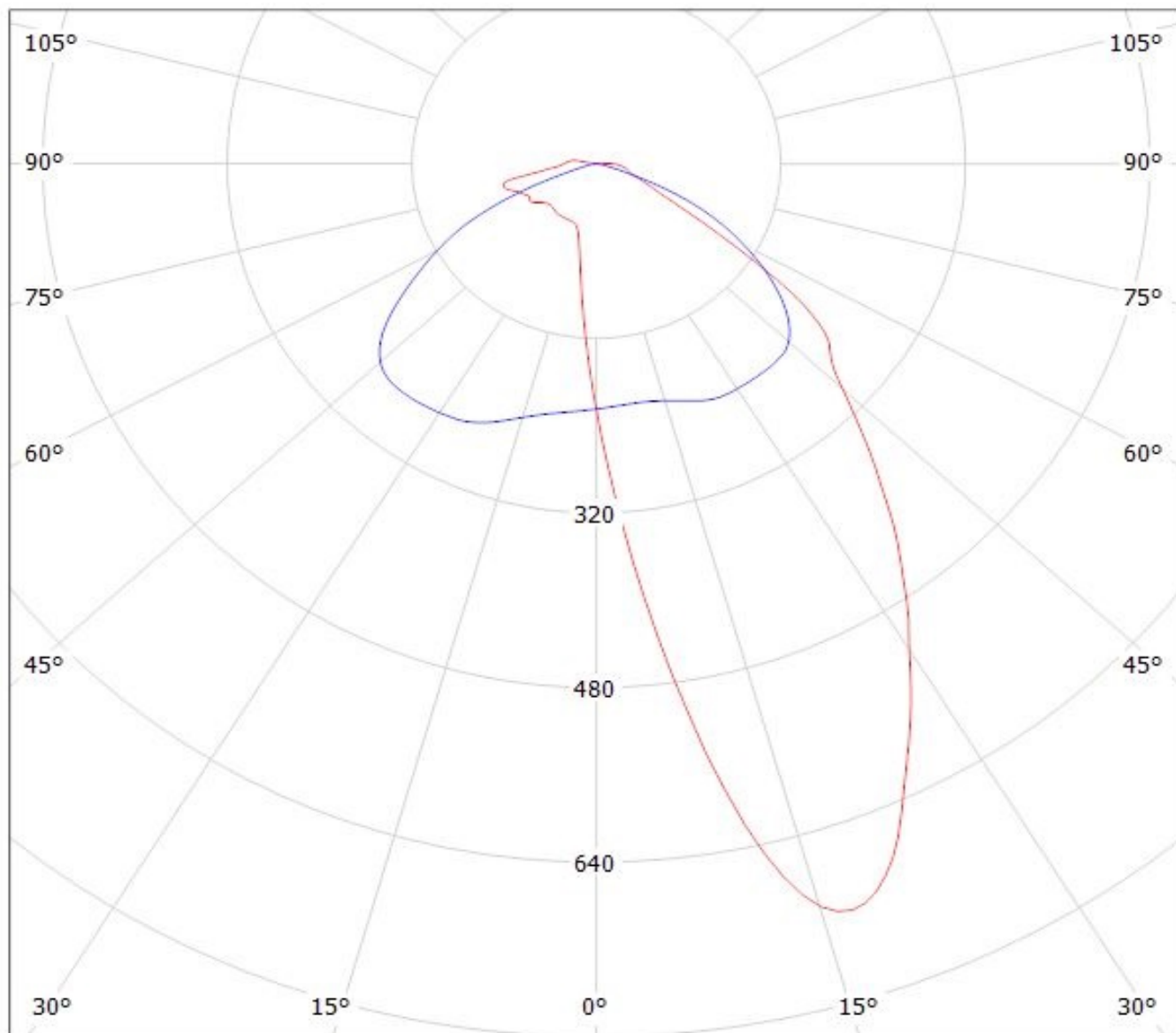

cd/klm

— C0 - C180

— C90 - C270

$\eta = 94\%$

Luminaire: Ledil F15244_FLORENCE-ZT25-S_(LM561B+)_cav1
Lamps: 1 x LM561B+1343.71lm@120mA_P=8.13375W_ℓ=0.250A

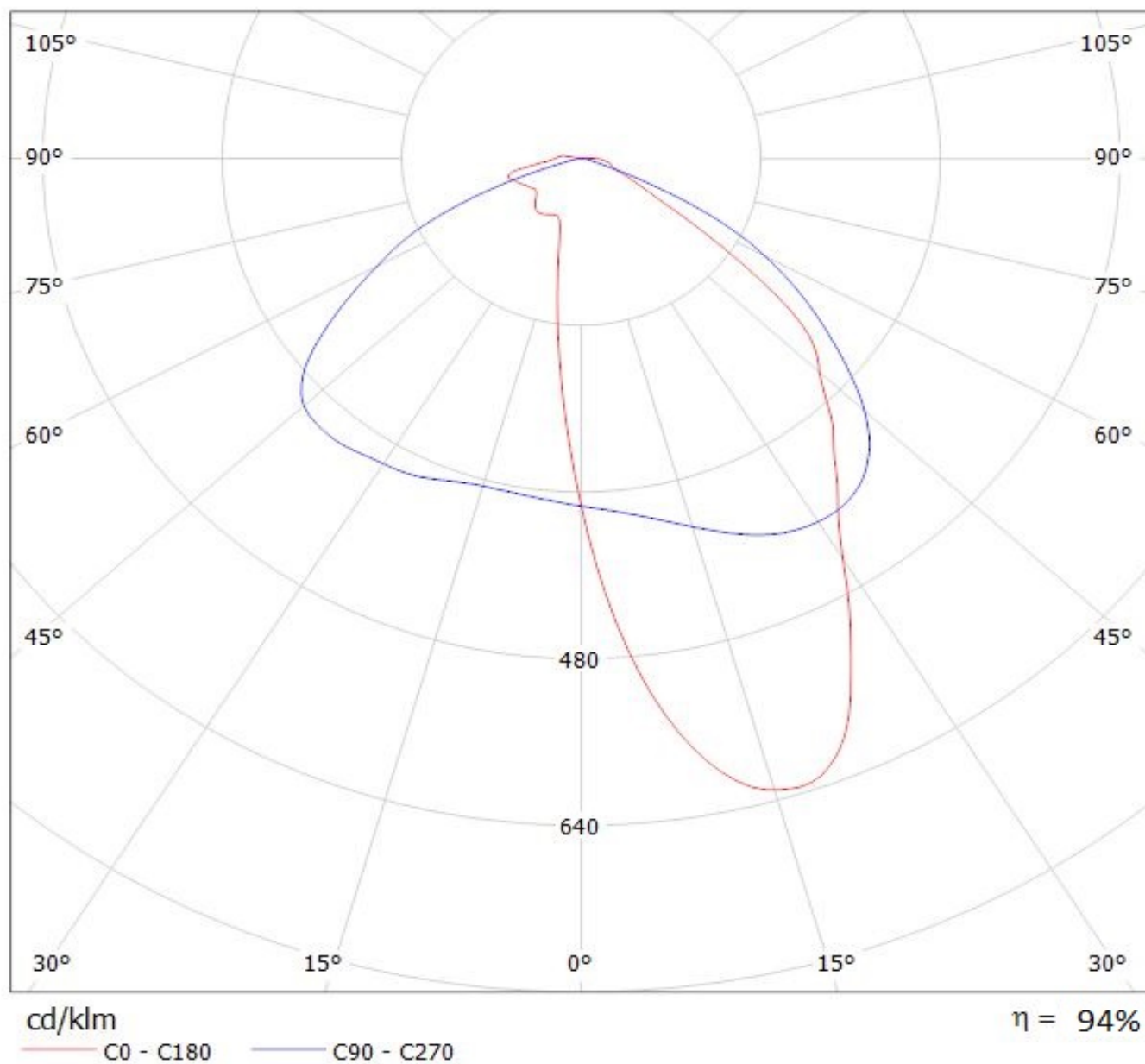

NOTE: The typical divergence will be changed by different color, chip size and chip position tolerance. The typical total divergence is the full angle measured where the luminous intensity is half of the peak value.