

THIS DRAWING IS UNPUBLISHED. RELEASED FOR PUBLICATION 12, 2002.  
 © COPYRIGHT 2002 BY TYCO ELECTRONICS CORPORATION. ALL RIGHTS RESERVED.

LOC	DIST	REVISIONS			
P	LTR	DESCRIPTION	DATE	DWN	APVD
A	40	E	ECN 0150-0589-02	4-02	WH RS

1. TORQUE 8.0 IN-LBS  $\begin{matrix} +1.5 \\ -0.5 \end{matrix}$  IN-LBS BIDIRECTIONAL
2. 5/16" WRENCH HEAD 1055265-1
3. PREVIOUS PART NUMBER 2098-0275-50

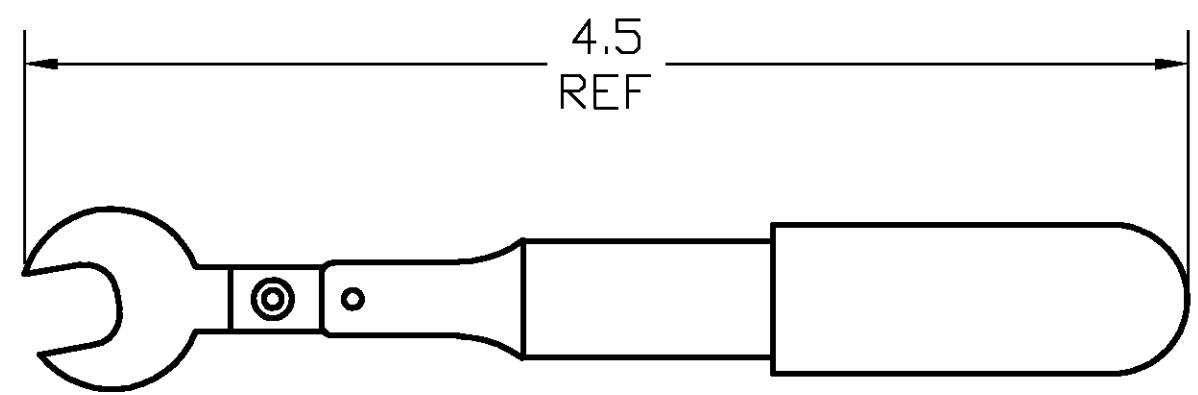

THIS DRAWING IS A CONTROLLED DOCUMENT.		DWN	DAVID STULL	12/12/02	<b>tyco</b> <b>Electronics</b>	Tyco Electronics Corporation		
		CHK	DAVID STULL	12/12/02		Harrisburg, PA 17112		
		APVD	R.SCHAEFFER	12/12/02	NAME			
		PRODUCT SPEC			TORQUE WRENCH FOR			
		APPLICATION SPEC			SMA (OSM) RF CONNECTORS			
		WEIGHT			SIZE	CAGE CODE	DRAWING NO	RESTRICTED TO
		.30 LBS.			A3	00779	1055258	-
		CUSTOMER DRAWING			SCALE	SHEET	OF	REV
					1:1	1	1	E

DIMENSIONS:		TOLERANCES UNLESS OTHERWISE SPECIFIED:	
INCHES		0 PLC	± -
		1 PLC	± -
		2 PLC	± -
		3 PLC	± -
		4 PLC	± -
		ANGLES	± -
MATERIAL		FINISH	
-		NICKEL PLATING	

D  
C  
B  
A

D  
C  
B  
A