

13	12	11	10	9	8	7	6	5	4	3	2	1
MATERIAL NUMBER	ENGINEERING NUMBER	MATERIAL NUMBER TAPE	ENGINEERING NUMBER TAPE	WIRE AWG	MWID $\triangle 4$	ID MIN	INSULATION COLOR					
191640010	SA-269	191640807	SA-269T	22-18	.235/5.97	.054/1.37	RED					
191640040	SB-289	191640315	SB-289T	16-14	.264/6.71	.080/2.03	BLUE					

(A)

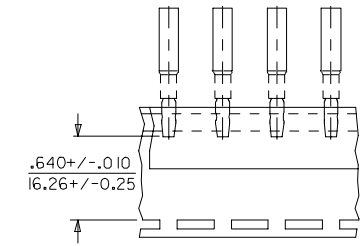

PARTS ON TAPE

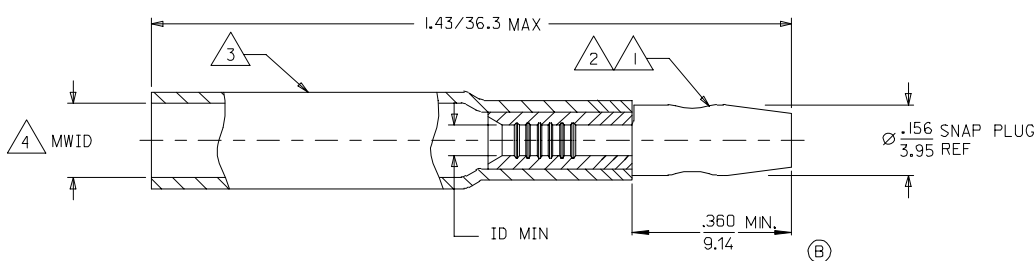

SALES DRAWING

NOTES:

- $\triangle 1$ TERMINAL MATERIAL: COPPER ALLOY
- $\triangle 2$ FINISH: ELECTRO TIN PLATE.
- $\triangle 3$ INSULATION MATERIAL: HEAT SHRINKABLE TUBING WITH HOTMELT ADHESIVE INNER LINER. COLOR: SEE CHART
- $\triangle 4$ MWID = MAXIMUM WIRE INSULATION DIAMETER.

RELEASED FC NO: ETC2007-0054 DRWN: JLOMASTRO 2006/08/16 CHKD: RDEROSS 2006/08/16 APPR: JMACNEIL 2006/08/17 REVISION DESCRIPTION	QUALITY SYMBOLS	GENERAL TOLERANCES (UNLESS SPECIFIED)	DIMENSION STYLE	SCALE	DESIGN UNITS	THIRD ANGLE PROJECTION	
	$\nabla = 0$ $\nabla = 0$	mm INCH	IN/MM	---	INCH		
		4 PLACES ± --- ± ---	DRAWN BY ASAYDEH	DATE 05/12/13	TITLE	.156 BULLET PLUG PERMA-SEAL	
		3 PLACES ± --- ± ---	CHECKED BY JLOMASTRO	DATE 05/12/13			
	2 PLACES ± --- ± ---	APPROVED BY RDEROSS	DATE 05/12/13				
	1 PLACE ± --- ± ---						
	ANGULAR ± --- °						
		DRAFT WHERE APPLICABLE MUST REMAIN WITHIN DIMENSIONS	SEE CHART	MATERIAL NO. SD-19164-031	DOCUMENT NO.	SHEET NO. 1 OF 1	
			SIZE C	THIS DRAWING CONTAINS INFORMATION THAT IS PROPRIETARY TO MOLEX INCORPORATED AND SHOULD NOT BE USED WITHOUT WRITTEN PERMISSION			