

THIS COPY IS PROVIDED ON A RESTRICTED BASIS AND IS NOT TO BE USED IN ANY WAY DETRIMENTAL TO THE INTERESTS OF PANDUIT CORP.

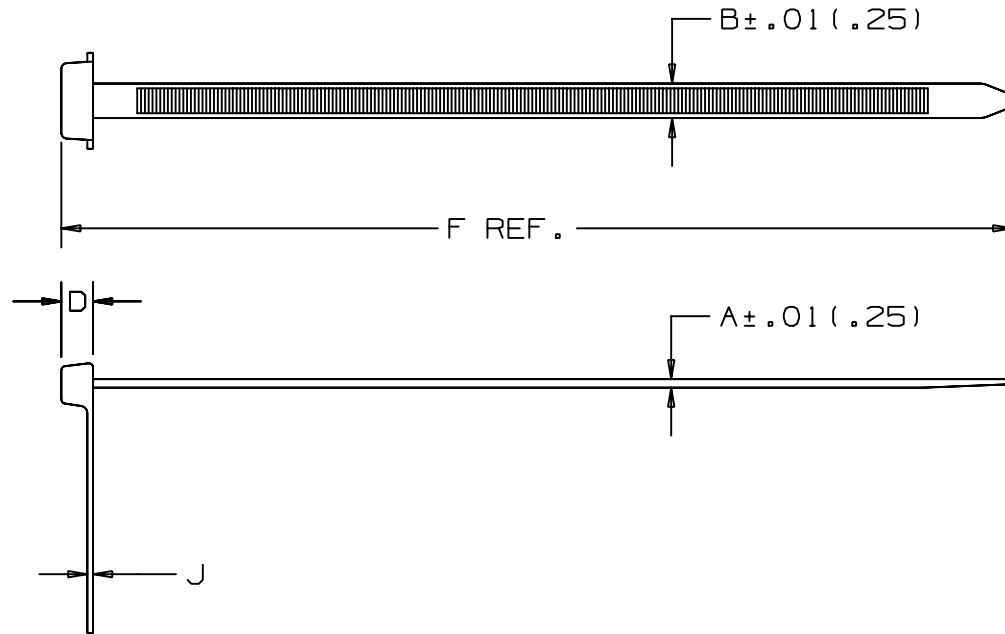
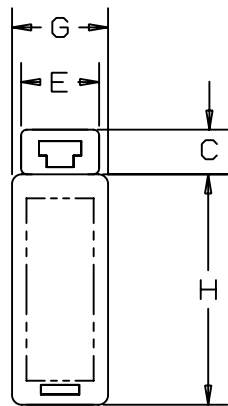

PANDUIT PART NO.*	BUNDLE DIA.		A	B	C	D	E	F	G	H	J	WRITE-ON AREA	MIN. LOOP TENSILE	CROSS- SECTION	WEIGHT
	MIN. in (mm)	MAX. in (mm)	in (mm)	in (mm)	in (mm)	in (mm)	in (mm)	in (mm)	in (mm)	in (mm)	in (mm)	in. (mm)	lbs (N)		lbs/100pcs. (g)
SSM2S	.06 (1.5)	1.75 (45)	.045 (1.1)	.180 (4.6)	.230 (5.8)	.165 (4.2)	.410 (10.4)	6.7 (170)	.50 (12.7)	1.18 (30)	.030 (.8)	.44 x .96 (11.2 x 24.4)	50 (222)	STANDARD	.29 (132)
SSM4S	.06 (1.5)	4.00 (102)	.045 (1.1)	.180 (4.6)	.230 (5.8)	.165 (4.2)	.410 (10.4)	14.9 (378)	.50 (12.7)	1.18 (30)	.030 (.8)	.44 x .96 (11.2 x 24.4)	50 (222)	STANDARD	.55 (249)

NOTES:

- *1) SEE CURRENT PRICE SHEET FOR PART NUMBER SUFFIX DESIGNATION FOR PACKAGE SIZE AND PART COLOR.
- 2) RECOGNIZED UNDER THE COMPONENT PROGRAM OF UNDERWRITERS LABORATORIES INC.

DIMENSIONS IN PARENTHESES ARE IN METRIC UNITS.

PANDUIT CORP. TINLEY PARK, ILLINOIS

STA-STRAP MARKER TIE
SSM SERIES

UNLESS OTHERWISE SPECIFIED,
DIMENSIONAL TOLERANCES ARE:
(.X) ± .005 (.15)
(.XX) ± .02 (.5) ANGLES ± .005 (.15)

UNLESS OTHERWISE SPECIFIED,
ALL DIMENSIONS ARE GIVEN
IN INCHES, THIRD ANGLE PROJECTION.

DRAWN BY
RTF/AJC

MAT'L:

SCALE NONE

DATE
8-8-66

NYLON 6.6

DRAWING NO.

SS-630

DWG
A
SIZE

10	5/31/05	ERW		METRIC CONVERSION CORRECTIONS	630	10									
REV	DATE	BY	CHK	DESCRIPTION	ECN	R	CUST	SUP							