

1 2 3 4 5 6

A

B

C

D

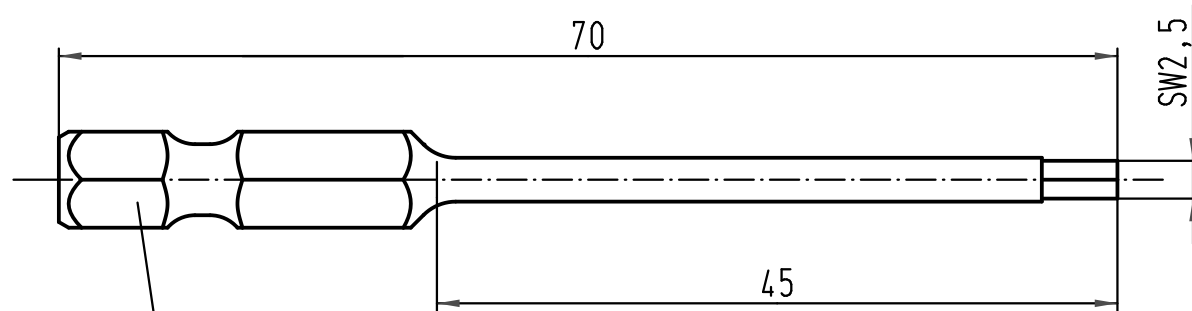

Schaft DIN 3126-E6,3

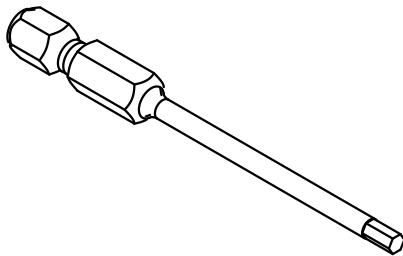

| | | | | | | |
|---|------|-------------------|--------------------------------|------|--|--|
| All Dimensions in mm Original Size DIN A 4 | | Techn. Character. | | | Nicht tolerierte Masse/ Free size tolerances | |
| | | | Dat. | Name | Massstab/ Scale 2:1 | Sechskant-Schraubendreher SW2,5 <i>hexagon screwdriver, SW2,5</i> |
| | | Detail. | 20.02.07 | Bor | | |
| | | Insp. | | Be | | |
| | | Stand. | | | | |
| 412723 | | | HARTING Electric GmbH & Co. KG | | | TB 09 99 000 0375 |
| Mod. | Dat. | Name | D-32339 Espelkamp | | | |
| | | | | | | Sub. |

