

CUT-OFF WHEN THE CRIMPING

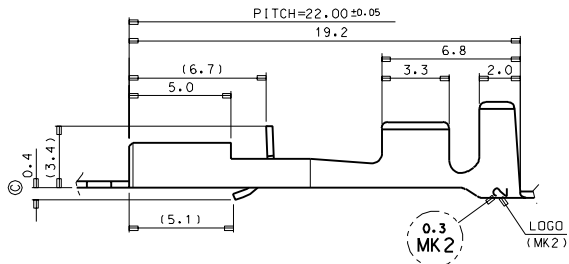

LOGO (MK2)

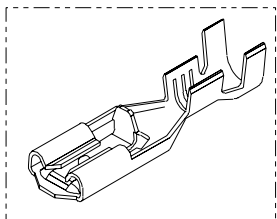

ISOMETRIC VIEW

NOTES

1. MATERIAL : BRASS, 0.30 mm THICKNESS
2. FINISH : PRE-PLATED TIN
3. MATING TAB THICKNESS : 0.30 mm
4. APPLICABLE HOUSING : 35189-0110
5. RECOMMENDED LENGTH OF WIRE STRIP IS 4.4-5.0mm.
6. APPLICABLE WIRE : AWG #20-#16  
INSULATION DIA. :  $\phi$ 1.9-3.4mm

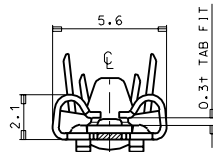

VIEW "A"

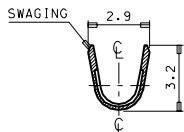

SEC' : B-B"

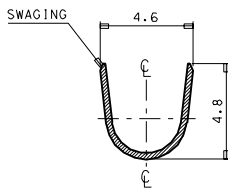

SEC' : C-C"

1	C
1	B
1	A
	REV
	SHT
	REVISION ON CAD ONLY

REVISED EC NO. KDR1997-0160 DRAWN: J.S.KANG 97/12/01 CHKD: B.K.CHOI APPR: G.W.LEE	QUALITY SYMBOLS MAJOR CRITICAL	GENERAL TOLERANCES (UNLESS SPECIFIED) mm    INCH 4 PLACES $\pm 0.1$ $\pm$ 3 PLACES $\pm 0.2$ $\pm$ 2 PLACES $\pm 0.3$ $\pm$ 1 PLACE $\pm 0.3$ $\pm$	SCALE 6/1 DESIGN UNITS <input checked="" type="checkbox"/> mm <input type="checkbox"/> INCH DRAWN BY B. DATE J.S.KANG 97/12/01 CHECKED BY & DATE APPROVED BY & DATE	DIMENSIONS: <input type="checkbox"/> mm <input type="checkbox"/> INCH <input type="checkbox"/> mm ONLY THIRD ANGLE PROJECTION <input checked="" type="checkbox"/>	TITLE: .187 MP-Lock TM'L(M) (0.3+ TAB FIT)	SHEET NO. 1 of 1	
	DESCRIPTION C B A REV	ANGLAR: $\pm 1^\circ$	CAD FILENAME s35068a.dgn	MATERIAL NO. SEE NOTES	DRAWING NO. SD 35068-9812	MOLEX INCORPORATED KOREA	SHEET NO. 1 of 1
	DRAFT WHERE APPLICABLE MUST REMAIN WITHIN DIMENSIONS	THIS DRAWING CONTAINS INFORMATION THAT IS PROPRIETARY TO MOLEX INCORPORATED AND SHOULD NOT BE USED WITHOUT WRITTEN PERMISSION.	INCORPORATED AND SHOULD NOT BE USED WITHOUT WRITTEN PERMISSION.	SEE NOTES	DRAWING NO. SD 35068-9812	SHEET NO. 1 of 1	B
							MX-A3