



961 Series

Rectangular Non-Relampable Snap-fit Panel Mount Indicator



Overview

The 961 Series non-relampable snap mount rectangular indicator lights are designed for mounting into a 1.281" x .395" hole with panel thickness ranges from .045" to .090".

Specifications

Housing: White Nylon (standard), black optional, other color available to special order.

Bezel: Sulfamate Nickel Plated.

Terminations: Wire leads: Black #18 wire gauge, PVC plastic insulated. UL-CSA rated at 105°C. 6" long. 1/2" stripped. Terminal: Brass, Tin-plated 1/4" or 3/16" quick connect.

Incandescent AC or DC Voltage options: 6 to 28 volts.

High Brightness Neon AC Voltage options: 125 to 250 volts.

Lens: Heat resistant, high strength polycarbonate. Fluted (standard). Smooth face available to special order.

Lens Marking: Lenses can be stamped. Contact Sales.

Mounting: Designed to snap securely into a 1.281" x .395" hole. Panel thickness ranges from .045" to .090"

Note: Assemblies "No-Lens" - Body Only - are not cURus

Dimensions

All dimensions in inches.

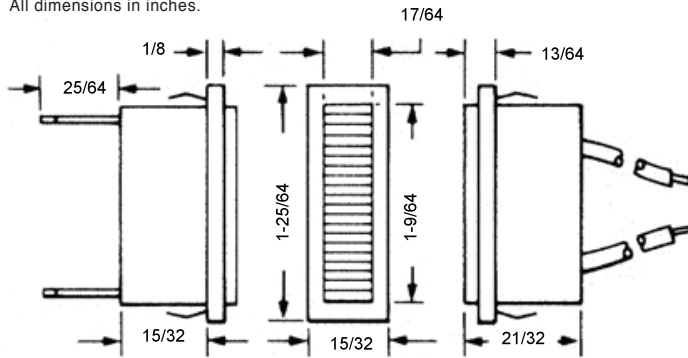

Wire Leads Version

0.187" Q.C. Terminals Version

0.250" Q.C. Terminals Version

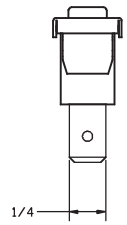
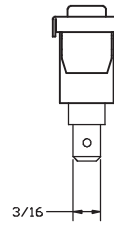
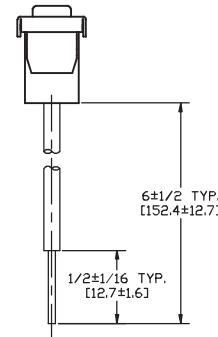

Ordering Information

EXAMPLE 961 6 71 T 90 W AN											
Chrome Plated Bezel		Wire Leads		250 Volt Neon Lamp			Built-in 150K OHM	Rectangular Fluted Lens	White Housing	Amber Non-Diffusing Lens	
Series Number	Termination	Lamp				Resistor	Lens Type	Housing Color	Lens Color		
		Code	Volts	MA	Life(Hrs)						
961 Chrome Plated Bezel	6 6" Wire Leads	10	6.0	40	10,000	X None (No Resistor required with incandescent lamps)	90 ⁵ Rectangular (Fluted) Standard	W White (Standard)	Nondiffusing (Clear)		
		12	6.3	200	5,000				AN Amber		
		02	6.3	200	20,000				BN Colorless		
		13	14.0	80	1,500				CN Green		
		03	14.0	80	15,000				RN Red		
		15	28.0	40	4,000				WN White (Cloudy)		
	7 187" Q.C. Terminals	NEON (High Brightness)						91 Rectangular (Smooth) Optional	B Black (Optional)	Translucent ⁶	
		70 ²	125	1/3 W	10,000		A 22K OHM			AT Amber	
		70 ²	250	1/3 W	10,000		T 150K OHM			BT Colorless	
		56 ³	125	1/3 W	10,000		B 30K OHM			GT Green	
8 .250 Q.C. Terminals	56 ³	250	1/3 W	10,000	E 100K OHM	RT Red					
	57 ⁴	125	1/3 W	10,000	B 30K OHM	WT White					
		57 ⁴	250	1/3 W	10,000	E 100K OHM		YT Yellow			
² Standard Neon. Use with lens color AN, CN, RN, WN, or YN. ³ Green Neon. Use with lens colors CN, GN or WN. ⁴ Blue Neon. Use with lens color BN, CN, or WN. ⁵ Only with nondiffusing lens colors. ⁶ Do not use with neon lamps.											

Compliances and Approvals

