

1	2	3	4	5	6	7	8
A	A	B	B	C	C	D	D

SHEET 1 OF 1

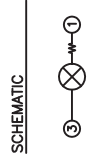
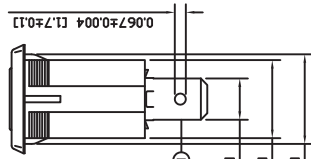
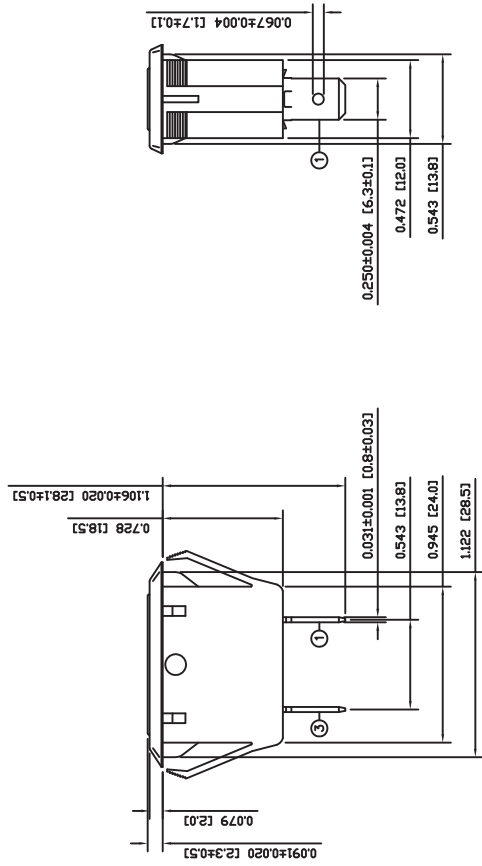
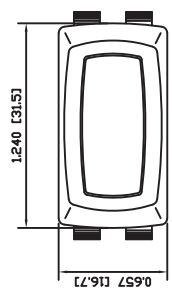

SPECIFICATIONS
 FUNCTION: Signal Light
 ILLUMINATION VOLTAGE: 250V
 APPROVALS: **RoHS** COMPLIANT

COLORS AND MARKINGS
 BODY: Black
 ACTUATOR: Transparent Green
 MARKINGS: None
 MARKING COLOR: None

MATERIALS
 BODY: Polyamide 6/6 (PA66), UL94 V-2
 ACTUATOR: Polycarbonate (PC), UL94 V-2
 LAMP: Neon Bulb
 TERMINALS: Silver Plated Brass

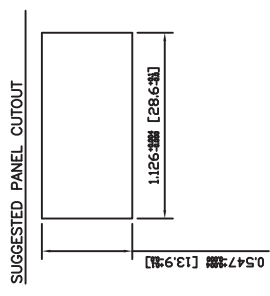

ACTUATOR	A	09/08/13	CAB
BODY	B	10/05/10	CAB
COLORS	A	09/08/13	CAB
MATERIALS	A	09/08/13	CAB
SPECIFICATIONS	A	10/01/27	CAB
REFERENCE	REV.	DATE	BY

B	A	18835	11/02/04	CAB
CHANGED	INITIAL RELEASE	18837	10/02/04	CAB
DESCRIPTION	DESCRIPTION	FOR	DATE	DRAWN BY

INCHES [MILLIMETERS]	±0.008 [±0.2]	±1'
DIMENSIONS	±0.008 [±0.2]	±1'
GENERAL TOLERANCES		
SCALE	DRAWING NOT TO SCALE	PROJECTION
TEST NUMBER	14-RSC14001000137	DATE
REVISION	FEBRUARY 4, 2010	REVISION

E-SWITCH **LAMB INDUSTRIES**

TITLE: RSC14001000-137

PRODUCTION: FEBRUARY 4, 2010

REVISION: A