

MALE PCB PINS

SOLDER TERMINAL TURRETS

2810

2810-X-00-XX-00-00-07-0

Swage mount in 3,0 hole

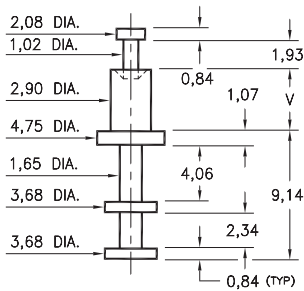

Basic Part Number	Board Thickness	Length V
2810-2	1,57	2,67
2810-3	2,39	3,43
2810-4	3,18	4,19

2524

2524-X-00-XX-00-00-07-0

Swage mount in 2,34 hole

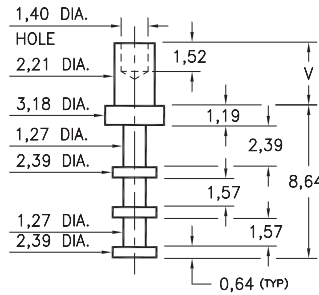

Basic Part Number	Board Thickness	Length V
2524-1	0,79	1,91
2524-2	1,57	2,67
2524-3	2,39	3,43
2524-4	3,18	4,19

2561

2561-X-00-XX-00-00-07-0

Swage mount in 2,39 hole

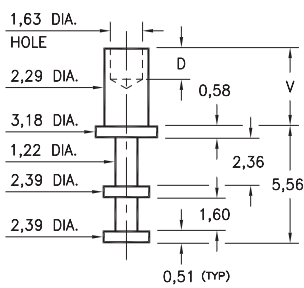

2508

2508-X-00-XX-00-00-07-0

Swage mount in 2,39 hole

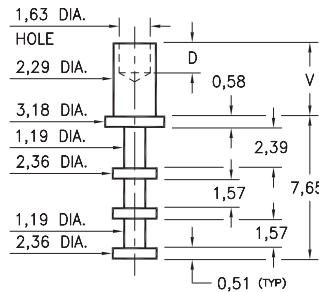

Basic Part Number	Board Thickness	Length V	Depth D
25XX-1	0,79	1,60	1,19
25XX-2	1,57	2,39	1,57
25XX-3	2,39	3,18	1,57
25XX-4	3,18	3,96	1,57

2551

2551-X-00-XX-00-00-07-0

Swage mount in 2,39 hole

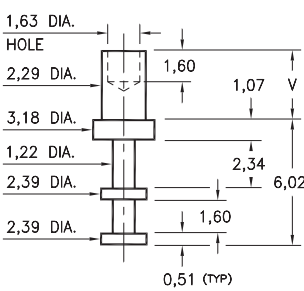

Basic Part Number	Board Thickness	Length V
2551-1	0,79	1,91
2551-2	1,57	2,67
2551-3	2,39	3,43
2551-4	3,18	4,19

2812

2812-X-00-XX-00-00-07-0

Swage mount in 2,95 hole

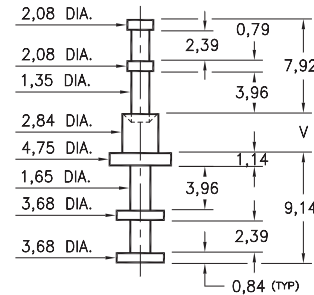

Basic Part Number	Board Thickness	Length V
2812-1	1,57	2,67
2812-2	2,39	3,43
2812-3	3,18	4,19
2812-4	4,78	5,84

SPECIFICATIONS:

Pin Material: Brass Alloy 360, 1/2 Hard
(Swage pins are annealed)

Dimensions: Millimeters

Tolerances On: Lengths: $\pm 0,13$
Diameters: $\pm 0,051$
Angles: $\pm 2^\circ$



ORDER CODE: **XXXX - X - 00 - XX - 00 - 00 - 07 - 0**

BASIC PART #

SPECIFY PIN FINISH:

- 01** 5,08 μ m TIN/LEAD OVER NICKEL
- 80** 5,08 μ m TIN OVER NICKEL (RoHS)
- 44** 7,62 μ m SILVER OVER COPPER (RoHS)
- 50** 7,62 μ m ELECTRO-SOLDER
(60/40 SnPb)

