

REVISIONS			
REV	DESCRIPTION, ECN, EAR NO.	DATE	APP'D
A	PROPOSAL	JAN16/19	L.CHAN

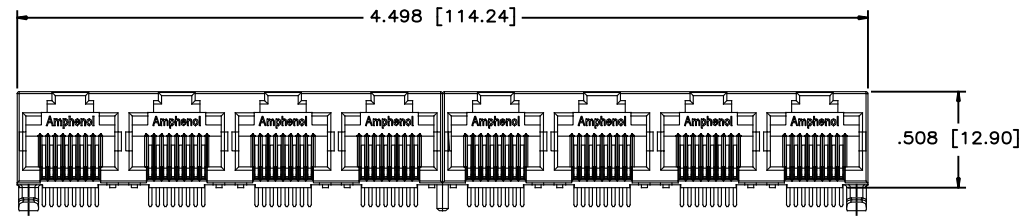

TOP VIEW

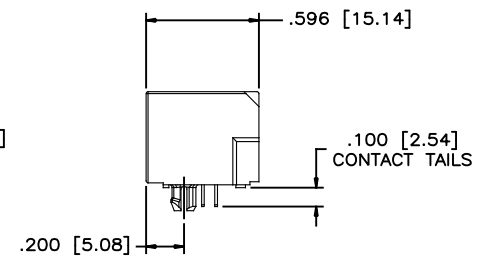

SIDE VIEW

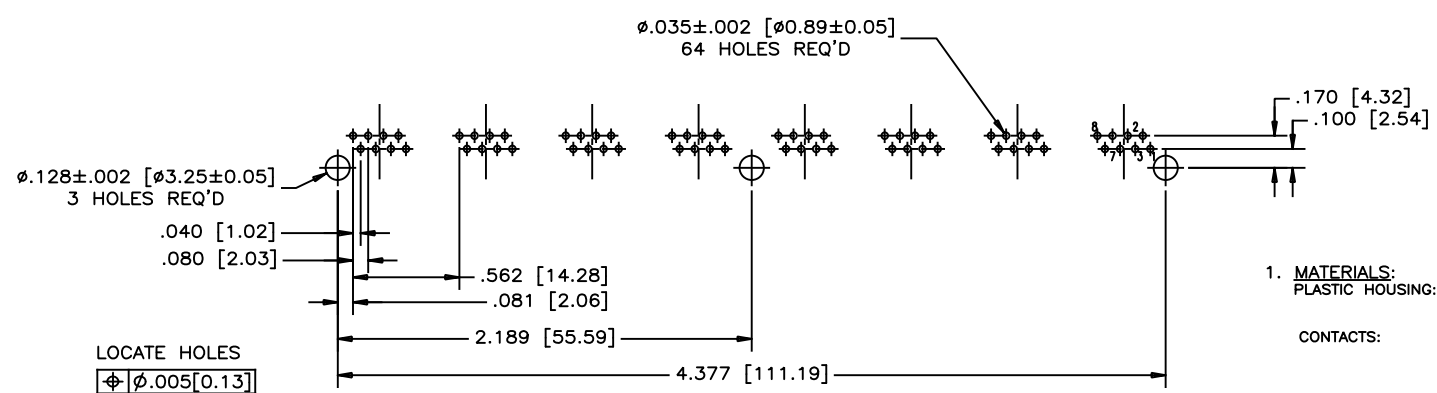

LOCATE HOLES
 $\phi .005 [0.13]$
 POSITION DIMENSIONS ARE BASIC

RECOMMENDED P.C.B. LAYOUT
 (COMPONENT SIDE OF BOARD)

- MATERIALS:**
 PLASTIC HOUSING: HIGH TEMPERATURE THERMOPLASTIC
 FLAMMABILITY RATING UL 94V-0, COLOUR: BLACK

 CONTACTS: PHOSPHOR BRONZE
 PLATING: SELECTIVE GOLD PLATING ON MATING SURFACES,
 SEE AMPHENOL PART NUMBER FOR DETAIL.
 50 μ " [1.27 MICRONS] MIN. NICKEL UNDERPLATE
 100 μ " [2.54 MICRONS] MIN. MATTE TIN ON CONTACT TAILS
- RECOMMENDED SOLDERING TEMPERATURE:**
 WAVE SOLDERING AT 260° C MAXIMUM FOR 5 SEC MAXIMUM.
- PART NUMBER:** RJE39-888-0X00

- GOLD PLATING OPTION
 0=GOLD FLASH
 1=6u" GOLD PLATING
 2=15u" GOLD PLATING
 3=30u" GOLD PLATING
 4=50u" GOLD PLATING

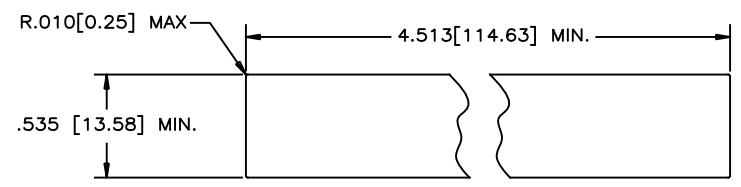

RECOMMENDED PANEL CUTOUT

UNLESS SPECIFIED OTHERWISE		DRAWN	W.QIU	DATE	JAN16/19
PRIMARY UNITS	INCH	CHECKED	L.CHAN	DATE	JAN16/19
SECONDARY	MILLIMETER	M.E.	APP'D		
REFERENCE IN PARENTHESES		Q.A.	APP'D		
GENERAL TOLERANCES		DWG APPR.			
1 DECIMAL PLACE	±0.025	ENG. REL. NO.			
2 DECIMAL PLACES	±0.020	REF.			
3 DECIMAL PLACES	±0.015	THIRD ANGLE PROJECTION			
ANGULAR DEGREES	±1.0°	DO NOT SCALE DRAWING			

Amphenol Canada Corp.
 Commercial Products

TITLE
 8 PORT HIGH SPEED MODULAR JACK,
 8 POSITIONS, 8 CONTACTS, UNSHIELDED,
 WITHOUT LEDS- RoHS COMPLIANT

DWG. NO.
 P-RJE39-888-0X00

REV
 A

CODE ID NO. 03554 | DWG SIZE: C | SCALE: N/A | SHEET 1 OF 1