

REV.	DATE	DESCRIPTION
A	09/29/98	ADD X-SECTION OF BODY

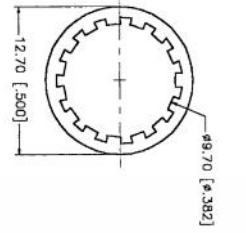

DESCRIPTION	MATERIAL	FINISH	UNLESS OTHERWISE SPECIFIED, DIMENSIONS IN [] ARE IN INCHES FOR COUNTRY REFERENCED ONLY.	APPROVALS	DATE
1 BODY	BRASS	NICKEL		DRAWN	
2 INSULATOR	TEFLON	NATURAL		CHECKED	
3 CONTACT PIN	PHOS. BRONZE	GOLD	TOLERANCES FOR UNLESS OTHERWISE SPECIFIED ARE:	ISSUED	
4 FERRULE	BRASS	NICKEL	6-30 = ± 0.4		
5 LOCK WASHER	BRASS	NICKEL	30-120 = ± 0.6		
6 HEX NUT	BRASS	NICKEL	120-315 = ± 1.6		
7			315-1000 = ± 1.6		
8			1000-2000 = ± 2.4		

DO NOT SCALE DRAWING

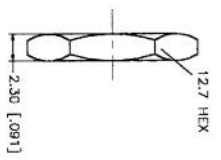
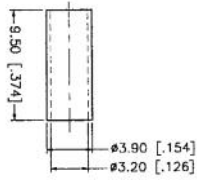
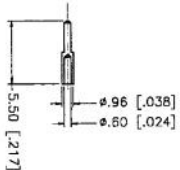
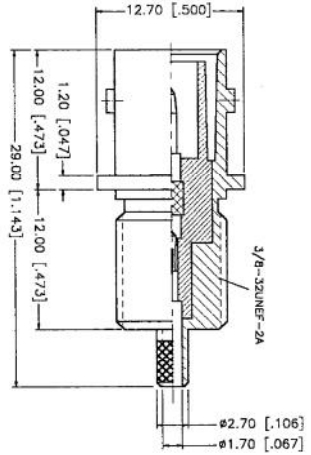
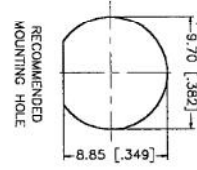
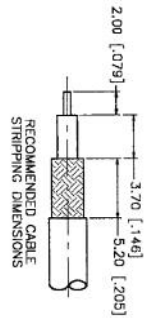

TITLE BNC REVERSE POLARIZED BULKHEAD CRIMP JACK
 FRONT MOUNT- 174, 188, 316 CABLE

SCALE NA PART NO. 112587-RP SHEET 1 OF 1