

Distributed by:

JAMECO[®]
ELECTRONICS

www.Jameco.com ♦ 1-800-831-4242

The content and copyrights of the attached
material are the property of its owner.

Jameco Part Number 658638

REV.	DATE	DESCRIPTION
A	11/25/03	UPDATE DRAWING FORMAT

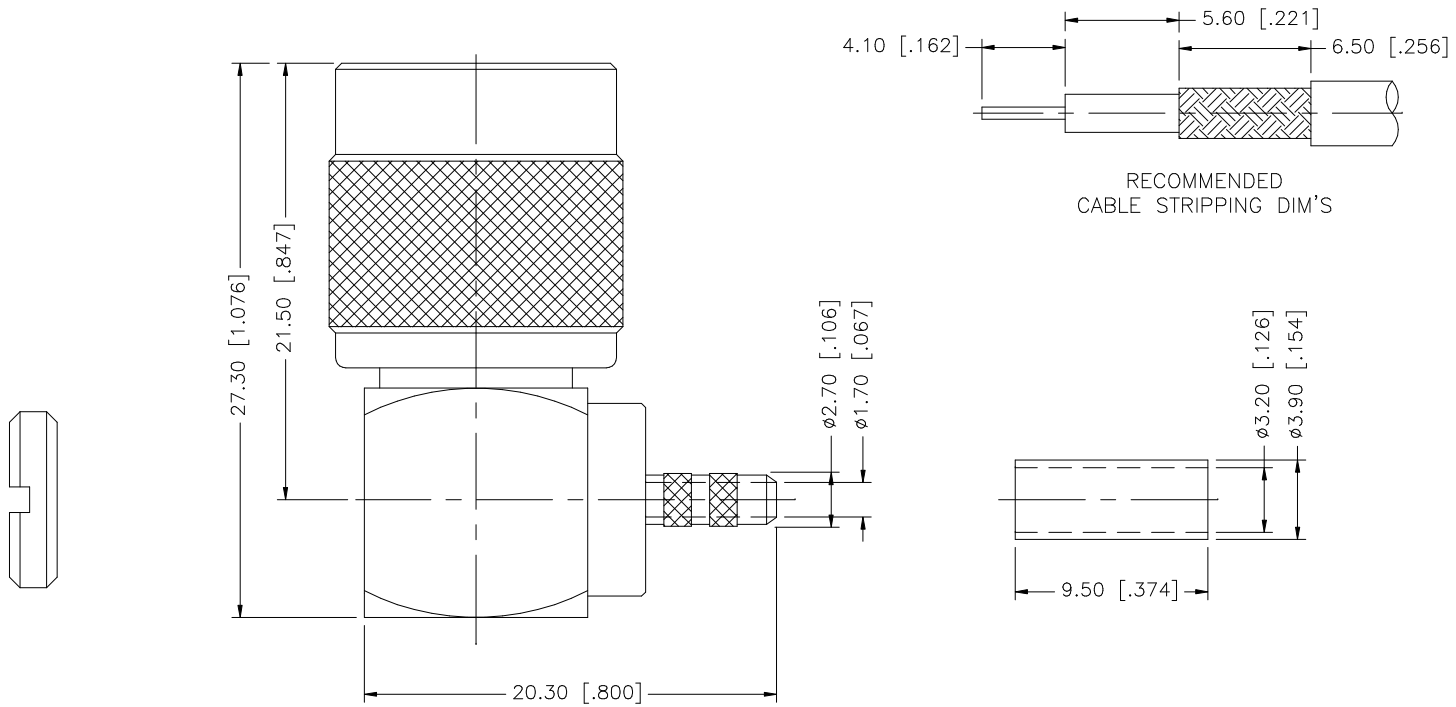

DESCRIPTION	MATERIAL	FINISH	QTY	DO NOT SCALE DRAWING	APPROVALS	DATE	Amphenol Connex					
8					DRAWN	G.R.S.	11/25/03	PART DESCRIPTION TNC R/A CRIMP PLUG (FOR RG174/U, 188A/U, 316/U CABLE)				
7					CHECKED		PART NO. 122148					
6					ISSUED		DWG. NO. 122148.DWG					
5	NUT	BRASS	NICKEL	1	SHEET	1 OF 1	REV.	A	SIZE	A	SCALE	NA
4	FERRULE	BRASS	NICKEL	1	UNLESS OTHERWISE SPECIFIED DIMENSIONS ARE IN MILLIMETERS. DIMENSIONS IN [] ARE IN INCHES AND FOR CUSTOMER REFERENCE ONLY.							
3	CONTACT PIN	BRASS	GOLD	1	UNLESS OTHERWISE SPECIFIED TOLERANCES FOR MILLIMETERS ARE: 0.5 - 8mm ± 0.20mm 8 - 30mm ± 0.40mm 30 - 120mm ± 0.50mm							
2	INSULATOR	DELRIIN	NATURAL	1	UNLESS OTHERWISE SPECIFIED TOLERANCES FOR INCHES ARE: .020 - .315 = ± 0.007" .315 - 1.180 = ± 0.015" 1.180 - 4.724 = ± 0.020"							
1	BODY	BRASS	NICKEL	1	CAD FILE C:/122/122148.DWG							