

REV.	DATE	DESCRIPTION
NC	05/18/03	INITIAL RELEASE

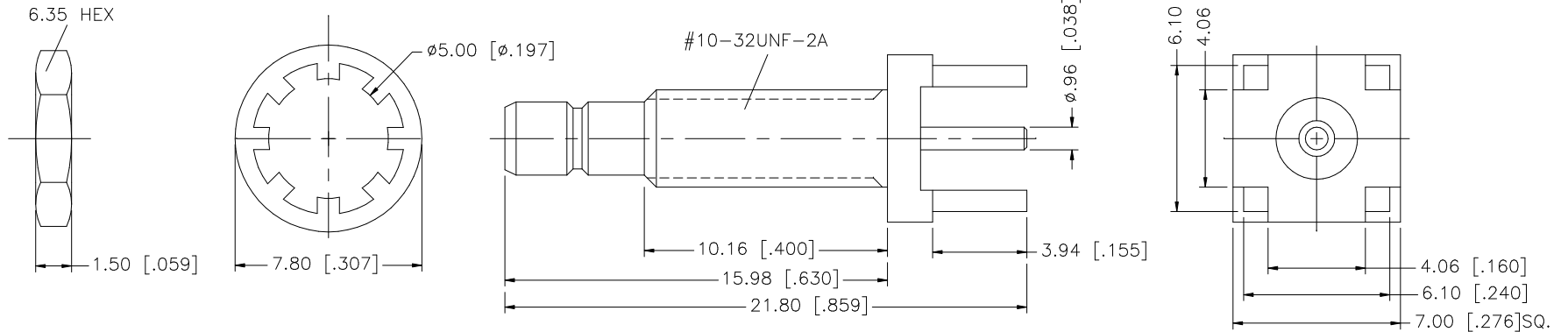
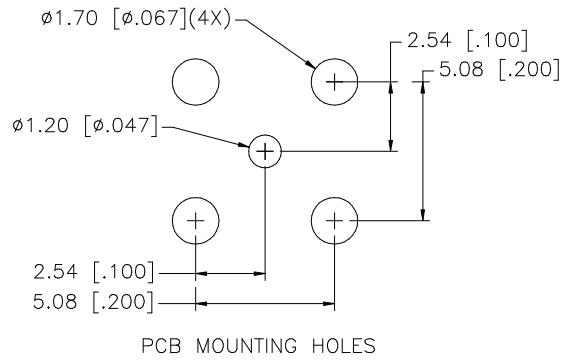

REV.	DATE	DESCRIPTION	
NC	05/18/03	INITIAL RELEASE	
8			
7			
6			
5	HEX NUT	BRASS GOLD 1	
4	LOCK WASHER	BRASS GOLD 1	
3	CONTACT PIN	BRASS GOLD 1	
2	INSULATOR	TEFLON NATURAL 1	
1	HOUSING/BODY	BRASS GOLD 1	
	DESCRIPTION	MATERIAL FINISH QTY	
<p>UNLESS OTHERWISE SPECIFIED DIMENSIONS ARE IN MILLIMETERS. DIMENSIONS IN [] ARE IN INCHES AND FOR CUSTOMER REFERENCE ONLY.</p> <p>UNLESS OTHERWISE SPECIFIED TOLERANCES FOR MILLIMETERS ARE: 0.5 - 8mm ± 0.20mm 8 - 30mm ± 0.40mm 30 - 120mm ± 0.50mm</p> <p>UNLESS OTHERWISE SPECIFIED TOLERANCES FOR INCHES ARE: .020 - .315 = ± 0.007" .315 - 1.180 = ± 0.015" 1.180 - 4.724 = ± 0.020"</p> <p>DO NOT SCALE DRAWING</p>			
APPROVALS		DATE	<h1 style="color: blue; margin: 0;">Amphenol Connex</h1> <p style="text-align: center; margin: 5px 0;">PART DESCRIPTION</p> <h2 style="text-align: center; margin: 0;">SMB P.C. MOUNT & BULKHEAD JACK (EXTENDED BODY)</h2> <p style="text-align: center; margin: 5px 0;">PART NO.</p> <h3 style="text-align: center; margin: 0;">142210-10</h3>
DRAWN G.R.S.		05/18/03	
CHECKED			
ISSUED			
SHEET 1 OF 1			
CAD FILE		C:/142/142210-10.DWG	<p>DWG. NO. 142210-10.DWG</p> <p>REV. NC</p> <p>SIZE A</p> <p>SCALE NA</p>