

REV.	DATE	DESCRIPTION
A	04/31/03	UPDATE DRAWING FORMAT

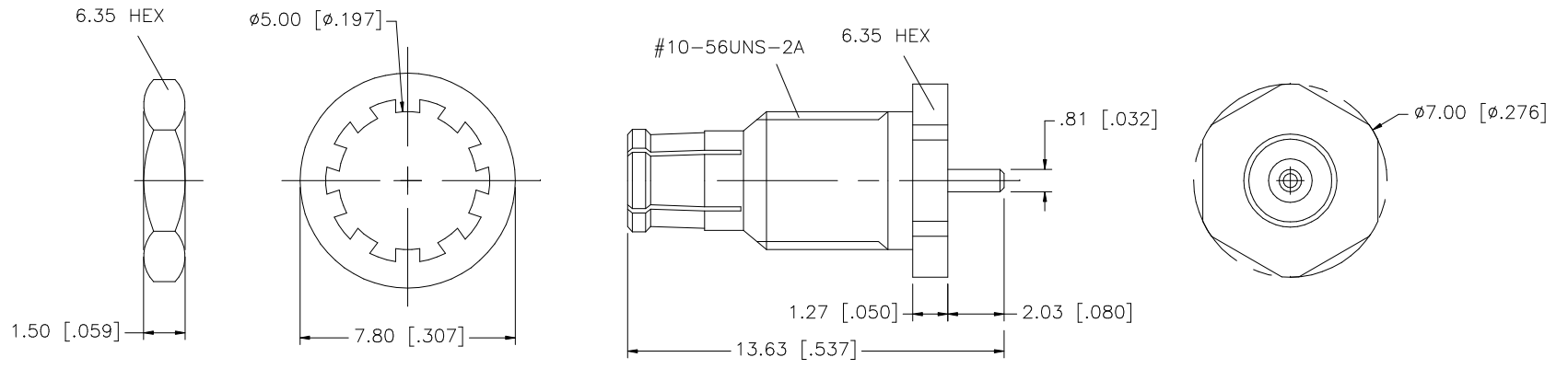

NOTE:
1. MAX. PANEL THICKNESS = 3mm

8					UNLESS OTHERWISE SPECIFIED DIMENSIONS ARE IN MILLIMETERS. DIMENSIONS IN [] ARE IN INCHES AND FOR CUSTOMER REFERENCE ONLY.	APPROVALS	DATE	Amphenol Connex			
7						DRAWN	G.R.S.				04/31/03
6					UNLESS OTHERWISE SPECIFIED TOLERANCES FOR MILLIMETERS ARE: 0.5 - 8mm ± 0.20mm 8 - 30mm ± 0.40mm 30 - 120mm ± 0.50mm	CHECKED		PART DESCRIPTION MCX BULKHEAD PLUG RECEPTACLE			
5	HEX NUT	BRASS	GOLD	1		ISSUED					
4	LOCK WASHER	BRASS	GOLD	1	UNLESS OTHERWISE SPECIFIED TOLERANCES FOR INCHES ARE: .020 - .315 = ± 0.007" .315 - 1.180 = ± 0.015" 1.180 - 4.724 = ± 0.020"	SHEET	1 OF 1	PART NO. 252173			
3	CONTACT PIN	BRASS	GOLD	1		CAD FILE	C:/252/252173.DWG				DWG. NO.
2	INSULATOR	TEFLON	NATURAL	1	DO NOT SCALE DRAWING						
1	BODY	BER. COPPER	GOLD	1							
	DESCRIPTION	MATERIAL	FINISH	QTY							