

NOTES:

1. MATERIALS OF CONSTRUCTION:
 BODY = BRASS, GOLD PLATED (.000030 MIN THICK)
 CUBE BODY = ZINC DIE CAST, NICKEL PLATED (.000200 MIN THICK)
 FEMALE CONTACT = BeCu, GOLD PLATED (.000030 MIN THICK)
 CAP = BRASS, NICKEL PLATED (.000100 MIN THICK)
 FERRULE = SEAMLESS COPPER, NICKEL (.000100 MIN THICK)
 INSULATOR = TEFLON
 SPRING RING = BeCu, NICKEL PLATED (.000100 MIN THICK)
2. ELECTRICAL:
 A. IMPEDANCE: 50 OHM
 B. FREQUENCY RANGE: DC - 4 GHz
 C. VSWR(RETURN LOSS): 1.35 + .04f (GHz), MAX.
 D. DIELECTRIC WITHSTANDING VOLTAGE: 1000 VRMS, MIN.
3. MECHANICAL:
 A. DURABILITY: 500 CYCLES MIN.
 B. TEMPERATURE RANGE: -65° C TO +165° C
4. PACKAGING:
 A. QUANTITY: SINGLE PACK
 B. MARKING: BAG TO BE MARKED
 "AMPHENOL, 903-350P-51A1, AND DATE CODE"

903-350P-51A1		REVISIONS			
DRAWING NO.	REV	DESCRIPTION	DATE	ECO	APPR
THIRD ANGLE PROJ.	--	RELEASE TO MFG.	-----	-----	
	M	SEE SHEET 1	7/11/05	45513	CPM
	N	SEE SHEET 1	11/6/06	46336	CPM

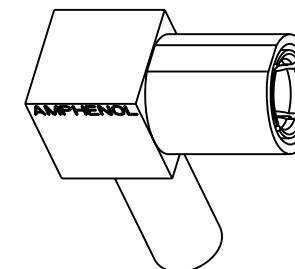

SCALE 2.500

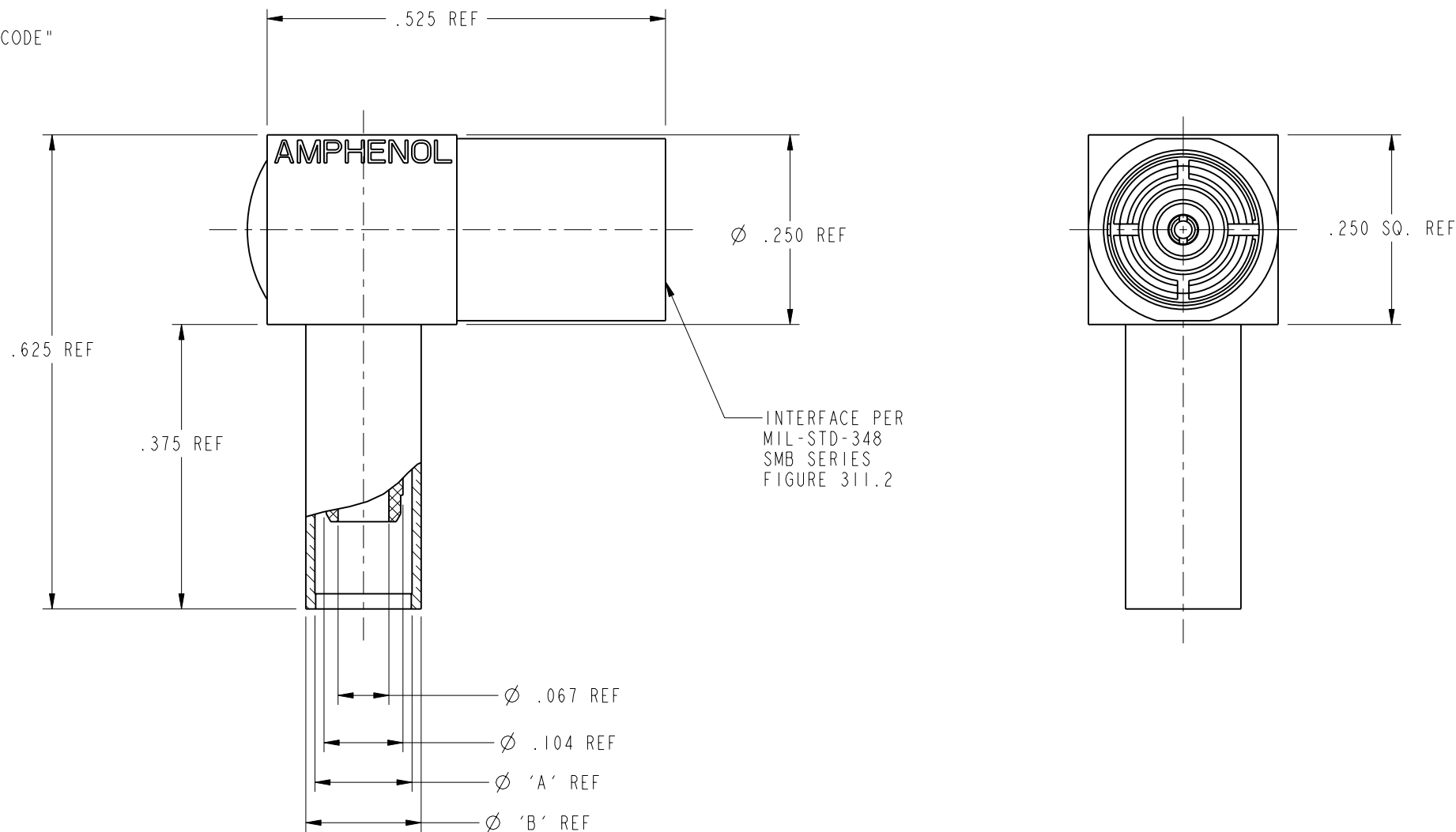

CUSTOMER OUTLINE DRAWING

ALL OTHER SHEETS ARE FOR INTERNAL USE ONLY

UNLESS OTHERWISE SPECIFIED, DIMENSIONS ARE IN INCHES AND TOLERANCES ARE: 2 PLACE DECIMAL 3 PLACE DECIMAL ANGLES $\pm .015$ (0,381 mm) $\pm .005$ (0,127 mm) $\pm 1^\circ$	MATERIAL	DRAWN C. McGRATH	DATE 10/25/04	TITLE SMB 50 OHM R/A PLUG FOR RG-316/U		Amphenol RF Danbury, CT, USA Tainan, Taiwan Shenzhen, China www.amphenolrf.com	
	REFERENCE EAR 111-961389 2 GEN# ASSYM18-SMB 615X-963-100 AGILENT# 1250-0872 REV C	ENGINEER O. BARTHELMES	DATE 10/25/04				
NOTICE - These drawings, specifications, or other data (1) are, and remain the property of Amphenol Corp. (2) must be returned upon request; and (3) are confidential and not to be disclosed to any person other than those to whom they are given by Amphenol Corp. The furnishing of these drawings, specifications, or other data by Amphenol Corp., or to any other person to anyone for any purpose is not to be regarded by implication or otherwise in any manner licensing, granting rights or permitting such holder or any other person to manufacture, use or sell any product, process or design, patented or otherwise, that may in any way be related to or disclosed by said drawings, specifications, or other data.		CAD FILE I:\SMA\903-350P-51A1	CODE ID 74868	DWG SIZE B	DRAWING NO. 903-350P-51A1	SCALE: 5.0:1	SHEET 2 OF 2
						REV N	