

REVISIONS				
REV	DESCRIPTION	DATE	ECO	APPR
01	PROTOTYPE RELEASE	28-Sep-01		MAH

ASSEMBLY INSTRUCTIONS

FOR SEMI-RIGID SIZE .086 (RG-405 TYPE) CABLE CONNECTORS

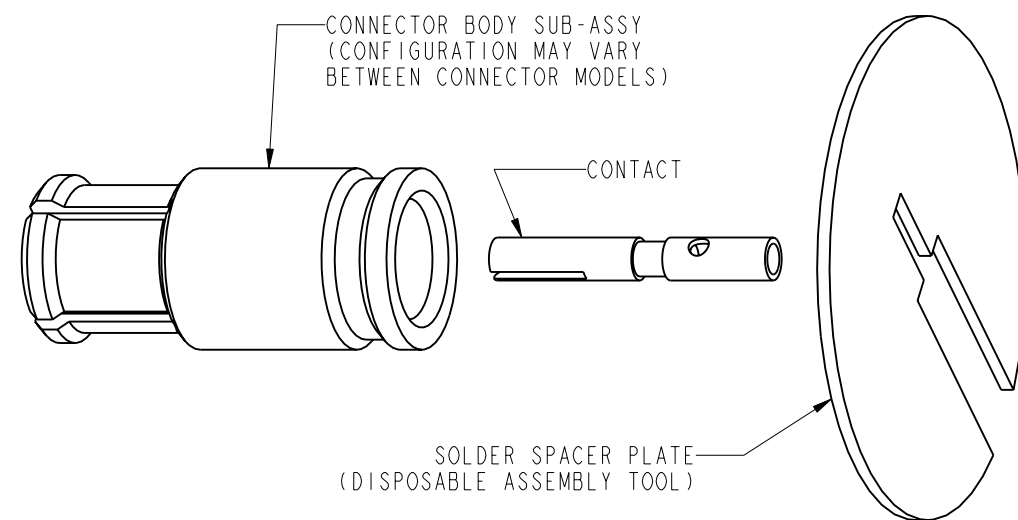

STEP 2:
SOLDER CENTER CONTACT TO CABLE CENTER CONDUCTOR
WHILE MAINTAINING .010 +/- .001 GAP.
(SOLDER FIXTURE RECOMMENDED)

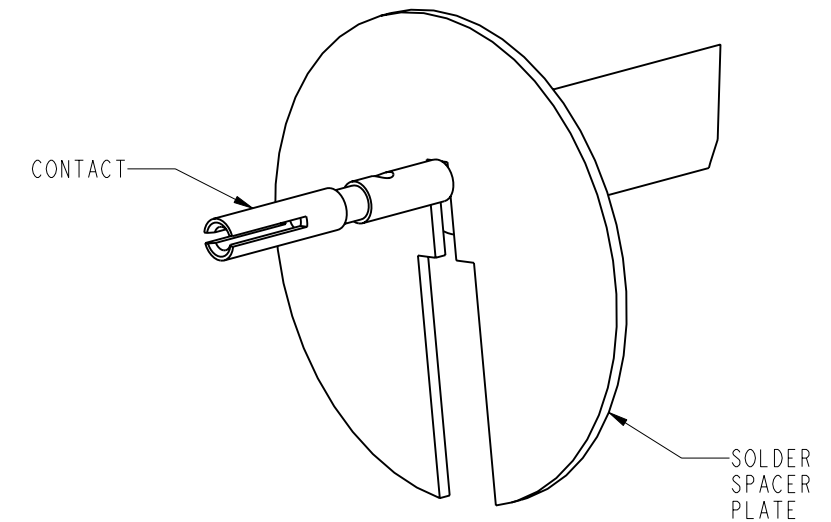

STEP 3:
A. INSERT PREPARED CABLE AND CONTACT INTO BODY UNTIL CABLE
BOTTOMS INTERNALLY.
B. SOLDER OUTER CONDUCTOR OF CABLE TO BODY OF CONNECTOR.
VERIFY INTERFACE DIMENSION OF CONTACT AFTER ASSEMBLY.
CONTACT TO BE FLUSH TO .010" BELOW BODY SURFACE PER
MIL-STD-348. (SOLDER FIXTURE RECOMMENDED)

STEP 1:
PREPARE CABLE AS SHOWN.

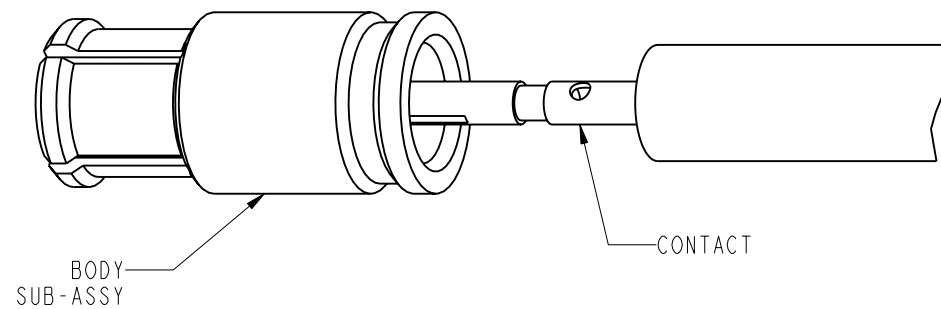
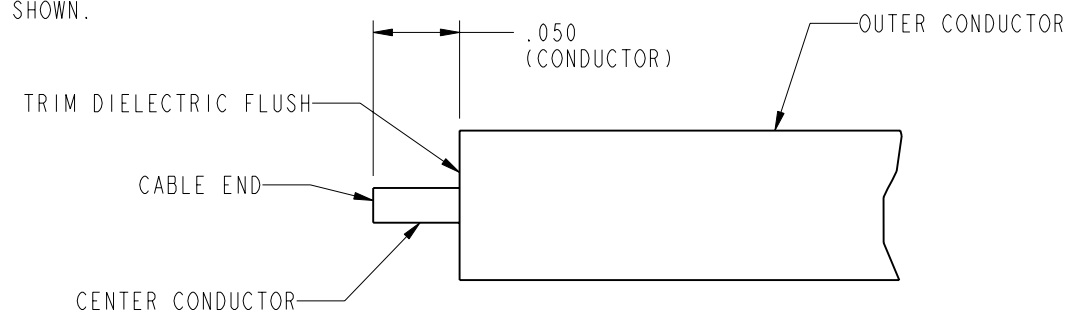

	NAME	DATE		NAME	DATE
PROJ. ENG.	MIKE HOYACK	28-Sep-01	APPD. BY		
CHK. BY			DATE ISSUED		

AMPHENOL CORPORATION DANBURY, CONN.

UNLESS OTHERWISE SPECIFIED DIMENSIONS ARE IN INCHES: AND TOLERANCES ARE:		CODE IDENT.	REV
FRACTIONS	DECIMALS	ANGLES	
± 1/64	± .005	± 1°	
SCALE: NONE		74868	349-50685
			01
		SHEET 1 OF 2	

AMPHENOL CORPORATION DANBURY, CONN.

UNLESS OTHERWISE SPECIFIED DIMENSIONS ARE IN INCHES: AND TOLERANCES ARE:		CODE IDENT.	REV
FRACTIONS	DECIMALS	ANGLES	
± 1/64	± .005	± 1°	
SCALE: NONE		74868	349-50685
			01
		ASSYF2_SMP	SHEET 2 OF 2

REVISIONS				
REV	DESCRIPTION	DATE	ECO	APPR
01	PROTOTYPE RELEASE	01-OCT-01		MAH

ASSEMBLY INSTRUCTIONS

FOR SEMI-RIGID SIZE .047 CABLE CONNECTORS

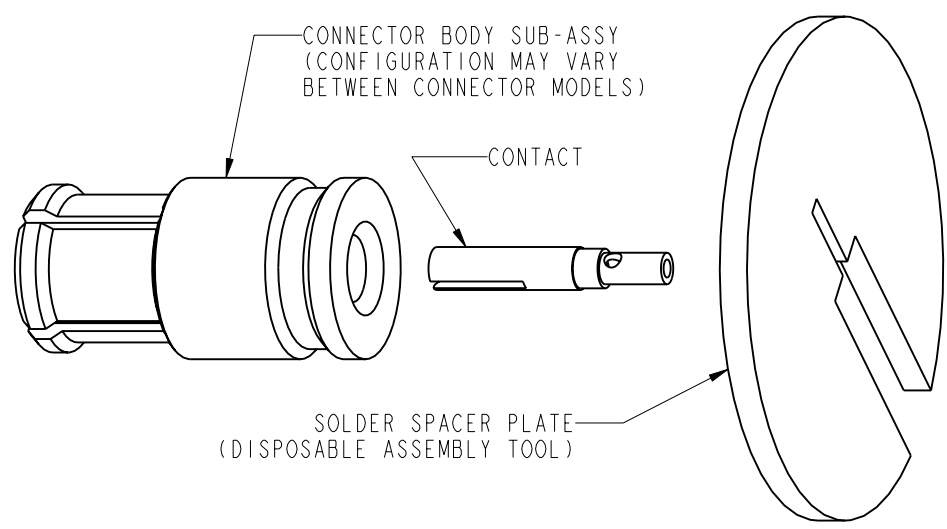

STEP 2:
 SOLDER CENTER CONTACT TO CABLE CENTER CONDUCTOR)
 WHILE MAINTAINING .022 +/- .001 GAP.
 (SOLDER FIXTURE RECOMMENDED)

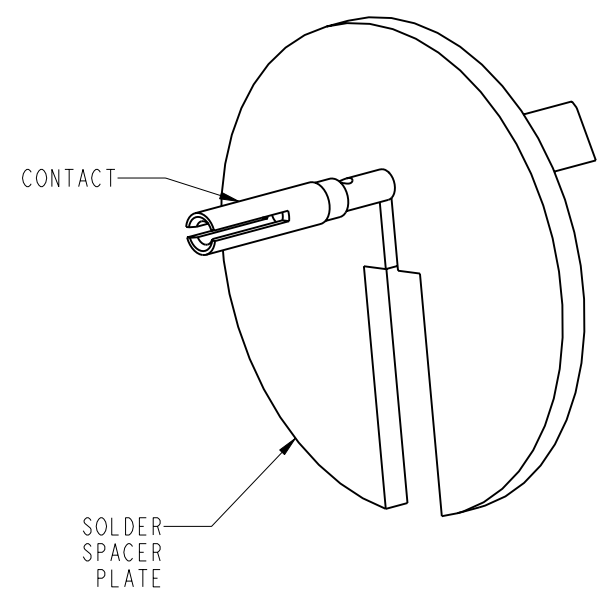

STEP 1:
 PREPARE CABLE AS SHOWN.

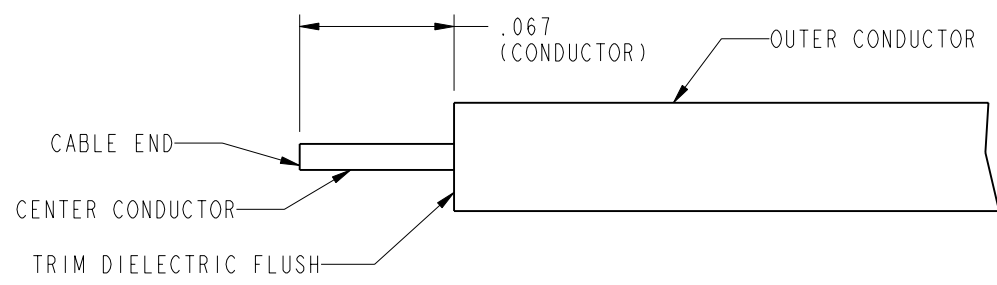

STEP 3:
 A. INSERT PREPARED CABLE AND CONTACT INTO BODY UNTIL CABLE BOTTOMS INTERNALLY.
 B. SOLDER OUTER CONDUCTOR OF CABLE TO BODY OF CONNECTOR. VERIFY INTERFACE DIMENSION OF CONTACT AFTER ASSEMBLY. CONTACT TO BE FLUSH TO .022" BELOW BODY SURFACE PER MIL-STD-348. (SOLDER FIXTURE RECOMMENDED)

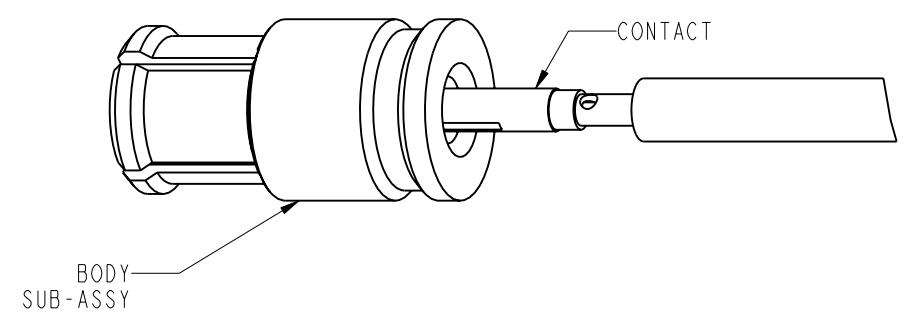

	NAME	DATE		NAME	DATE
PROJ. ENG.	MIKE HOYACK	01-OCT-01	APPD. BY		
CHK. BY			DATE ISSUED		

AMPHENOL CORPORATION DANBURY, CONN.

UNLESS OTHERWISE SPECIFIED DIMENSIONS ARE IN INCHES: AND TOLERANCES ARE: FRACTIONS DECIMALS ANGLES ± 1/64 ± .005 ± 1°	CODE IDENT.	349-50686	REV
	74868		01
SCALE: NONE	SHEET 1 OF 2		

AMPHENOL CORPORATION DANBURY, CONN.

UNLESS OTHERWISE SPECIFIED DIMENSIONS ARE IN INCHES: AND TOLERANCES ARE: FRACTIONS DECIMALS ANGLES ± 1/64 ± .005 ± 1°	CODE IDENT.	349-50686	REV
	74868		01
SCALE: NONE	ASSYFI_SMP	SHEET 2 OF 2	

REVISIONS				
REV	DESCRIPTION	DATE	ECO	APPR
01	PROTOTYPE RELEASE	01-Oct-01		MAH

ASSEMBLY INSTRUCTIONS

FOR SEMI-RIGID SIZE .086 (RG-405 TYPE)
& .047 CABLE CONNECTORS

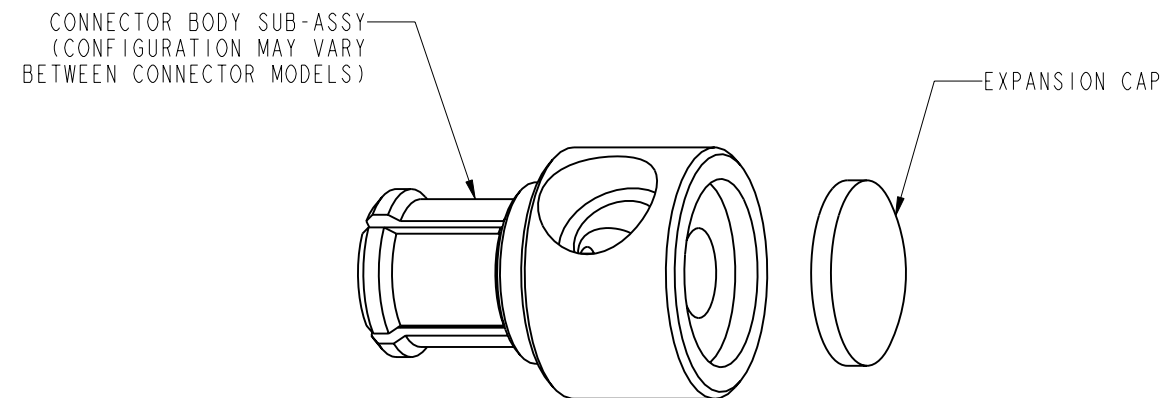

STEP 1:
PREPARE CABLE AS SHOWN.

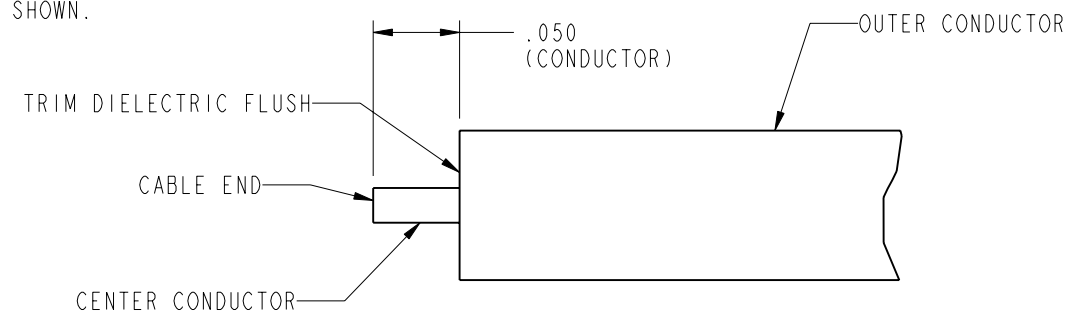

	NAME	DATE		NAME	DATE
PROJ. ENG.	MIKE HOYACK	01-Oct-01	APPD. BY		
CHK. BY			DATE ISSUED		

AMPHENOL CORPORATION DANBURY, CONN.

UNLESS OTHERWISE SPECIFIED DIMENSIONS ARE IN INCHES: AND TOLERANCES ARE: FRACTIONS DECIMALS ANGLES ± 1/64 ± .005 ± 1°	CODE IDENT.	349-50687	REV
	74868		01
SCALE: NONE	SHEET 1 OF 2		

STEP 2:
INSERT CABLE INTO BODY UNTIL CABLE BOTTOMS INTERNALLY.

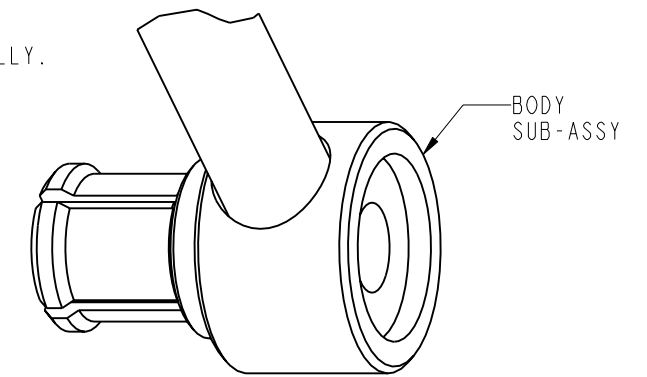

STEP 3:
SOLDER SLOTTED CENTER CONTACT TO CABLE CENTER CONDUCTOR.

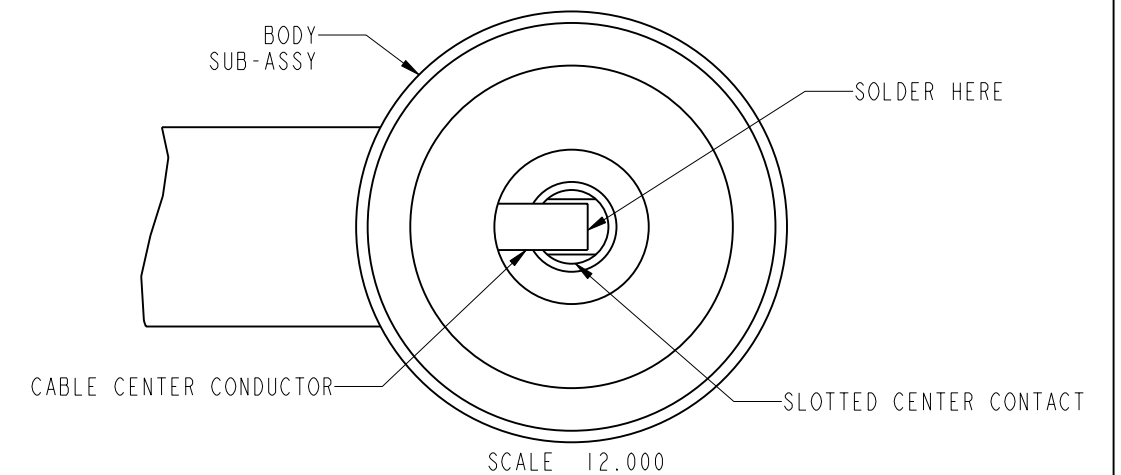

STEP 4:
SOLDER OUTER CONDUCTOR OF CABLE TO BODY OF CONNECTOR

DEPRESS EXPANSION CAP INTO BODY TO
CLOSE ACCESS HOLE.

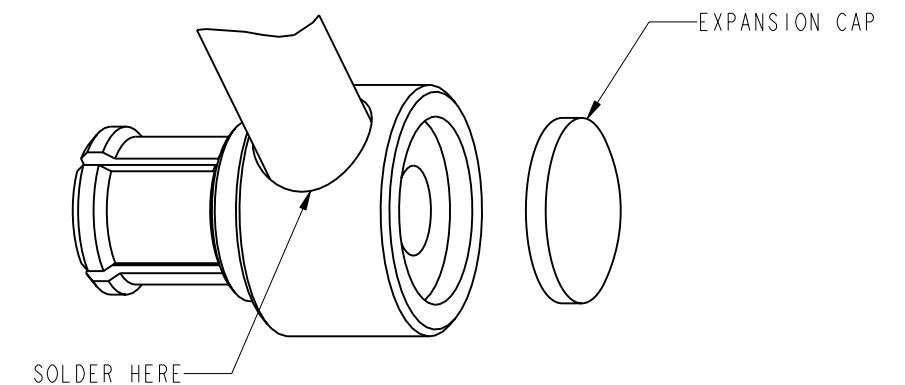

AMPHENOL CORPORATION DANBURY, CONN.

UNLESS OTHERWISE SPECIFIED DIMENSIONS ARE IN INCHES: AND TOLERANCES ARE: FRACTIONS DECIMALS ANGLES ± 1/64 ± .005 ± 1°	CODE IDENT.	349-50687	REV
	74868		01
SCALE: NONE	ASSYF2_SMP	SHEET 2 OF 2	