

REVISIONS					
REV	ECO	DESCRIPTION	DATE	BY	APPR
01	-	CUSTOMER DRAWING	-	-	-

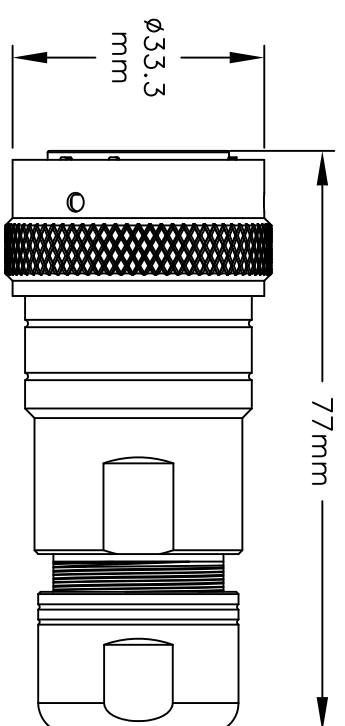

ASSEMBLED VIEW

ILLUSTRATION: COMPLETE KIT

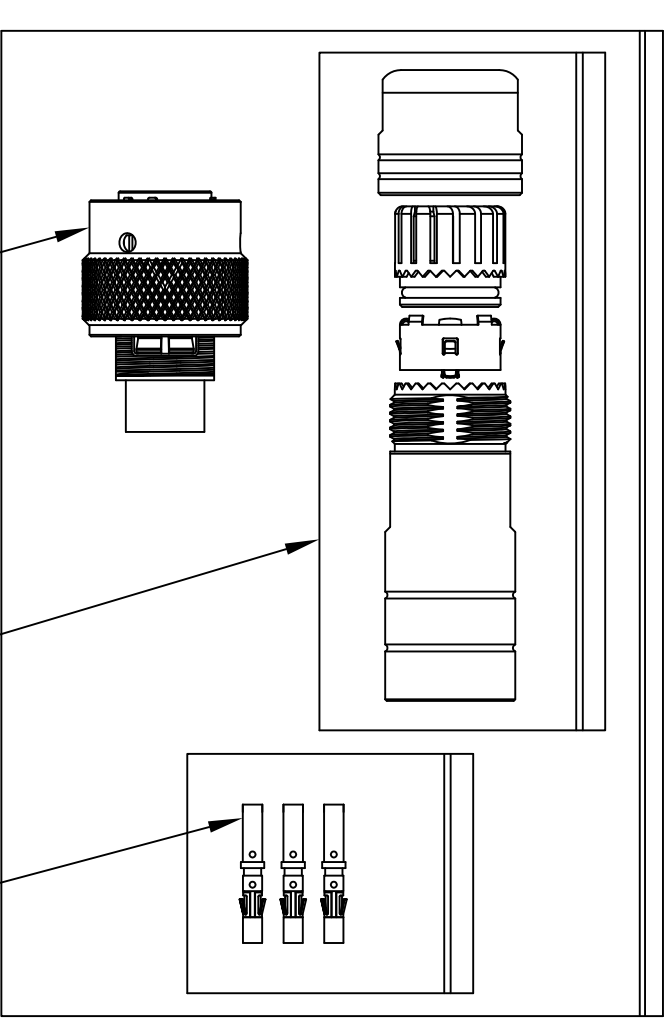
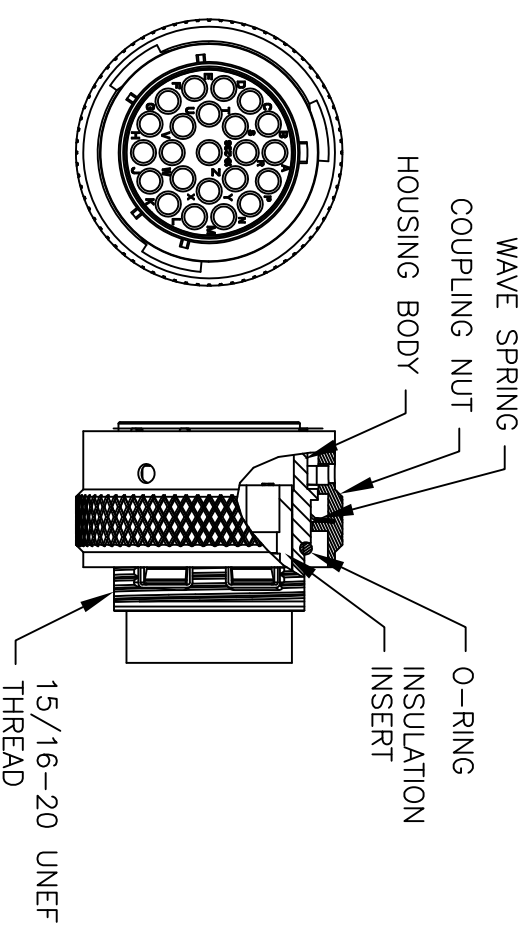

NOTES:

- 1) CORD GRIP RANGE: 3mm TO 6.5mm
- 2) CONTACT BARREL RANGE: 16AWG TO 18AWG
- 3) RECOMMENDED CRIMP TOOLS:  
HAND CRIMPER: MFX-3959  
PNEUMATIC CRIMPER: MFX-3960

- 4) EXTRACTION TOOL: QXRT16
- 5) MATERIALS:  
HOUSING BODY: ZINC DIE CAST, NICKEL PLATED  
COUPLING NUT: ALUMINUM ALLOY, NICKEL PLATED  
WAVE SPRING: STAINLESS STEEL  
INSULATION INSERT: PA66, UL94/V-0  
CONTACT: BRASS, GOLD FLASH PLATED  
SEAL AND O-RING: NBR (NITRILE BUTADIENE RUBBER)

7) TECHNICAL DATA:

- a) ELECTRICAL DATA:  
d) CURRENT (MAX): 13A  
b) VOLTAGE (MAX): 250V AC/DC  
c) INSULATION RESISTANCE (MIN): 5000M OHMS  
d) TEST VOLTAGE (BETWEEN CONTACTS): 3050V
- 7) TECHNICAL DATA:  
a) TEMPERATURE RANGE: -40°C TO 105°C  
b) PROTECTION: IP67 (MATED CONDITION)  
c) MATING CYCLES: >500  
d) VIBRATION RESISTANCE PER MIL-STD-202 METHOD 204  
e) THERMAL SHOCK PER MIL-STD-202 METHOD 207  
f) 48 HOUR SALT SPRAY PER MIL-STD-202 METHOD 101  
8) ROHS COMPLIANT

QUANTITY	PART NUMBER	DESCRIPTION	ITEM
23	MS16M23F	CONTACT, SOCKET, SIZE 16	3
1	RT0L-18CG-S1	CORD GRIP	2
1	RT061823SNH	CONNECTOR	1

UNLESS OTHERWISE SPECIFIED		SIGNATURES		DATE
1) All dimensions are in metric(mm).	2) Tolerances are as follows:	DRAWN:	MRF	10SEP13
1 PL DEC #0.30	Fractions ±1/64	CHECKED:		
2 PL DEC #0.15	Angles ±1°	ENGINEER:		
3 PL DEC #0.08		APPROVAL:		
3) Note reference = $\Delta$		CUSTOMER:		

MATERIAL SPECIFICATIONS:		PROCESS SPECIFICATIONS:		SCALE:	SHEET	OF	1
THIS DRAWING IS SUPPLIED FOR INFORMATION ONLY. DESIGN FEATURES, SPECIFICATIONS AND PERFORMANCE DATA SHOWN HEREON ARE THE PROPERTY OF THE AMPHENOL CORPORATION. NO RIGHTS OF REPRODUCTION ARE IMPLIED. ALL DIMENSIONS ARE SUBJECT TO NORMAL MANUFACTURING VARIATIONS.		NEXT ASSY:		B	1	1	1

**SINE Systems Corporation**  
A Subsidiary of Amphenol Corporation  
44724 Morley Drive  
Clinton Township, MI 48036

KIT, RT061823SNH