

THE INFORMATION CONTAINED IN THIS DRAWING IS THE SOLE PROPERTY OF ANDERSON POWER PRODUCTS. ANY REPRODUCTION IN PART OR WHOLE WITHOUT THE WRITTEN PERMISSION OF ANDERSON POWER PRODUCTS IS PROHIBITED.

Copyright 2013

ANDERSON POWER PRODUCTS RESERVES THE RIGHT TO ALTER PRODUCT TYPES, THEIR TECHNICAL DATA, DIMENSION, STYLE AND ACCESSORIES WITHOUT PRIOR NOTIFICATION.

D

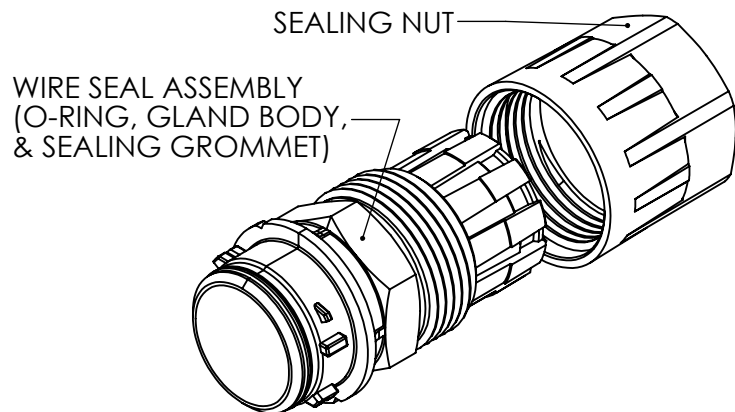

C

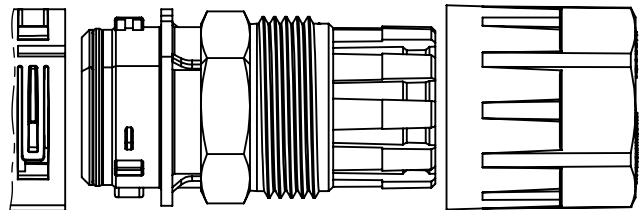

STRAIGHT PLUG (FEMALE) OR IN-LINE RECEPTACLE SHELL (MALE) NOT INCLUDED

NOTES:

1. MATERIALS:
 - A. SEAL NUT - PC, UL94 V-0, BLACK
 - B. GLAND BODY - PC, UL94 V-0, BLACK
 - C. SEALING GROMMET - EPDM RUBBER, BLACK
 - D. O-RING - NBR, BLACK
2. BACKSHELL ASSEMBLY KITS INCLUDE ONE EACH SEAL NUT AND WIRE SEAL ASSEMBLY
3. REFER TO ASSEMBLY INSTRUCTIONS 1S6616 FOR STRAIGHT PLUG (FEMALE) AND 1S6617 FOR IN-LINE RECEPTACLE (MALE) ASSEMBLY
4. FOR USE WITH 5-POSITION MINI-PL SPEC PAK® SK1-021M05 (ALL KEYS) AND SK6-021M05 (ALL KEYS) ONLY

A

SEAL NUT

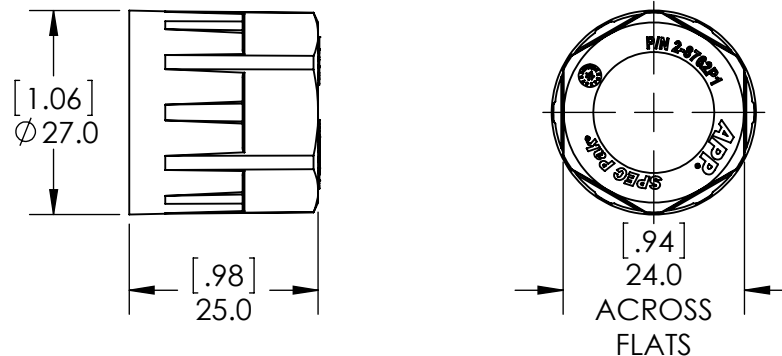

D

C

WIRE SEAL ASSEMBLY

SEE SHEET 2 FOR WIRE SEAL OPTIONS

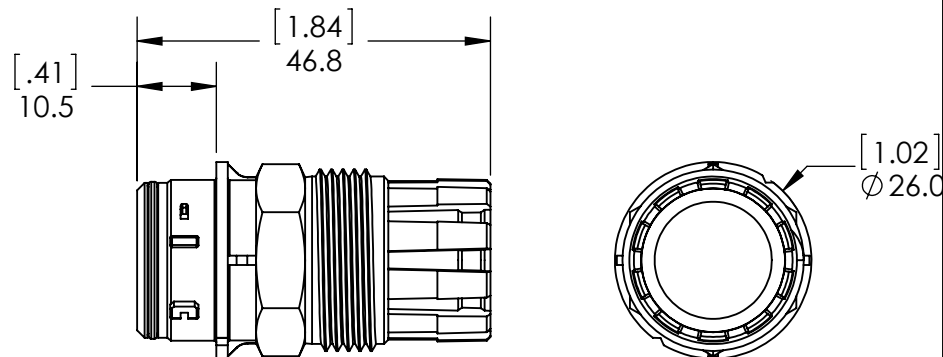

B

A

DIMENSIONS ARE IN:		MM [INCH]		<i>APPROVALS</i>		ANDERSON POWER PRODUCTS	
UNLESS OTHERWISE STATED				DRAWN	NTS	10/7/2013	
TOLERANCES:				CHECKED	MM	1/23/2014	
DECIMALS (INCH)	DECIMALS (MM)	ANGLES		MFG APPRV	CHB	1/24/2014	
.XX ±.02	.X ±.5	±2°		QC APPRV	UFN	1/23/2014	
SURFACE FINISH:				ENG APPRV	CMS	1/23/2014	
MACHINED 3.2µ [128µin]				TITLE			
MOLDED 1.6µ [64µin]				5-POSITION MINI-PL SPEC PAK® BACKSHELL ASSEMBLY			
MATERIAL: SEE NOTE 1				SIZE	A	DWG NO.	115308S1
FINISH:				SCALE	NONE	CADFILE	04072
3rd ANGLE PROJECTION				-CAD GENERATED DRAWING- DO NOT MANUALLY UPDATE DO NOT SCALE		REV.	0
				SHEET		1 OF 2	

REV.	DESCRIPTION	APPRV	DATE
REVISIONS			

8 7 6 5 4 3 2 1

THE INFORMATION CONTAINED IN THIS DRAWING IS THE SOLE PROPERTY OF ANDERSON POWER PRODUCTS. ANY REPRODUCTION IN PART OR WHOLE WITHOUT THE WRITTEN PERMISSION OF ANDERSON POWER PRODUCTS IS PROHIBITED.

Copyright 2013

ANDERSON POWER PRODUCTS RESERVES THE RIGHT TO ALTER PRODUCT TYPES, THEIR TECHNICAL DATA, DIMENSION, STYLE AND ACCESSORIES WITHOUT PRIOR NOTIFICATION.

D

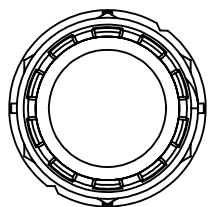

PS1T24-15X

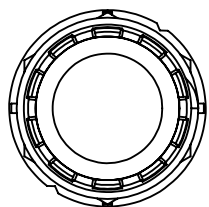

PS1T24-14X

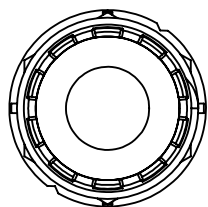

PS1T24-11X

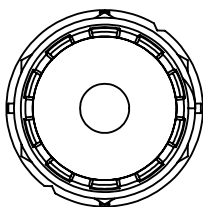

PS1T24-7X

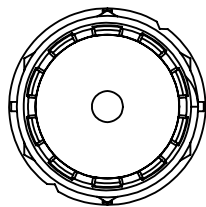

PS1T24-4X

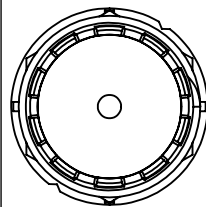

PS1T24-3X

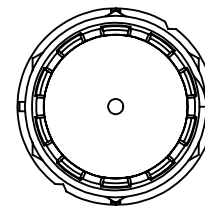

PS1T24-2X

D

C

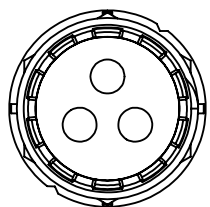

PS3T24-5X

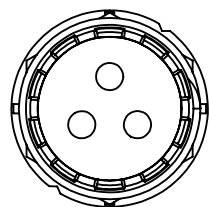

PS3T24-4X

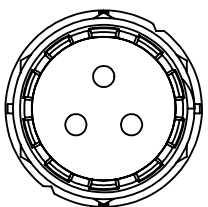

PS3T24-3X

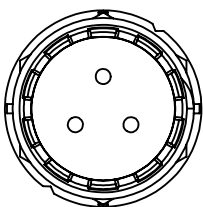

PS3T24-2X

C

B

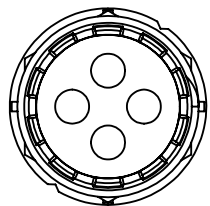

PS4T24-5X

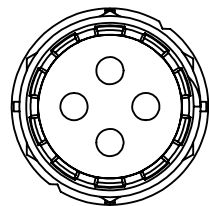

PS4T24-4X

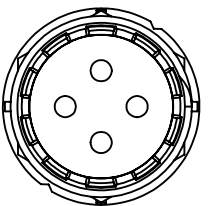

PS4T24-3X

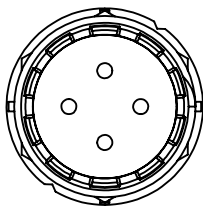

PS4T24-2X

B

A

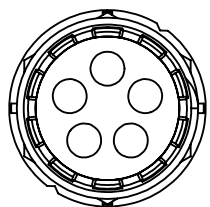

PS5T24-5X

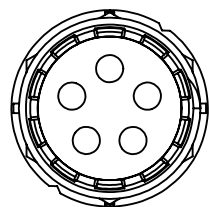

PS5T24-4X

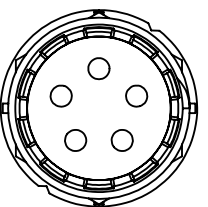

PS5T24-3X

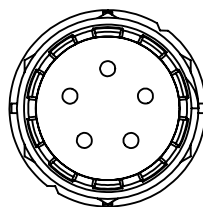

PS5T24-2X

A

BACKSHELL ASM P/N	SPEC PAK® P/N CODE	WIRE SEALING RANGES			
		MM		INCHES	
		MIN	MAX	MIN	MAX
PS1T24-15X	PS01	14.0	15.5	.55	.61
PS1T24-14X	PS02	11.0	14.0	.43	.55
PS1T24-11X	PS03	6.5	11.0	.26	.43
PS1T24-7X	PS04	4.0	6.5	.16	.26
PS1T24-4X	PS05	3.0	4.1	.12	.16
PS1T24-3X	PS06	2.0	3.1	.08	.12
PS1T24-2X	PS07	1.0	2.0	.04	.08
PS3T24-5X	PM31	3.5	4.5	.14	.18
PS3T24-4X	PM32	2.6	3.6	.10	.14
PS3T24-3X	PM33	2.0	2.8	.08	.11
PS3T24-2X	PM34	1.0	2.0	.04	.08
PS4T24-5X	PM41	3.5	4.5	.14	.18
PS4T24-4X	PM42	2.6	3.6	.10	.14
PS4T24-3X	PM43	2.0	2.8	.08	.11
PS4T24-2X	PM44	1.0	2.0	.04	.08
PS5T24-5X	PM51	3.5	4.5	.14	.18
PS5T24-4X	PM52	2.6	3.6	.10	.14
PS5T24-3X	PM53	2.0	2.8	.08	.11
PS5T24-2X	PM54	1.0	2.0	.04	.08

DIMENSIONS ARE IN:	MM [INCH]	APPROVALS		ANDERSON POWER PRODUCTS TITLE 5-POSITION MINI-PL SPEC PAK® BACKSHELL ASSEMBLY
UNLESS OTHERWISE STATED		DRAWN	10/7/2013	
TOLERANCES:		CHECKED	1/23/2014	
DECIMALS (INCH) DECIMALS (MM) ANGLES	.XX ±.02 .X ±.5 ±2°	MFG APPRV	1/24/2014	
SURFACE FINISH:		QC APPRV	1/23/2014	
MACHINED	3.2µ [128µin]	ENG APPRV	1/23/2014	
MOLDED	1.6µ [64µin]			
MATERIAL:	SEE NOTE 1	SIZE	A	
FINISH:		DWG NO.	115308S1	
		REV.	0	
		SCALE	NONE	
		CADFILE	04072	
		SHEET	2 OF 2	

-	SEE SHEET 1	-	-
REV.	DESCRIPTION	APPRV	DATE
REVISIONS			

8 7 6 5 4 3 2 1