

PART NAME

RELAY RACK PANELS

PART NO.

PA-1101 THRU PA-1112 / PS-1250 THRU PS-1261  
SFA-1831 THRU SFA-1842

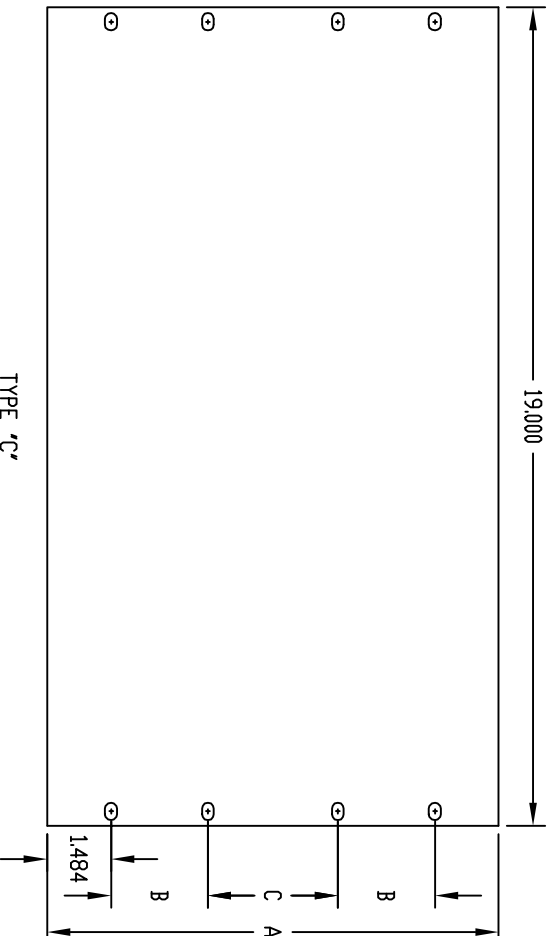
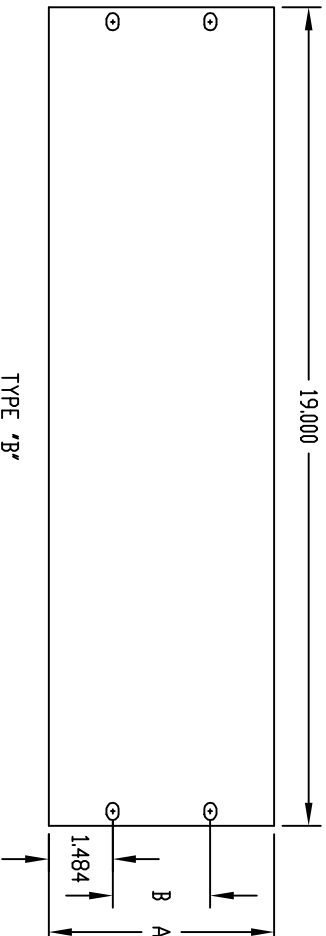
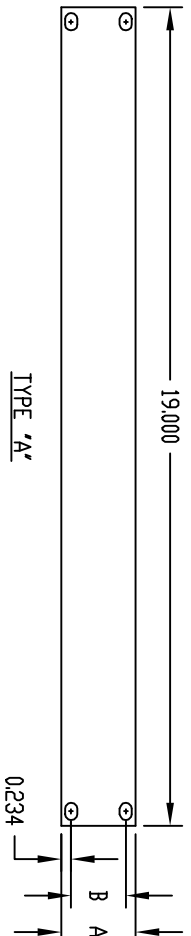

**'PA' SERIES:**  
MATERIAL: 0,125 ALUMINIUM  
FINISH: METALLIC GRAY  
WHITE TEXTURED  
BLACK TEXTURED

**'PS' SERIES:**  
MATERIAL: 11 GA. STEEL  
FINISH: METALLIC GRAY  
WHITE TEXTURED

**'SFA' SERIES:**  
MATERIAL: 0,125 ALUMINIUM  
ONE SIDE TAPED  
FINISH: NATURAL

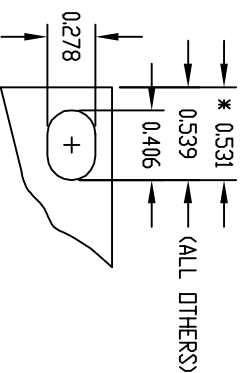

\* - THIS DIMENSION APPLIES TO ONLY  
PA-1101 & PA-1102  
SFA-1831 & SFA-1832

'PA' SERIES	'PS' SERIES	'SFA' SERIES	TYPE	A	B	C
PA-1101	PS-1250	SFA-1831	A	1,750	1,250	-
PA-1102	PS-1251	SFA-1832	A	3,500	3,000	-
PA-1103	PS-1252	SFA-1833	B	5,250	2,250	-
PA-1104	PS-1253	SFA-1834	B	7,000	4,000	-
PA-1105	PS-1254	SFA-1835	B	8,750	5,750	-
PA-1106	PS-1255	SFA-1836	C	10,500	2,250	3,000
PA-1107	PS-1256	SFA-1837	C	12,250	3,500	2,250
PA-1108	PS-1257	SFA-1838	C	14,000	4,000	3,000
PA-1109	PS-1258	SFA-1839	C	15,750	4,000	4,750
PA-1110	PS-1259	SFA-1840	C	17,500	4,000	6,500
PA-1111	PS-1260	SFA-1841	C	19,250	5,250	5,750
PA-1112	PS-1261	SFA-1842	C	21,000	5,250	7,500