

Banana Plug - Insulated Hex Body Solder Stud

SPECIFICATIONS

Plug Body: Brass per QQ-B-626D

Plug Spring: Nickel silver per QQ-C-585

Finish: Nickel

Insulated Handle: Nylon 6/6 per ASTM D4066

RATINGS

Current: 15 amps

Breakdown Voltage: 3500 Vrms minimum †

Contact Resistance: 0.010 ohms maximum

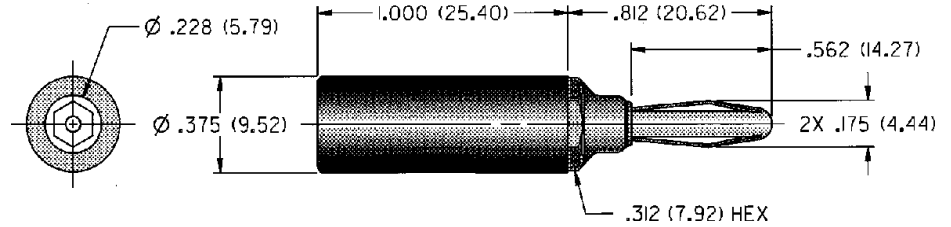

NICKEL PLATING

108-1762-101 Red

For Standard Banana Jack: .166 (4.23) Diameter

FEATURES:

- Wire can be soldered to threaded stud or flared and held by stud for solderless connection
- Solder stud accepts up to 16 gauge wire
- Nylon UL approved for self extinguishing