

CUI INC

9615 SW Allen, Suite 103
 Beaverton, OR 97005
 Phone: (503) 643-4899
 800-275-4899
 Fax: (503) 372-1266
 Website: www.cui.com

Specifications

1	Part No.	GC0251K			
2	Nominal Size	14 x 25 mm.	inch		
3	Impedance	8 Ω ± 15%	at	1.5K Hz.	1 V.
4	Resonance	600 Hz.±	120 Hz.	F0 Hz.	1 V.
5	S.P. Level	81 dB±	3 dB	1 w. 50 cm. average at	
6	Response	fo Hz.~	20K Hz.	MAX 10dB	800, 1K, 1.2K, 1.5K Hz.
7	Crossover Freq.	Hz.	Hz.	dB/OCT	Net work
8	Input Power	Nominal Input	1 w.	Handling Capacity	1.5 w.
9	Operation	Must be normal at program source			1 w.
10	Buzz, Rattle, etc.	Must be normal at sine wave			2.9 v.
11	Flux Density	Gauss ± 10%			
12	Total Flux	Max well min			
13	Magnet	Size	7.9 x 1.3 mm	gr	oz
14	Total Weight				gr oz
15	Load Test	After test meet item 9 and 10	White noise	1 W.	24 Hours
16	Distortion	% MAX		Hz	W.
17	Heat Test	After test meet item 9 and 10	60±2 ±°C	20-50 %R.H.	24 Hours
18	Humidity Test	After test meet item 9 and 10	40±2 ±°C	90-95 %R.H.	24 Hours

PART NO.	GC0251K	UNITS:	mm
DRAWN BY:		PAGE NO:	1 of 2

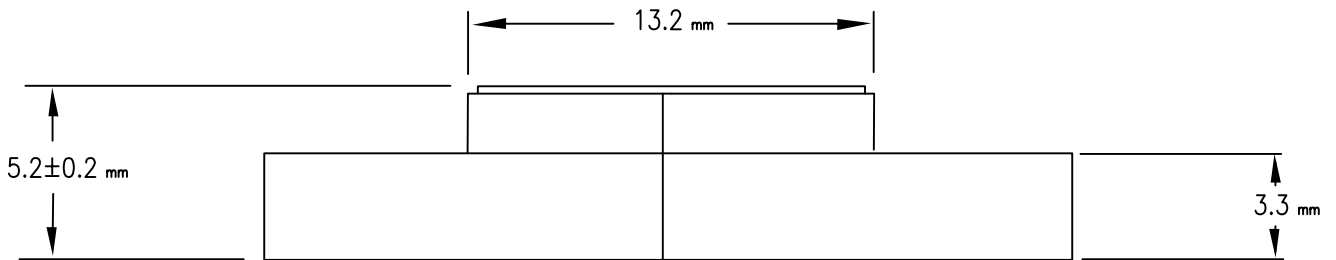
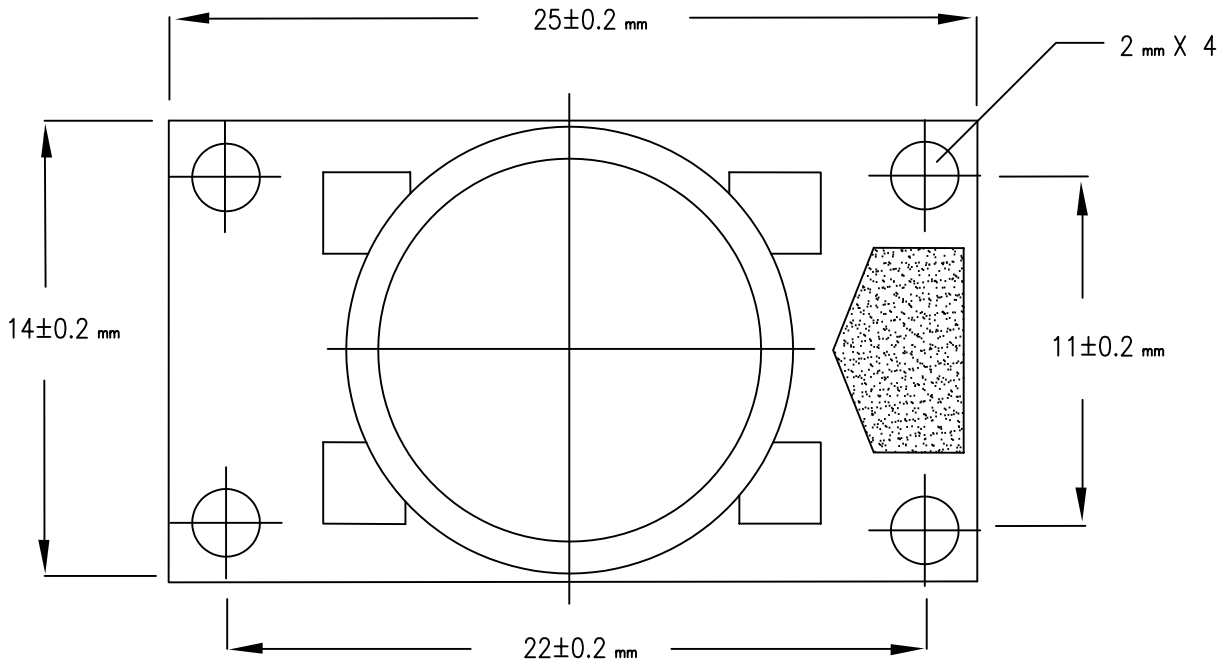

9615 SW Allen, Suite 103
 Beaverton, OR 97005
 Phone: (503) 643-4899
 800-275-4899
 Fax: (503) 372-1266
 Website: www.cui.com

TITLE:	
PART NO.	UNITS:
GC0251K	mm
DRAWN BY:	Page No.
	2 of 2