

REV.	DESCRIPTION	DATE
A	NEW DRAWING	4/6/2006
B	Added DC rating	8/15/2006

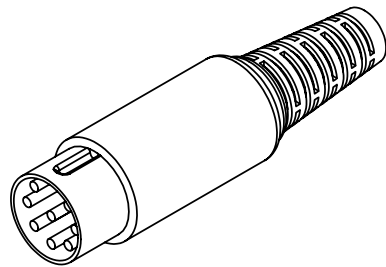
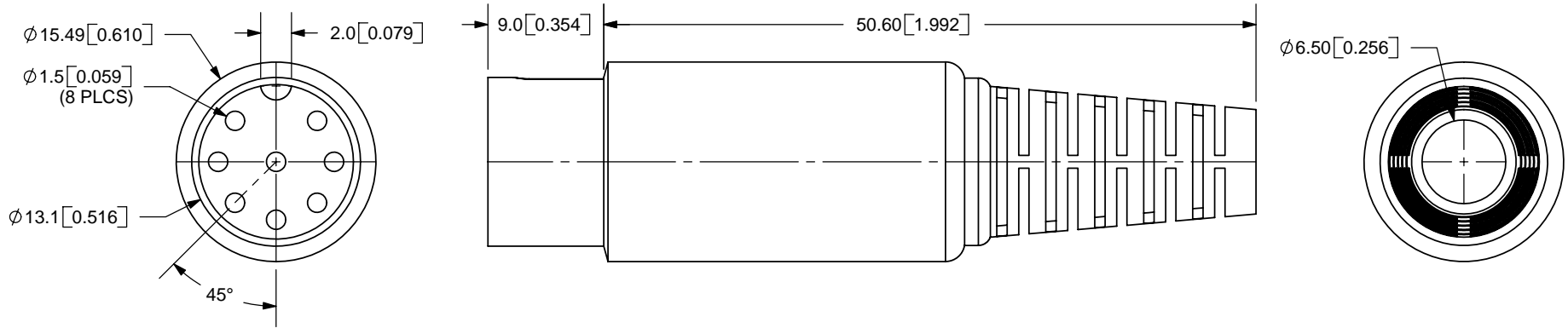

SCALE 1:1

**NOTES:**  
 RECOMMENDED WIRE RANGE: 24AWG~28AWG  
 LEAD TERMINATION: SOLDER CUPS

**SPECIFICATIONS:**  
 RATING: 12V DC @ 2A; 100V AC @ 1A  
 CONTACT RESISTANCE: PINS-30m OHMS MAX; SHELL-50m OHMS MAX  
 INSULATION RESISTANCE: 100M OHMS MIN; 500V DC  
 VOLTAGE WITHSTAND: 250V AC R.M.S. FOR 1 MINUTE  
 LIFE: 5,000 CYCLES

TOLERANCE:  
 X.X  $\pm 0.1$ mm  
 X.XX  $\pm 0.05$ mm



9615 SW Allen Blvd., Ste. 103  
 Beaverton, OR 97005  
 Phone: 503-643-4899  
 800-275-4899  
 Fax: 503-372-1266  
 Website: www.cui.com

MATERIAL	PLATING	TITLE:	REV:
PINS	Brass	IN-LINE PLUG	B
SHELL	Steel	PART NO. SD-80	UNITS: MM [INCHES]
INSULATOR	PBT	DRAWN BY: ZRJ	APPROVED BY:
BOOT	PVC		SCALE: 2:1

PC FILE NAME:  
SD-80

COPYRIGHT 2006 BY CUI INC.