

# Transient Voltage Surge Suppression Limiters TVSS

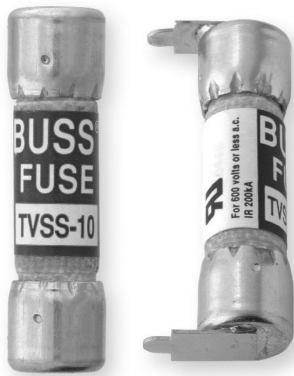

**Catalog Symbol:** TVSS

**Physical Size:** Refer to “Dimensional Data”

**Construction:**

- Melamine Tube
- Nickel Plated Brass End Caps

**Voltage Rating:** 600Vac

**Interrupting Rating:**

- 200,000A RMS Sym.

**Agency Approvals:**

- UL Recognized 600Vac, File E56412

**Catalog Symbol and Surge Ratings**

| CATALOG NUMBER | 8x20µS SURGE RATING | MELTING I <sup>2</sup> t (A <sup>2</sup> s) | CLEARING I <sup>2</sup> t (A <sup>2</sup> s) | I <sub>peak</sub> @ 100kA 60 Hz (A) |
|----------------|---------------------|---|--|-------------------------------------|
| TVSS-5         | 5,000A              | 559   | 1,650  | 4,283                               |
| TVSS-10        | 10,000A             | 1,788                                       | 5,766  | 6,618                               |
| TVSS-15        | 15,000A             | 3,760                                       | 9,730  | 7,843                               |
| TVSS-20        | 20,000A             | 6,020                                       | 14,000                                       | 8,594                               |

Above catalog numbers are available with Printed Circuit Board Tabs. When ordering, use suffix “-01”.

**General Information:**

- Designed to protect TVSS systems per UL 1449 Second Edition Requirements.
- Able to withstand 8x20 µSec surge pulses without opening.
- Limiters are identified by a surge rating and not continuous current rating.

**Dimensional Data**

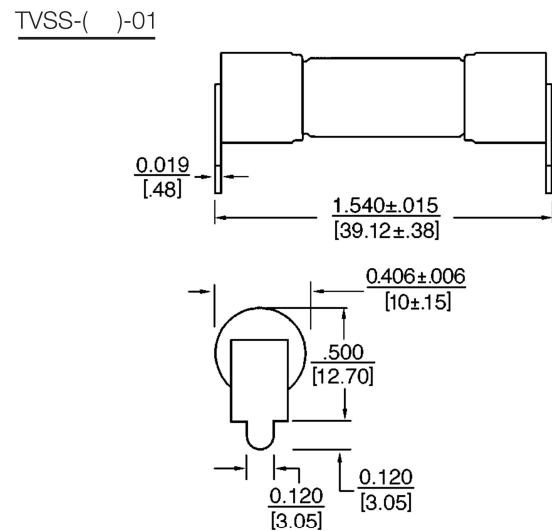
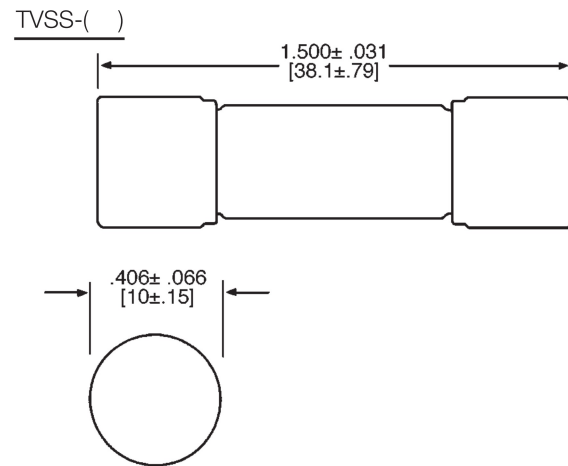

CE logo denotes compliance with European Union Low Voltage Directive (50-1000Vac, 75-1500Vdc). Refer to Data Sheet: 8002 or contact Bussmann Application Engineering at 636-527-1270 for more information.

**Recommended fuseblocks/fuseholders for 13/32" x 1-1/2" fuses**  
**See Data Sheets listed below**

- Open fuseblocks - 1104, 2104
- Finger-safe fuseholders - 1109, 1102, 1103, 1151
- Panel-mount fuseholders - 2114, 2113, 2108,
- In-line fuseholders - 2127, 2126

# Transient Voltage Surge Suppressors TVSS

Time-Current Characteristic Curves—Average Melt

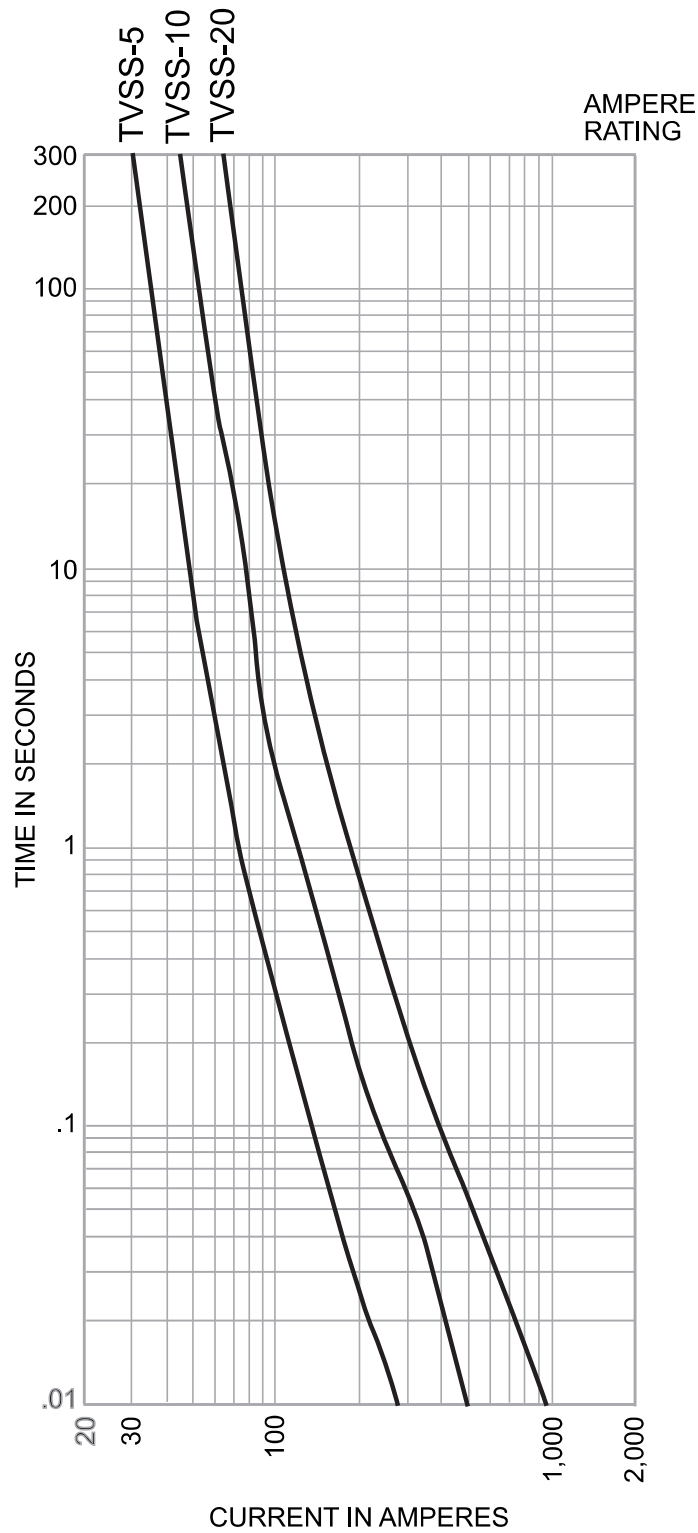

## Time-Current Characteristic Curves—Peak Let-Through

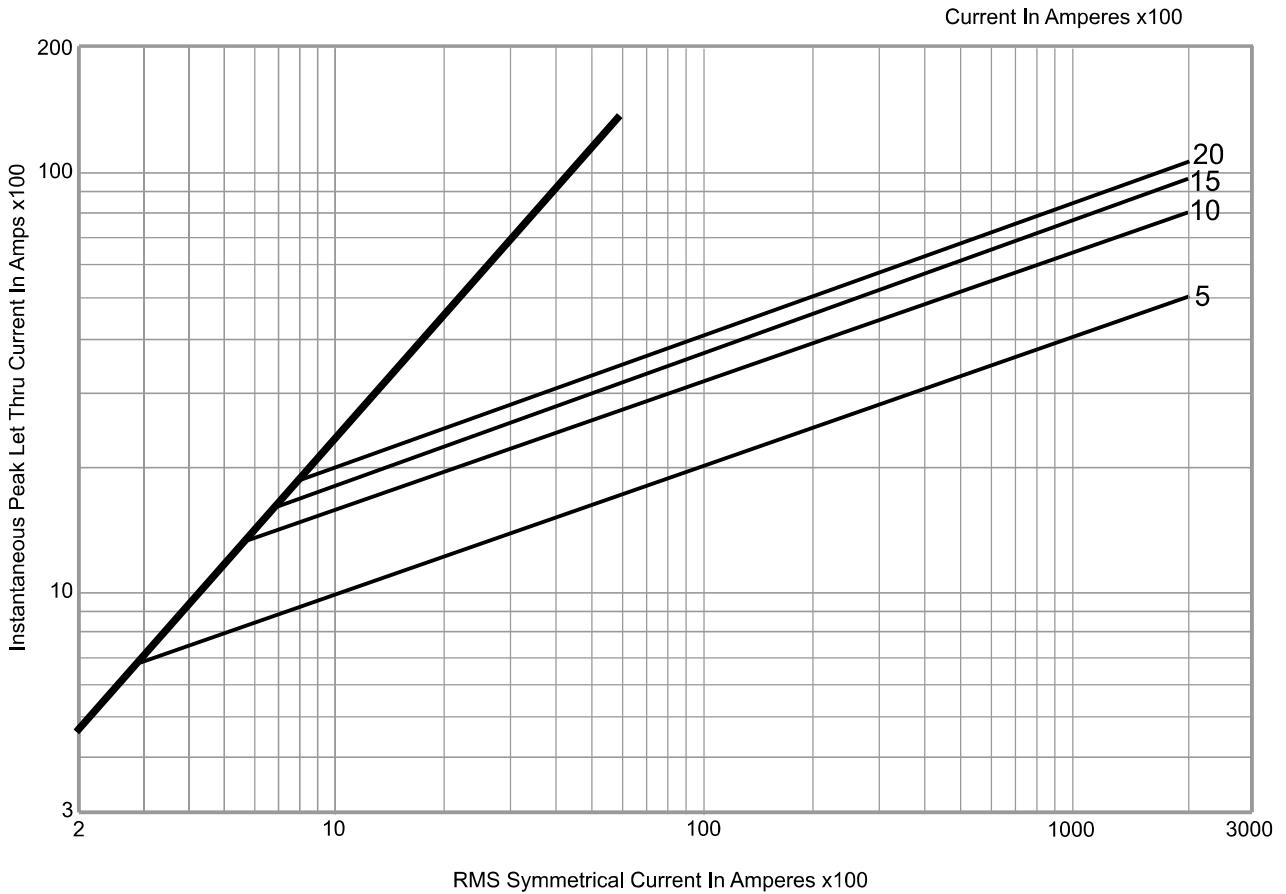

The only controlled copy of this Data Sheet is the electronic read-only version located on the Bussmann Network Drive. All other copies of this document are by definition uncontrolled. This bulletin is intended to clearly present comprehensive product data and provide technical information that will help the end user with design applications. Bussmann reserves the right, without notice, to change design or construction of any products and to discontinue or limit distribution of any products. Bussmann also reserves the right to change or update, without notice, any technical information contained in this bulletin. Once a product has been selected, it should be tested by the user in all possible applications.