

CABLE 243 RF: RF CABLE ASSEMBLY, SMA S/T MALE TO SMA STRAIGHT BULKHEAD JACK WITH O-RING RATED TO IP67/68 + MULTIPLE CABLE OPTIONS

SPECIFICATIONS :

1. SMA STRAIGHT MALE, P/N:  
 FOR RG178 CABLE: RFCT-SMA022-M78.  
 FOR  $\phi$ 1.13MM &  $\phi$ 1.13MM LL CABLE: RFCT-SMA011-M13.  
 FOR  $\phi$ 1.32MM DS CABLE: RFCT-SMA038-M32.  
 FOR  $\phi$ 1.37MM CABLE: RFCT-SMA026-F37.
2. COAXIAL CABLE, SEE P/N FOR DETAIL.
3. SMA STRAIGHT BULKHEAD JACK WITH O-RING RATED TO IP67/68,  
 P/N: RFCT-SMA002-F78.

ENVIRONMENTAL:

- A. BULKHEAD MOUNTED CONNECTOR (RFCT-SMA002-F78)  
 TESTED TO THE FOLLOWING SPECIFICATION:
  - i. IP6X - DUST TIGHT - NO PARTICLE INGRESS.
  - ii. IPX7 WATERPROOF FOR 30 MINUTES UP TO 1 METER UNDERWATER.
  - iii. IPX8 WATERPROOF FOR 48 HOURS AT 1 METER UNDERWATER.
  - iv. IPX8 WATERPROOF FOR 12 HOURS AT 5 METERS UNDERWATER.
  - v. PRESSURE TEST - 1 BAR FOR 10 SECONDS.

NOTES:

1. WORKING FREQUENCY RANGE: DC-3GHz.
2. OPERATING TEMPERATURE: -55°C~+125°C
3. IMPEDANCE: 50 OHM.

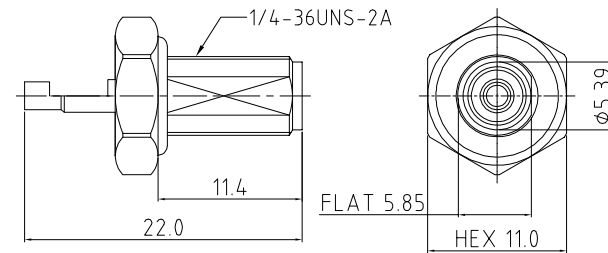
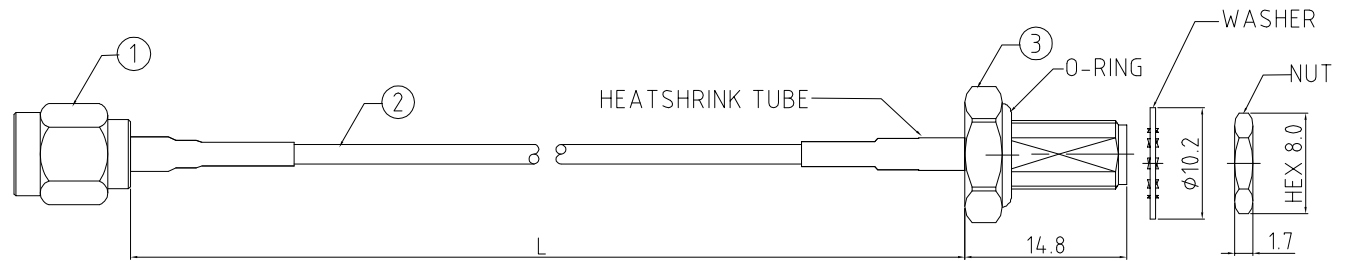

SMA JACK DETAIL DRAWING

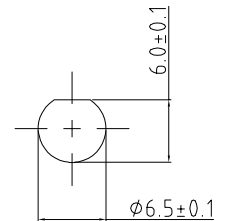

RECOMMENDED SMA MOUNTING HOLE

HOW TO ORDER  
 CABLE 243 RF - X X X X - X - X

"L" LENGTH IN MM:  
 eg: 100MM = 0100  
 (MIN. 0050, MAX. 2000,  
 STANDARD = 0100, 0150, 0200)  
 Tolerance: 50mm: ±2mm.  
 51-200mm: ±5mm.  
 201-500mm: ±7mm.  
 >500mm: ±10mm.

CABLE SIZE OPTIONS:  
 1 = RG178 CABLE, COLOR: BROWN  
 2 =  $\phi$ 1.13MM CABLE, COLOR: GRAY  
 3 =  $\phi$ 1.13MM LOW LOSS CABLE, COLOR: GRAY  
 4 =  $\phi$ 1.32MM DS CABLE, COLOR: GRAY  
 5 =  $\phi$ 1.37MM CABLE, COLOR: BLACK

WASHER AND NUT OPTIONS:  
 BLANK = SEPARATELY PACKED (STANDARD)  
 A = ALL ASSEMBLED WITH CONNECTOR

REV. DATE & DRN	10 07/08/16 - RH RELEASE
11 30/09/17 - NYW	ADD 1.13MM CABLE OPTIONS.
12 01/11/17	ADD 1.32DS CABLE OPTIONS.
13 27/05/19 - NYW	ADD OPERATING TEMP.
14 20/09/19 - NYW	ADD 1.37 CABLE OPTION.
	ADD NOTE 3.

Scale: NTS	THIRD ANGLE	Unstated X XX XXX ANGLES	Tolerances: N/A N/A N/A N/A
Drawn: RJH			
App'd: XXX	Title CABLE ASSEMBLY		
Date: 20 SEP. '19	Revision: 14	Unit: mm	

IP67/68 Rated Cables

www.gradconn.com

Type: Cable 243 RF
CABLE 243 RF
Drawing Number:
Sheet 1 of 1
Drawing © E and O E