

Customer Information Sheet

DRAWING No.- D26XX-XX

SHEET 2 OF 2

IF IN DOUBT - ASK

(C)

NOT TO SCALE

THIRD ANGLE PROJECTION

ALL DIMENSIONS IN mm

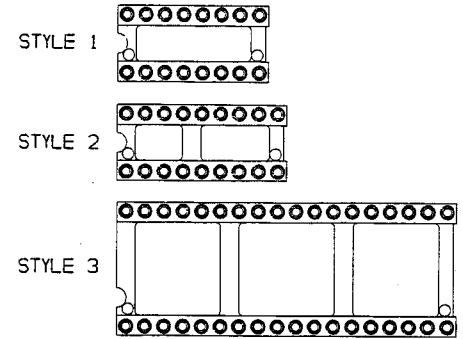
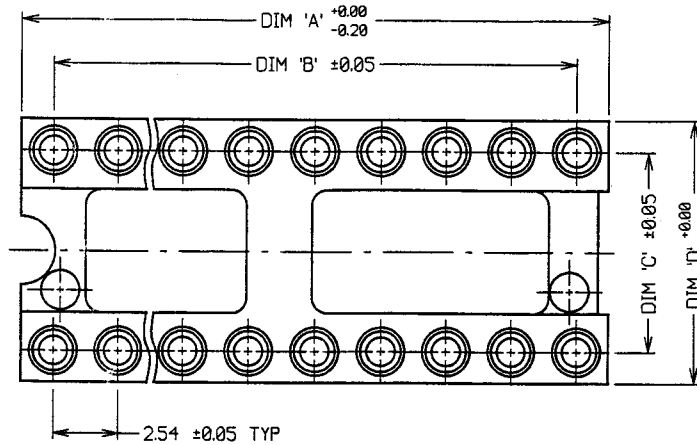
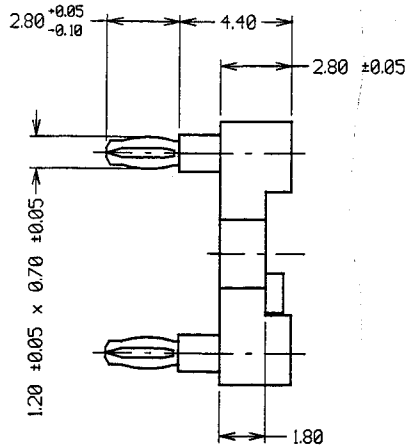

ORDER CODE:

D26XX-XX

No. OF WAYS
(SEE TABLE)

FINISH:

01 - TIN/LEAD SHELL, GOLD CLIP
T6 - TIN/LEAD SHELL, TIN/LEAD CLIP

NOTES:

- RECOMMENDED HOLE SIZE = $\varnothing 1.09-0.94\text{mm}$.
RECOMMENDED BOARD THICKNESS = 1.5 TO 2.0mm.

SPECIFICATIONS:

MATERIAL:

MOULDING - GLASS-FILLED POLYESTER UL94V-0
CONTACT SHELL - BRASS
CONTACT CLIP - BERYLLIUM COPPER

FINISH:

01 - SHELL - 5 μ 90/10 TIN/LEAD OVER 2-3 μ NICKEL
CLIP - 0.25 μ GOLD OVER 2-3 μ NICKEL
T6 - SHELL - 5 μ 90/10 TIN/LEAD OVER 2-3 μ NICKEL
CLIP - 5 μ 90/10 TIN/LEAD OVER 2-3 μ NICKEL

ELECTRICAL:

CURRENT RATING - 1 AMP
VOLTAGE RATING - 100V AC, 150V DC
CONTACT RESISTANCE - 10 MILLIOHMS MAX
INSULATION RESISTANCE - 10,000 MEGOHMS MIN
DIELECTRIC WITHSTANDING - 1000V AC MIN

MECHANICAL:

INSERTION FORCE = 3.0N MAX ($\varnothing 0.46\text{mm}$ GAUGE)
WITHDRAWAL FORCE = 0.3N MIN ($\varnothing 0.46\text{mm}$ GAUGE)
SOLDERABILITY = 260°C FOR 5 SECONDS
DURABILITY = 100 CYCLES

ENVIRONMENTAL:

TEMPERATURE RANGE = -55°C TO +125°C

PACKING:

TUBE

FOR COMPLETE SPECIFICATION, SEE COMPONENT SPECIFICATION C004XX (LATEST ISSUE).

HARWIN PART No.	No. OF WAYS	STYLE	DIM 'A'	DIM 'B'	DIM 'C'	DIM 'D'
D2606-XX	6	1	7.6	5.08	7.62	10.02
D2608-XX	8	1	10.1	7.62	7.62	10.02
D2614-XX	14	1	17.17	15.24	7.62	10.02
D2616-XX	16	1	20.3	17.78	7.62	10.02
D2618-XX	18	2	22.8	20.32	7.62	10.02
D2620-XX	20	2	25.3	22.86	7.62	10.02
D2622-XX	22	2	27.8	25.40	10.16	12.56
D2624-XX	24	2	30.4	27.94	15.24	17.64
D2628-XX	28	2	35.5	33.02	15.24	17.64
D2632-XX	32	2	40.6	38.10	15.24	17.64
D2640-XX	40	3	50.6	48.26	15.24	17.64

2	03.12.97	4185
1	27.08.97	----
ISS.	DATE	C/N
APPROVED: <i>W.S.B.</i>		
CHECKED: <i>M.M.</i>		
DRAWN: D. BECK		
CUSTOMER REF.		
ASSEMBLY DRG.		

HARWIN

HARWIN INC
U.S.A.
TEL: (812) 285 0055
FAX: (812) 285 0056

HARWIN PLC
U.K.
TEL: 01705 370451
FAX: 01705 314590

HARWIN PTE
SINGAPORE
TEL: 65 7794909
FAX: 65 7793868

TOLERANCES

X - $\pm 1\text{mm}$
X.X - $\pm 0.25\text{mm}$
X.XX - $\pm 0.10\text{mm}$
X.XXX - $\pm 0.01\text{mm}$
ANGLES = $\pm 1^\circ$
UNLESS STATED

MATERIAL:

SEE ABOVE

FINISH:

SEE ABOVE

S/AREA:

mm²

TITLE:

DIL IC SOCKET
OPEN FRAME, PRESS-FIT

DRAWING NUMBER:

D26XX-XX

SHT
2
OF
2