

M22 Connectors

Jumper Socket Open Top

- ❖ Suitable for use with pin headers shown on pages 92–94 and 96–99.
- ❖ Can be fitted and removed by hand, giving an alternative on-board programming method to DIP switches.
- ❖ Open top for use with test probe.
- ❖ End and side stackable.
- ❖ Choice of colours available.

2mm (.080") PITCH

JUMPER SOCKET

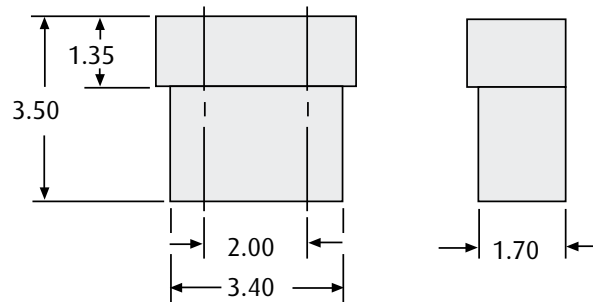
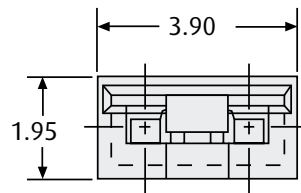

HOW TO ORDER

M22 - 19 X 00 XX

SERIES CODE

COLOUR

0	Black
1	Blue
2	Red
3	Grey

FINISH

05	Gold	
46	Tin	

www.harwin.com

All dimensions in mm.



HARWIN