

Customer Information Sheet

DRAWING No.: M80-906XX02

IF IN DOUBT - ASK

©

NOT TO SCALE

THIRD ANGLE PROJECTION

ALL DIMENSIONS IN mm

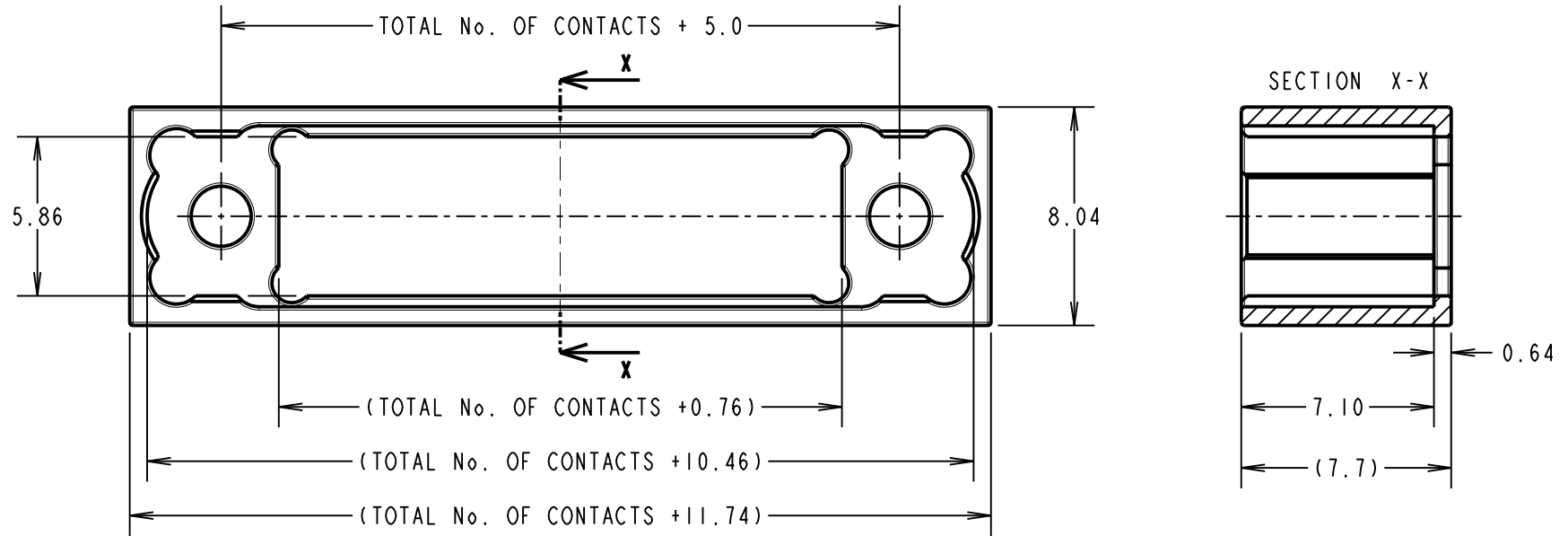

SPECIFICATIONS:

MATERIAL = ALUMINIUM ALLOY
FINISH = ELECTROLESS NICKEL

ELECTRICAL:

RF ATTENUATION = 10kHz TO 400MHz @ >30dBs
IN GENERAL ACCORDANCE WITH MIL-STD-1377

ENVIRONMENTAL:

TEMPERATURE RANGE = -55°C TO +125°C

PACKING:

BAG

FOR COMPLETE SPECIFICATION, SEE COMPONENT SPECIFICATION C042XX (LATEST ISSUE)

ORDER CODE:

M80-906XX02

TOTAL No. OF CONTACTS

08, 10, 12, 14, 16, 18,
20, 22, 24, 26, 28, 32,
34, 36, 38, 40, 42, 44,
46, 48, 50

MR	9	06.04.20	30027
NAME	ISS.	DATE	C/NOTE
APPROVED:		M.RUDKIN	
CHECKED:		S.BENNETT	
DRAWN:		S.FLOWER	
CUSTOMER REF.:			
ASSEMBLY DRG:			

HARWIN

www.harwin.com
technical@harwin.com

THIS DRAWING AND ANY INFORMATION OR DESCRIPTIVE MATTER SET OUT HEREON ARE CONFIDENTIAL AND COPYRIGHT PROPERTY OF THE HARWIN GROUP AND MUST NOT BE DISCLOSED, LOANED, COPIED OR USED FOR MANUFACTURING, TENDERING OR FOR ANY OTHER PURPOSE WITHOUT THEIR WRITTEN PERMISSION.

TOLERANCES
X. = ±1mm
X.X = ±0.50mm
X.XX = ±0.20mm
X.XXX = ±0.01mm
ANGLES = ±5°
UNLESS STATED

MATERIAL:

SEE ABOVE

FINISH: SEE ABOVE

S/AREA: mm²

TITLE:

DATAMATE J-TEK MALE
PCB/PANEL MOUNT BACKSHELL

DRAWING NUMBER:

M80-906XX02

SHT
5
OF
5