

0.8mm Contact Spacing • SMT Type • Small, Low Profile
P.C.Board to P.C.Board Application (Parallel/Vertical)

KX14/KX15 Series Connectors

JAE

FEATURES

- For connection between parallel boards spaced 4 to 9mm (increment of 1mm).
- Mating guide for orientating the contacts.
- Ribbon type contacts ensure reliable electrical continuity, resisting twisting force of coupling.
- Configuration suited for automatic packaging. Sufficient adsorbing face. Terminal length easy to be recognized by image processor.
- Friction lock less sensitive to vibration and tensile strength.
- KX15 • 50-contact angle type is ATA standard interface used in various media bays such as thin CD-ROM drive bay for notebook computers. For PC board side connector, angle type KX14 is available.

APPLICATIONS

Video cameras, notebook computers, CD-ROM / DVD-ROM drive unit of notebook computers, cordless phones, mobile phones, and other audiovisual and information equipment

GENERAL SPECIFICATIONS

No. of Contacts	[Standard Type] Straight : 20,30,40,50,60,70, 80,100,120,140,160 Right-angle : Hold-down type/30,40,50,60,70 Screw type/70,80,140 [For Bay Slot] Right-angle : 50
Current Rating	0.5 Amps
D.W.Voltage	500 VACr.m.s. (for one minute)
Insulation Resistance	100 megohms min.
Contact Resistance	70 milliohms max.
Operating Temperature	-40°C to +85°C

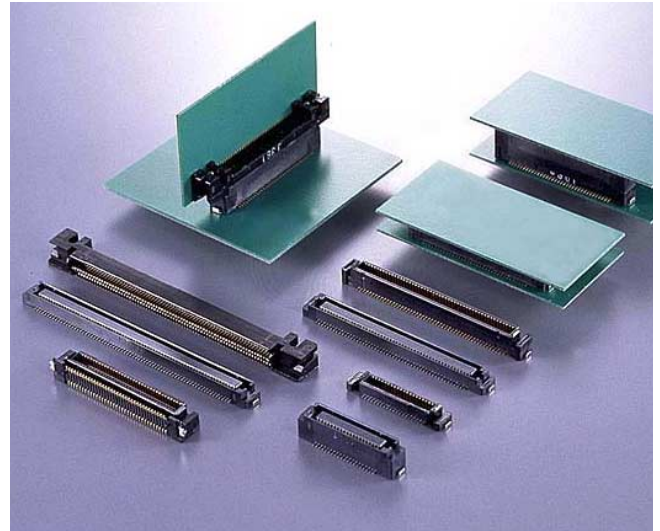

TYPES & COMBINATIONS

- Standard Type: Click the button.



- For Bay Slot: Click the button.



* The products and specifications contained in this catalog are subject to change without notice. When considering use of or placing an order for products included in this catalog, please check first with our sales department.

TYPES & COMBINATIONS

Receptacle • KX14

●Straight type
With positioning boss/hold-downs
P/N : KX14-***K□D***

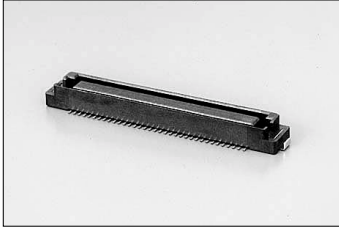

Standard Type

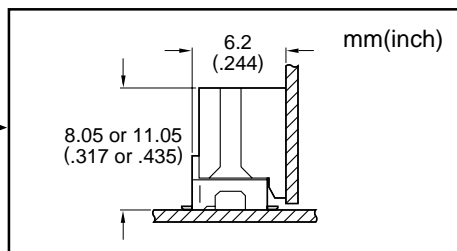
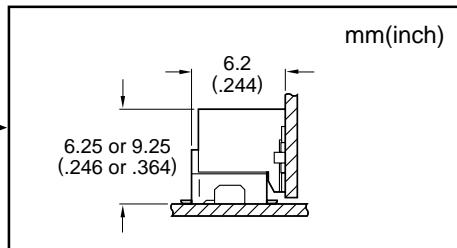
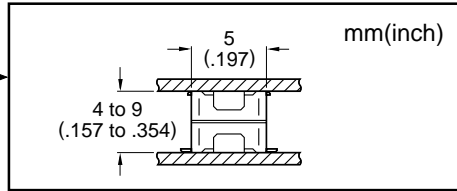

Plug • KX15

●Straight type
With positioning boss/hold-downs
P/N : KX15-***K□D***

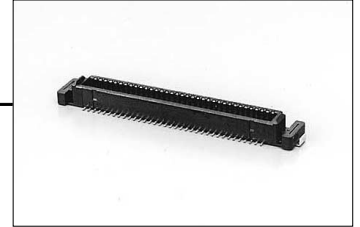

●Right-angle type
With positioning boss/hold-downs
P/N : KX15-***KLD*L**

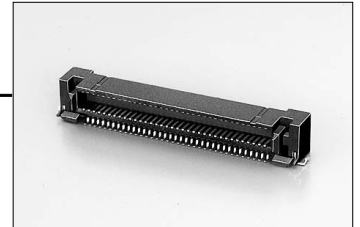

●Right-angle type
With positioning boss/hexagon nuts
P/N : KX15-***KLN*L**

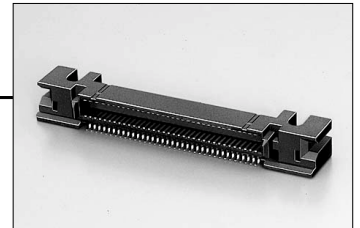

Applicable parallel board-to-board distance ranging from 4mm to 9mm (at 1mm intervals)

For the straight type, we have two insulator heights of receptacle (KX14) and three insulator heights of plug (KX15). In the case of parallel board application, you can select a board-to-board distance in the range from 4mm to 9mm (at 1mm intervals) by combining suitable plug and receptacle.

Connector types and dimensions

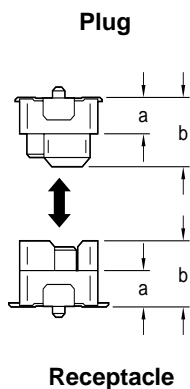

Mated-height No.		2	3	4	5
Receptacle	a	1.95mm	—	—	4.95mm
	b	3.55mm	—	—	6.55mm
Plug	a	1.95mm	2.95mm	3.95mm	—
	b	3.75mm	4.75mm	5.75mm	—

Parallel board-to-board distance

		Receptacle	
Plug	Mated-height No.	2	5
	2	4mm	7mm
	3	5mm	8mm
	4	6mm	9mm

TYPES & COMBINATIONS

Receptacle • KX14 (PC board side)

For Bay Slot

Plug • KX15 (Drive unit side)

●Right-angle type
Standard packaging type
P/N:KX14-50KL7.4H1

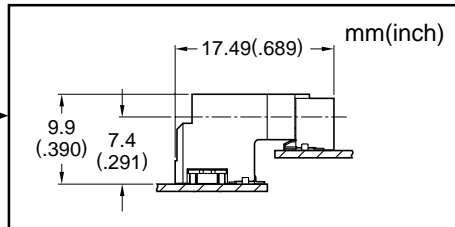
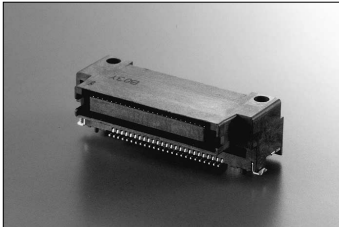

●Right-angle type
With positioning boss/hold-downs
P/N:KX15-50KLD*L

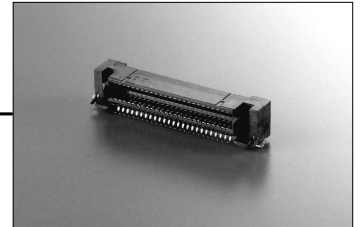

●Right-angle type
Standard packaging type
P/N:KX14-50KL9DN1

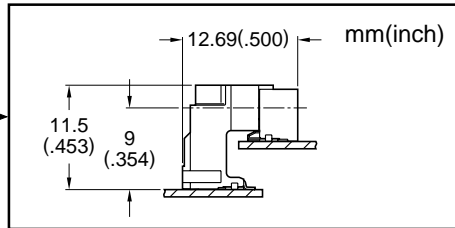
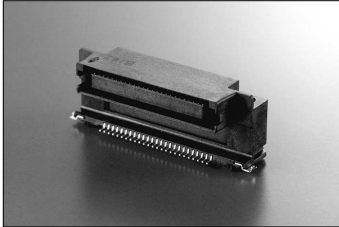

●Right-angle type
Standard packaging type
P/N:KX14-50KL10H1

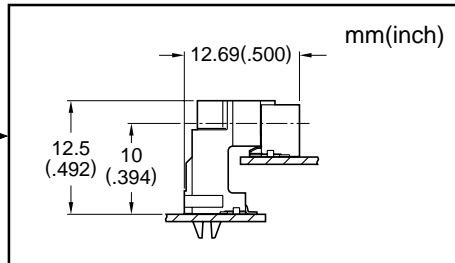
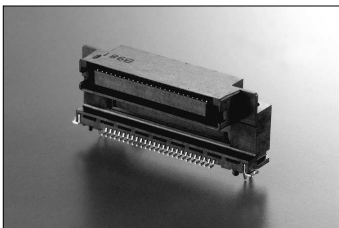

●Right-angle type
Standard packaging type
P/N:KX14-50KL13.3DN1

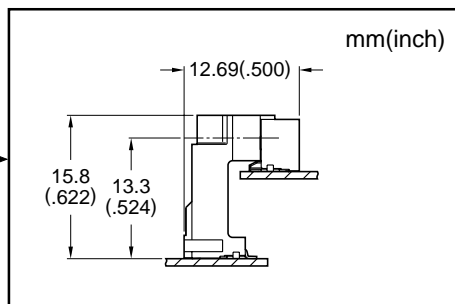
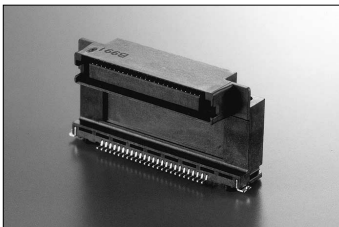

●Right-angle type
Reverse packaging type
P/N:KX14-50KL7.9H1

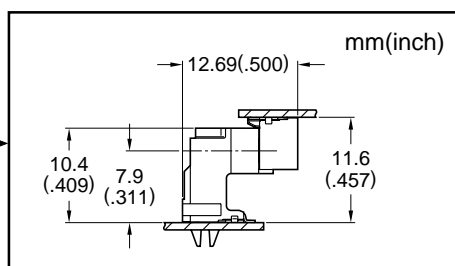
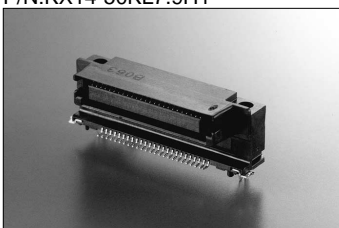

For board-to-board distances other than those mentioned above, please contact JAE's sales department.