



# PS CONNECTOR

Connectors for tabs



## Features

### • **Secure locking, easy insertion**

The combination of terminal and housing provides easy mating onto the male tab. Unmating is also easy, by holding the housing while pulling, the contact lock spring is disengaged by the taper inside the housing. Should you accidentally pull the wire, the locking mechanism ensure that disengagement does not take place.

### • **Stable contact performance**

The contact is designed with a large contact area to give stable performance, even when high current is applied.

### • **Mis-insertion prevention mechanism and housing lance**

Inside the housing is a stopper that prevents mis-insertion, which ensures that someone will not mistakenly insert a contact in the housing. What's more, use of a housing lance means that only slight force is needed to insert a contact, even though the contact is held firmly in place.

## Specifications

- Current rating: 25A AC, DC(#250 + AWG #10)
- Voltage rating: 250V AC, DC
- Temperature range: -40°C to +105°C
- Contact resistance: Initial value/ 3m Ω max.  
After environmental testing/ 6m Ω max.
- Insulation resistance: 1,000M Ω min.
- Withstanding voltage: 2,000V AC/ minute
- Applicable wire: #110...AWG #24 to #16  
#187...AWG #26 to #14  
#205...AWG #22 to #14  
#250...AWG #22 to #10
- Applicable Tab: #110 Tab 0.5mm(.020") thick  
#187 Tab 0.5mm(.020")/0.8mm(.031") thick  
#205 Tab 0.5mm(.020")/0.8mm(.031") thick  
#250 Tab 0.8mm(.031") thick

\* Contact JST if Lead-Free product is required.

\* Refer to "General Instruction and Notice when using Terminals and Connectors" at the end of this catalog.

\* Contact JST for details.

## Standards

 Recognized E60389

 Certified LR20812

 R9850196

## Contact

### #110 Series

**SPS-01T-110**

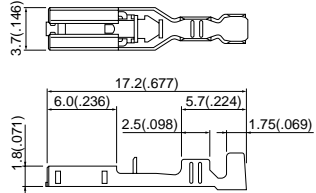

**SPS-41T-110**

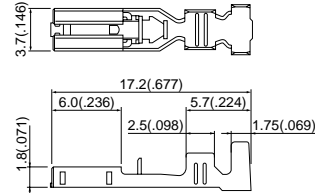

### #187 Series

**SPS-01T-187...for 0.5mm(.020") thick tabs**

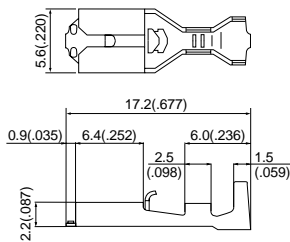

**SPS-51T-187...for 0.5mm(.020") thick**

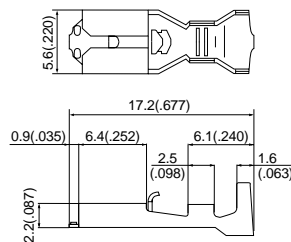

**SPS-82T-187...for 0.5mm(.020")**

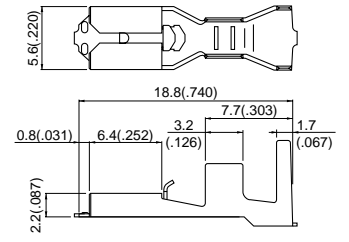

**SPS-01T-187-8...for 0.8mm(.031") thick**      **SPS-51T-187-8...for 0.8mm(.031") thick**

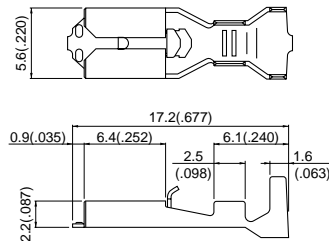
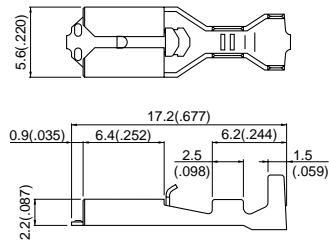

### <Flag type>

**SFPS-41T-187...for 0.5mm(.020")**

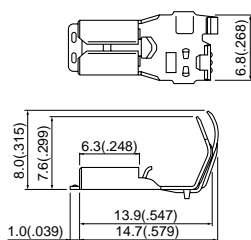

**SFPS-41T-187-8...for 0.8mm(.031") thick**

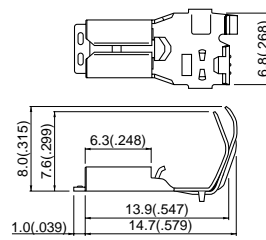

# PS CONNECTOR

## Contact

### #205 Series

**SPS-21T-205**...for 0.8mm(.031") thick

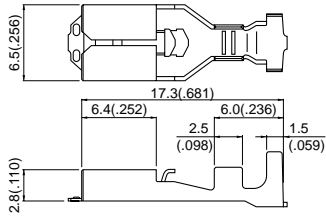

**SPS-21T-205-5**...for 0.5mm(.020") thick

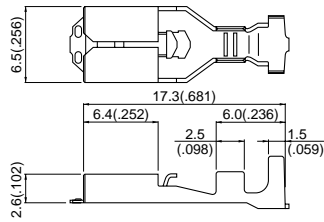

**SPS-51T-205**...for 0.8mm(.031") thick

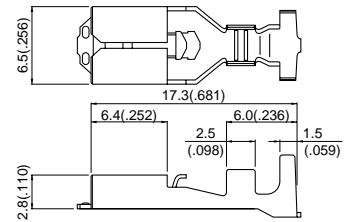

### #250 Series

**SPS-21T-250**

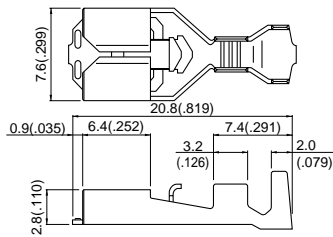

**SPS-61T-250**

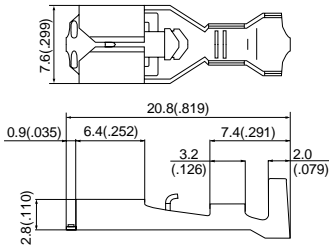

**SPS-91T-250**

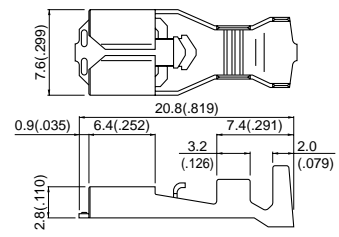

### <Flag type>

**SFPS-61T-250**

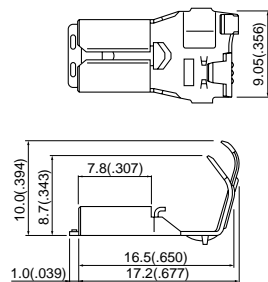

**SFPS-91T-250**

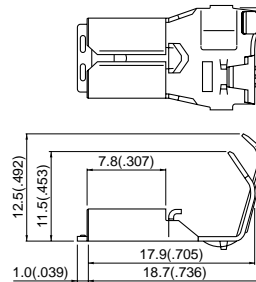

## Contact

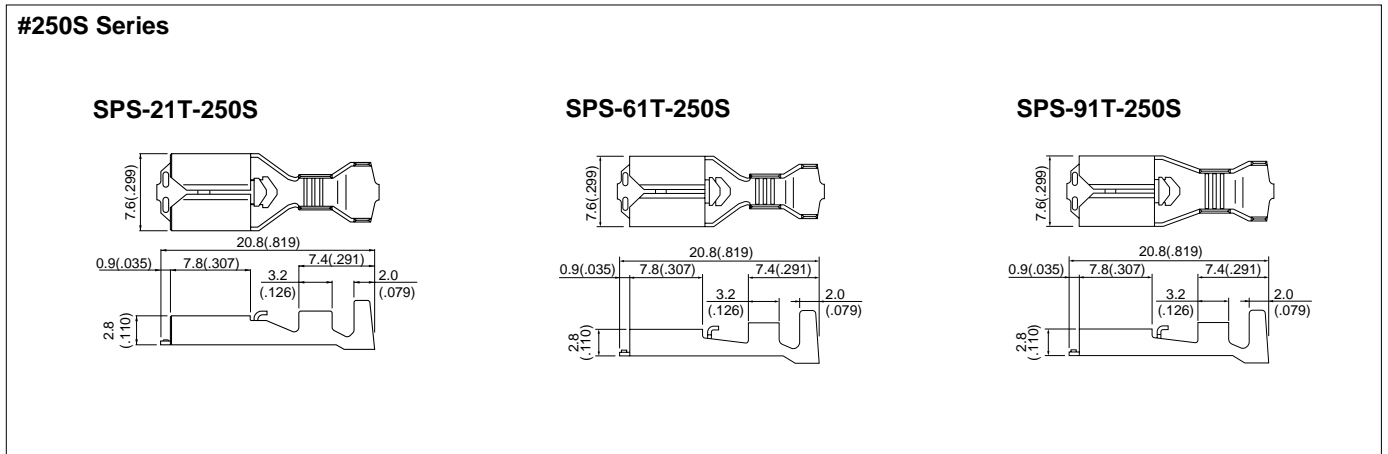

Series	Model No.	Applicable wire			Q'ty / reel
		mm <sup>2</sup>	AWG #	Insulation O.D.mm(in.)	
<b>#110</b>	<b>SPS-01T-110</b>	0.21 to 0.5	24 to 20	1.0 to 2.5(.039 to .098)	10,000
	<b>SPS-41T-110</b>	0.5 to 1.31	20 to 16	1.9 to 3.4(.075 to .134)	10,000
<b>#187</b>	for 0.5mm(.020") thick tabs <b>SPS-01T-187</b>	0.13 to 0.5	26 to 20	1.3 to 3.4(.051 to .134)	10,000
	<b>SPS-51T-187</b>	0.5 to 2.0	20 to 14	1.9 to 3.6(.075 to .142)	7,500
	<b>SPS-82T-187</b>	0.75+0.75 to 1.25+1.25	18+18 to 16+16	2.1+2.1 to 2.9+2.9(.083+.083 to .114+.114)	3,500
	for 0.8mm(.031") thick tabs <b>SPS-01T-187-8</b>	0.13 to 0.5	26 to 20	1.3 to 3.4(.051 to .134)	10,000
	<b>SPS-51T-187-8</b>	0.5 to 2.0	20 to 14	1.9 to 3.6(.075 to .142)	7,500
	<b>#187 flag</b>	for 0.5mm(.020") thick tabs <b>SFPS-41T-187</b>	0.3 to 1.25	22 to 16	1.7 to 3.4(.067 to .134)
for 0.8mm(.031") thick tabs <b>SFPS-41T-187-8</b>		0.3 to 1.31	22 to 16	1.7 to 3.4(.067 to .134)	5,000
<b>#205</b>	for 0.8mm(.031") thick tabs <b>SPS-21T-205</b>	0.3 to 0.75	22 to 18	1.5 to 3.1(.059 to .122)	5,000
	for 0.5mm(.020") thick tabs <b>SPS-21T-205-5</b>	0.3 to 0.75	22 to 18	1.5 to 3.1(.059 to .122)	5,000
	for 0.8mm(.031") thick tabs <b>SPS-51T-205</b>	0.5 to 2.0	20 to 14	1.9 to 3.6(.075 to .142)	5,000
<b>#250</b>	<b>SPS-21T-250</b>	0.3 to 0.75	22 to 18	1.5 to 3.1(.059 to .122)	5,000
	<b>SPS-61T-250</b>	0.75 to 2.0	18 to 14	2.1 to 3.9(.083 to .154)	5,000
	<b>SPS-91T-250</b>	2.0 to 5.5	14 to 10	3.0 to 4.7(.118 to .185)	4,000
<b>#250 flag</b>	<b>SFPS-61T-250</b>	0.75 to 2.0	18 to 14	2.1 to 3.9(.083 to .154)	3,000
	<b>SFPS-91T-250</b>	3.5 to 5.5	12 to 10	4.0 to 5.2(.157 to .205)	2,000
<b>#250S</b>	<b>SPS-21T-250S</b>	0.3 to 0.75	22 to 18	1.5 to 3.1(.059 to .122)	5,000
	<b>SPS-61T-250S</b>	0.75 to 2.0	18 to 14	2.1 to 3.9(.083 to .154)	5,000
	<b>SPS-91T-250S</b>	2.0 to 5.5	14 to 10	3.0 to 4.7(.118 to .185)	4,000

### Material and Finish

Brass, tin-plated

# PS CONNECTOR

## Housing

### #110 Series

#### PS-110

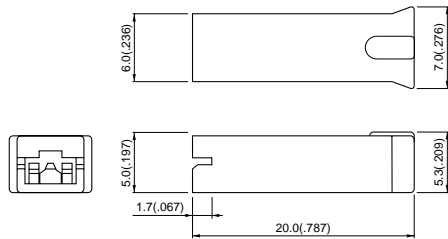

### #187 Series

#### PS-187

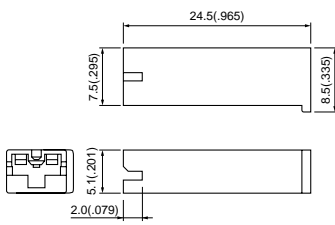

#### PS-187-2A-10

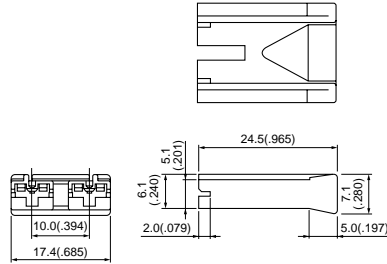

#### PS-187-2A-14

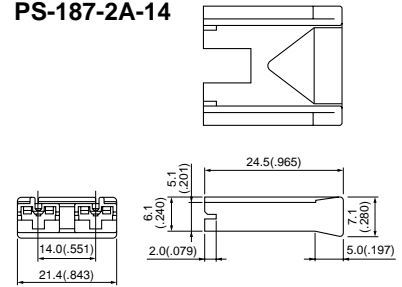

#### PS-187-2A-15

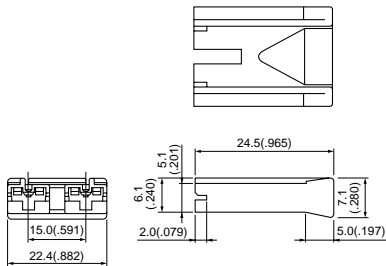

#### PS-187-2A-17.8

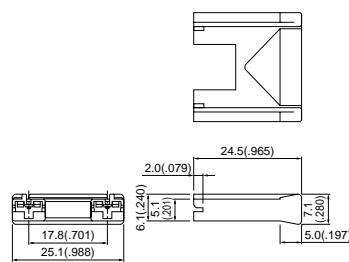

#### PS-187-2B

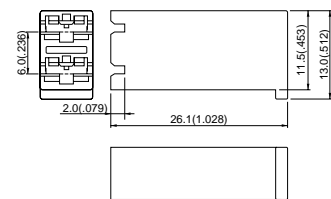

#### PS-187-2B-6.75

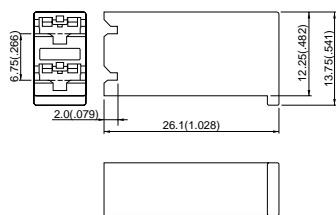

#### PS-187-2B1

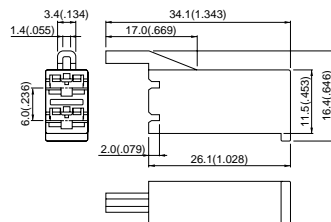

#### PS-187-4B

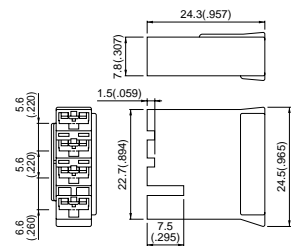

## #187 Series

### PS-187-2V

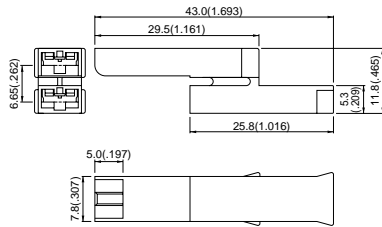

### PS-187-3V

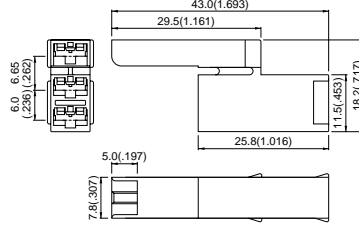

### PS-187-8-T-H

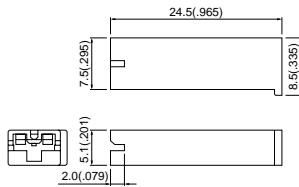

### PS-187-2A-16-8-T-H

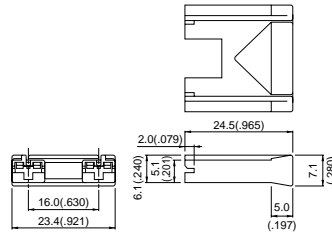

### PS-187-2B-8-T-H

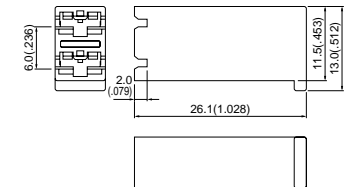

### PS-187-2B1-8-T-H

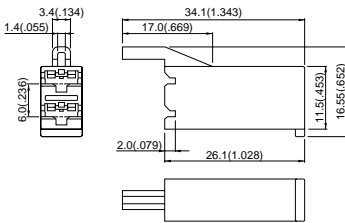

### PS-187-2V-8-T-H

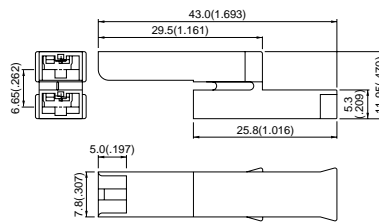

### PS-187-3V-8-T-H

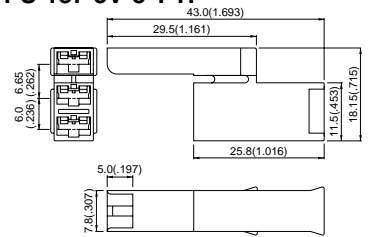

## #250S Series

### NPS-250-A

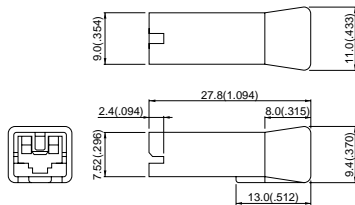

## #250 Series

### PS-250

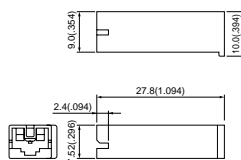

### PS-250-A

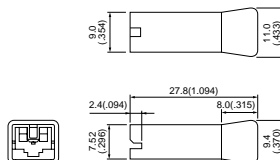

### PS-250-2B

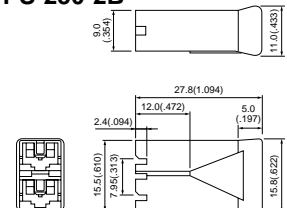

# PS CONNECTOR

## #250 Series

### PS-250-2A-15

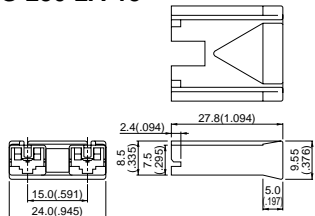

## One-touch sleeve

### FPS-187

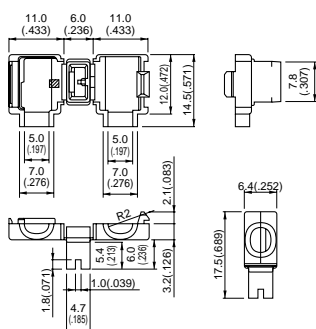

### FPS-250

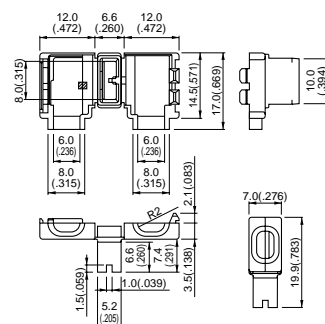

Series	Model No.	Q'ty / bag	Applicable terminal
#110	PS-110	1,000	SPS-01T-110, SPS-41T-110
#187	PS-187	1,000	SPS-01T-187 SPS-51T-187 SPS-82T-187
	PS-187-2A-10	500	
	PS-187-2A-15	500	
	PS-187-2A-17.8	500	
	PS-187-2B	500	
	PS-187-2B-6.75	500	
	PS-187-2B1	500	
	PS-187-4B	500	
	PS-187-2V	500	
	PS-187-3V	500	
	*PS-187-8-T-H	1,000	SPS-01T-187-8 SPS-51T-187-8
	*PS-187-2A-16-8-T-H	500	
	*PS-187-2B-8-T-H	500	
	*PS-187-2B1-8-T-H	500	
	*PS-187-2V-8-T-H	500	
*PS-187-3V-8-T-H	500		
#250S	NPS-250-A	1,000	SPS-21T-250S SPS-61T-250S SPS-91T-250S
#250	PS-250	1,000	SPS-21T-250 SPS-61T-250 SPS-91T-250
	PS-250-A	500	
	PS-250-2B	500	
	PS-250-2A-15	500	
One-touch sleeve	FPS-187	500	SFPS-41T-187
	FPS-250	500	SFPS-61T-250

### Material and Finish

Nylon 66, UL94V-0, natural (white)  
UL94V-2, gray <\*-marked housing...for 0.8mm(.031") thick tabs>

Note: FPS-187 and FPS-250 are UL recognized with File No. E55167, but not CSA certified.

## Applicable tab

#110...for 0.5mm (.020")

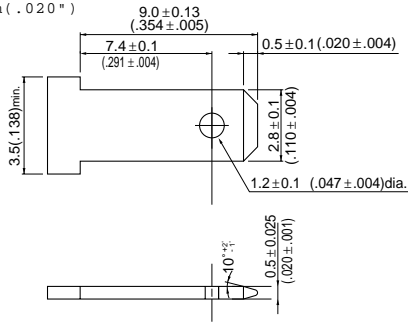

#187...for 0.5mm (.020") thick

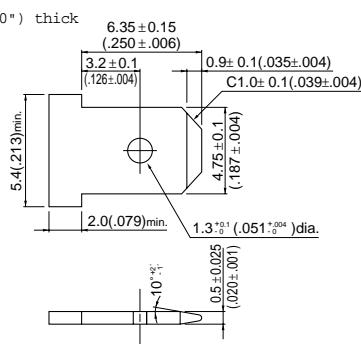

#187...for 0.8mm (.031") thick tabs

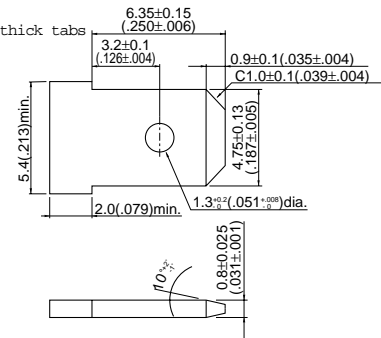

#205...for 0.5mm (.020") thick

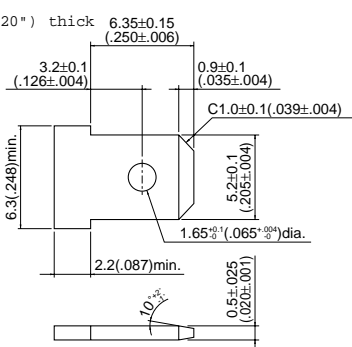

#205...for 0.8mm (.031") thick

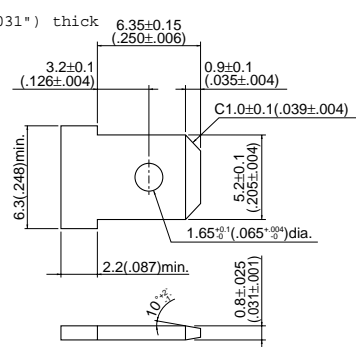

#250...for 0.8mm (.031") thick

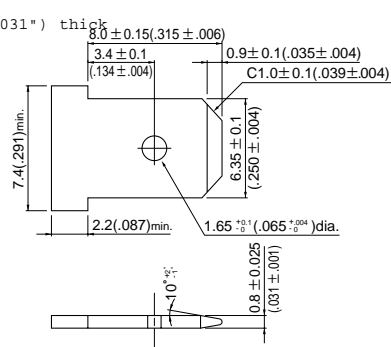

- Note: 1.Contact JST when using PS connector for Micro-switch.  
 2.Make sure there are no unneeded ribs or other protuberances on tab surfaces.  
 3.Contact JST when using PS-187-4B.



# PS CONNECTOR

## Applicator for the semi-automatic press AP-K2N

---

Contact	Crimp applicator MK-L(-SPS)	
	with safety cover	without safety cover
<b>SFPS-41T-187(-8)</b>	APL SFPS41-187 WSC	APL SFPS41-187
<b>SFPS-61T-250</b>	APL SFPS61-250 WSC	APL SFPS61-250
<b>SFPS-91T-250</b>	APL SFPS91-250 WSC	APL SFPS91-250
<b>SPS-01T-110</b>	APLMK SPS01-110	APLNC SPS01-110
<b>SPS-01T-187(-8)</b>	APLMK SPS01-187	APLNC SPS01-187
<b>SPS-21T-205</b>	APLMK SPS21-205	APLNC SPS21-205
<b>SPS-21T-250</b>	APLMK SPS21-250	APLNC SPS21-250
<b>SPS-21T-250S</b>	APLMK SPS21-250	APLNC SPS21-250
<b>SPS-41T-110</b>	APLMK SPS41-110	APLNC SPS41-110
<b>SPS-51T-187(-8)</b>	APLMK SPS51-187	APLNC SPS51-187
<b>SPS-51T-205</b>	APLMK SPS51-205	APLNC SPS51-205
<b>SPS-61T-250</b>	APLMK SPS61-250	APLNC SPS61-250
<b>SPS-61T-250S</b>	APLMK SPS61-250	APLNC SPS61-250
<b>SPS-82T-187</b>	APLMK SPS82-187	APLNC SPS82-187
<b>SPS-91T-250(S)</b>	APLMK SPS91-250	APLNC SPS91-250