

Capacitor, tantalum, 10 uF, +/-10% Tol, 25V@85C, Lead Spacing=6.35 mm

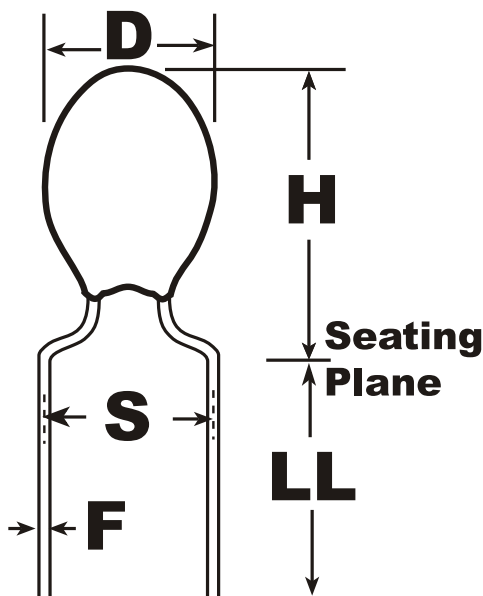

Dimensions (mm)

Specifications

ID	Dimension	Tolerance	Manufacturer:	KEMET
D	5.5	+0	Value:	10 uF
H	10.2	+0	Voltage DC @ 85C:	25V
F	0.5	+/-0.05	Voltage DC @ 125C:	16.5V
S	6.35	+/-0.38	Tolerance:	+/-10%
LL	4.75	+/-0.81	Body Type:	Radial Conformal ('dipped')
			Temperature Range:	-55/+125C
			Application:	General Purpose
			Termination Type:	Tin-Lead (SnPb)
			Leakage Current:	2 uA
			Dissipation Factor:	6%
			Package Kind:	Bulk
			Package Type:	Bag