

Lightweight yet strong, constructed of aircraft grade aluminum. Batteries snap-fit securely into clips.

- Brass Eyelets, Nickel Plate
- Brass Lugs, Nickel Plate
- Moisture Proof, Resin Impregnated, Fibre Insulating Washers
- Aluminum 2024-T3, Frame & Clip



## ALUMINUM BATTERY HOLDERS

FIG. 1



1 CELL

FIG. 2



2 CELL

FIG. 3



2 CELL

FIG. 4



4 CELL



3 CELL



6 CELL  
CAT. NO. 193  
CAT. NO. 197  
CAT. NO. 201



4 CELL



6 CELL  
CAT. NO. 205

FIG. 5



FIG. 6



### MODIFICATIONS

We welcome the opportunity to quote on variations of standard items. Use our engineering service for your custom-built holders. Holders with PC and Quick-Fit terminals available on special order.

CAT. NO.	HOLDS NO. OF CELLS	FIG. NO.	BATTERY CROSS REFERENCE			
			EVEREADY	DURACELL	RAY-O-VAC	NEDA
<b>"AAA" CELL HOLDERS</b>			$\left( \begin{array}{l} \text{BATTERY SIZE } .375 (9.5) \\ .468 (11.9) \end{array} \right) \text{O.D.} \times \frac{1.673 (42.5)}{1.752 (44.5)} \text{L}$			
137	1	1	E92, 912, CH12	M24F, MN2400	824	24A, 24F, 24P
138	2	3				
169	3	3				
170	4	3				
<b>"AA" CELL HOLDERS</b>			$\left( \begin{array}{l} \text{BATTERY SIZE } .531 (13.4) \\ .561 (14.5) \end{array} \right) \text{O.D.} \times \frac{1.906 (48.4)}{1.988 (50.5)} \text{L}$			
139	1	1	E9, EV15, EN91, CH15, E133, E133N, E177, 505, 523, 1015, 1215	ZM9, RM12R, NC15AA, M15F, M15AA, TR133R, TR177, M505, MN1500, PC1500	5AA, 615, 815, 7AA	15, 15A, 15C, 15D, 15F, 15M, 15NC, 221, 1101M, 1113M, 1306AP, 1306M, 1314M, 1606M
140	2	3				
171	3	3				
182	4	3				
189	2	2				
192	4	4				
193	6	4				
<b>"C" CELL HOLDERS</b>			$\left( \begin{array}{l} \text{BATTERY SIZE } .875 (22.2) \\ 1.125 (28.6) \end{array} \right) \text{O.D.} \times \frac{1.875 (47.6)}{1.969 (50.5)} \text{L}$			
173	1	1	CH35, E93, 935, 1235, EV35, EN93	M14F, M14HD, NC14C, TR286, MN1400, PC1400	1C, 614, 814,	14A, 14C, 14D, 14F, 14NC, 1600M
174	2	3*				
185	2	3				
187	3	2				
196	4	4**				
197	6	4				
<b>"D" CELL HOLDERS</b>						
175	1	1	CH50, E95, 950, 1250, EV50, EN95	M13F, NC13D, S42, M13HD, TR289, MN1300, PC1300	2D, 6D, 613, 813	13A, 13C, 13D, 13F, 13NC, 1115M, 1810M
176	2	3*				
190	3	2				
186	2	3				
200	4	4**				
201	6	4				
205	6	4***				
<b>"N" CELL HOLDERS</b>			$\left( \begin{array}{l} \text{BATTERY SIZE } .375 (9.5) \\ .468 (11.9) \end{array} \right) \text{O.D.} \times \frac{1.110 (28.2)}{1.189 (30.2)} \text{L}$			
154	1	1	E90, E340E, E401E, EP401, EP401E	MP401H	R401, RP401, 810	910A, 910F, 910M, 1117M, 1118M, MN9100
155	2	3				
156	3	3				
<b>"9 VOLT" BATTERY HOLDERS</b>						
203-P	REFER TO PAGE 21		CH22, EN22, E146X, 216, 522, 1222, E303396	TR146X, M1604, M1604HD, MN16, PC146X,	A1604, D1604, 1604	1604A, 1604C, 1604D, 1604M, 1604NC, 1619M
303-P						
1290†						
1290-79						
1291†						
1291-79						
<b>LITHIUM "2/3A" CELL HOLDER</b>						
131	1	1	–	DL-2/3A	BR-2/3A	CR-173355E
<b>"15 VOLT" BATTERY HOLDERS</b>						
161	1	5	–	–	–	224
163	1	5	411	–	–	208
167	2	6*	–	–	–	–
<b>"22½ VOLT" BATTERY HOLDERS</b>						
139	1	1	505	–	–	221
168	1	5	420	–	–	225
177	1	5	–	–	–	–
178	2	6*	M215	M215	–	215
<b>"30 VOLT" BATTERY HOLDERS</b>						
183	1	5	413	–	–	210
184	1	6*	–	–	–	–

\* 1 Clip holds two batteries in place. \*\* 2 Clips hold four batteries in place. \*\*\* 3 Clips hold six batteries in place. † Recommended for battery thickness under .640 (16.3)

# DIMENSIONAL DRAWINGS FOR ALUMINUM BATTERY HOLDERS

## MATERIAL SPECIFICATIONS

**Insulating Washers:** Moisture proof, resin impregnated fibre  
**Terminal Lugs:** Brass, Tin Plate

**Frame and Clips:** Aluminum 2024-T3  
**Contact Eyelet:** Brass, Nickel Plate

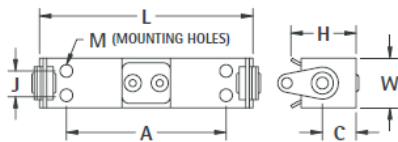

DWG. 1

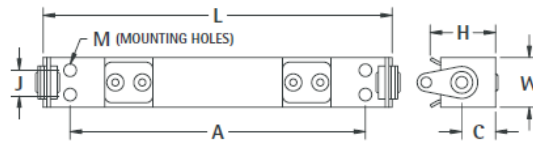

DWG. 2

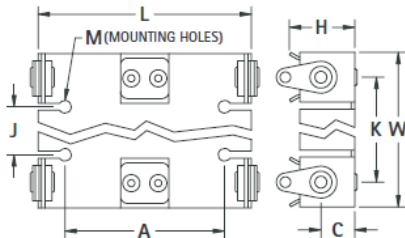

DWG. 3

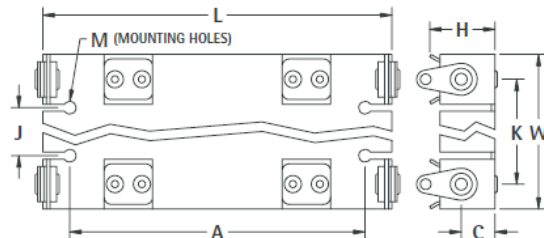

DWG. 4

CAT. NO.	DWG. NO.	W Width Of Base	L Length Of Base	H Height Of Base	C Height to Battery Center	K Distance Between Battery Centers	J Mounting Holes Spacing	A Mounting Holes Center to Center	M Mounting Holes (Diameter)
<b>"AAA" CELL HOLDERS</b>									
137	1	.437 (11.1)	1.915 (48.6)	.484 (12.3)	.468 (11.9)	—	.250 (6.4)	1.500 (38.1)	.111 (2.8)
138	3	.812 (20.6)	1.915 (48.6)	.484 (12.3)	.468 (11.9)	.437 (11.1)	—	.875 (22.2)	.140 (3.6)
169	3	1.250 (31.8)	1.915 (48.6)	.467 (11.9)	.281 (7.1)	.437 (11.1)	.438 (11.1)	.875 (22.2)	.144 (3.7)
170	3	1.687 (42.8)	1.915 (48.6)	.484 (12.3)	.468 (11.9)	.437 (11.1)	.875 (22.2)	.875 (22.2)	.140 (3.6)
<b>"AA" CELL HOLDERS</b>									
139	1	.625 (15.9)	2.140 (54.4)	.580 (14.7)	.625 (15.9)	—	.406 (10.3)	1.500 (38.1)	.111 (2.8)
140	3	1.125 (28.6)	2.140 (54.4)	.625 (15.9)	.625 (15.9)	.625 (15.9)	—	1.218 (30.9)	.140 (3.6)
171	3	1.750 (44.5)	2.140 (54.4)	.625 (15.9)	.625 (15.9)	.625 (15.9)	.625 (15.9)	1.218 (30.9)	.140 (3.6)
182	3	2.656 (67.5)	2.140 (54.4)	.625 (15.9)	.625 (15.9)	.718 (18.2)	1.437 (36.5)	1.218 (30.9)	.140 (3.6)
189	2	.625 (15.9)	4.075 (103.5)	.625 (15.9)	.625 (15.9)	—	.437 (11.1)	3.000 (76.2)	.128 (3.3)
192	4	1.125 (28.6)	4.093 (104.0)	.625 (15.9)	.625 (15.9)	.625 (15.9)	—	3.093 (78.6)	.140 (3.6)
193	4	1.750 (44.5)	4.075 (103.5)	.625 (15.9)	.625 (15.9)	.625 (15.9)	.625 (15.9)	3.125 (79.4)	.140 (3.6)
<b>"C" CELL HOLDERS</b>									
173	1	.750 (19.1)	2.093 (53.2)	.953 (24.2)	.781 (19.8)	—	.437 (11.1)	1.500 (38.1)	.140 (3.6)
174	3*	1.625 (41.3)	2.093 (53.2)	1.105 (28.1)	.781 (19.8)	1.000 (25.4)	—	1.750 (44.5)	.140 (3.6)
185	3	.750 (19.1)	4.025 (102.2)	.953 (24.2)	.812 (20.6)	—	.500 (12.7)	3.187 (80.9)	.140 (3.6)
187	2	2.840 (72.1)	2.093 (53.2)	.953 (24.2)	.781 (19.8)	1.125 (28.6)	1.125 (28.6)	1.250 (31.8)	.140 (3.6)
196	4**	1.625 (41.3)	4.025 (102.2)	1.125 (28.6)	.781 (19.8)	1.000 (25.4)	—	3.187 (80.9)	.140 (3.6)
197	4	2.875 (73.0)	4.025 (102.2)	.968 (24.6)	.812 (20.6)	1.171 (29.7)	1.000 (25.4)	3.187 (80.9)	.140 (3.6)
<b>"D" CELL HOLDERS</b>									
175	1	1.000 (25.4)	2.562 (65.1)	1.218 (30.9)	.937 (23.8)	—	.750 (19.1)	1.750 (44.5)	.128 (3.3)
176	3*	2.062 (52.4)	2.578 (65.5)	1.437 (36.5)	.937 (23.8)	1.312 (33.3)	—	2.093 (53.2)	.140 (3.6)
186	2	1.000 (25.4)	4.865 (123.6)	1.218 (30.9)	.968 (24.6)	—	.687 (17.4)	4.125 (104.8)	.128 (3.3)
190	3	3.375 (85.7)	2.578 (65.5)	1.218 (30.9)	.968 (24.6)	1.343 (34.1)	1.125 (28.6)	1.937 (49.2)	.140 (3.6)
200	4**	2.062 (52.4)	4.865 (123.6)	1.468 (37.3)	.968 (24.6)	1.312 (33.3)	—	4.375 (111.1)	.140 (3.6)
201	4	3.375 (85.7)	4.865 (123.6)	1.218 (30.9)	.968 (24.6)	1.343 (34.1)	1.125 (28.6)	4.275 (108.6)	.140 (3.6)
205	4***	2.062 (52.4)	7.230 (183.6)	1.437 (36.5)	.937 (23.8)	1.312 (33.3)	—	6.812 (173.0)	.140 (3.6)
<b>"N" CELL HOLDERS</b>									
154	1	.437 (11.1)	1.343 (34.1)	.531 (13.5)	.468 (11.9)	—	.250 (6.4)	.906 (23.0)	.111 (2.8)
155	3	.937 (23.8)	1.343 (34.1)	.531 (13.5)	.484 (12.3)	.500 (12.7)	—	.875 (22.2)	.128 (3.3)
156	3	1.500 (38.1)	1.343 (34.1)	.531 (13.5)	.475 (12.1)	.531 (13.5)	.562 (14.3)	.875 (22.2)	.111 (2.8)
<b>LITHIUM "2/3A" CELL HOLDER</b>									
131	1	.625 (15.9)	1.478 (37.5)	.625 (15.9)	.437 (11.1)	—	.437 (11.1)	1.125 (28.6)	.111 (2.8)
<b>"15 VOLT" BATTERY HOLDERS</b>									
161	1	1.125 (28.6)	1.625 (41.3)	.594 (15.1)	.375 (9.5)	—	.562 (14.3)	1.000 (25.4)	.140 (3.6)
163	1	1.000 (25.4)	1.750 (44.5)	1.218 (30.9)	.687 (17.4)	—	.718 (18.2)	1.125 (28.6)	.140 (3.6)
167	1*	1.125 (28.6)	1.593 (40.5)	1.264 (32.1)	.760 (19.3)	.593 (15.1)	—	1.000 (25.4)	.140 (3.6)
<b>"22 1/2 VOLT" BATTERY HOLDERS</b>									
139	1	.625 (15.9)	2.140 (54.4)	.578 (14.7)	.390 (9.9)	—	.406 (10.3)	1.500 (38.1)	.111 (2.8)
168	1	.750 (19.1)	2.275 (57.8)	.937 (23.8)	.718 (18.2)	—	.500 (12.7)	1.500 (38.1)	.140 (3.6)
177	1	.750 (19.1)	2.125 (54.0)	1.156 (29.4)	.781 (19.8)	—	.437 (11.1)	1.500 (38.1)	.140 (3.6)
178	3*	1.125 (28.6)	2.215 (56.3)	1.218 (30.9)	.781 (19.8)	.625 (15.9)	—	1.218 (30.9)	.140 (3.6)
<b>"30 VOLT" BATTERY HOLDERS</b>									
183	1	.750 (19.1)	2.687 (68.2)	1.156 (29.4)	.812 (20.6)	—	.562 (14.3)	1.750 (44.5)	.111 (2.8)
184	3*	1.125 (28.6)	2.640 (67.1)	1.218 (30.9)	.812 (20.6)	.625 (15.9)	—	1.812 (46.0)	.140 (3.6)

\* 1 Clip holds two batteries in place. \*\* 2 Clips hold four batteries in place. \*\*\* 3 Clips hold six batteries in place.

DIMENSIONS ARE FOR REFERENCE ONLY

Tel (718) 956-8900 • Fax (718) 956-9040  
 (800) 221-5510 • kec@keyelco.com

**KEYSTONE**  
 RoHS COMPLIANT ~ ISO 9001 CERTIFIED

www.keyelco.com  
 31-07 20th Road - Astoria, NY 11105-2017

ALUMINUM BATTERY HOLDERS