



Designers' Choice

# BATTERY CONTACTS

## BATTERY SPRING & BUTTON CONTACTS

- Economical and reliable contacts are ideal for molded cases with self contained battery compartments
- Single and dual contact designs available for "A", "AA", "AAA", "AAAA" & "N" size batteries
- "Solder tab" design for either wire lead or PC mounting
- Unique spring contacts adjust to variations in battery lengths
- Reliable spring contacts assure low contact resistance and a dependable connection
- Space saving, economical, excellent mechanical construction

## SPRING CONTACT FOR "A" • "AA" • "9V" SIZES



MATERIAL: .012 Phosphor Bronze, Nickel Plate

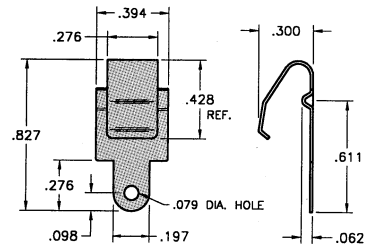

CAT. NO. 5209

## BATTERY CONTACTS FOR "A" • "AA" SIZES

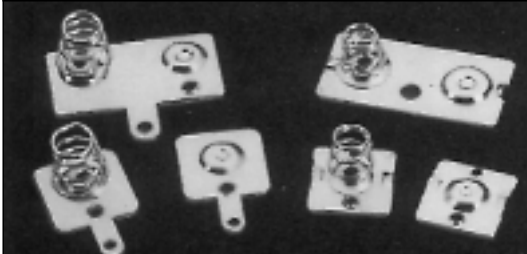

MATERIAL:  
Plate: .020 Steel, Nickel Plate  
Spring: Spring Steel, Nickel Plate

Dual Contact w/Tabs

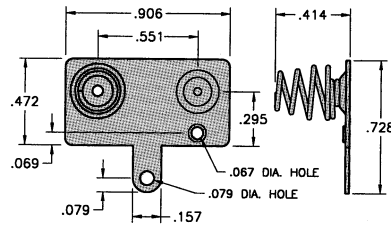

CAT. NO. 5211

Dual Contact

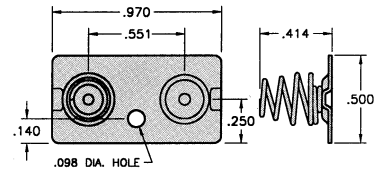

CAT. NO. 5212

(+) Positive Button

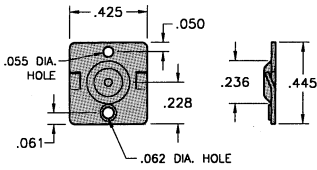

CAT. NO. 5224

(-) Negative Spring

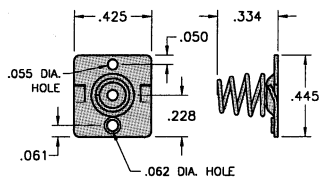

CAT. NO. 5202

(+) Positive Button w/Tabs

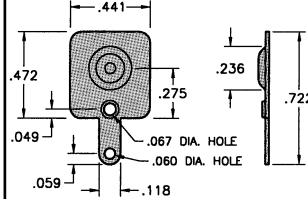

CAT. NO. 5223

(-) Negative Spring w/Tabs

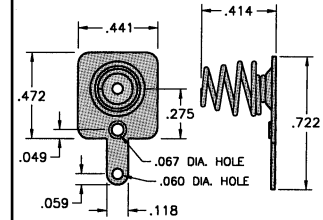

CAT. NO. 5201

## BATTERY CONTACTS FOR "AAA" • "AAAA" • "N" SIZES

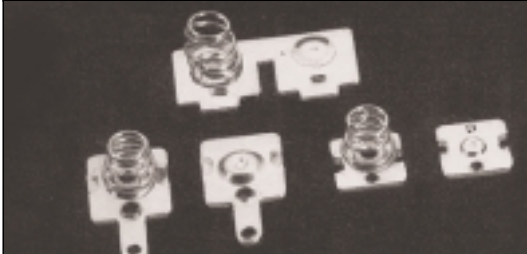

MATERIAL:  
Plate: .020 Steel, Nickel Plate  
Spring: Spring Steel, Nickel Plate

(+) Positive Button

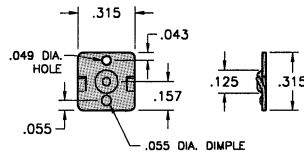

CAT. NO. 5225

(-) Negative Spring

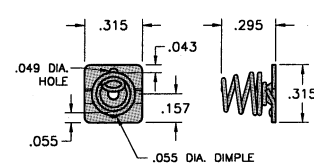

CAT. NO. 5203

Dual Contact

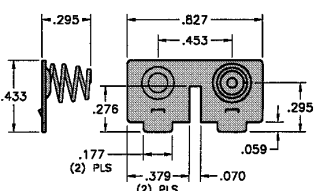

CAT. NO. 5214 (Left Side)

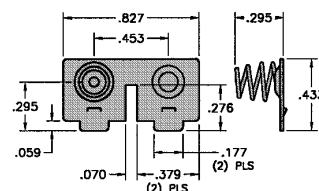

CAT. NO. 5213 (Right Side)

(+) Positive Button w/Tabs

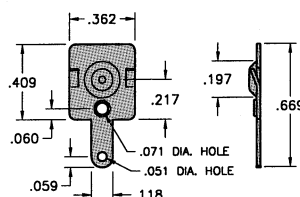

CAT. NO. 5226

(-) Negative Spring w/Tabs

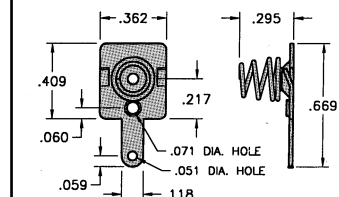

CAT. NO. 5204

# BATTERY CONTACTS

Designers' Choice



## SNAP-ON CONTACTS FOR "A" • "AA" • "AAA" • "AAAA" • "N" SIZES

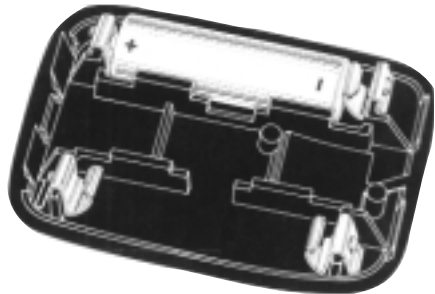

- Economical and reliable contacts are ideal for molded cases with self contained battery compartments
- Single & dual contact designs available for "A" • "AA" • "AAA" • "AAAA" • "N" size batteries
- Solder "ear" to facilitate soldering of wire lead
- Unique spring tension contact adjusts to variations in battery length
- Reliable spring tension contacts assure low contact resistance
- Clips easily onto .060 to .070 thick panel edges
- Sharp barbs securely anchor contact in place

### For "A" • "AA"

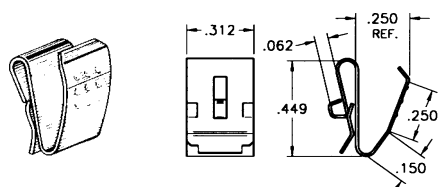

CAT. NO. 209

MATERIAL  
.012 Spring Steel,  
Nickel Plate

### For "A" • "AA"

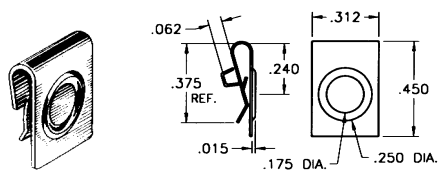

CAT. NO. 228

MATERIAL  
.010 Spring Steel,  
Nickel Plate

### For "AAA" • "AAAA" • "N"

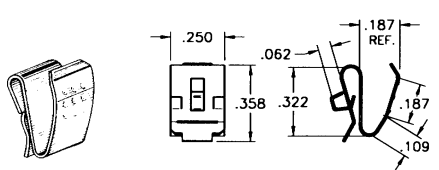

CAT. NO. 204

MATERIAL  
.010 Spring Steel,  
Nickel Plate

### For "AAA" • "AAAA" • "N"

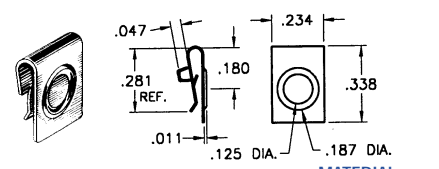

CAT. NO. 238

MATERIAL  
.010 Spring Steel,  
Nickel Plate

### For "A" • "AA"

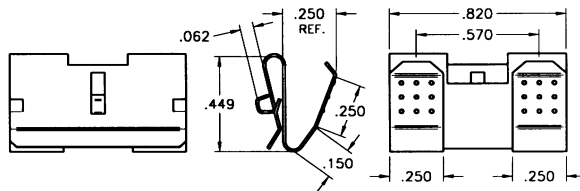
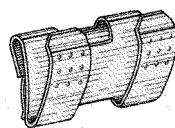

CAT. NO. 210

MATERIAL: .012 Spring Steel, Nickel Plate

### For "A" • "AA"

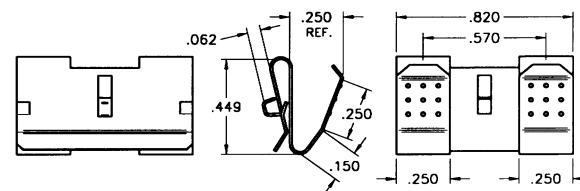
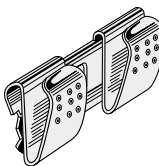

CAT. NO. 288

MATERIAL: .012 Spring Steel, Nickel Plate

### For "A" • "AA"

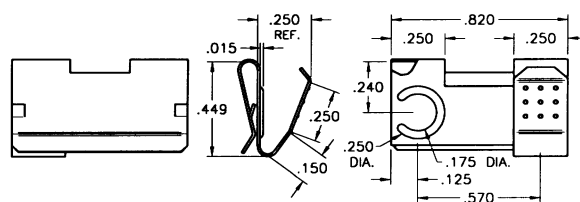
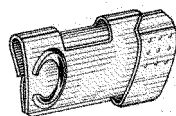

CAT. NO. 290 - Left (shown)

CAT. NO. 291 - Right

MATERIAL: .012 Spring Steel, Nickel Plate

### For "A" • "AA"

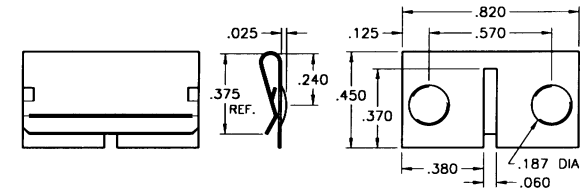

CAT. NO. 292

MATERIAL: .010 Spring Steel, Nickel Plate

### For "AAA" • "AAAA" • "N"

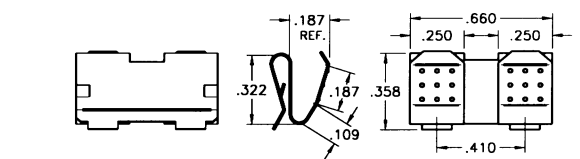
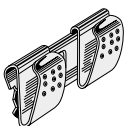

CAT. NO. 202

MATERIAL: .010 Spring Steel, Nickel Plate