



Designers' Choice

GROMMETS, BUMPERS & BUSHINGS

RUBBER GROMMETS

Ideal for electrical insulation and mechanical damping. Made from BUNA S.

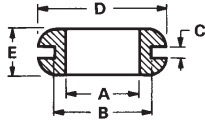

CAT. NO.	I.D. A	For Hole B	For Panel C	D	E
730	.125	.187	.062	.312	.187
733	.125	.250	.062	.343	.187
734	.125	.437	.062	.625	.187
735	.125	.375	.093	.500	.312
736	.187	.312	.062	.437	.218
731	.187	.312	.062	.437	.218
737	.187	.281	.093	.437	.218
738	.250	.437	.062	.625	.187
739	.250	.375	.062	.562	.250
740	.250	.375	.093	.500	.250
741	.312	.562	.062	.812	.312
742	.312	.437	.062	.625	.281
743	.312	.437	.093	.625	.312
744	.375	.625	.062	.875	.312
745	.375	.500	.062	.625	.250
732	.437	.562	.062	.750	.250
746	.437	.687	.062	.937	.312
747	.500	.812	.062	1.062	.312
748	.500	1.250	.062	1.500	.250
749	.500	.750	.093	.968	.281
750	.562	.812	.062	1.062	.312
752	.625	.875	.062	1.125	.312
753	.625	1.250	.062	1.500	.250
755	.750	1.062	.062	1.375	.375
756	.750	1.437	.062	1.812	.375
757	.875	1.250	.062	1.625	.437

RECESSED BUMPERS

Provides excellent traction and shock absorbing qualities. available with or without Mold-in Washers.

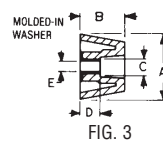
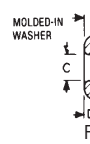
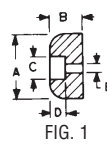

MATERIAL: Rubber, BUNA S (figs. 1 & 2), Vinyl (fig. 3)

CAT. NO.	FIG.	A	B	C	D	E	Screw Size
720	1	.500	.250	.250	.187	.125	#4
721	1	.625	.312	.250	.187	.125	#4
722	1	.718	.437	.250	.218	.125	#4
723	2	.937	.375	.375	.187	.187	#8
*724	3	.687	.250	.343	.125	.155	#6
*725	3	.875	.312	.406	.125	.187	#8
*726	3	1.062	.437	.468	.234	.200	#10
727	3	.562	.375	.218	.187	.115	#4
728	3	.750	.437	.265	.250	.148	#6
729	3	.937	.625	.359	.297	.174	#8

*Grey - all others black

SELF-LOCKING BUMPER FOOT

- A unique easy-to-install self-locking bumper foot
- Two piece assembly, furnished pre-assembled
- Vibration absorbing and skid resistant
- Mounts without screws or tools

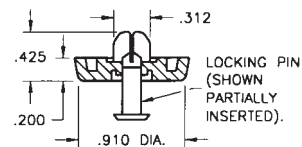

MATERIAL:
Foot: Santoprene, Black
Pin: Polypropylene, Black

CAT. NO. 717

Recommended Mounting Hole: .305 dia.

NYLON INSULATED BUSHINGS

Snaps into panel hole to provide protection for wire, cable and tubing from sharp uneven edges.

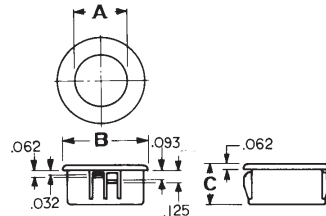

MATERIAL: Nylon 6/6, Black

CAT. NO.	HOLE SIZE REQUIRED	MAXIMUM CHASSIS THICKNESS	A INSIDE DIA.	B HEAD DIA.	C OVERALL HEIGHT
8470	.250	.062	.125	.312	.312
8471	.312	.062	.187	.375	.312
8472	.375	.125	.250	.468	.406
8473	.437	.125	.312	.531	.406
8474	.500	.125	.375	.578	.406
8475	.562	.125	.437	.656	.406
8476	.625	.125	.500	.718	.406
8477	.750	.125	.562	.843	.406
8478	.875	.125	.625	.953	.453
8479	1.000	.125	.750	1.125	.453
8480	1.187	.125	.937	1.312	.453
8481	1.250	.125	.937	1.359	.453
8482	1.375	.125	1.000	1.468	.453
8483	1.500	.125	1.062	1.609	.453
8484	1.750	.125	1.375	1.875	.453
8485	2.000	.125	1.625	2.125	.453
8486	2.500	.250	1.968	2.656	.718

"UNIVERSAL" RUBBER GROMMET

Designed to adjust to different wire, cable or tubing diameters from .125 to .312

- Self-adjusting membrane forms a dust resistant seal
- Installs in .500 diameter hole in .062 thick panels or boards
- Molded outer ring retains grommet in place

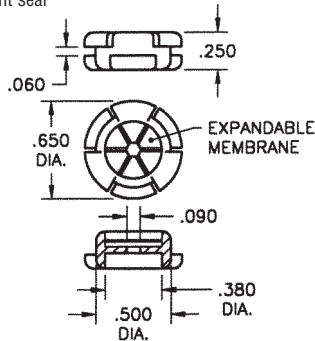

MATERIAL: Black Thermoplastic Rubber

CAT. NO. 777

NYLON SPLIT BUSHINGS

Designed to be assembled into holes that already contain wire or cable. Versatile bushing can be used on all chassis from .032 to .125 thick.

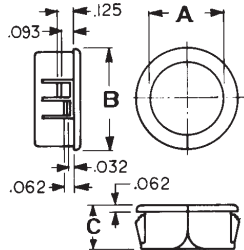

CAT. NO.	HOLE SIZE REQUIRED	A INSIDE DIA.	B HEAD DIA.
8490	.375	.265	.421
8491	.500	.312	.562
8492	.562	.390	.640
8493	.625	.453	.687
8494	.750	.546	.796
8495	.875	.671	.921
8496	1.000	.796	1.062

MATERIAL: Nylon 6/6, Black

HOLE PLUGS/CABLE CLAMPS

Designers' Choice



NYLON HOLE PLUGS

Closes unused chassis holes quickly and economically. Plugs are abrasion and vibration resistant.

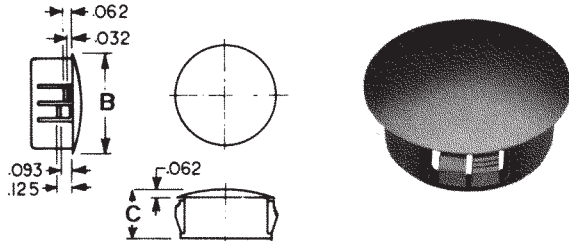

MATERIAL: Black, Nylon 6/6, Matte Finish

CAT. NO.	HOLE DIA.	PANEL THICKNESS	B	C
8600	.250	.062	.312	.312
8601	.312	.062	.375	.312
8602	.375	.125	.468	.406
8603	.500	.125	.578	.406
8604	.625	.125	.734	.406
8605	.750	.125	.921	.406
8606	.875	.125	1.015	.453
8607	1.000	.125	1.203	.453
8608	1.125	.125	1.218	.453
8609	1.250	.125	1.375	.453
8610	1.375	.125	1.500	.453
8611	1.500	.125	1.671	.453

STEEL HOLE PLUGS

Excellent spring retention. Plugs will cover chassis holes, wiring outlets, access holes or unused opening.



MATERIAL: Steel, Nickel Plate

CAT. NO.	Hole Dia.	Panel Thickness	A	B	C	Prongs
7600	.250	.032-.062	.406	.234	.062	6
7601	.312	.047-.078	.437	.250	.062	6
7602	.375	.047-.062	.500	.234	.062	6
7603	.500	.031-.062	.656	.281	.078	8
7604	.625	.062-.093	.812	.296	.078	8
7605	.750	.062-.093	.921	.296	.078	12
7606	.875	.062-.093	1.062	.296	.062	12
7607	1.000	.062-.156	1.140	.328	.093	12
7608	1.125	.031-.125	1.312	.343	.093	12
7609	1.250	.062-.093	1.437	.343	.093	12
7610	1.375	.031-.125	1.562	.406	.078	12
7611	1.500	.031-.062	1.640	.406	.093	12

NYLON VENT PLUGS

Used to cover chassis holes while allowing air flow for ventilation.

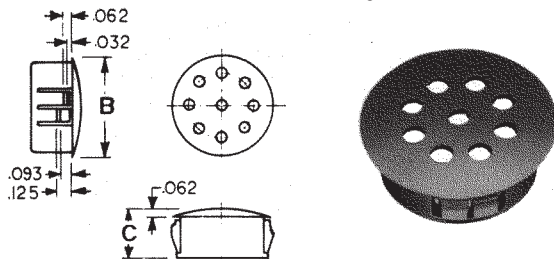

MATERIAL: Black, Nylon 6/6, Matte Finish

CAT. NO.	HOLE DIA.	PANEL THICKNESS	B	C
8612	.875	.125	1.015	.453
8613	1.000	.125	1.203	.453

NYLON CABLE CLAMPS

Ideal for securing, insulating and routing cable wiring, piping, tubing, components and fibre optics.

MATERIAL: White, .050 Nylon 6/6

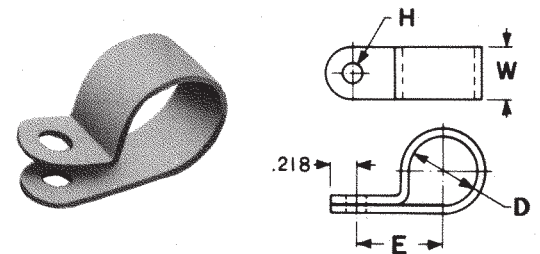

CAT. NO.	D	E	W	H
7620	.125	.325	.375	.140
7621	.125	.325	.375	.203
7622	.187	.380	.375	.140
7623	.187	.380	.375	.203
7624	.250	.410	.375	.140
7625	.250	.410	.375	.203
7626	.312	.445	.375	.140
7627	.312	.445	.375	.203
7628	.375	.475	.375	.140
7629	.375	.475	.375	.203
7630	.437	.525	.375	.140
7631	.437	.525	.375	.203
7632	.500	.550	.375	.140
7633	.500	.550	.375	.203
7634	.562	.625	.500	.203
7635	.625	.660	.500	.203
7636	.750	.785	.500	.203
7637	.875	.845	.500	.203
7638	1.000	.910	.500	.203
7639	1.125	.970	.500	.203
7640	1.250	1.060	.500	.203

FLEXIBLE GROMMETING

Ideal for maintenance, short-run production, R&D or prototyping. Supplied in 25ft. rolls. Make your own grommets to fit any size or shape required.

MATERIAL: Black, Nylon Type 6/6

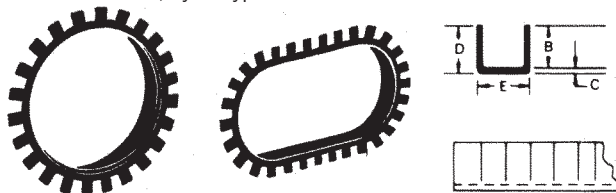

CAT. NO.	MAX. PANEL	B	C	D	E
8615	.052	.150	.040	.190	.125
8616	.085	.155	.045	.200	.162
8617	.125	.155	.045	.220	.206

PC BOARD & CABLE ACCESSORIES

Designers' Choice



LEVEL ACTION PC CARD EJECTORS

Designed for .062 thick PC cards. Level action ejectors aids card insertion and extraction. Supplied complete with stainless steel spring pin.

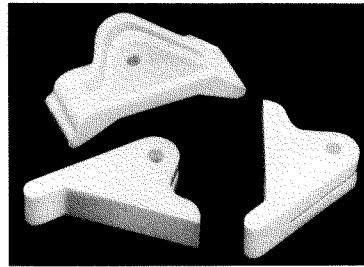

CARD MOUNTING DIMENSIONS

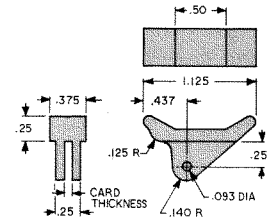
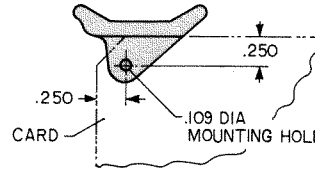

MATERIAL: White Nylon 6/6, UL rated 94V-2

CAT. NO. 8640

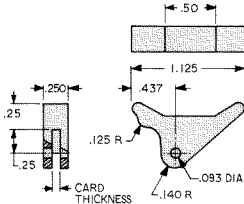

CAT. NO. 8641

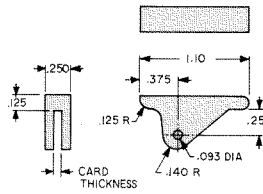

CAT. NO. 8642

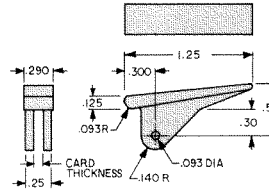

CAT. NO. 8643

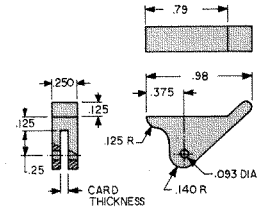

CAT. NO. 8644

PC BOARD GUIDES

Guides may be used horizontally or vertically and snap into .125 diameter holes. Narrow width allows maximum density and optimum air-flow. Simple press-fit, secure installation.

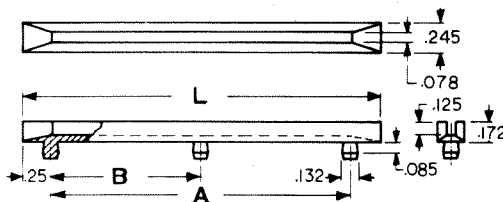
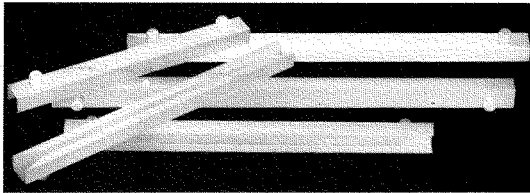

MATERIAL: Natural Nylon 6/6, UL rated 94V-2

CAT. NO.	L	A	B
8620	2.5	2.0	—
8621	3.0	2.5	—
8622	3.5	3.0	—
8623	4.0	3.5	—
8624	4.5	4.0	—
8625	5.0	4.5	—
8626	5.5	5.0	—
8627	6.0	5.5	—
8628	6.5	6.0	—
8629	7.0	6.5	—
8630	7.0	6.5	3.25
8631	7.5	7.0	—
8632	7.5	7.0	3.50
8633	8.0	7.5	—
8634	8.0	7.5	3.75
8635	8.5	8.0	—
8636	8.5	8.0	4.00

CABLE TIES

Popular sizes and strengths to meet common cable tie requirements. Injection molded with one piece construction for strength and reliability. Easily installed by hand. Optional installation tool available, tightens and flush cuts cable tie.

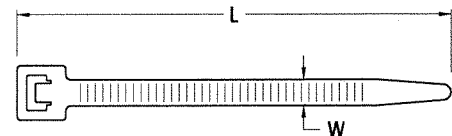
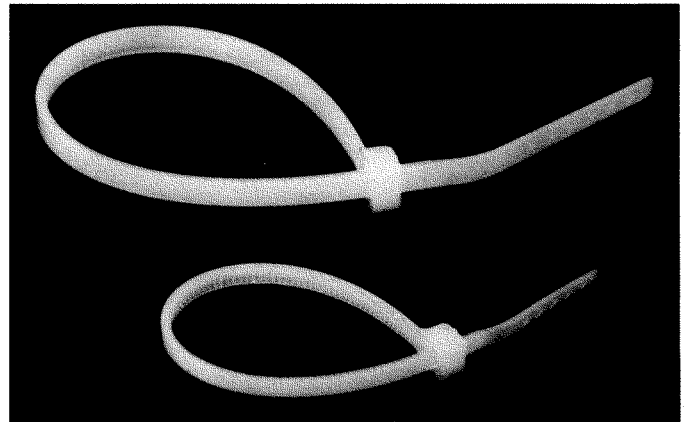

MATERIAL: Natural Nylon 6/6, UL rated 94V-2

CAT. NO.	TENSILE STRENGTH (Min. Bundle)	BUNDLE DIAMETER (Maximum)	L LENGTH (Approx.)	W WIDTH (Approx.)	T THICKNESS (Approx.)
8865	18 lbs	1.000	4.250	0.100	0.045
8866	18 lbs	2.000	8.000	0.100	0.045
8867	40 lbs	1.250	6.000	0.140	0.050
8868	50 lbs	1.750	7.500	0.190	0.055
8869	120 lbs	4.000	14.500	0.190	0.055
8870	Hand Operated Cable Tie Installation Tool for 18lb to 50lb Ties				