

**Recommended PCB Layout  
(Top View)**

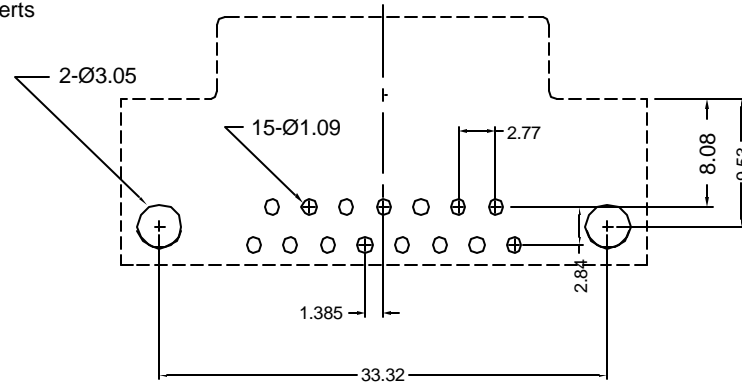

**Material and Finish**

Shell: Steel, zinc plated or tin plated

Insulator: PBT with glass-fiber reinforcement  
UL 94V-0  
color-black

Contact Material:  
Plug- Brass

Contact Plating Options:  
Standard: gold flash on mating end, tin on termination end, 50u" nickel underplate on entire contact

15 Option: 0.000015" gold on mating end, tin on termination end, 50u" nickel underplate on entire contact

30 Option: 0.000030" gold on mating end, tin on termination end, 50u" nickel underplate on entire contact

**Electrical Specifications**

Rated Current:  
5A

Rated Voltage:  
300V DC

Withstanding Voltage:  
500V (rms) AC for 1 min

Insulation Resistance:  
more than 1000 Mohm at 500v DC

Contact Resistance:  
13 mohm Max

Dielectric Strength:  
1000V for 1 min

Temperature Rating:  
-55°C to +105°C

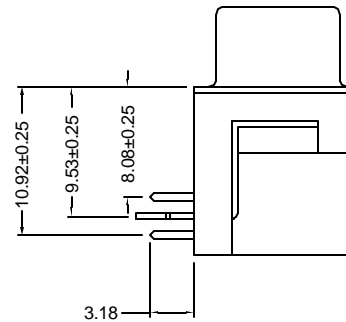
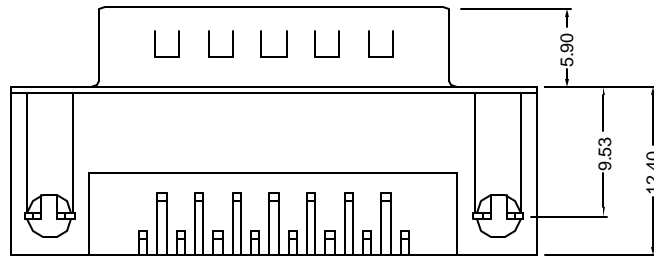

**Ordering Information**

Part Number	Contact Area Plating Finish
K22X-A15P-N	Gold Flash (standard)
K22X-A15P-N15	15u" Gold (15 option)
K22X-A15P-N30	30u" Gold (30 option)



Tolerances
X.X ± 0.25
X.XX ± 0.15
Unless Stated Otherwise

REV.	DATE	DESCRIPTION	REV. BY	CHK. BY	DRAWN BY	DATE
A1	10/28/05	New Drawing	R. Aguirre	H. MA	R. Aguirre	9/26/05

**K22X-A15P-N**

Right Angle D-Sub, Male, RoHS Compliant

0.318" Footprint

