

Recommended PCB Layout  
(Component Side)

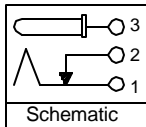
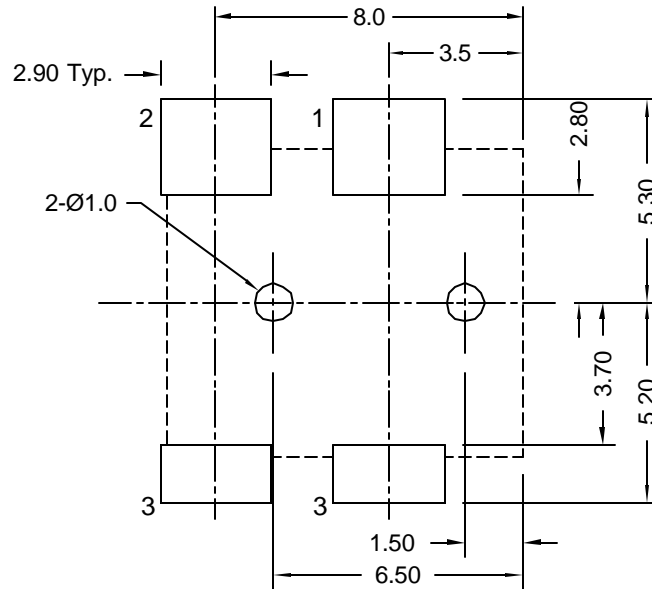
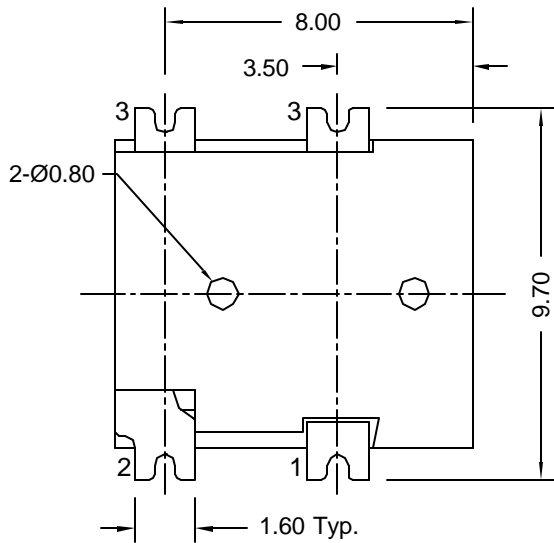

Part Number	Center Post Diameter	Packaging
KLDX-SMT-0201L-A	Ø1.00	Bulk (standard)
KLDX-SMT-0201L-B	Ø1.30	
KLDX-SMT-0201L-A-TR	Ø1.00	Tape & Reel (TR option)
KLDX-SMT-0201L-B-TR	Ø1.30	

**Material and Finish**

Body: High Temp Thermoplastic  
UL94V-0, Color: Black  
Center Pin: Brass, Silver Plated  
Contact #1: Phosphor Bronze, Silver Plated  
Contact #2, #3: Brass, Silver Plated

**Electrical Characteristics**

Contact Resistance  
Before Test  
Between Terminals: 30 milliohms Max.  
Plug to Contacts: 50 milliohms Max.  
After Test:  
Between Terminals: 60 milliohms Max.  
Plug to Contacts: 100 milliohms Max.

Rated Voltage: 24V DC  
Rated Current: 2.5 amps  
Insulation Resistance: 100 Megohms Min.  
**Mechanical Characteristics**  
Durability Test: 2500 cycles  
Insertion Force: 0.3kg-2.0kg  
Extraction Force: 0.3kg-2.0kg  
Operating Temp: -25°C to +70°C  
Max. Soldering Temp: 230°C for 30 seconds  
260°C for 10 seconds

**Recommended Plug Dimensions**

Outer Dimension OD: 3.5mm  
Inner Diameter ID:  
KLDX-SMT-0201L-A: 1.10mm  
KLDX-SMT-0201L-B: 1.35mm



Tolerances
X.X ± 0.25
X.XX ± 0.15
Unless Stated Otherwise

REV.	DATE	DESCRIPTION	REV. BY	CHK. BY	DRAWN BY	DATE
A1	7/21/05	New Drawing	H. MA	C. Furumasu	H. MA	7/21/05

**KLDX-SMT-0201L-xx**

UNITS  
mm

**Mini DC Power Jack,  
SMT, RoHS Compliant**

